

A close-up photograph of several thistles in a field. The thistles have green, spiky leaves and stems. The flower heads are covered in small, purple and white flowers. The background is a clear blue sky with a few white clouds. The text is overlaid on the top left and bottom right of the image.

***Lancaster County  
Weed Control Authority  
2019 Director Evaluation***

**Brent Meyer  
Weed Superintendent**

# Lancaster County / City of Lincoln Combined Weed Program

- Provide a coordinated program for control of Noxious Weeds County wide - and Weed Abatement within Lincoln's City limits.
- By Interlocal agreement in 1996 the City of Lincoln's Weed Abatement Program combined with Lancaster Counties Noxious Weed Program.
- Lancaster County Board of Commissioners are responsible to carry out the Combined Program.
- A merger that created a more efficient and effective agency.
- More convenient for the citizens of Lincoln and Lancaster County.

# Accomplishments

- Helicopter spraying of phragmites on private property. (Paid by landowner)
- Cost-share for private landowners along Salt Creek, Oak Creek and Middle Creek from NDA through the LPWMA. (LB1038 funding)
- Continuing to scan into TRIM
- LB 1038 funding – Working with State Senators to protect this funding source.
- Serving as the chair for the Governor’s Riparian Vegetation Management Task Force.
- Appointed by the Governor to represent the Nebraska Weed Control Association on the Nebraska Invasive Species Council.
- Serving as the chair for the NWCA Legislative Committee.
- Remote Pilot Certificate from the FAA



# Noxious Weed Inspections

- Parcels inspected – 2,201
- Total inspections – 3,436
- Legal Notices sent - 54
- Force controls performed – 6
- Liens filed for non-payment – 2
- Court cases - 0



# Weed Abatement - City of Lincoln

- Parcels inspected – 3,429
- Total inspections – 7,658
- Legal notices sent - 1,139
- Force controls performed - 211
- 3,086 request for service “complaints” from the public
- Do NOT do weed abatement in the rural areas or towns & villages in the County



DIRECTION  
259 deg(T)

40.81297°N  
096.68640°W

ACCURACY 5 m  
DATUM WGS84

Family Dollar

7/19/17, 1:01:41 PM

# PRT – Problem Resolution Team



# County Right of Way – Noxious Weed Control

- Currently in our 5th season of using our own sprayer and staff to treat the perennial noxious weeds in the County ROW.
- Seeing a significant reduction in the acres infested and spending much less time and money on applications.
- Treating at the right time, instead of when outside contractors had time.
- No longer hire an outside contractor to help with ROW spraying.
- The new UTV and Sprayer have increased our productivity along the ROW's

# City of Lincoln Landfills

- Our office oversees the noxious weed control at both City landfills.
- Just completed our 2<sup>nd</sup> season.
  - Hired by the City to treat noxious weeds at both landfills.
  - Brings additional revenue into our Department, instead of us paying a contractor to do the work.
  - Work is done at the right time - instead of when other contractors had time.
  - Much better results!





# NAISMA Weed-free Forage

- Chief Inspector, Pat Dugan and myself are the only one's in Lancaster County certified to provide Weed-free forage and Weed-free gravel inspections.
- North American Invasive Species Management Association [www.naisma.org](http://www.naisma.org) - 28 States and 1 Province are involved
- Using Certified WFF on all roadside projects (State & Local)
- Provide WFF inspections for landowners



ALABAMA	ALASKA	ALBERTA
ARIZONA	CALIFORNIA	COLORADO
IOWA	IDAHO	INDIANA
ILLINOIS	KANSAS	KENTUCKY
MICHIGAN	MINNESOTA	MONTANA
MISSOURI	NORTH CAROLINA	NEBRASKA
NEW MEXICO	NORTH DAKOTA	NEVADA
OHIO	OREGON	SOUTH DAKOTA
UTAH	VIRGINIA	WASHINGTON
WISCONSIN	WYOMING	

# NAISMA Weed-free Gravel

- Lancaster County was the first County in Nebraska to require the gravel pits to be inspected and certified Noxious Weed Free. We are currently the only County certifying pits.
- Each pit is inspected to verify noxious weeds have not been allowed to produce seed.
- Any project having dirt moved into it is also required to have the borrow pit inspected prior to moving dirt.



# NO SPRAY ZONES

- Working with Sensitive Crop producers
  - Grape vineyards
  - Vegetable
  - Organic growers
  - Bee's & Honey



# Weed Management Areas (WMA's)

- Belong to the Lower Platte Weed Management Area.
- Lancaster County led the charge creating the LPWMA as it's own separate government entity. *Credit David Derbin*
- Weed Department staff along with County Treasurer and Budget and Fiscal staff provide the Accounting for the WMA.
- WMA's provide many benefits for Lancaster County landowners.

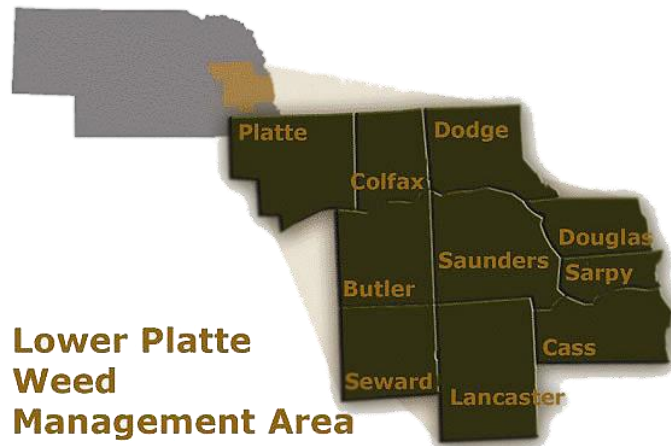

# WMA Grant Provides for Survey



Each location is GPS mapped and provided to the pilot doing applications.

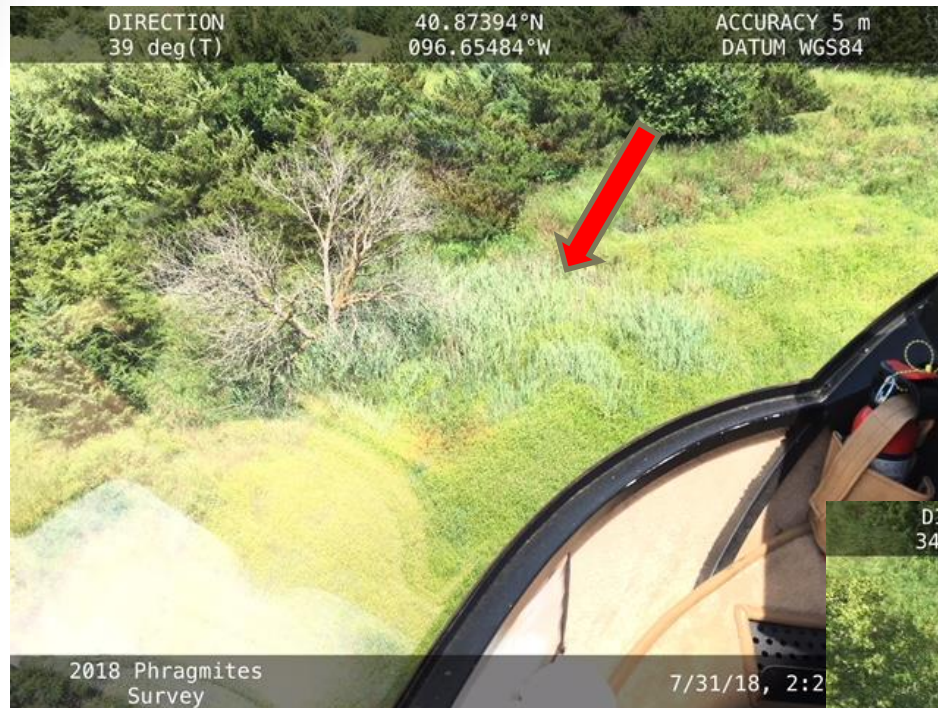

Lancaster County areas included:  
Salt Creek, Oak Creek,  
Middle Creek, 48<sup>th</sup> Street  
Landfill as well as NRD and  
Game & Parks properties.



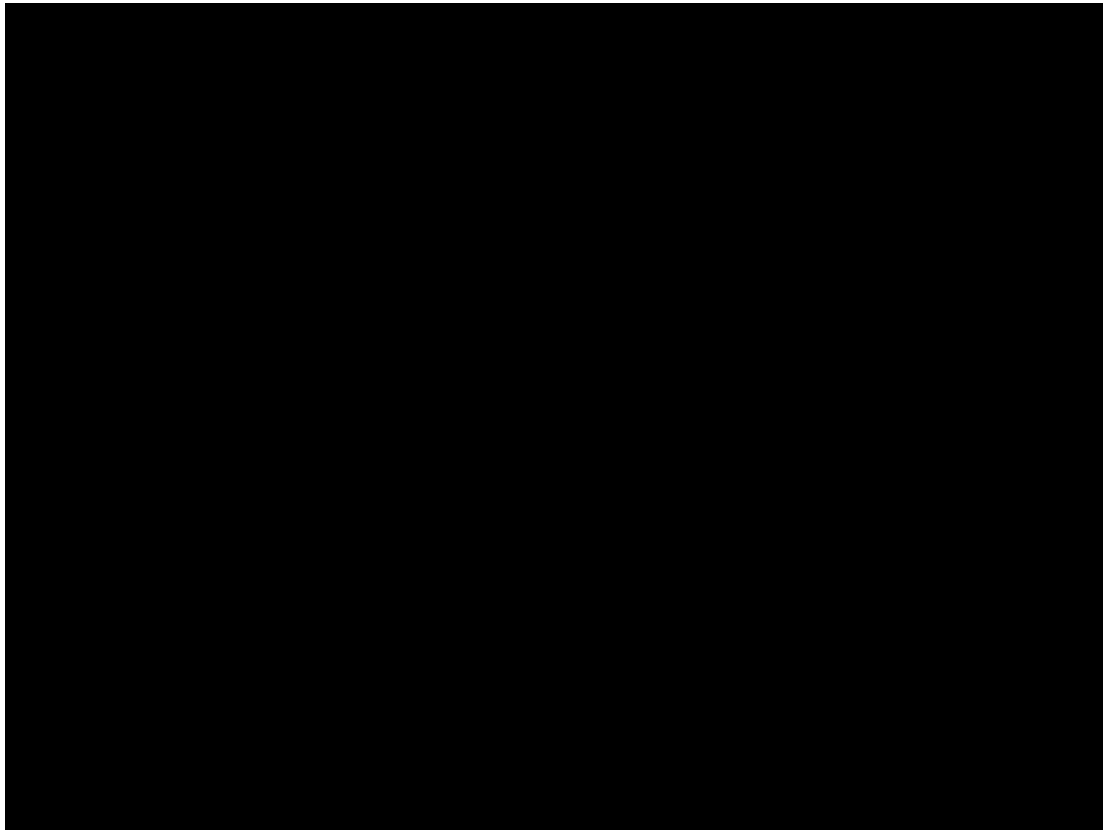

IMG\_2177.mp4

# Helicopter Applications

- Provide landowners the connection for helicopter applications
- Oversee the treatment of phragmites on Salt Creek, Oak Creek, Middle Creek and the 48<sup>th</sup> St landfill.
- Currently working with Nebraska/Iowa helicopters out of Tekamah, NE. to give landowners a local option.
- 30+ landowners signed up in 2019.





# Mapping

- GPS locations of all noxious weed locations
- Use GIS / ESRI to create GPS locations
- Inspectors use tablets that have the GPS locations loaded.
- Color coded to match the plants file color.

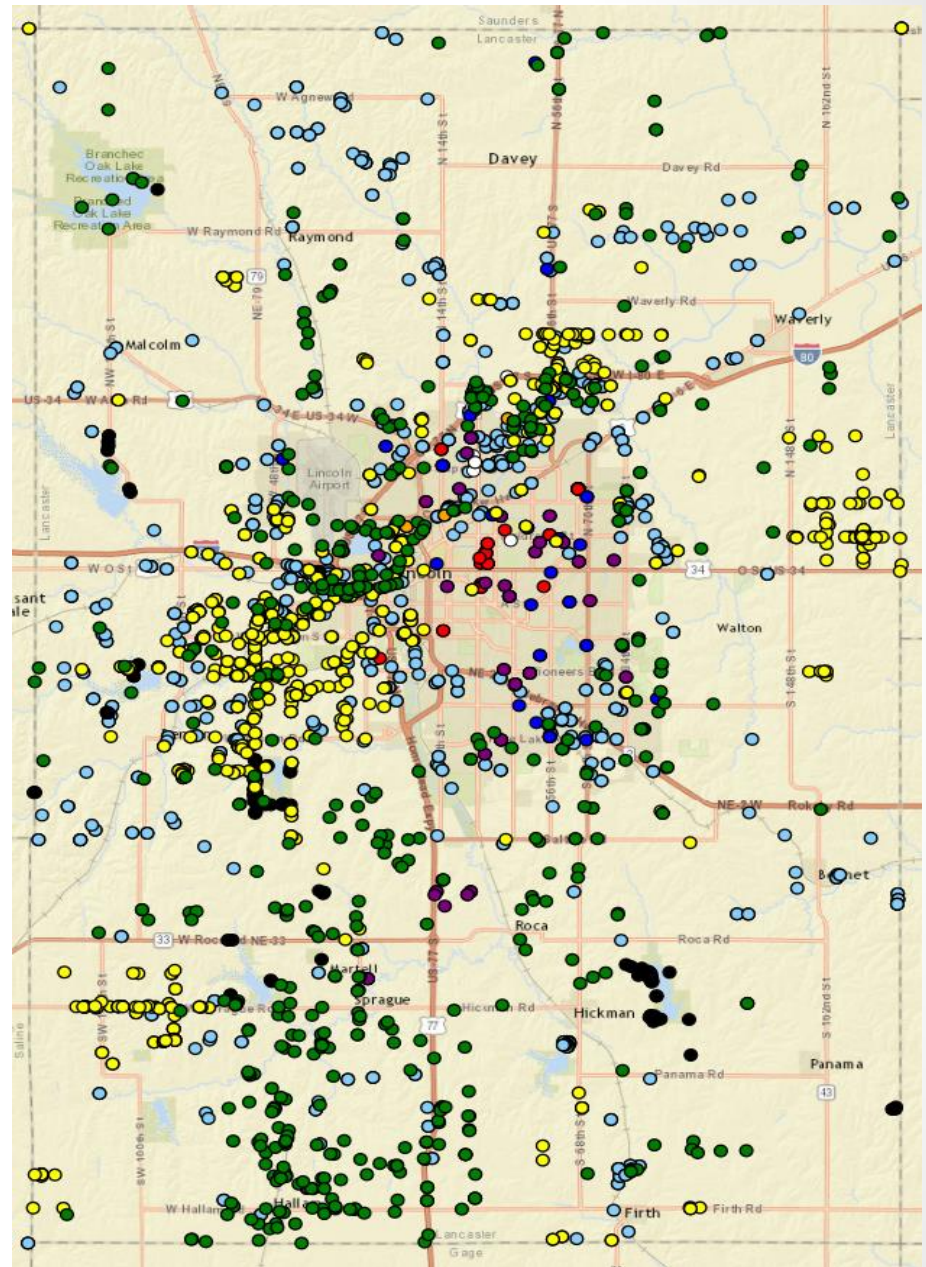

# Information Technology

- There is no way could we handle the work load we have today without the support we get from Information Services.
- Continue to build on our current programs.
- Drone use – Lower Platte WMA now owns one we can use because of our partnership.
- Continue to look at the newest technology to increase our efficiency.

# Public Relations

- Need to continue to educate landowners about invasives.
- Working with landowners to better understand the benefits of controlling their noxious weeds.
- Build relationships with landowners to see us as their resource for all weeds issues, instead of the enforcement agency.
- Weed-free forage inspections are great landowner relations
- Handle approximately 3,000 complaints from the public annually.
- Nebraska Power Farming Show in December – Lancaster Event Center
- Presented about teasel to the 5-Rivers WMA landowner meeting in Syracuse.
  
- LANCASTER COUNTY –  
PROTECTIVE PROPERTY MANAGEMENT DIVISION

# Education Opportunities – UNL Plant Pathology Class



# Outreach



**Lancaster County Weed Control**

**Lincoln Parks & Recreation**  
fundamental

"Working together to control the spread of noxious and invasive plants in the City of Lincoln and Lancaster County."

Become a Weed Watcher Volunteer and learn how to detect and report these invasive plants before they get out of hand

These invasive plants are required by State law to be controlled.

For more information on becoming a Weed Watcher volunteer, or to report a sighting contact the Lancaster County Weed Control Office

<http://lancaster.ne.gov/weeds>  
402-441-7817

**Phragmites**

**Purple loosestrife**

**Wetland Invaders**

**Saltcedar**

**Kn...**

A collage of photographs showing different types of wetland plants. The plants are labeled: Phragmites, Purple loosestrife, Saltcedar, and Knotweed. The photos show the plants in their natural wetland habitats, including close-ups of leaves, flowers, and stems.

# Goals

- Work toward “paperless” inspection work flow.
- Prevent the development of new weed infestations
- Provide education and public outreach on noxious and invasive weed control
  - Change the perception of the program to the public from enforcement - to a department they look to for information.
  - Find ways to reach the public with the information about invasives
- Provide for ongoing management of State of Nebraska – mandated noxious weeds
- Use the UTV to increase our productivity on inspections and do more of our own noxious weed herbicide applications.
- Look at ways we can be efficient and effective in every part of our operation
- Explore drone use to increase productivity

# Training - 2019

- Nebraska Weed Control Association offers 40 hours of Continuing Education each year. Brent attends as many as possible and Pat attends the Spring and Fall Trainings.
- North American Invasive Species Management Association annual conference is an excellent training to learn from invasive species managers across the Globe.
- Attend Supervisory Trainings when possible
- Website design and management training
- All employees are trained and sign off on the Harassment Policy.
- All seasonal employees spend 3 to 4 days being trained on everything from dealing with the public to County policies.

# Facility Needs

- Our office space is tight but functional. Multi-use offices
- Security for our office
- Secure chemical storage area
- Building with parking for a minimum of 3 vehicles
- Future needs may include a chemical loadout and containment facility (*Only needed if we're unable to secure outside contractors*)



# Future Challenges

- Phragmites
- Identifying new invasives moving into the area before they become a serious economic threat.
- Finding ways to educate the public about the new invasives.
- Railroads - 2019 was better than in the past
- Absentee landowners
- Noxious Weeds in Urban Areas
- Rural developments creating outlots with no value.
- New developments as the city continues to grow.
- Ornamental Yards & Front yard gardens
- Staffing
- Facilities & Security
- Vehicles and equipment

# The Preserve at Cross Creek

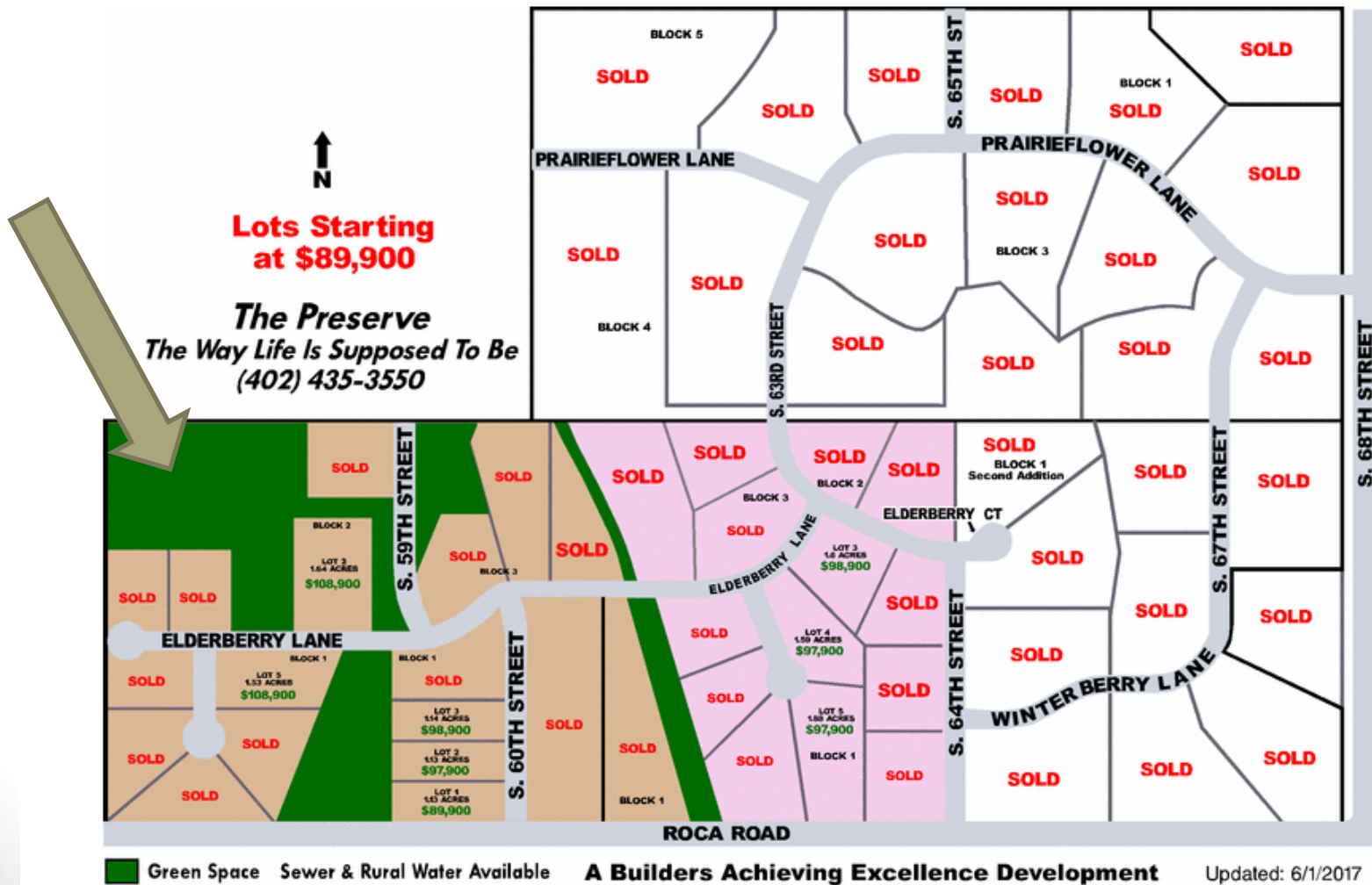

# \$0 Value / Tax Properties



Lancaster County  
Nebraska, USA

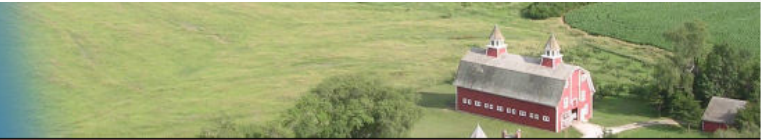

County Treasurer » Property Information Search » Property Tax Information

## Andy Stebbing Lancaster County Treasurer Property Tax Information

- Make Tax Payment
- Payment History
- View Taxbill
- Tax Sale
- Special Assessment
- Special Sale
- Assessor's Information
- Property Map

Tax Year: 2016 Roll: Real Estate Parcel: 15-16-422-005-000

Owner: LAND II LLC  
 Owner Address: 1901 SW 5 ST Apt: 100 City: LINCOLN, NE 68522  
 Situs Address: 999999 \*\*NO SITUS\*\* ST City: LINCOLN

Tax District: 0068 RURAL Tax Rate: 1.6539880 %  
 Property Class: A2 AGUNIMPROVED

Legal Description: THE PRESERVE AT CROSS CREEK 8TH ADDITION, OUTLOT D

Tax Sale: No  
 Assignment: No Special Assessment History: No Special Sale: No

### Property Payment Calculator

Payment Date:

No Payment is Due.

### Property Tax History

Year	Owner	Tax Value	Tax Amount	Paid Tax	Paid Int	Paid Fee	Owed Tax+Fee	Tax Sale
2016	LAND II LLC	0	0.00	0.00	0.00	0.00	0.00	No

[Back to Search List](#) • [New Search](#)

# Challenges



# Phragmites @ Fallbrook



## Lancaster County/City of Lincoln GIS Map

Parcel ID: 12-34-202-005-000  
Owner: NEBCO  
Address: No Data  
Legal: FALLBROOK ADDITION, OUTLOT L

Printed: Oct 04, 2012

DISCLAIMER: The information is presented on a best-efforts basis, and should not be relied upon for making financial, survey, legal or other commitments. If you have questions or comments regarding the data displayed on this map, please email [assessor@lanasterne.gov](mailto:assessor@lanasterne.gov) and you will be directed to the appropriate department.



# Ornamental Yards?

- Is a property that claims to be wildflowers and ornamental grasses ok?

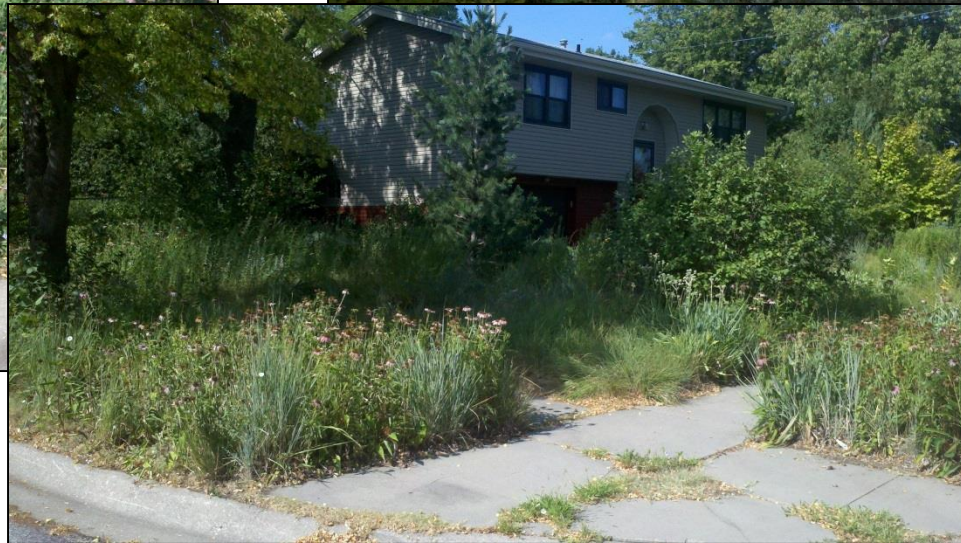
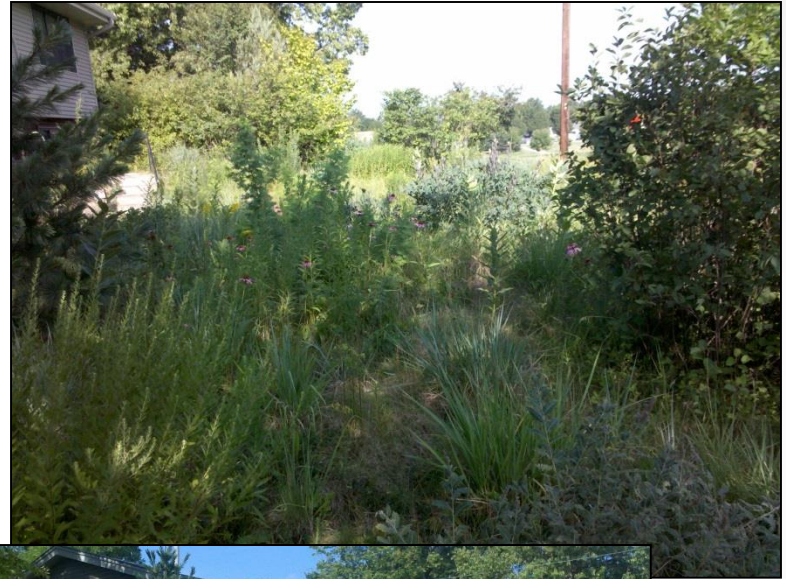
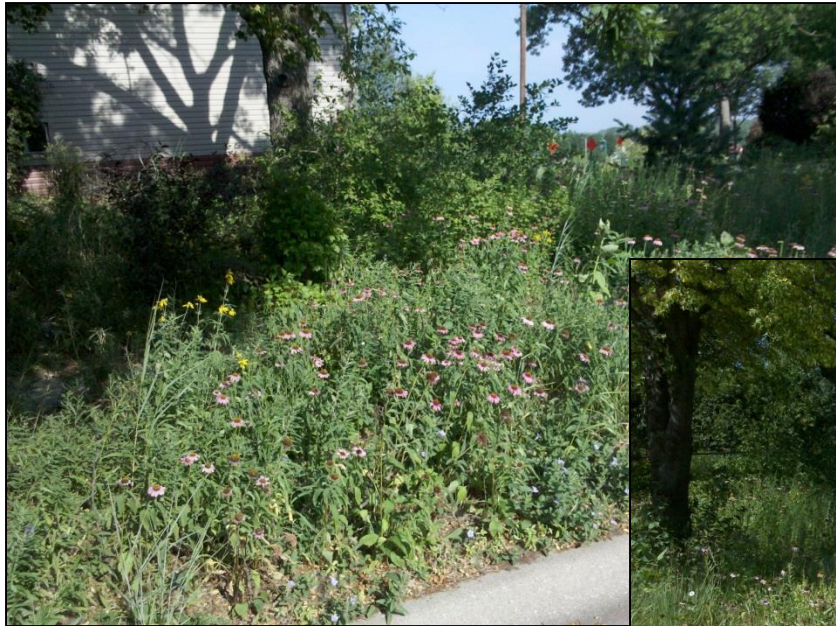

# Early Detection - Rapid Response EDRR      What will be next?

- 3 out of the last 5 noxious weeds added to Nebraska's Noxious Weed list were first sold as ornamentals.
- Lancaster County was the first County to add both Common & Cutleaf Teasel. Pawnee County and Saline County added teasel in 2018.
- Always looking for something out of place



# Giant reed / *Arundo donax*





Chinese fleece vine, *Fallopia aubertii*  
aka: Lemon lace / silver lace vine



# Yellow floating-heart Benson Park, Omaha



# Discussion

Brent Meyer, Superintendent  
Lancaster County Weed Control  
444 Cherrycreek Rd., Building B  
Lincoln, NE. 68528  
402-441-7817

[bmeyer@lancaster.ne.gov](mailto:bmeyer@lancaster.ne.gov)

[www.lancaster.ne.gov/weeds](http://www.lancaster.ne.gov/weeds)



**STOP INVASIVE SPECIES  
IN YOUR TRACKS.®**

[PlayCleanGo.org](http://PlayCleanGo.org)