

**CONTRACT DOCUMENTS**

**LANCASTER COUNTY**

**NEBRASKA**

**For**

**PROJECT NO: 20-06  
Abutment Stabilization at  
County Structures N-149, A-151 and A-138**

**URETEK USA, Inc.  
PO Box 1929  
Tomball, TX 77377-1929**

LANCASTER COUNTY, NEBRASKA  
CONTRACT AGREEMENT

THIS CONTRACT, made and entered into this \_\_\_\_\_ day of \_\_\_\_\_, \_\_\_\_\_, by and between URETEK USA, Inc., hereinafter called the Contractor, and the County of Lancaster, Nebraska, a political subdivision of the State of Nebraska, hereinafter called the County.

WHEREAS, on March 13, 2019, the County declared a state of emergency pursuant to Neb. Rev. Stat. § 81-829.50 with respect to a flooding event that started Saturday, March 9, 2019, in the County;

WHEREAS, on March 21, 2019, the Federal Emergency Management Agency declared a Major Disaster, related to the Incident Period for March 9, 2019, through April 1, 2019, in the County;

WHEREAS, the emergency and major disaster during the period described above caused serious damage to County property requiring emergency Repair at County Structures N-149, A-151, and A-138;

WHEREAS, in response to the emergency and major disaster the County has caused to be prepared Specifications, Plans, and other Contract Documents for the Work herein described, to-wit: Project No. 20-06, Abutment Stabilization at County Structures N-149, A-151 and A-138;

WHEREAS, the Contractor has submitted to the County a proposal in accordance with the Specifications, Plans, and other Contract Documents for the Work; and

WHEREAS, the County wishes to engage Contractor to perform the emergency Work pursuant to Neb. Rev. Stat. §§ 23- 3109(2) and 81-829.51;

NOW, THEREFORE, in consideration of the sums to be paid to the Contractor and the mutual covenants herein contained, the Contractor and the County hereby agree as follows:

1. The Contractor agrees to (a) furnish all tools, equipment, supplies, superintendence, transportation, and other construction accessories, services, and facilities; (b) furnish all materials, supplies, and equipment specified to be incorporated into and form a permanent part of the complete work; (c) provide and perform all necessary labor in a substantial and workmanlike manner and in accordance with the provisions of the Contract Documents; and (d) execute construct, and compete all work included in and covered by the County's award of this Contract to the Contractor, such award being based on the acceptance by the County of the Contractor's Proposal.
2. The County agrees to pay the Contractor for the performance of the work embraced in this Contract and the Contractor agrees to accept as full compensation therefor, the following sums for all work covered by and included in the Contract award and designated above, payment thereof to be made in the manner provided by the County in the sum of: Forty One Thousand Four Hundred Forty Two Dollars and 00/100 (\$41,442.00). The County will begin processing payment within thirty (30) calendar days after all labor has been performed and all equipment or other merchandise has been delivered, and all such labor and equipment and other materials have met all contract specifications.
3. **EQUAL EMPLOYMENT OPPORTUNITY:** In connection with the carrying out of this project, the Contractor shall not discriminate against any employee, applicant for employment, or any other person because of race, color, religion, sex, national origin, ancestry, disability, age or marital status. The Contractor will take affirmative action to ensure that applicants are employed, and that employees are treated during employment, without regard to their race, color, religion, sex, national origin, ancestry, disability, age or marital status. Such action shall include, but not be limited to, the following: employment, upgrading, demotion or transfer; recruitment or recruitment advertising; layoff or termination; rates of pay or other compensation; and selection for training, including apprenticeship.
4. To the extent permitted by law, the County relinquishes control of the construction site to the Contractor and its subcontractors during the period of construction. The construction, placement of barricades, and posting of warning signs in the area of construction will be the responsibility of the Contractor. This shall include the placement of construction equipment and any obstacles which are created as a result of the construction project. The placement of barricades and warning signs shall be in compliance with the Manual on Uniform Control Devices, the 2011 City of Lincoln Standard Specifications for Municipal Construction, as supplemented by the 2017 Edition of the Standard Specifications of Highway Construction of the State of Nebraska, Department of Transportation the Special Provisions, Supplementary Special Provisions, and all other supplementary documents to this Agreement. To the extent permitted by law, the Contractor expressly accepts control of the construction site, such control shall include, but not be limited to, barricades, signs, road crossings, warning signs, construction equipment and any obstacles created during construction of the project.

5. It is the express intent of the parties that this Agreement shall not create an employer-employee relationship. Employees of the Contractor shall not be deemed to be employees of the County and employees of the County shall not be deemed to be employees of the Contractor. The Contractor and the County shall be responsible to their respective employees for all salary and benefits. Neither the Contractor's employees nor the County's employees shall be entitled to any salary, wages, or benefits from the other party, including but not limited to overtime, vacation, retirement benefits, workers' compensation, sick leave or injury leave. Contractor shall also be responsible for maintaining workers' compensation insurance, unemployment insurance for its employees, and for payment of all federal, state, local and any other payroll taxes with respect to its employees' compensation.
6. Each party agrees to indemnify and hold harmless, to the fullest extent allowed by law, the other party and its principals, officers, and employees from and against all claims, demands, suits, actions, payments, liabilities, judgments and expenses (including court-ordered attorneys' fees), arising out of or resulting from the acts or omissions of their principals, officers, or employees in the performance of this Agreement. Liability includes any claims, damages, losses, and expenses arising out of or resulting from performance of this Agreement that results in any claim for damage whatsoever including any bodily injury, civil rights liability, sickness, disease, or damage to or destruction of tangible property, including the loss of use resulting therefrom. Further, each party shall maintain a policy or policies of insurance (or a self-insurance program), sufficient in coverage and amount to pay any judgments or related expenses from or in conjunction with any such claims. Nothing in this Agreement shall require either party to indemnify or hold harmless the other party from liability for the negligent or wrongful acts or omissions of said other party or its principals, officers, or employees.
7. This Contract shall be effective upon execution by both parties. The Work included in this Contract shall commence on October 17, 2019 (*or upon notice to proceed by the County*) and shall be completed on or before November 15, 2019 (*30 calendar days*).
8. All components used in the manufacture or construction of materials, supplies and equipment, and all finished materials, shall be new, the latest make/model, of the best quality, and the highest grade workmanship. Contractor shall furnish title to the material required by this Contract free and clear of all liens and encumbrances, issued in the name of the Lancaster County, Nebraska, as may be required. Material delivered under this Contract shall remain the property of the Contractor until: (i) A physical inspection and actual usage of the material is made and found to be acceptable to the County; and (ii) Material is determined to be in full compliance with the Contract. In the event the delivered material is found to be defective or does not conform to the Contractor's proposal, the County reserves the right to cancel the order upon written notice to the Contractor and return materials to the Contractor at Contractor's expense.
9. If any portion of this Agreement is held invalid, the remainder hereof shall not be affected thereby if such remainder would then continue to conform to the terms and requirements of applicable law. The laws of the State of Nebraska shall govern the rights, obligations, and remedies of the parties under this Contract. Contractor agrees to abide by all applicable local, state and federal laws and regulations concerning the handling and disclosure of private and confidential information concerning individuals and corporations as to inventions, copyrights, patents and patent rights. Contractor shall comply with Nebraska Revised Statutes 77-1323 and 77-1324: every person, partnership, limited liability company, association or corporation furnishing labor or material in the repair, alteration, improvement, erection, or construction of any public improvement shall sign a certified statement which will accompany the contract; and the certified statement shall state that all equipment to be used on the project, except that acquired since the assessment date, has been assessed for taxation for the current year, giving the county where assessed.
10. **GUARANTEE:** A Performance and Labor and Material Payment Bond in the full amount of the Contract shall be required for all construction contracts.
11. Contractor agrees that it will not discriminate against any employee or applicant for employment because of race, color, religion, sex, national origin, ancestry, disability, age, or marital status. Contractor shall comply with the provisions of the County's Affirmative Action Policy. The Equal Opportunity Officer will determine compliance or non-compliance with the County's Affirmative Action Policy upon a complete and substantial review of Contractor's equal opportunity policies, procedures and practices.
12. Contractor shall indemnify and hold harmless, to the fullest extent allowed by law, the County, its agents, officers, employees and representatives from and against all claims, demands, suits, actions, payments, liability, judgements and expenses (including court-ordered attorney's fees), arising out of or resulting from the performance of the contract that results in bodily injury, sickness, disease, death, civil rights liability, or injury to or destruction of tangible property, including the loss of use resulting therefrom, and that are caused in whole or in part by the Contractor, its employees, agents, any subcontractor, anyone directly or indirectly employed by them, or anyone for whose acts any of them may be liable. This section will not require Contractor to indemnify or hold harmless the County for any losses, claims, damages and expenses arising out of or resulting from the sole negligence of the County, its agents, employees, or representatives. In any and all claims against the County or any of its members, officers or employees by an employee of the Contractor, any subcontractor, anyone directly or indirectly employed by any of them or by anyone for whose acts made by any of them may be liable, the indemnification

obligation under this paragraph shall not be limited in any way by any limitation of the amount or type of damages, compensation or benefits payable by or for the Contractor or any subcontractor under worker's compensation acts, disability benefit acts or other employee benefit acts.

13. In accordance with Neb. Rev. Stat. 4-108 through 4-114, the Contractor agrees to register with and use a federal immigration verification system, to determine the work eligibility status of new employees performing services within the state of Nebraska. A federal immigration verification system means the electronic verification of the work authorization program of the Illegal Immigration Reform and Immigrant Responsibility Act of 1996, 8 U.S.C. 1324 a, otherwise known as the E-Verify Program, or an equivalent federal program designated by the United States Department of Homeland Security or other federal agency authorized to verify the work eligibility status of a newly hired employee pursuant to the Immigration Reform and Control Act of 1986. The Contractor shall not discriminate against any employee or applicant for employment to be employed in the performance of this section pursuant to the requirements of state law and 8 U.S.C.A. 1324b. The Contractor shall require any subcontractor to comply with the provisions of this section.
14. This Contract along with the Suppliers Response, Plans and the following Supplemental Contract Documents, attached hereto and incorporated by this reference, form this Contract:
  1. Contract Agreement
  2. Map
  3. Accepted Proposal of Contractor
  4. Specifications
  5. Special Provisions
  6. Performance and Labor and Material Payment Bond
  7. Purchasing Agent Appointment
  8. Nebraska Resale or Exempt Sale Certificate
  9. Tax Assessment Form
  10. Employer Classification Act Instructions
  11. Employee Classification Act Affidavit
  12. Insurance Clause and Certificate

The Contractor and the County hereby agree that all the terms and conditions of this Contract shall be binding upon themselves, and their heirs, administrators, executors, legal and personal representatives, successors, and assigns.

IN WITNESS WHEREOF, the Contractor and the County do hereby execute this contract.

EXECUTION BY LANCASTER COUNTY, NEBRASKA

ATTEST:

BY THE BOARD OF COUNTY COMMISSIONERS OF  
LANCASTER COUNTY, NEBRASKA

\_\_\_\_\_  
County Clerk

\_\_\_\_\_

Contract and Bond Approved as to Form

\_\_\_\_\_

this \_\_\_\_\_ day of \_\_\_\_\_, \_\_\_\_\_

\_\_\_\_\_

\_\_\_\_\_

\_\_\_\_\_  
Deputy County Attorney

\_\_\_\_\_

EXECUTION BY CONTRACTOR

IF A CORPORATION:

URETEK USA, Inc.  
Name of Corporation

ATTEST:

13900 Humble Road Tomball, TX  
(Address) 77375

Secretary

Am B. Hyde  
Secretary

By: Edward Hibbard  
Duly Authorized Official

J.P. Sales  
Legal Title of Official

IF OTHER TYPE OF ORGANIZATION:

\_\_\_\_\_  
Name of Organization

\_\_\_\_\_  
Type of Organization

\_\_\_\_\_  
Address)

By: \_\_\_\_\_  
Member

By: \_\_\_\_\_  
Member

IF AN INDIVIDUAL:

\_\_\_\_\_  
Name

\_\_\_\_\_  
Address

\_\_\_\_\_  
Signature

# Subgrade Stabilization

BUTLER COUNTY

N.W. 140th ST. N.W. 128th ST. N.W. 112th ST. N.W. 105th ST. N.W. 98th ST. N.W. 84th ST. N.W. 70th ST. N.W. 56th ST. N.W. 48th ST. N.W. 40th ST. N.W. 27th ST. N.W. 12th ST. N. 1st ST. N. 14th ST. N. 27th ST. N. 40th ST. N. 56th ST. N. 70th ST. N. 84th ST. N. 98th ST. N. 112th ST. N. 120th ST. N. 134th ST. N. 141st ST. N. 148th ST. N. 162nd ST. N. 176th ST. N. 190th ST.

SAUNDERS R 5 E

R 6 E

R 7 E

R 8 E

COUNTY

W. ASHLAND RD. 24000  
W. LITTLE SALT RD. 22500  
W. AGNEW RD. 21000  
W. ROCK CREEK RD. 19500  
W. DAVEY RD. 18000  
W. BRANCHED OAK RD. 16500  
W. RAYMOND RD. 15000  
W. MILL RD. 13500  
W. WAVERLY RD. 12000  
W. BLUFF RD. 10500  
W. McKELVIE RD. 9000  
W. ALVO RD. 7500  
W. FLETCHER AV. 6000  
W. SUPERIOR ST. 4600  
W. ADAMS ST. 3000  
W. HOLDREGE ST. 1500  
W. "O" ST. 100  
W. "A" ST. 1400  
W. VAN DORN ST. 2800  
W. PIONEERS BLVD. 4300  
W. OLD CHENEY RD. 5700  
W. DENTON RD. 7000  
W. YANKEE HILL RD. 8500  
W. ROKEBY RD. 10000  
W. SALTILLO RD. 11500  
W. BENNET RD. 13000  
W. WITTSTRUCK RD. 14500  
W. ROCA RD. 16000  
W. MARTELL RD. 17500  
W. SPRAGUE RD. 19000  
W. STAGECOACH RD. 20500  
W. PANAMA RD. 22000  
W. OLIVE CREEK RD. 23500  
W. PRINCETON RD. 25000  
W. PELLA RD. 26500  
W. HALLAM RD. 28000  
W. GAGE RD. 29500

ASHLAND RD. 24000  
LITTLE SALT RD. 22500  
AGNEW RD. 21000  
ROCK CREEK RD. 19500  
DAVEY RD. 18000  
BRANCHED OAK RD. 16500  
RAYMOND RD. 15000  
MILL RD. 13500  
WAVERLY RD. 12000  
BLUFF RD. 10500  
McKELVIE RD. 9000  
ALVO RD. 7500  
FLETCHER AV. 6000  
HAVELOCK AV. 4600  
ADAMS ST. 3000  
HOLDREGE ST. 1500  
"O" ST. 100  
"A" ST. 1400  
VAN DORN ST. 2800  
PIONEERS BLVD. 4300  
OLD CHENEY RD. 5700  
PINE LAKE RD. 7000  
YANKEE HILL RD. 8500  
ROKEBY RD. 10000  
SALTILLO RD. 11500  
BENNET RD. 13000  
WITTSTRUCK RD. 14500  
ROCA RD. 16000  
MARTELL RD. 17500  
HICKMAN RD. 19000  
STAGECOACH RD. 20500  
PANAMA RD. 22000  
OLIVE CREEK RD. 23500  
PRINCETON RD. 25000  
PELLA RD. 26500  
FIRTH RD. 28000  
GAGE RD. 29500

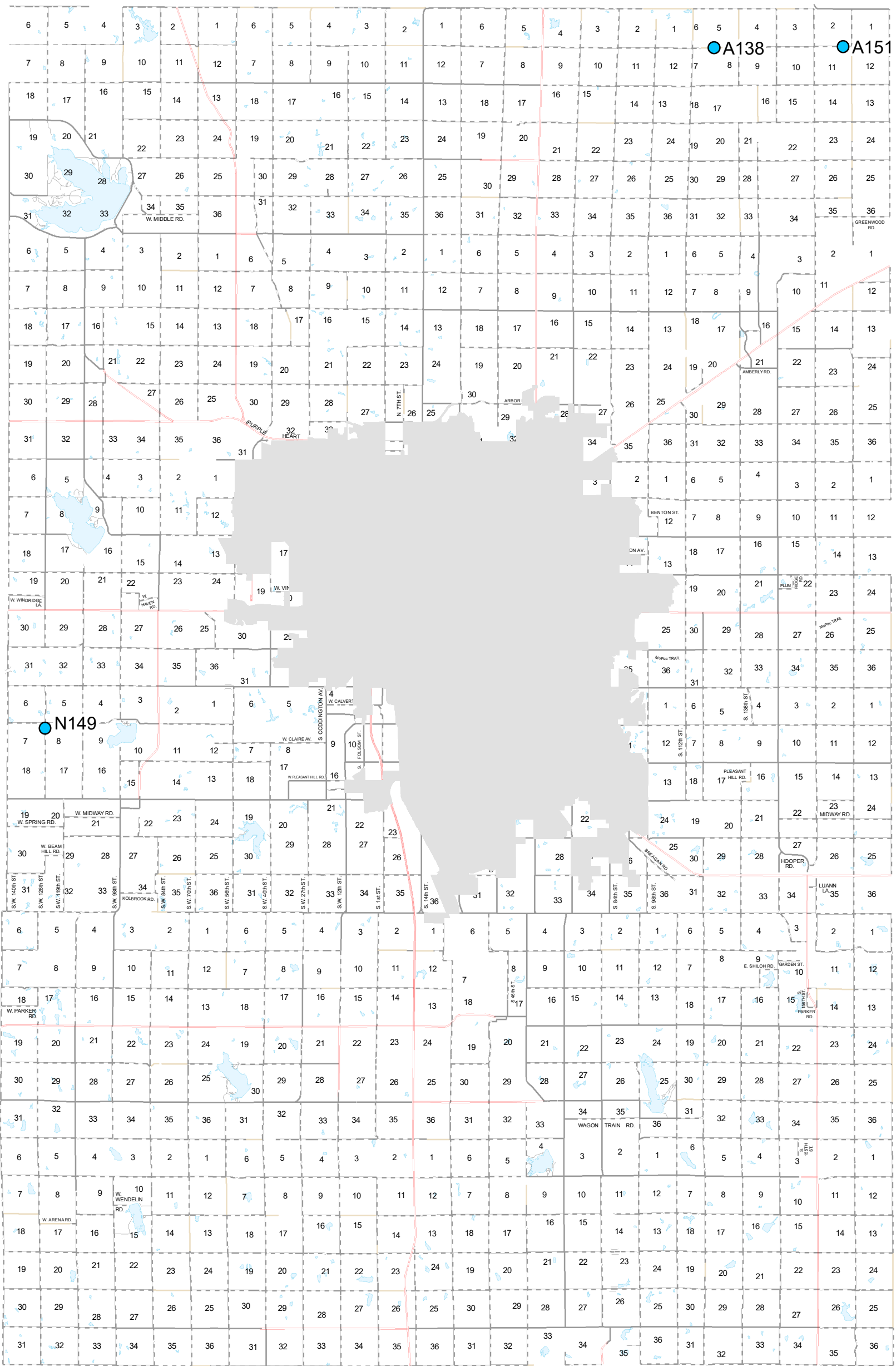

GAGE R 5 E

R 6 E

R 7 E

R 8 E

COUNTY

S.W. 142nd ST. S.W. 128th ST. S.W. 114th ST. S.W. 100th ST. S.W. 86th ST. S.W. 72nd ST. S.W. 58th ST. S.W. 42nd ST. S.W. 29th ST. S.W. 14th ST. S.W. 2nd ST. S. 12th ST. S. 25th ST. S. 38th ST. S. 54th ST. S. 68th ST. S. 82nd ST. S. 96th ST. S. 110th ST. S. 120th ST. S. 134th ST. S. 148th ST. S. 162nd ST. S. 176th ST. S. 190th ST.

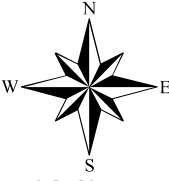

## Accepted Proposal of Contractor

| Abutment Stabilization at County Structures N-149, A-151 and A-138<br>Project No. 20-06 |                            |                    |         |            |             |
|---|----------------------------|--------------------|---------|------------|-------------|
| Line No.  | Description                | Estimated Quantity | Unit    | Unit Price | Amount      |
| <b>Group 1 - Grading</b>  |                            |                    |         |            |             |
| 1   | Location 1 (N-149) Polymer | 1,800.00           | Lbs     | \$6.49     | \$11,682.00 |
| 2   | Location 2 (A-151) Polymer | 2,000.00           | Lbs     | \$6.49     | \$12,980.00 |
| 3   | Location 3 (A-138) Polymer | 2,000.00           | Lbs     | \$6.49     | \$12,980.00 |
| 4   | Mobilization               | 1.00               | LumpSum | \$3,800.00 | \$3,800.00  |
|   | <b>Total</b>               |                    |         |            | \$41,442.00 |



September 11, 2019

**Larry L Legg P.E**  
Design Engineer  
Lancaster County Engineering  
402-441-1852  
402-430-3784  
[LLegg@lancaster.ne.gov](mailto:LLegg@lancaster.ne.gov)

URETEK USA, Inc. is pleased to present this proposal to the Lancaster County for subgrade stabilization.

**PROBLEM AND SCOPE OF WORK:**

**Location 1** - County bridge N149, located on West 126<sup>th</sup> south of Pioneers, is showing visible signs of voids on the NE corner of the bridge at the abutment. There are also visible signs of erosion between the guardrail and the wingwall on the north side.

On the north end of the bridge, we recommend the client backfill the eroded areas near the guardrail with soil. URETEK will stabilize the soils between the wingwalls and the guardrail as well as one row of injections inside the guardrails. (Approx. 14'x8') URETEK will also stabilize and void fill along the north abutment with one rows of injections at -4' and -8'. (Approx. 26'x4')

**Location 2** – County Bridge A-151, located west of 176<sup>th</sup> and Little Salt Road, is showing signs of undermining at the base of the abutment. This could indicate voids behind the abutment. URETEK will stabilize along both abutments with one row of injections at -4' and -8' and, if necessary, below the abutment to eliminate voids and weak soils. Each abutment is approximately 30' long.

**Location 3** – County Bridge Located West of 134<sup>th</sup> and Little Salt Road, is showing signs of undermining at the base of the abutment. This could indicate voids behind the abutment. URETEK will stabilize along both abutments with one row of injections at -4' and -8' and, if necessary, below the abutment to eliminate voids and weak soils. Each abutment is approximately 30'

**PROPOSED SOLUTION:**

URETEK USA will use the URETEK Deep Injection (UDI) process and our URETEK 486 STAR polymer to stabilize the soils under the roadway. Injections will continue after stabilization if lift is required.



URETEK USA will perform the following operations:

1. Drill injection holes on 4' centers and install injection tubes to depths specified in the scope section.
2. Inject the highly expansive, high strength, lightweight, water-resistant URETEK 486 STAR polymer through the tubes and into the soils beneath the base to fill the voids & stabilize the soils per the proposed scope above. Injection will continue until 1mm of movement is detected at the surface of the roadway confirming adequate soil stabilization. Since this polymer is water-resistant, it can be injected into wet soil conditions without compromising the integrity of the polymer.
3. Drill out the top 8" of grout injection holes and fill with gravel.
4. Perform final profile of all lanes of the roadway for warranty purposes.

**PROPOSED COST:**

Location 1 - Estimated: 1,800 pounds @ \$6.49/pound = \$11,682.00

Location 2 - Estimate 2,000 pounds @ \$6.49/pound = \$12,980.00

Location 3 - Estimate 2,000 pounds @ \$6.49/pound = \$12,980.00

Mobilization = ~~\$3,000.00~~ 3,800

Total Estimate = \$40,642.00 ~~\$41,442.00~~ 10-9-19

Client will only be invoiced for actual material used.

**ITEMS NOT INCLUDED IN QUOTE:**

Traffic control – joint/crack sealing – ~~bonding/bond participation~~ – prevailing wage rates – sales tax – milling of existing asphalt wedges (if required)

**SCHEDULE:**

Schedule will be discussed between URETEK USA and client after all paperwork has been approved by both sides. Operations can accommodate day or night/weekday and/or weekend work depending on the client's schedule. Traffic can be returned to the project area 15 minutes after our last injection.

**SAFETY:**

URETEK USA has an impressive safety record, because our people are our most important asset and safety is our top concern. URETEK USA has an extensive safety manual directly pertaining to our polyurethane injection process. URETEK USA has employed an industrial hygienist company to produce a safety report on our production unit, process, and personnel. The report clearly shows on-site safety procedures in using and handling the process chemicals and equipment and is available upon request.

**INSURANCE:**

URETEK USA has insurance in excess of any requirements the client may have.

**MERIT SHOP CONTRACTOR:**

URETEK USA is a merit shop contractor and all services provided by this proposal will be on a merit shop basis. All reference to labor agreement of any kind, or alluded to, in a principle contract or a sub-contract, are set aside, and not part of this proposal.

Sincerely,

**Kevin Stumpff**  
Great Plains Project Manager

**URETEK USA, Inc.**  
(402) 417-8407  
[Kevin.Stumpff@uretekusa.com](mailto:Kevin.Stumpff@uretekusa.com)

## SPECIFICATIONS

Lancaster County Engineering Department

Project 20-06

ABUTMENT STABILIZATION AT COUNTY STRUCTURES N-149, A-151 and A-138

The work detailed on the plans and contract documents will be completed in accordance with the requirements of the Nebraska Department of Transportation's 2017 Edition of the Standard Specifications for Highway Construction (NDOT Standard Specification) including all amendments, Supplemental Specifications and additions thereto effective at the date of the contract, the Special Provisions, plans and all supplementary documents are essential parts of the contract.

**REVISIONS, AMENDMENTS AND/OR SUPPLEMENTS TO THE STANDARD SPECIFICATIONS**

The following are revisions, amendments and/or supplements to the Standard Specifications:

Section 101, Article 101.0317: **Commission.** Shall mean the Board of County Commissioners of Lancaster County, Nebraska.

Section 101, Article 101.0328: **Department.** Shall mean the Lancaster County Engineering Department.

Section 101, Article 101.0335: **Engineer.** Shall mean the Lancaster County Engineer.

Section 101, Article 101.0388: **State.** Shall mean Lancaster County, Nebraska.

Section 102: This section of the Standard Specification is not applicable to this Contract.

Section 103: This section of the Standard Specification is not applicable to this Contract.

Section 105, Article 105.02  
Paragraph 6: The address for submittal of shop drawings and working drawings will be amended to:

Lancaster County Engineering Department  
444 Cherrycreek Road, Bldg. "C"  
Lincoln, NE 68528  
Attn: Shop Drawings

Section 107, Article 107.14: This section of the Standard Specification is null and void.

Section 107, Article 107.15: This section of the Standard Specification is null and void

Section 109, Article 109.07  
Paragraph 3(b): This section of the Standard Specifications is null and void.

**INSURANCE**

All Contractors shall take special note of the *Contractors Comprehensive General Liability and Workmen's Compensation and Employer Liability Insurance* requirements of the Contract documents. The Contractor will also be required to provide *Builder's Risk Insurance* if the project involves the construction of a building.

The contractor must provide proof of insurance in accordance with the Contract documents.

**DELIVERY (Construction)**

All work shall be based on the delivery schedule specified in the Special Provisions and/or Project Schedule Form. Time required for delivery of labor, materials, services, etc., as specified above is hereby made an essential element of the work pursuant to this contract.

**INDEPENDENT CONTRACTOR**

It is the express intent of the parties that this Agreement shall not create an employer-employee relationship, and the Contractor, or any employees or other persons acting on behalf of the Contractor in the performance of this Agreement, shall be deemed to be independent contractor(s) during the entire term of this Agreement or any renewals thereof. It is agreed between the parties that the designated staff shall at all times continue to be employees of the Contractor for the duration of the Agreement. The Contractor shall be responsible for all salary and benefits payable under this Agreement and the Contractor's employees shall not be entitled to any salary from the County or to any benefits made to County Employees, including, but not limited to, overtime, vacation, retirement benefits, workers' compensation, sick leave or injury leave. The Contractor shall also be responsible for maintaining workers' compensation insurance, unemployment insurance and any applicable malpractice insurance coverage for its employees, and for payment of all federal, state, local and any other payroll taxes with respect to the employee's compensation.

**SEVERABILITY**

If any portion of this Agreement is held invalid, the remainder hereof shall not be affected thereby if such remainder would then continue to conform to the terms and requirements of applicable law.

CONTRACT TIME PERIOD

The Contractor shall furnish all necessary equipment, tools, machinery, apparatus, and other means of construction; to do all work and to furnish all materials and labor necessary to complete the work in accordance with the Plans, Specifications, and Special Provisions now on file in the office of the Lancaster County Engineer; to commence said work on October 17, 2019, and to complete all work on or before November 15, 2019, (30 calendar days).

The Contractor may begin work on the contract before the date specified herein provided such a change is acceptable to the County Engineer, and that the Contractor has obtained written permission to do so.

The Contractor may, upon giving the proper written notice, begin work on the contract.

- A. The Contractor will be required to give the Project Engineer forty-eight 48 hour notice prior to commencing work at any site on the contract.
- B. Sanitary provisions will be required at the construction site IAW Section 107.06 unless otherwise directed by the Project Engineer.
- C. All temporary traffic control devices, barricades, construction signs, and not-standard signs required by the Barricade Plan, Detour Plan or Standard Plans will be properly erected and functioning prior to commencing work at the construction site.

PERFORMANCE, LABOR, AND MATERIAL PAYMENT BOND. Contractor shall furnish on forms provided by the County a Performance and Labor and Material Payment Bond in the sum of one hundred percent (100%) of the contract price, executed by the contractor and a corporate surety company authorized to transact business in the State of Nebraska. Such bond shall be conditioned upon the faithful performance of all terms and conditions of the contract documents, including the holding harmless of the County from failure to do so and including the making good of any and all guarantees which the contract documents may require; and, such bond shall be further conditioned upon the payment of all laborers and materialmen who provide labor, materials, etc. actually used or rented in the performance of the contract, including insurance premiums and interest.

SALE TAX EXEMPT STATUS

The Contractor is hereby advised that this project is sales tax exempt. The Contractor will be issued a Purchasing Agent Appointment and Sales Tax Exempt Certificate for the work on this project.

PRECONSTRUCTION CONFERENCE

At the preconstruction conference, the Contractor shall prepare and submit schedule for completion.

PERFORMANCE AND LABOR AND MATERIAL PAYMENT BOND

KNOW ALL MEN BY THESE PRESENTS, that we, Urettek USA, Inc. as principal, hereinafter referred to as "Contractor," and Western Surety Company, a corporate surety company authorized to transact business in the State of Nebraska as surety, hereinafter referred to as "Surety," are held and firmly bound unto the County of Lancaster, Nebraska, hereinafter referred to as "County," in the penal sum of Forty One Thousand Four Hundred Forty Two Dollars and 00/100 (\$41,442.00) lawful money of the United States for the payment of which sum, well and truly to be made, we bind ourselves and our heirs, executors, administrators, legal representatives, successors, and assigns jointly and severally, firmly by these presents.

THE CONDITION OF THIS OBLIGATION is such that whereas, the Contractor has entered into a certain contract with the County, dated \_\_\_\_\_, which contract hereby defined to include all contract documents (instructions to bidders, the accepted bid proposal, special and general conditions, specifications, and drawings) is by reference hereby made a part hereof and is hereinafter referred to as "Contract" for Project No. 20-06; Abutment Stabilization at County Structures N-149, A-151 and A-138, Lancaster County, Nebraska.

NOW, THEREFORE, IF THE Contractor (1) shall in all particulars well, duly, and faithfully observe, perform, and abide by each and every covenant, condition, and part of the Contract according to the true intent and meaning in each case AND save harmless and defend the County from all suits, judgments, damages, costs, charges, and expenses which may accrue from failure to do so AND make good any and all guarantees which the Contract may require of the Contractor or of the subcontractors; and (2) shall duly pay for all labor, materials, equipment, tools, repairs on machinery, provisions, utilities, fuels, lubricants, and all other supplies or materials actually used or rented by the Contractor or by the subcontractors in performance of the Contract including all insurance premiums on insurance required by the Contract together with interest as provided by law - THEN this obligation shall be and become null and void; otherwise, it shall remain in full force and effect.

PROVIDED FURTHER, that the Surety for value received hereby stipulates and agrees that no change, extension of time, alteration, or addition to the terms of the Contract or to the work to be performed thereunder shall in any wise affect the Surety's obligation on this bond; and the Surety hereby waives notice of any change, extension of time, alteration, or addition to the terms of the Contract or to the work to be performed thereunder.

IN WITNESS WHEREOF, this bond is executed this 9th day of October, 2019

[Signature]  
Witness

13900 Humble Rd., Tomball, TX 77377  
Address

[Signature]  
Witness

10101 Reunion Place, #100, San Antonio, TX 78216  
Address

Urettek USA, Inc.  
Contractor  
[Signature]  
Vice President

13900 Humble Rd., Tomball, TX  
Address

Western Surety Company  
Surety  
[Signature]  
Attorney-in-fact Betty J. Reeh

151 N. Franklin, Chicago, IL 60606  
Address



(Accompany this bond with Attorney-in-fact's authority from Surety, certified to include the above date of the bond.)

# Western Surety Company

## POWER OF ATTORNEY APPOINTING INDIVIDUAL ATTORNEY-IN-FACT

Know All Men By These Presents, That WESTERN SURETY COMPANY, a South Dakota corporation, is a duly organized and existing corporation having its principal office in the City of Sioux Falls, and State of South Dakota, and that it does by virtue of the signature and seal herein affixed hereby make, constitute and appoint

**Gary W Wheatley, Bryan K Moore, Clark D Fresher, Betty J Reeh, Individually, of San Antonio, TX**  
**Michael D Hendrickson, Patricia Ann Lyttle, Individually, of Irving, TX**

its true and lawful Attorney(s)-in-Fact with full power and authority hereby conferred to sign, seal and execute for and on its behalf bonds, undertakings and other obligatory instruments of similar nature

### - In Unlimited Amounts -

and to bind it thereby as fully and to the same extent as if such instruments were signed by a duly authorized officer of the corporation and all the acts of said Attorney, pursuant to the authority hereby given, are hereby ratified and confirmed.

This Power of Attorney is made and executed pursuant to and by authority of the By-Law printed on the reverse hereof, duly adopted, as indicated, by the shareholders of the corporation.

In Witness Whereof, WESTERN SURETY COMPANY has caused these presents to be signed by its Vice President and its corporate seal to be hereto affixed on this 5th day of September, 2017.



WESTERN SURETY COMPANY

*Paul T. Bruflat*

Paul T. Bruflat, Vice President

State of South Dakota }  
County of Minnehaha } ss

On this 5th day of September, 2017, before me personally came Paul T. Bruflat, to me known, who, being by me duly sworn, did depose and say: that he resides in the City of Sioux Falls, State of South Dakota; that he is the Vice President of WESTERN SURETY COMPANY described in and which executed the above instrument; that he knows the seal of said corporation; that the seal affixed to the said instrument is such corporate seal; that it was so affixed pursuant to authority given by the Board of Directors of said corporation and that he signed his name thereto pursuant to like authority, and acknowledges same to be the act and deed of said corporation.

My commission expires  
June 23, 2021



*J. Mohr*

J. Mohr, Notary Public

### CERTIFICATE

I, L. Nelson, Assistant Secretary of WESTERN SURETY COMPANY do hereby certify that the Power of Attorney hereinabove set forth is still in force, and further certify that the By-Law of the corporation printed on the reverse hereof is still in force. In testimony whereof I have hereunto subscribed my name and affixed the seal of the said corporation this 9th day of October, 2019.



WESTERN SURETY COMPANY

*L. Nelson*

L. Nelson, Assistant Secretary

Figure: 28 TAC §1.601(a)(3)

**IMPORTANT NOTICE**

- 1 To obtain information or make a complaint:
- 2 You may contact Western Surety Company, Surety Bonding Company of America or Universal Surety of America at 605-336-0850.
- 3 You may call Western Surety Company's, Surety Bonding Company of America's or Universal Surety of America's toll-free telephone number for information or to make a complaint at:

**1-800-331-6053**

- 4 You may also write to Western Surety Company, Surety Bonding Company of America or Universal Surety of America at:

P.O. Box 5077  
Sioux Falls, SD 57117-5077

- 5 You may contact the Texas Department of Insurance to obtain information on companies, coverages, rights or complaints at:

**1-800-252-3439**

- 6 You may write the Texas Department of Insurance:

P.O. Box 149104  
Austin, TX 78714-9104  
Fax: (512) 490-1007  
Web: [www.tdi.texas.gov](http://www.tdi.texas.gov)  
E-Mail: [ConsumerProtection@tdi.texas.gov](mailto:ConsumerProtection@tdi.texas.gov)

- 7 **PREMIUM OR CLAIM DISPUTES:**  
Should you have a dispute concerning your premium or about a claim you should contact Western Surety Company, Surety Bonding Company of America or Universal Surety of America first. If the dispute is not resolved, you may contact the Texas Department of Insurance.

- 8 **ATTACH THIS NOTICE TO YOUR POLICY:**  
This notice is for information only and does not become a part or condition of the attached document.

**AVISO IMPORTANTE**

Para obtener informacion o para someter una queja:

Puede comunicarse con Western Surety Company, Surety Bonding Company of America o Universal Surety of America al 605-336-0850.

Usted puede llamar al numero de telefono gratis de Western Surety Company's, Surety Bonding Company of America's o Universal Surety of America's para informacion o para someter una queja al:

**1-800-331-6053**

Usted tambien puede escribir a Western Surety Company, Surety Bonding Company of America o Universal Surety of America:

P.O. Box 5077  
Sioux Falls, SD 57117-5077

Puede comunicarse con el Departamento de Seguros de Texas para obtener informacion acerca de companias, coberturas, derechos o quejas al:

**1-800-252-3439**

Puede escribir al Departamento de Seguros de Texas:

P.O. Box 149104  
Austin, TX 78714-9104  
Fax: (512) 490-1007  
Web: [www.tdi.texas.gov](http://www.tdi.texas.gov)  
E-Mail: [ConsumerProtection@tdi.texas.gov](mailto:ConsumerProtection@tdi.texas.gov)

**DISPUTAS SOBRE PRIMAS O RECLAMOS:**  
Si tiene una disputa concerniente a su prima o a un reclamo, debe comunicarse con el Western Surety Company, Surety Bonding Company of America o Universal Surety of America primero. Si no se resuelve la disputa, puede entonces comunicarse con el departamento (TDI).

**UNA ESTE AVISO A SU POLIZA:** Este aviso es solo para proposito de informacion y no se convierte en parte o condicion del documento adjunto.



**State of Texas**

**Claim Notice Endorsement**

To be attached to and form a part of Bond No. 30074235.

In accordance with Section 2253.021(f) of the Texas Government Code and Section 53.202(6) of the Texas Property Code any notice of claim to the named surety under this bond(s) should be sent to:

**CNA Surety  
151 North Franklin, 17th Floor  
Chicago, IL 60606**

**Telephone: 1-877-672-6115**

## CONTRACT AGREEMENT

### RE: PURCHASING AGENT APPOINTMENT

The Contractor performing work for the County of Lancaster, Nebraska, will be issued a Purchasing Agent Appointment signed by the Purchasing Agent of the County. It is to be used by the Contractor and his subcontractors when purchasing tangible personal property to be actually incorporated into the contract work including materials incidental but necessary to the performance of the contract, provided that such materials are actually incorporated into the contract work. It does not apply to either (1) the purchase of materials to be used but not incorporated into the contract work including but not limited to form lumber, scaffold, etc.; or (2) the purchase or rental of machinery, equipment, or tools owned or leased by the Contractor or his subcontractors and used in performing the contract work.

Purchase qualifying as aforesaid shall be considered as being made by the County. The County shall be obligated to the vendor for the purchase price; but the Contractor or subcontractor, as the case may be, shall handle all payments therefore on behalf of the County. The vendor shall agree to make demand or claim for payment of the purchase price from the County by submitting an invoice to the Contractor or subcontractor. Title to all materials and supplies so qualifying shall vest in the County directly from the vendor; and regardless of the method of payment, title shall vest in the County as otherwise provided in the contract with the County. The Contractor or subcontractor shall not acquire title to any material incorporated into the project. All invoices shall bear the Contractor's or subcontractor's name as agent for the County.

The Contractor may reproduce copies of this Contract Agreement and of the original of the aforesaid Appointment and Certificate to furnish to his suppliers on each invoice or order. The Contractor shall enter the supplier's (the vendor's) name and address, the date, the invoice or order number, a description of the items, and the amount in the spaces provided and shall sign the certificate on the line provided for the "Purchaser's Agent."

The Contractor shall provide each subcontractor with a copy of this Contract Agreement; and of said Appointment and Certificate, the Contractor shall add the subcontractor's name and address in the places provided therefore. Each subcontractor is hereby given the authority to reproduce copies of the copy of said Appointment and Certificate thus provided him by the Contractor and to furnish the same to his (the subcontractor's) suppliers on each invoice or order, and the subcontractor shall complete and sign the same for his purchases in like manner as above set forth for the Contractor.



## Instructions

**Who May Issue a Resale Certificate.** Purchasers are to give the seller a properly completed Form 13, Section A, when making purchases of property or taxable services that will subsequently be resold in the purchaser's normal course of business. The property or services must be resold in the same form or condition as when purchased, or as an ingredient or component part of other property that will be resold.

**Who May Issue an Exempt Sale Certificate.** Form 13, Section B, may be completed and issued by governmental units or organizations that are exempt from paying Nebraska sales and use taxes. See this list in the [Nebraska Sales Tax Exemptions Chart](#). Most nonprofit organizations are **not** exempt from paying sales and use tax. Enter the appropriate number from "Exemption Categories" (listed below) that properly reflects the basis for your exemption.

For additional information about proper issuance and use of this certificate, please review [Reg-1-013, Sale for Resale – Resale Certificate](#), and [Reg-1-014, Exempt Sale Certificate](#).

**Contractors.** Contractors complete Form 13, Section C, part 1 or part 2 based on the option elected on the [Contractor Registration Database](#).

To make tax-exempt purchases of building materials and fixtures, Option 1 or Option 3 contractors must complete Form 13, Section C, Part 1. To make tax-exempt purchases of building materials and fixtures pursuant to a construction project for an exempt governmental unit or an exempt nonprofit organization, Option 2 contractors must complete Form 13, Section C, Part 2. The contractor must also attach a copy of a properly completed [Purchasing Agent Appointment and Delegation of Authority for Sales and Use Tax, Form 17](#), to the Form 13, and both documents must be given to the supplier when purchasing building materials. See the [contractor information guides](#) and [Reg-1-017, Contractors](#), for additional information. Also, see the Important Note under "Exemption Categories" number 3.

**When and Where to Issue.** The Form 13 must be given to the seller at the time of the purchase to document why sales tax does not apply to the purchase. The Form 13 must be kept with the seller's records for audit purposes.

**Sales Tax Number.** A purchaser who is engaged in business as a wholesaler or manufacturer is not required to provide an ID number when completing Section A. Out-of-state purchasers may provide their home state sales tax number. Section B does not require a Nebraska ID number when exemption category 1, 2, or 5 is indicated.

**Fully Completed Resale or Exempt Sale Certificate.** A fully completed resale or exempt sale certificate is proof for the retailer that the sale was for resale or is exempt. For a resale certificate to be fully completed, it must include: (1) identification of the purchaser and seller, type of business engaged in by the purchaser; (2) sales tax permit number; (3) signature of an authorized person; and (4) the date of issuance.

For an exempt sale certificate to be fully completed, it must include: (1) identification of purchaser and seller; (2) a statement that the certificate is for a single purchase or is a blanket certificate covering future sales; (3) a statement of the basis for exemption, including the type of activity engaged in by the purchaser; (4) signature of an authorized person; and (5) the date of issuance.

**Penalties.** Any purchaser who gives a Form 13 to a seller for any purchase which is other than for resale, lease, or rental in the normal course of the purchaser's business, or is not otherwise exempted from sales and use tax under the Nebraska Revenue Act, is subject to a penalty of \$100 or ten times the tax, whichever is greater, for each instance of presentation and misuse. In addition, any purchaser, or their agent, who fraudulently signs a Form 13 may be found guilty of a Class IV misdemeanor.

### Exemption Categories

(Insert appropriate number from the list below in Section B)

1. Governmental units, identified in [Reg-1-072, United States Government and Federal Corporations](#); and [Reg-1-093, Governmental Units](#). Governmental units are not assigned exemption numbers.

Sales to the U.S. government, its agencies, instrumentalities, and corporations wholly owned by the U.S. government are exempt from sales tax. However, sales to institutions chartered or created under federal authority, but which are not directly operated and controlled by the U.S. government for the benefit of the public, generally are taxable.

Purchases by governmental units that are **not** exempt from Nebraska sales and use taxes include, but are not limited to: governmental units of other states; sanitary and improvement districts; rural water districts; railroad transportation safety districts; and county historical societies.

2. Purchases when the intended use renders it exempt. See [Nebraska Sales Tax Exemption Chart](#).
3. Purchases made by organizations that have been issued a [Nebraska Exempt Organization Certificate of Exemption](#) (Certificate of Exemption). [Reg-1-090, Nonprofit Organizations](#); [Reg-1-091, Religious Organizations](#); and [Reg-1-092, Educational Institutions](#), identify these organizations. These organizations are issued a Certificate of Exemption with a state ID number which must be entered in Section B of Form 13.

**Important Note:** Nonprofit educational institutions must be accredited regionally or nationally and have their primary campus in Nebraska to be exempt from sales and use tax. Also nonprofit organizations providing any of the types of health care or services that qualify to be exempt must be licensed or certified by the Nebraska Department of Health and Human Services (DHHS) to be exempt from sales and use taxes. There is no sales and use tax exemption prior to these entities being accredited, licensed, or certified. They CANNOT issue either a [Resale or Exempt Sale Certificate, Form 13](#), or a [Purchasing Agent Appointment, Form 17](#), to any retailer or contractor relating to purchases of building materials for construction or repair projects performed prior to being accredited, licensed, or certified. After an entity becomes accredited, licensed, or certified upon completion of the construction project, it may submit a [Form 4](#).

Nonprofit health care organizations that hold a Certificate of Exemption are exempt for purchases for use at their facility, or portion of the facility, covered by the license issued under the Nebraska Health Care Facility Licensure Act. Only specific types of health care facilities and activities are exempt. Purchases of items for use at facilities that are not covered under the license, or for any other activities that are not specifically exempt, are taxable. The exemption is not for the entire organization that offers different levels of health care or other activities, but is limited to the specific type of health care that is exempt. Purchases for non-exempt types of health care are taxable.

4. Purchases of motor vehicles, trailers, semitrailers watercraft, and aircraft used predominately as common or contract carrier vehicles; accessories that physically become part of the common or contract carrier vehicle; and repair and replacement parts for these vehicles. The exemption ID number must be entered in Section B of the Form 13. An individual or business that has been issued a common or contract carrier certificate of exemption may only use it to purchase those items described above prior to the expiration date on the certificate. The certificate of exemption expires every 5 years. (See [Nebraska Common or Contract Carrier Information Guide](#)).
5. Purchases of manufacturing machinery and equipment made by a person engaged in the business of manufacturing, including repair and replacement parts or accessories, for use in manufacturing. (See [Reg-1-107, Manufacturing Machinery and Equipment Exemption](#)).
6. Occasional sales of used business or farm machinery or equipment productively used by the seller as a depreciable capital asset for more than one year in his or her business. The seller must have previously paid tax on the item being sold. The seller must complete, sign, and give the Exempt Sale Certificate to the purchaser. (See [Reg-1-022, Occasional Sales](#)). The Form 13 must be kept with the purchaser's records for audit purposes.

# Purchasing Agent Appointment and Delegation of Authority for Sales and Use Tax

| PURCHASING AGENT APPOINTMENT                            |             |                        |  |             |                   |
|---|-------------|------------------------|--|-------------|-------------------|
| Name and Address of Prime Contractor                    |             |                        | Name and Address of Governmental Unit or Exempt Organization         |             |                   |
| Name<br>URETEK USA, Inc.                                |             |                        | Name<br>Lancaster County   |             |                   |
| Street or Other Mailing Address<br>PO Box 19219         |             |                        | Street or Other Mailing Address<br>555 S. 10th St.                   |             |                   |
| City<br>Tomball,  | State<br>TX | Zip Code<br>77377-1929 | City<br>Lincoln,   | State<br>NE | Zip Code<br>68508 |
| Name and Location of Project                            |             |                        | Appointment Information  |             |                   |
| Name<br>Abutment Stabilization at N-149, A151 and A-138 |             |                        | Effective Date (see Instructions)                                    |             |                   |
| Street or Other Mailing Address                         |             |                        | Expiration Date  |             |                   |
| City<br>Lancaster County                                | State<br>NE | Zip Code               | Nebraska Exemption Number (Exempt Organizations Only)<br>N/A (Gov't) |             |                   |
| Identify Project<br>Project No. 20-06                   |             |                        |  |             |                   |

The undersigned governmental unit or exempt organization appoints the above-named contractor and the contractor's delegated subcontractors as its agent to purchase and pay for building materials that will be annexed to real estate by them into the tax exempt construction project stated above.

**sign here** →

Authorized Signature of Governmental Unit or Exempt Organization

Title

Date

| DELEGATION OF PRIME CONTRACTOR'S AUTHORITY |       |          |                        |  |  |
|--|-------|----------|------------------------|--|--|
| Name and Address of Subcontractor          |       |          | Delegation Information |  |  |
| Name                                       |       |          | Effective Date         |  |  |
| Street or Other Mailing Address            |       |          | Expiration Date        |  |  |
| City                                       | State | Zip Code | Portion of Project     |  |  |

The undersigned prime contractor hereby delegates authority to act as the purchasing agent of the named governmental unit or exempt organization to the above-named subcontractor.

**sign here** →

Signature of Prime Contractor or Authorized Representative

Title

Date

## INSTRUCTIONS

**WHO MUST FILE.** Any governmental unit or organization that is **exempt** from sales and use tax may appoint as its agent a prime contractor to purchase building materials and/or fixtures that will be annexed to property that belongs to or will belong to the governmental unit or exempt organization pursuant to a construction contract with the governmental unit or exempt organization. The appointment of the prime contractor as its agent is completed by issuing a Purchasing Agent Appointment and Delegation of Authority for Sales and Use Tax, Form 17, to the prime contractor. The Form 17 is required to be given to the contractor **BEFORE** he or she annexes building materials. The governmental unit or exempt organization must identify the project (e.g., east wing, chapel construction, or new school auditorium). Most

nonprofit organizations are NOT exempt from sales tax in Nebraska. In addition, not all governmental units are exempt from Nebraska sales tax. Refer to [Contractor Information](#) on our Web site for additional information on exempt entities. A contractor can confirm the exempt status of a governmental unit or exempt organization by contacting the Nebraska Department of Revenue.

The exemption from the payment of the Nebraska and local option sales and use taxes only applies if the governmental unit or exempt organization directly, or through its contractor, pays for the building materials. **IMPORTANT NOTE:** When an organization that requires licensure in order to be exempt (i.e., nonprofit hospitals), but is not licensed at the time of the construction project, the exempt organization **CANNOT**

issue either a purchasing agent appointment or an exemption certificate. If the exempt organization becomes licensed upon completion of the project, it may apply for a refund of the tax paid or collected by the contractors.

**WHEN TO FILE.** A prime contractor engaging in a construction project with a governmental unit or exempt organization must receive a properly completed and signed Form 17 **BEFORE** any building materials are annexed. If Form 17 is not issued, the contractor must pay the sales and use taxes and the governmental unit or exempt organization may obtain a refund of the taxes paid by the contractor.

**WHERE TO FILE.** A copy of the completed form should be retained by the governmental unit or exempt organization issuing the Form 17. The original is to be retained by the prime contractor. Copies of this form must be made by the prime contractor for delegation purposes to any subcontractors working on the project identified on this form.

**APPOINTMENT INFORMATION.** Enter the dates the purchasing agent appointment will become effective and when it will expire. This appointment will not allow any purchases without payment of the tax by the prime contractor or subcontractor before the effective date or after the expiration date. The dates the delegation becomes effective and the expiration dates must be completed. The phrase "upon completion" or similar phrase is not acceptable as an expiration date. The governmental unit or exempt organization may need to issue another Form 17 if the project is not completed within the prior "effective" and "expiration" dates. Exempt organizations must enter their Nebraska Sales and Use Tax Exemption number.

**DELEGATION OF PRIME CONTRACTOR'S AUTHORITY.** The prime contractor may delegate his or her authority to act as the purchasing agent of the governmental unit or exempt organization to a subcontractor. The prime contractor must complete his or her copy of Form 17 for each subcontractor who is delegated authority to act as a purchasing agent. Reproductions of this delegation must be provided to the subcontractor, who must retain a copy for his or her records, and to the governmental unit or exempt organization.

Enter the dates the delegation of the subcontractor will become effective, when it will expire, and the portion of the project delegated. This delegation will not allow any purchases without payment of the tax by the subcontractor before the delegation date or after the expiration date. Any further delegation from a subcontractor to additional subcontractors must be delegated by providing a copy of the Form 17 that they received from the prime contractor and attaching it to a separate Form 17 with any further delegation to other subcontractors. The purchasing agent appointment is limited to the contractor's purchase of building materials and/or fixtures for the specific project and is only valid during the appointment dates shown on the Form 17.

**EXEMPT SALE CERTIFICATE.** A prime contractor who has been appointed to act as a purchasing agent by a governmental unit or exempt organization, and who hires a subcontractor operating as an Option 1 contractor, must provide to that subcontractor a completed copy of Form 17 and a Nebraska Resale or Exempt Sale Certificate, Form 13, with Section C,

Part 2, completed. The subcontractor will retain these forms in his or her records, and will not charge the contractor sales tax on any portion of the invoice involving the annexation of materials to the specific project identified on the Form 17. If these forms are not provided to the subcontractor operating under Option 1, the subcontractor must collect and remit sales tax on the charge for the separately stated building materials portion of the invoice. If the Option 1 subcontractor does not separately state the charge for the building materials from contractor labor, then the entire charge is taxable to the prime contractor.

Contractors operating under Option 2 (maintaining a tax-paid inventory) who have been issued a Form 17 from a governmental unit or an exempt organization, must furnish each vendor a copy of the Form 17 and a Form 13, completing Section C, Part 2, when purchasing building materials that will be annexed to real estate. Forms 13 and 17 must be retained with the vendor's and contractor's records for audit purposes. A contractor or subcontractor may reproduce copies of these documents which will be furnished to the vendors for each invoice or order made by them.

Invoices from vendors for the purchase of building materials by the contractor as purchasing agent, or the authorized subcontractor, must clearly identify that such purchase is for the specific Form 17 project.

**CREDIT/REFUND OF SALES AND USE TAX.** A contractor or subcontractor who has been appointed as a purchasing agent before any materials are annexed, may withdraw sales or use tax-paid materials from inventory that will be annexed to real estate or used to repair property annexed to real estate and receive a credit for the sales or use tax amount previously paid on those materials.

The contractor or subcontractor may take a credit either against his or her current tax liability, or file a Claim for Overpayment of Sales and Use Tax, Form 7, and receive a refund of the sales or use tax paid on those materials.

**TOOLS, EQUIPMENT, AND SUPPLIES.** The purchase, rental, or lease of tools, supplies, or equipment (i.e., scaffolding, barricades, machinery, etc.) by a contractor for use in the completion of an exempt project CANNOT be purchased tax free, even if the contractor has been issued a Form 17. These items do not become annexed to the real estate.

**OPTION 1 CONTRACTOR ONLY.** If an Option 1 contractor is the **only** contractor involved in performing work for a governmental unit or exempt organization, a Form 17 is NOT required. The Option 1 contractor must only obtain a Form 13, Section B, from the exempt project owner.

**PENALTY.** Any person who signs this document with the intent to evade payment of tax is liable for the sales and use tax, interest, and penalty, and may be found guilty of a misdemeanor.

**AUTHORIZED SIGNATURE.** The purchasing agent appointment must be signed by an officer of the exempt organization or proper government official. The delegation of prime contractor's authority must be signed by the owner, partner, corporate officer, or other individual authorized to sign by a power of attorney on file with the Nebraska Department of Revenue.





LANCASTER COUNTY

EMPLOYER CLASSIFICATION ACT INSTRUCTIONS

WHEREAS, there is concern over the inappropriate competitive advantages in the public bidding process for local publicly funded construction and delivery service contracts resulting from the misclassification of individuals performing construction labor services as "independent contractors" rather than "employees"; such "independent contractors" are commonly referred to as "1099 workers" due to the IRS form they receive rather than a W-4 which an employee receives;

WHEREAS, this mis-classification of such individuals as "independent contractors" rather than as "employees" eliminates any obligation to pay these individuals legally required minimum or overtime wages, to provide legally required workers' compensation insurance, to make unemployment insurance payments, to pay legally required employment and payroll taxes, and to provide any other health, pension, or benefit such individuals would typically receive if properly classified as employees;

WHEREAS, this mis-classification of individuals performing construction labor services for the contractor as "independent contractors" rather than "employees" is a violation of federal and state law, but is difficult to enforce once public construction or delivery service contracts have been bid, awarded, and entered into;

WHEREAS, the use of public funds to compensate contractors who unlawfully avoid their obligation to pay legally required minimum or overtime wages, to provide legally required workers' compensation insurance, to make unemployment insurance payments, to pay legally required employment and payroll taxes, and to provide any other health, pension, or benefit is not in the public interest; and

WHEREAS, the Employee Classification Act, *Neb. Rev. Stat. §§ 48-2901 to 48-2912* (effective July 15, 2010) provides that any contract entered into between a political subdivision and a contractor shall require that each contractor who performs construction or delivery service pursuant to the contract submit to the political subdivision an affidavit attesting that (1) each individual performing services for such contractor is properly classified under the Employee Classification Act, (2) such contractor has completed a federal I-9 immigration form and has such form on file for each employee performing service, (3) such contractor has complied with *Neb. Rev. Stat. § 4-114* requirements that the contractor register and use a federal immigration employment verification system to determine the work eligibility status of new employees physically performing services in the State of Nebraska, (4) such contractor has no reasonable basis to believe that any individual performing services for such contractor is an undocumented worker, and (5) as of the time of the contract, such contractor is not barred from contracting with the state or any political subdivision pursuant to *§ 48-2912 of the Employee Classification Act*.

NOW, THEREFORE, Lancaster County adopts the following policy as to the bid and award of contracts to contractors for construction and delivery services with Lancaster County;

The Purchasing Agent shall immediately include in the County's notice to bidders for construction contracts that all contractors submitting bids in response to the notice shall affirmatively certify to the Purchasing Agent that all individuals hired to perform construction or delivery labor services for the contractor under the contract shall be properly classified as employees and not as independent contractors if the individual does not meet the requirements of an independent contractor under federal and state law (including the requirements of the State of Nebraska Employee Classification Act), and that the contractor will comply with all legal obligations with respect to these employees (including, but not limited to , minimum and overtime pay, workers' compensation, unemployment compensation, and payment of federal and state payroll taxes). The notice to bidders shall further provide that contractors may use affidavits required pursuant to the Employee Classification Act for this purpose, but that a failure to make the affirmative certification to the Purchasing Agent shall render the bidder ineligible for award of the contract.

The Purchasing Agent shall immediately include the following provisions in contracts for construction or delivery services:

(1) Contractor agrees that each individual performing services for the contractor shall be properly classified as an employee and not as an independent contractor if the individual does not meet the requirements of an independent contractor under the State of Nebraska's Employee Classification Act and that contractor shall comply with all legal obligations with respect to the employee (including, but not limited to, minimum and overtime pay, workers' compensation, unemployment compensation, and payment of federal and state payroll taxes).



(2) Contractor understands and agrees that failure to classify each individual hired to perform services under the contract as an employee rather than as an independent contractor if the individual does not meet the requirements of an independent contractor under the State of Nebraska's Employee Classification Act and/or failure to comply with legal obligations with respect to the employee (including, but not limited to, minimum and overtime pay, workers' compensation, unemployment compensation, and payment of federal and state payroll taxes) shall be considered a breach of the contract and is a ground for rescission of the Contract by the County.

(3) Contractor additionally agrees to include the following provision in each subcontract entered into with a subcontractor as part of the contractor's contract with the County.

(a) Subcontractor agrees that each individual performing services for the subcontractor shall be properly classified as an employee and not as an independent contractor if the individual does not meet the requirements of an independent contractor under the State of Nebraska's Employee Classification Act and that subcontractor shall comply with all legal obligations with respect to the employee (including, but not limited to, minimum and overtime pay, workers' compensation, unemployment compensation, and payment of federal and state payroll taxes).

(b) Subcontractor understands and agrees that subcontractor's failure to properly classify individuals hired to perform services under the subcontract as employees and not as independent contractors if the individual does not meet the requirements of an independent contract under the State of Nebraska's Employee Classification Act and/or failure to comply with legal obligation with respect to the employee (including, but not limited to, minimum and overtime pay, workers' compensation, unemployment compensation, and payment of federal and state payroll taxes) shall be considered a breach of the contract and is a ground for rescission of the subcontract with the contractor.

(4) Contractor agrees that if subcontractor fails to or is suspected of failing to properly classify each individual hired pursuant to the subcontract as an employee and not as an independent contractor if the individual does not meet the requirements of an independent contractor under the State of Nebraska's Employee Classification Act and/or fails to comply with legal obligations with respect to the subcontractor's employees, the contractor shall take appropriate corrective action including, but not limited to, reporting the suspected violation of the State of Nebraska Employee Classification Act to the Nebraska Department of Labor or rescission of the subcontract by the contractor. Written notification of the corrective action shall be submitted to the Lincoln-Lancaster County Purchasing Department. Contractor understands and agrees that contractor's failure to take appropriate corrective action shall be considered a breach of the contractor's contract with the County and is a ground for rescission of the contract by the County.

(5) The County shall notify the Nebraska Department of Labor of any contractor or subcontractor it has determined is in breach of contract due to the terms of this order.

(6) Any contractor or subcontractor who shall have been determined by the Nebraska Department of Labor to have knowingly provided a false affidavit to the County under the State of Nebraska's Employee Classification Act shall be referred to the Purchasing Agent of the County who shall determine whether to declare such contractor or subcontractor an irresponsible bidder who shall be disqualified from receiving any business from the County for a stated period of time.

(7) This policy does not prohibit a contractor or subcontractor from hiring individuals to perform construction labor services as independent contractors, provided that the contractor's or subcontractor's use of such individuals as an independent contractor complies with the criteria found in subdivision 5 of *Neb. Rev. Stat. § 48-604* and is otherwise valid under federal and state law and is not intended to circumvent lawful obligations under federal and state law or county contractual requirements.

EMPLOYEE CLASSIFICATION ACT AFFIDAVIT

For the purpose of complying with THE NEBRASKA EMPLOYEE CLASSIFICATION ACT, Nebraska Revised Statutes 48-2901 to 48-2912,

I, Edward James Hibbard, herein below known as the Contractor, state under oath and swear as follows:

1. Each individual performing services for the Contractor is properly classified under the Employee Classification Act.
2. The Contractor has completed a federal I-9 immigration form and has such form on file for each employee performing services.
3. The Contractor has complied with *Neb. Rev. Stat. 4-114*.
4. The Contractor has no reasonable basis to believe that any individual performing services for the Contractor is an undocumented worker.
5. The Contractor is not barred from contracting with state or any political subdivision pursuant to *Neb. Rev. Stat. 48-2912* of this Act.
6. As the Contractor, I understand that pursuant to the Employee Classification Act a violation of the Act by a contractor is grounds for rescission of the contract by Lancaster County. I understand that pursuant to the Act any contractor who knowingly provides a false affidavit may be subject to criminal penalties and upon a second or subsequent violation shall be barred from contracting with Lancaster County for a period of three years after the date of discovery of the falsehood.

I hereby affirm and swear that the statements and information provided on this affidavit are true, complete and accurate. The undersigned person does hereby agree and represent that he or she is legally capable to sign this affidavit and to lawfully bind the Contractor to this affidavit.

PRINT NAME: Edward James Hibbard  
(First, Middle, Last)

SIGNATURE: [Handwritten Signature]

TITLE: V.P. Sales

State of ~~Nebraska~~ TEXAS )

)ss.

County of HARRIS )

This affidavit was signed and sworn to before me, the undersigned Notary Public, on this

9<sup>th</sup> day of October, 2019.

[Handwritten Signature: Theresa Uhlmann]  
Notary Public

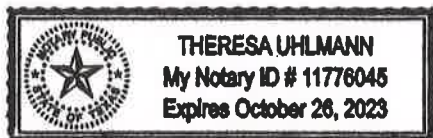

**INSURANCE CLAUSE FOR ALL CITY OF LINCOLN, LANCASTER COUNTY  
AND PUBLIC BUILDING COMMISSION CONTRACTS**

Insurance coverage on this Contract will be required for the entities selected below

City of Lincoln     Lancaster County     Public Building Commission

Vendors must provide coverage & documents related to the items with a check mark in Sections 1 – 1.9.

This includes proof of coverage and waivers as required below.

All Vendors must comply with Sections 2-8.

**THE REQUIREMENTS HEREIN APPLY TO CONTRACTS TO BE ISSUED BY THE CITY OF LINCOLN,  
LANCASTER COUNTY, AND THE LINCOLN-LANCASTER COUNTY PUBLIC BUILDING COMMISSION.  
FOR PURPOSES OF CERTIFICATES, ENDORSEMENTS AND OTHER PROOF REQUIRED HEREIN, ONLY  
INCLUDE THE ENTITY ISSUING THE CONTRACT.**

**FAILURE OF THE APPROPRIATE ENTITY (CITY, COUNTY, OR PUBLIC BUILDING COMMISSION) TO  
OBJECT TO THE FORM OF THE CERTIFICATE OR ENDORSEMENT OR TO DEMAND SUCH PROOF AS  
IS REQUIRED HEREIN SHALL NOT CONSTITUTE A WAIVER OF ANY OF THE INSURANCE  
REQUIREMENTS SET FORTH BELOW.**

**Insurance; Coverage Information**

The Contractor shall, prior to beginning work, provide proof of insurance coverage in a form satisfactory to the City/County/PBC, which shall not withhold approval unreasonably. The coverages and minimum levels required by this Contract are set forth below and shall be in effect for all times that work is being done pursuant to this Contract. No work on the Project or pursuant to this Contract shall begin until all insurance obligations herein are met to the satisfaction of the City/County/PBC, which shall not unreasonably withhold approval. Self-insurance shall not be permitted unless consent is given by the City/County/PBC prior to execution of the Contract and may require submission of financial information for analysis. Deductible levels shall be provided in writing from the Contractor's insurer and will be no more than \$25,000 per occurrence or as may be approved by the City or County as appropriate. Said insurance shall be written on an **OCCURRENCE** basis, and shall be **PRIMARY, with any insurance coverage maintained by the City/County/PBC being secondary or excess.**

**Certificates**

The Contractor shall provide certificates of insurance and such other proof, such as endorsements, as may be acceptable to the City or County (as appropriate) evidencing compliance with these requirements. The Contractor shall provide a Certificate of Insurance demonstrating the coverage required herein and the necessary endorsements or other proof and waivers described herein and below before being permitted to begin the work or project pursuant to this Contract.

1. **Commercial General Liability**

The Contractor shall provide proof of Commercial General Liability Insurance with a minimum limit of not less than \$1,000,000 each occurrence and \$2,000,000 aggregate. These minimum limits can be met by primary and umbrella liability policies. Coverage shall include: Premises-Operations, Products/ Completed Operations, Contractual, Broad Form Property Damage, and Personal Injury. Such coverage shall be endorsed for the general aggregate to be on a **PER PROJECT** basis, and the Contractor shall provide an additional insured endorsement acceptable to the City/County/PBC. The required insurance must include coverage for all projects and operations of Contractor or similar language that meets the approval of the City/County/PBC, which approval shall not be unreasonably withheld.

1.1 **Additional Insured (Requires an Endorsement Form)**

All Contractors shall provide an Additional Insured Endorsement form or other proof showing the City/County/PBC as additional insured for commercial general liability, auto liability and such other coverages as may be required by the City/County/PBC. The form or other proof shall be as is acceptable to the City/County Attorney.

1.2 **Automobile Liability**

The Contractor shall provide proof of Automobile Liability coverage, which shall include: Owned, Hired and Non-Owned. Bodily Injury and Property Damage Combined Single Limit shall be at least \$1,000,000 Per Accident.

1.3 **Garage Keepers / Garage Liability**

The Contractor shall provide garage insurance, if required. Coverage shall include Garage Liability and Garage Keepers on a Direct Primary Basis, including Auto Physical Damage, with limits of not less than \$1,000,000 each accident Bodily Injury and Property Damage combined liability and Actual Cash Value auto physical damage. Coverage symbol(s) 30 and 21 shall be provided, where applicable.

1.4 **Workers' Compensation; Employers' Liability**

The Contractor shall provide proof of workers' compensation insurance of not less than minimum statutory requirements under the laws of the State of Nebraska and any other applicable State. Employers' Liability coverage with limits of not less than \$500,000 each accident or injury shall be included. The Contractor shall provide the City/County/PBC with an endorsement for waiver of subrogation or other proof of such waiver as may be acceptable to the City or County. The Contractor shall also be responsible for ensuring that all subcontractors have workers' compensation insurance for their employees before and during the time any work is done pursuant to this Contract.

**1.5 Builder's Risk Insurance**

The Contractor shall purchase and maintain builder's risk property insurance for all sites upon which construction is occurring as provided by Contract and all storage sites where equipment, materials, and supplies of any kind purchased pursuant to the Contract are being held or stored unless the Contractor receives notice that the City/County/PBC has obtained a builder's risk policy for itself. Except to the extent recoverable by Contractor from another subcontractor, deductibles shall be the responsibility of the Contractor. This coverage is required whenever the work under contract involves construction or repair of a building structure or bridge.

**1.5.1 Waiver of Builder's Risk Insurance Carrier's Subrogation Rights**

The Contractor and its subcontractor(s) waive all rights of action and subrogation that the insurance company providing the builder's risk policy may have against each of them and/or the City/County/PBC, Architect, and the officers, agents and employees of any of them, for all claims, damages, injuries and losses, to the extent covered by such property insurance. Such waiver of subrogation shall be effective for such persons even though such persons would otherwise have a duty of indemnification or contribution, contractual or otherwise, and even though such persons did not pay the insurance premium directly or indirectly, and whether or not such persons had an insurable interest in any property damaged. The Contractor or subcontractor shall provide proof of such waiver.

**1.6 Pollution Liability**

Contractors shall provide proof of pollution liability insurance arising out of all operations of the Contractors and subcontractors, due to discharge, dispersal, release, or escape of contaminants or pollutants into or upon land, the atmosphere or any watercourse or body of water with bodily injury and property damage limits of not less than \$1,000,000 per occurrence and \$2,000,000 annual aggregate for:

- 1) Bodily injury, sickness, disease, mental anguish or shock sustained by any person, including death;
- 2) Property damage including physical injury to or destruction of tangible property including the resulting loss of use thereof, clean-up costs, and the loss of use of tangible property that has not been physically injured or destroyed;
- 3) Defense including loss adjustment costs, charges and expenses incurred in the investigation, adjustment or defense of claims for such compensatory damages;
- 4) Definition of pollution conditions shall include asbestos, lead, and mold so that these risks are covered if caused by Contractor/successful candidate's work or operations.
- 5) Coverage is required on an occurrence form.

**1.7 Errors and Omissions; Professional Liability**

Errors and Omissions or Professional Liability insurance, as may be required, covering damages arising out of negligent acts, errors, or omissions committed by Contractor in the performance of this Contract, with a liability limit of not less than \$1,000,000 each claim. Contractor shall maintain this policy for a minimum of two (2) years after completion of the work or shall arrange for a two year extended discovery (tail) provision if the policy is not renewed. The intent of this policy is to provide coverage for claims arising out of the performance of professional Services under this contract and caused by any error, omission, breach or negligent act, including infringement of intellectual property (except patent and trade secret) of the Contractor. This coverage is required whenever the Contractor or service provider is required to be certified, licensed or registered by a regulatory entity and/or where the provider's judgment in planning and design could result in economic loss to City/County/PBC.

**1.8 Railroad Contractual Liability Insurance**

If work is to be performed within 50 feet of any railroad property and affecting any railroad bridge or trestle, tracks, road beds, tunnel, underpass or railroad crossing, the Contractor must provide proof acceptable to the City or County that any exception for such work in the Contractor's commercial general liability policy has been removed or deleted.

**1.8.1 Railroad Protective Liability**

If work is to be performed within 50 feet of any railroad property and affecting any railroad bridge or trestle, tracks, road beds, tunnel, underpass or crossing or otherwise required by the Special Provisions or applicable requirements of an affected railroad, the Contractor shall provide Railroad Protective Liability Insurance naming the affected railroad/s as insured with minimum limits for bodily injury and property damage of \$2,000,000 per occurrence, \$6,000,000 aggregate, or such other limits as required in the Special Provisions or by the affected railroad. The original of the policy shall be furnished to the railroad and a certified copy of the same furnished to the City/County/PBC Purchasing Department prior to any related construction or entry upon railroad premises by the Contractor or for work related to the Contract.

**1.9 Cyber Insurance**

The Contractor shall maintain network risk and cyber liability coverage (including coverage for unauthorized access, failure of security, breach of privacy perils, as well as notification costs and regulatory defense) in an amount of not less than \$1,000,000. Such insurance shall be maintained in force at all times during the term of the Contract and for a period of two years thereafter for services completed during the term of the Contract.

2. **Cancellation Notice**

All Contractors shall include an endorsement to provide for at least thirty (30) days' firm written notice in the event of cancellation during the term of the Contract and during the period of any required continuing coverages. The Contractor shall provide, prior to expiration of the policies, certificates and endorsement forms evidencing renewal insurance coverages. The parties agree that the failure of City/County/PBC to object to the form of a certificate and/or additional insured endorsement or endorsement forms provided shall not constitute a waiver of this requirement.

3. **Risk of Loss**

Except to the extent covered by the builder's risk insurance, the Contractor shall have the sole responsibility for the proper storage and protection of, and assumes all risk of loss of, any subcontractor's Work and tools, materials, equipment, supplies, facilities, offices and other property at or off the Project site. The Contractor shall be solely responsible for ensuring each subcontractor shall take every reasonable precaution in the protection of all structures, streets, sidewalks, materials and work of other subcontractors. Contractor shall protect its Work from damage by the elements or by other trades working in the area.

4. **Umbrella or Excess Liability**

The Contractor may use an Umbrella, Excess Liability, or similar coverage to supplement the primary insurance stated above in order to meet or exceed the minimum coverage levels required by this Contract.

5. **Minimum Scope of Insurance**

All Liability Insurance policies shall be written on an "Occurrence" basis only. All insurance coverage are to be placed with insurers authorized to do business in the State of Nebraska and must be placed with an insurer that has an A.M. Best's Rating of no less than A:VII unless specific approval has been granted otherwise.

6. **Indemnification**

To the fullest extent permitted by law the Contractor shall indemnify, defend, and hold harmless the Owner, its elected officials, officers, employees, agents, consultants, and employees of any of them from and against claims, damages, losses and expenses, including but not limited to attorney fees, arising out of or resulting from performance of the Work, provided that such claim, damage, loss or expense is attributable to bodily injury, sickness, disease or death, or to injury to or destruction of tangible or intangible property, including the Work itself, but only to the extent caused by the negligent, wrongful, or intentional acts or omissions of the Contractor, a subcontractor, anyone directly or indirectly employed by them or anyone for whose acts they may be liable, regardless of whether or not such claim, damage, loss or

expense is caused in part by the negligence of a party indemnified hereunder. In the event the claim, damage, loss or expense is caused in part by the negligence of a party indemnified hereunder, the indemnification by the Contractor shall be prorated based on the extent of the liability of the party indemnified hereunder. Such obligation shall not be construed to negate, abridge, or reduce obligations of indemnity which would otherwise exist as to a party or person described in this Section. Nothing herein shall be construed to be a waiver of sovereign immunity by the Owner.

7. **Reservation of Rights**

The City/County/PBC reserves the right to require a higher limit of insurance or additional coverages when the City/County/PBC determines that a higher limit or additional coverage is required to protect the City/County/PBC or the interests of the public. Such changes in limits or coverages shall be eligible for a change order or amendment to the Contract.

8. **Sovereign Immunity**

Nothing contained in this clause or other clauses of this Contract shall be construed to waive the Sovereign Immunity of the City/County/PBC.

9. **Further Contact**

For further information or questions concerning coverage or acceptable forms, Contractors may contact the Purchasing Division or the department that issued the bid or the request for proposal.

For general questions regarding Insurance Requirements, please contact Risk Management for the City or County.





# CERTIFICATE OF LIABILITY INSURANCE

DATE (MM/DD/YYYY)

THIS CERTIFICATE IS ISSUED AS A MATTER OF INFORMATION ONLY AND CONFERS NO RIGHTS UPON THE CERTIFICATE HOLDER. THIS CERTIFICATE DOES NOT AFFIRMATIVELY OR NEGATIVELY AMEND, EXTEND OR ALTER THE COVERAGE AFFORDED BY THE POLICIES BELOW. THIS CERTIFICATE OF INSURANCE DOES NOT CONSTITUTE A CONTRACT BETWEEN THE ISSUING INSURER(S), AUTHORIZED REPRESENTATIVE OR PRODUCER, AND THE CERTIFICATE HOLDER.

**IMPORTANT:** If the certificate holder is an ADDITIONAL INSURED, the policy(ies) must have ADDITIONAL INSURED provisions or be endorsed. If SUBROGATION IS WAIVED, subject to the terms and conditions of the policy, certain policies may require an endorsement. A statement on this certificate does not confer rights to the certificate holder in lieu of such endorsement(s).

|             |                               |                |
|-------------|-------------------------------|----------------|
| PRODUCER    | CONTACT NAME:                 |                |
|             | PHONE (A/C, No., Ext):        | FAX (A/C, No): |
| INSURED     | E-MAIL ADDRESS:               |                |
|             | INSURER(S) AFFORDING COVERAGE |                |
|             | NAIC #                        |                |
|             | INSURER A :                   |                |
|             | INSURER B :                   |                |
|             | INSURER C :                   |                |
| INSURER D : |                               |                |
| INSURER E : |                               |                |
| INSURER F : |                               |                |

**COVERAGES**                      **CERTIFICATE NUMBER:**                      **REVISION NUMBER:**

THIS IS TO CERTIFY THAT THE POLICIES OF INSURANCE LISTED BELOW HAVE BEEN ISSUED TO THE INSURED NAMED ABOVE FOR THE POLICY PERIOD INDICATED. NOTWITHSTANDING ANY REQUIREMENT, TERM OR CONDITION OF ANY CONTRACT OR OTHER DOCUMENT WITH RESPECT TO WHICH THIS CERTIFICATE MAY BE ISSUED OR MAY PERTAIN, THE INSURANCE AFFORDED BY THE POLICIES DESCRIBED HEREIN IS SUBJECT TO ALL THE TERMS, EXCLUSIONS AND CONDITIONS OF SUCH POLICIES. LIMITS SHOWN MAY HAVE BEEN REDUCED BY PAID CLAIMS.

| INSR LTR | TYPE OF INSURANCE  | ADDL INSD | SUBR WVD | POLICY NUMBER | POLICY EFF (MM/DD/YYYY) | POLICY EXP (MM/DD/YYYY) | LIMITS   |
|----------|--|-----------|----------|---------------|-------------------------|-------------------------|--|
|          | <b>COMMERCIAL GENERAL LIABILITY</b><br><input type="checkbox"/> CLAIMS-MADE <input type="checkbox"/> OCCUR<br><br>GEN'L AGGREGATE LIMIT APPLIES PER:<br><input type="checkbox"/> POLICY <input type="checkbox"/> PRO-JECT <input type="checkbox"/> LOC<br>OTHER: |           |          |               |                         |                         | EACH OCCURRENCE \$<br>DAMAGE TO RENTED PREMISES (Ea occurrence) \$<br>MED EXP (Any one person) \$<br>PERSONAL & ADV INJURY \$<br>GENERAL AGGREGATE \$<br>PRODUCTS - COMP/OP AGG \$<br>\$ |
|          | <b>AUTOMOBILE LIABILITY</b><br><input type="checkbox"/> ANY AUTO<br><input type="checkbox"/> OWNED AUTOS ONLY <input type="checkbox"/> SCHEDULED AUTOS<br><input type="checkbox"/> HIRED AUTOS ONLY <input type="checkbox"/> NON-OWNED AUTOS ONLY                |           |          |               |                         |                         | COMBINED SINGLE LIMIT (Ea accident) \$<br>BODILY INJURY (Per person) \$<br>BODILY INJURY (Per accident) \$<br>PROPERTY DAMAGE (Per accident) \$<br>\$                                    |
|          | <b>UMBRELLA LIAB</b> <input type="checkbox"/> OCCUR<br><b>EXCESS LIAB</b> <input type="checkbox"/> CLAIMS-MADE<br>DED    RETENTION \$  |           |          |               |                         |                         | EACH OCCURRENCE \$<br>AGGREGATE \$<br>\$   |
|          | <b>WORKERS COMPENSATION AND EMPLOYERS' LIABILITY</b><br>ANY PROPRIETOR/PARTNER/EXECUTIVE OFFICER/MEMBER EXCLUDED? (Mandatory in NH)<br>If yes, describe under DESCRIPTION OF OPERATIONS below  |           | Y/N      | N/A           |                         |                         | PER STATUTE    OTH-ER<br>E.L. EACH ACCIDENT \$<br>E.L. DISEASE - EA EMPLOYEE \$<br>E.L. DISEASE - POLICY LIMIT \$  |

DESCRIPTION OF OPERATIONS / LOCATIONS / VEHICLES (ACORD 101, Additional Remarks Schedule, may be attached if more space is required)

Lancaster County is listed as additionally insured.

|  |   |
|--|---|
| <b>CERTIFICATE HOLDER</b>                                      | <b>CANCELLATION</b>   |
| Lancaster County<br>555 South 10th Street<br>Lincoln, NE 68508 | SHOULD ANY OF THE ABOVE DESCRIBED POLICIES BE CANCELLED BEFORE THE EXPIRATION DATE THEREOF, NOTICE WILL BE DELIVERED IN ACCORDANCE WITH THE POLICY PROVISIONS.<br><br>AUTHORIZED REPRESENTATIVE |

© 1988-2016 ACORD CORPORATION. All rights reserved.

**THIS ENDORSEMENT CHANGES THE POLICY. PLEASE READ IT CAREFULLY.**

**ADDITIONAL INSURED – OWNERS, LESSEES OR  
CONTRACTORS – SCHEDULED PERSON OR  
ORGANIZATION**

This endorsement modifies insurance provided under the following:

COMMERCIAL GENERAL LIABILITY COVERAGE PART

**SCHEDULE**

|  |
|--|
| <p><b>Name of Person or Organization:</b><br/>Lancaster County</p> |
|--|

(If no entry appears above, information required to complete this endorsement will be shown in the Declarations as applicable to this endorsement.)

**A. Section II – Who Is An Insured** is amended to include as an insured the person or organization shown in the Schedule, but only with respect to liability arising out of your ongoing operations performed for that insured.

**B.** With respect to the insurance afforded to these additional insureds, the following exclusion is added:

**2. Exclusions**

This insurance does not apply to "bodily injury" or "property damage" occurring after:

- (1) All work, including materials, parts or equipment furnished in connection with such work, on the project (other than service, maintenance or repairs) to be performed by or on behalf of the additional insured(s) at the site of the covered operations has been completed; or
- (2) That portion of "your work" out of which the injury or damage arises has been put to its intended use by any person or organization other than another contractor or subcontractor engaged in performing operations for a principal as a part of the same project.

**WAIVER OF OUR RIGHT TO RECOVER FROM OTHERS ENDORSEMENT**

We have the right to recover our payments from anyone liable for an injury covered by this policy. We will not enforce our right against the person or organization named in the Schedule. (This agreement applies only to the extent that you perform work under a written contract that requires you to obtain this agreement from us.)

This agreement shall not operate directly or indirectly to benefit anyone not named in the Schedule.

Schedule

Lancaster County

Example

This endorsement changes the policy to which it is attached and is effective on the date issued unless otherwise stated.

**(The information below is required only when this endorsement is issued subsequent to preparation of the policy.)**

Endorsement  
Insured

Effective Policy No.

Endorsement No.  
Premium

Insurance Company

Countersigned by \_\_\_\_\_

**WC 00 03 13**  
(Ed. 4-84)





**ZURICH**<sup>®</sup>

## **Additional Insured – Automatic – Owners, Lessees Or Contractors**

| Policy No.   | Eff. Date of Pol. | Exp. Date of Pol. | Eff. Date of End. | Producer No. | Add'l. Prem | Return Prem. |
|--------------|-------------------|-------------------|-------------------|--------------|-------------|--------------|
| GLO018794703 | 07/01/2019        | 07/01/2020        | 07/01/2019        |              |             |              |

**THIS ENDORSEMENT CHANGES THE POLICY. PLEASE READ IT CAREFULLY.**

**Named Insured:** Uretek USA, Inc.

**Address (including ZIP Code):** P. O. Box 1929 Tomball, Tx 77377

This endorsement modifies insurance provided under the:

### **Commercial General Liability Coverage Part**

**A. Section II – Who Is An Insured** is amended to include as an additional insured any person or organization whom you are required to add as an additional insured on this policy under a written contract or written agreement. Such person or organization is an additional insured only with respect to liability for "bodily injury", "property damage" or "personal and advertising injury" caused, in whole or in part, by:

1. Your acts or omissions; or
2. The acts or omissions of those acting on your behalf,

in the performance of your ongoing operations or "your work" as included in the "products-completed operations hazard", which is the subject of the written contract or written agreement.

However, the insurance afforded to such additional insured:

1. Only applies to the extent permitted by law; and
2. Will not be broader than that which you are required by the written contract or written agreement to provide for such additional insured.

**B. With respect to the insurance afforded to these additional insureds, the following additional exclusion applies:**

This insurance does not apply to:

"Bodily injury", "property damage" or "personal and advertising injury" arising out of the rendering of, or failure to render, any professional architectural, engineering or surveying services including:

- a. The preparing, approving or failing to prepare or approve maps, shop drawings, opinions, reports, surveys, field orders, change orders or drawings and specifications; or
- b. Supervisory, inspection, architectural or engineering activities.

This exclusion applies even if the claims against any insured allege negligence or other wrongdoing in the supervision, hiring, employment, training or monitoring of others by that insured, if the "occurrence" which caused the "bodily injury" or "property damage", or the offense which caused the "personal and advertising injury", involved the rendering of or the failure to render any professional architectural, engineering or surveying services.

**C. The following is added to Paragraph 2. Duties In The Event Of Occurrence, Offense, Claim Or Suit of Section IV – Commercial General Liability Conditions:**

The additional insured must see to it that:

1. We are notified as soon as practicable of an "occurrence" or offense that may result in a claim;
2. We receive written notice of a claim or "suit" as soon as practicable; and
3. A request for defense and indemnity of the claim or "suit" will promptly be brought against any policy issued by another insurer under which the additional insured may be an insured in any capacity. This provision does not apply to insurance on which the additional insured is a Named Insured if the written contract or written agreement requires that this coverage be primary and non-contributory.

**D. For the purposes of the coverage provided by this endorsement:**

**1. The following is added to the Other Insurance Condition of Section IV – Commercial General Liability Conditions:**

**Primary and Noncontributory insurance**

This insurance is primary to and will not seek contribution from any other insurance available to an additional insured provided that:

- a. The additional insured is a Named Insured under such other insurance; and
- b. You are required by written contract or written agreement that this insurance be primary and not seek contribution from any other insurance available to the additional insured.

**2. The following paragraph is added to Paragraph 4.b. of the Other Insurance Condition of Section IV – Commercial General Liability Conditions:**

This insurance is excess over:

Any of the other insurance, whether primary, excess, contingent or on any other basis, available to an additional insured, in which the additional insured on our policy is also covered as an additional insured on another policy providing coverage for the same "occurrence", offense, claim or "suit". This provision does not apply to any policy in which the additional insured is a Named Insured on such other policy and where our policy is required by a written contract or written agreement to provide coverage to the additional insured on a primary and non-contributory basis.

**E. This endorsement does not apply to an additional insured which has been added to this policy by an endorsement showing the additional insured in a Schedule of additional insureds, and which endorsement applies specifically to that identified additional insured.**

**F. With respect to the insurance afforded to the additional insureds under this endorsement, the following is added to Section III – Limits Of Insurance:**

The most we will pay on behalf of the additional insured is the amount of insurance:

1. Required by the written contract or written agreement referenced in Paragraph A. of this endorsement; or
2. Available under the applicable Limits of Insurance shown in the Declarations, whichever is less.

This endorsement shall not increase the applicable Limits of Insurance shown in the Declarations.

All other terms and conditions of this policy remain unchanged.

**Policy Number**  
GLO 0187947-03

**ENDORSEMENT**

**ZURICH AMERICAN INSURANCE COMPANY**

Named Insured URETEK USA, INC.

Effective Date: 07/01/2019  
12:01 A.M., Standard Time

Agent Name IBTX

Agent No. 10836-000

**EXPANDED WORDING FOR FORM UGL1465**

UGL 1465DCW - ADDITIONAL INSURED - OWNERS, LESSEES OR CONTRACTORS - ONGOING OPERATIONS

NAME OF PERSON OR ORGANIZATION: ANY PERSON OR ORGANIZATION, OTHER THAN AN ARCHITECT, ENGINEER OR SURVEYOR, WHOM YOU ARE REQUIRED TO ADD AS AN ADDITIONAL INSURED UNDER THIS POLICY UNDER A WRITTEN CONTRACT OR WRITTEN AGREEMENT EXECUTED PRIOR TO LOSS, EXCEPT WHERE SUCH REQUIREMENT IS PROHIBITED BY LAW AND WHERE THAT CONTRACT SPECIFICALLY REQUIRES THE ISO CG2010 10/2001 EDITION FORM OR THE EQUIVALENT OF SAME.

LOCATION: ANY LOCATION OR PROJECT, OTHER THAN A WRAP-UP OR OTHER CONSOLIDATED INSURANCE PROGRAM LOCATION OR PROJECT FOR WHICH INSURANCE IS OTHERWISE SEPARATELY PROVIDED TO YOU BY A WRAP-UP OR OTHER CONSOLIDATED INSURANCE PROGRAM.

**Policy Number**  
GLO 0187947-03

**ENDORSEMENT**

**ZURICH AMERICAN INSURANCE COMPANY**

Named Insured URETEK USA, INC.

Effective Date: 07/01/2019

12:01 A.M., Standard Time

Agent Name IBTX

Agent No. 10836-000

**EXPANDED WORDING FOR FORM UGL1466**

UGL 1466DCW - ADDITIONAL INSURED - OWNERS, LESSEES OR CONTRACTORS - COMPLETED OPERATIONS

NAME OF PERSON OR ORGANIZATION: ANY PERSON OR ORGANIZATION, OTHER THAN AN ARCHITECT, ENGINEER OR SURVEYOR, WHOM YOU ARE REQUIRED TO ADD AS AN ADDITIONAL INSURED UNDER THIS POLICY UNDER A WRITTEN CONTRACT OR WRITTEN AGREEMENT EXECUTED PRIOR TO LOSS, EXCEPT WHERE SUCH REQUIREMENT IS PROHIBITED BY LAW AND WHERE THAT CONTRACT SPECIFICALLY REQUIRES THE ISO CG2037 10/2001 EDITION FORM OR THE EQUIVALENT OF SAME.

LOCATION: ANY LOCATION OR PROJECT, OTHER THAN A WRAP-UP OR OTHER CONSOLIDATED INSURANCE PROGRAM LOCATION OR PROJECT FOR WHICH INSURANCE IS OTHERWISE SEPARATELY PROVIDED TO YOU BY A WRAP-UP OR OTHER CONSOLIDATED INSURANCE PROGRAM.





ZURICH®

# Coverage Extension Endorsement

| Policy No.   | Eff. Date of Pol. | Exp. Date of Pol. | Eff. Date of End. | Producer No. | Add'l. Prem | Return Prem. |
|--------------|-------------------|-------------------|-------------------|--------------|-------------|--------------|
| BAP018794802 | 07/01/2019        | 07/01/2020        | 07/01/2019        |              |             |              |

**THIS ENDORSEMENT CHANGES THE POLICY. PLEASE READ IT CAREFULLY.**

This endorsement modifies insurance provided under the:

**Business Auto Coverage Form  
Motor Carrier Coverage Form**

## A. Amended Who Is An Insured

1. The following is added to the **Who Is An Insured** Provision in **Section II – Covered Autos Liability Coverage**:

The following are also "insureds":

- a. Any "employee" of yours is an "insured" while using a covered "auto" you don't own, hire or borrow for acts performed within the scope of employment by you. Any "employee" of yours is also an "insured" while operating an "auto" hired or rented under a contract or agreement in an "employee's" name, with your permission, while performing duties related to the conduct of your business.
- b. Anyone volunteering services to you is an "insured" while using a covered "auto" you don't own, hire or borrow to transport your clients or other persons in activities necessary to your business.
- c. Anyone else who furnishes an "auto" referenced in Paragraphs **A.1.a.** and **A.1.b.** in this endorsement.
- d. Where and to the extent permitted by law, any person(s) or organization(s) where required by written contract or written agreement with you executed prior to any "accident", including those person(s) or organization(s) directing your work pursuant to such written contract or written agreement with you, provided the "accident" arises out of operations governed by such contract or agreement and only up to the limits required in the written contract or written agreement, or the Limits of Insurance shown in the Declarations, whichever is less.

2. The following is added to the **Other Insurance** Condition in the Business Auto Coverage Form and the **Other Insurance – Primary and Excess Insurance Provisions Condition** in the Motor Carrier Coverage Form:

Coverage for any person(s) or organization(s), where required by written contract or written agreement with you executed prior to any "accident", will apply on a primary and non-contributory basis and any insurance maintained by the additional "insured" will apply on an excess basis. However, in no event will this coverage extend beyond the terms and conditions of the Coverage Form.

## B. Amendment – Supplementary Payments

Paragraphs **a.(2)** and **a.(4)** of the **Coverage Extensions** Provision in **Section II – Covered Autos Liability Coverage** are replaced by the following:

- (2) Up to \$5,000 for the cost of bail bonds (including bonds for related traffic law violations) required because of an "accident" we cover. We do not have to furnish these bonds.

- (iv) If the loss arises out of the maintenance or use of aircraft, "autos" or watercraft to the extent not subject to Exclusion **g.** of Section **I – Coverage A – Bodily Injury And Property Damage Liability**; or
- (v) That is property insurance (including any deductible or self insurance portion thereof) purchased by you to cover damage to:
  - Equipment you borrow from others; or
  - Property loaned to you or personal property in the care, custody or control of the insured arising out of the use of an elevator at premises you own, rent or occupy.
- (b) Any other primary insurance (including any deductible or self insurance portion thereof) available to the insured covering liability for damages arising out of the premises, operations, products, work or services for which the insured has been granted additional insured status either by policy provision or attachment of any endorsement. Other primary insurance includes any type of self insurance or other mechanism by which an insured arranges for funding of its legal liabilities.
- (c) Any of the other insurance, whether primary, excess, contingent or on any other basis, available to an additional insured, in which the additional insured on our policy is also covered as an additional insured on another policy providing coverage for the same "occurrence", claim or "suit". This provision does not apply to any policy in which the additional insured is a Named Insured on such other policy and where our policy is required by written contract or written agreement to provide coverage to the additional insured on a primary and non-contributory basis.

**W. Unintentional Failure to Disclose All Hazards**

Paragraph **6. Representations** of Section **IV – Commercial General Liability Conditions** is replaced by the following:

**6. Representations**

By accepting this policy, you agree:

- a. The statements in the Declarations are accurate and complete;
- b. Those statements are based upon representations you made to us; and
- c. We have issued this policy in reliance upon your representations.

Coverage will continue to apply if you unintentionally:

- a. Fail to disclose all hazards existing at the inception of this policy; or
- b. Make an error, omission or improper description of premises or other statement of information stated in this policy.

You must notify us as soon as possible after the discovery of any hazards or any other information that was not provided to us prior to inception of this Coverage Part.

**X. Waiver of Right of Subrogation**

Paragraph **8. Transfer Of Rights Of Recovery Against Others To Us** of Section **IV – Commercial General Liability Conditions** is replaced by the following:

**8. Transfer Of Rights Of Recovery Against Others To Us**

- a. If the insured has rights to recover all or part of any payment we have made under this Coverage Part, those rights are transferred to us. The insured must do nothing after loss to impair them. At our request, the insured will bring "suit" or transfer those rights to us and help us enforce them.
- b. If the insured waives its right to recover payments for injury or damage from another person or organization in a written contract executed prior to a loss, we waive any right of recovery we may have against such person or organization because of any payment we have made under this Coverage Part. The written contract will be considered executed when the insured's performance begins, or when it is signed, whichever happens first. This waiver of rights shall not be construed to be a waiver with respect to any other operations in which the insured has no contractual interest.

or employee of the "insured" to notify us of any "accident", claim, "suit" or "loss" shall not invalidate the insurance afforded by this policy.

Include, as soon as practicable:

- (1) How, when and where the "accident" or "loss" occurred and if a claim is made or "suit" is brought, written notice of the claim or "suit" including, but not limited to, the date and details of such claim or "suit";
- (2) The "insured's" name and address; and
- (3) To the extent possible, the names and addresses of any injured persons and witnesses.

If you report an "accident", claim, "suit" or "loss" to another insurer when you should have reported to us, your failure to report to us will not be seen as a violation of these amended duties provided you give us notice as soon as practicable after the fact of the delay becomes known to you.

**P. Waiver of Transfer Of Rights Of Recovery Against Others To Us**

The following is added to the **Transfer Of Rights Of Recovery Against Others To Us** Condition:

This Condition does not apply to the extent required of you by a written contract, executed prior to any "accident" or "loss", provided that the "accident" or "loss" arises out of operations contemplated by such contract. This waiver only applies to the person or organization designated in the contract.

**Q. Employee Hired Autos – Physical Damage**

Paragraph **b.** of the **Other Insurance** Condition in the Business Auto Coverage Form and Paragraph **f.** of the **Other Insurance – Primary and Excess Insurance Provisions** Condition in the Motor Carrier Coverage Form are replaced by the following:

For Hired Auto Physical Damage Coverage, the following are deemed to be covered "autos" you own:

- (1) Any covered "auto" you lease, hire, rent or borrow; and
- (2) Any covered "auto" hired or rented under a written contract or written agreement entered into by an "employee" or elected or appointed official with your permission while being operated within the course and scope of that "employee's" employment by you or that elected or appointed official's duties as respect their obligations to you.

However, any "auto" that is leased, hired, rented or borrowed with a driver is not a covered "auto".

**R. Unintentional Failure to Disclose Hazards**

The following is added to the **Concealment, Misrepresentation Or Fraud** Condition:

However, we will not deny coverage under this Coverage Form if you unintentionally:

- (1) Fail to disclose any hazards existing at the inception date of this Coverage Form; or
- (2) Make an error, omission, improper description of "autos" or other misstatement of information.

You must notify us as soon as possible after the discovery of any hazards or any other information that was not provided to us prior to the acceptance of this policy.

**S. Hired Auto – World Wide Coverage**

Paragraph **7a.(5)** of the **Policy Period, Coverage Territory** Condition is replaced by the following:

- (5) Anywhere in the world if a covered "auto" is leased, hired, rented or borrowed for a period of 60 days or less,

**T. Bodily Injury Redefined**

The definition of "bodily injury" in the **Definitions** Section is replaced by the following:

"Bodily injury" means bodily injury, sickness or disease, sustained by a person including death or mental anguish, resulting from any of these at any time. Mental anguish means any type of mental or emotional illness or disease.

**WAIVER OF OUR RIGHT TO RECOVER FROM OTHERS ENDORSEMENT**

We have the right to recover our payments from anyone liable for an injury covered by this policy. We will not enforce our right against the person or organization named in the Schedule. (This agreement applies only to the extent that you perform work under a written contract that requires you to obtain this agreement from us.)

This agreement shall not operate directly or indirectly to benefit anyone not named in the Schedule.

**Schedule**

ALL PERSONS AND/OR ORGANIZATIONS THAT ARE REQUIRED BY WRITTEN CONTRACT OR AGREEMENT WITH THE INSURED, EXECUTED PRIOR TO THE ACCIDENT OR LOSS, THAT WAIVER OF SUBROGATION BE PROVIDED UNDER THIS POLICY FOR WORK PERFORMED BY YOU FOR THAT PERSON AND/OR ORGANIZATION

**TEXAS WAIVER OF OUR RIGHT TO RECOVER FROM OTHERS ENDORSEMENT**

This endorsement applies only to the insurance provided by the policy because Texas is shown in Item 3.A. of the Information Page.

We have the right to recover our payments from anyone liable for an injury covered by this policy. We will not enforce our right against the person or organization named in the Schedule, but this waiver applies only with respect to bodily injury arising out of the operations described in the Schedule where you are required by a written contract to obtain this waiver from us.

This endorsement shall not operate directly or indirectly to benefit anyone not named in the Schedule.

The premium for this endorsement is shown in the Schedule.

Schedule

1. ( ) Specific Waiver

Name of person or organization

( x ) Blanket Waiver

Any person or organization for whom the Named Insured has agreed by written contract to furnish this waiver.

2. Operations:

3. Premium:

The premium charge for this endorsement shall be \_\_\_\_\_ percent of the premium developed on payroll in connection with work performed for the above person(s) or organization(s) arising out of the operations described.

4. Advance Premium:

This endorsement changes the policy to which it is attached and is effective on the date issued unless otherwise stated.

(The information below is required only when this endorsement is issued subsequent to preparation of the policy.)

Endorsement Effective 07/01/2019  
Insured Uretek USA, Inc.

Policy No. WC0187946-03

Endorsement No.  
Premium

Insurance Company  
Zurich American Insurance Co.

Countersigned by \_\_\_\_\_



ZURICH<sup>®</sup>

## Blanket Notification to Others of Cancellation or Non-Renewal

| Policy No.   | Eff. Date of Pol. | Exp. Date of Pol. | Eff. Date of End. | Producer No. | Add'l. Prem | Return Prem. |
|--------------|-------------------|-------------------|-------------------|--------------|-------------|--------------|
| BAP018794802 | 07/01/2019        | 07/01/2020        | 07/01/2019        |              |             |              |

### THIS ENDORSEMENT CHANGES THE POLICY. PLEASE READ IT CAREFULLY.

This endorsement modifies insurance provided under the:

#### Commercial Automobile Coverage Part

- A.** If we cancel or non-renew this Coverage Part by written notice to the first Named Insured, we will mail or deliver notification that such Coverage Part has been cancelled or non-renewed to each person or organization shown in a list provided to us by the first Named Insured if you are required by written contract or written agreement to provide such notification. However, such notification will not be mailed or delivered if a conditional notice of renewal has been sent to the first Named Insured. Such list:
1. Must be provided to us prior to cancellation or non-renewal;
  2. Must contain the names and addresses of only the persons or organizations requiring notification that such Coverage Part has been cancelled or non-renewed; and
  3. Must be in an electronic format that is acceptable to us.
- B.** Our notification as described in Paragraph **A.** of this endorsement will be based on the most recent list in our records as of the date the notice of cancellation or non-renewal is mailed or delivered to the first Named Insured. We will mail or deliver such notification to each person or organization shown in the list:
1. Within seven days of the effective date of the notice of cancellation, if we cancel for non-payment of premium; or
  2. At least 30 days prior to the effective date of:
    - a. Cancellation, if cancelled for any reason other than nonpayment of premium; or
    - b. Non-renewal, but not including conditional notice of renewal.
- C.** Our mailing or delivery of notification described in Paragraphs **A.** and **B.** of this endorsement is intended as a courtesy only. Our failure to provide such mailing or delivery will not:
1. Extend the Coverage Part cancellation or non-renewal date;
  2. Negate the cancellation or non-renewal; or
  3. Provide any additional insurance that would not have been provided in the absence of this endorsement.
- D.** We are not responsible for the accuracy, integrity, timeliness and validity of information contained in the list provided to us as described in Paragraphs **A.** and **B.** of this endorsement.

All other terms and conditions of this policy remain unchanged.

---

**BLANKET NOTIFICATION TO OTHERS OF CANCELLATION OR NONRENEWAL ENDORSEMENT**

This endorsement adds the following to Part Six of the policy.

**PART SIX  
CONDITIONS****Blanket Notification to Others of Cancellation or Nonrenewal**

1. If we cancel or non-renew this policy by written notice to you, we will mail or deliver notification that such policy has been cancelled or non-renewed to each person or organization shown in a list provided to us by you if you are required by written contract or written agreement to provide such notification. However, such notification will not be mailed or delivered if a conditional notice of renewal has been sent to you. Such list:
  - a. Must be provided to us prior to cancellation or non-renewal;
  - b. Must contain the names and addresses of only the persons or organizations requiring notification that such policy has been cancelled or non-renewed; and
  - c. Must be in an electronic format that is acceptable to us.
2. Our notification as described in Paragraph 1. above will be based on the most recent list in our records as of the date the notice of cancellation or non-renewal is mailed or delivered to you. We will mail or deliver such notification to each person or organization shown in the list:
  - a. Within seven days of the effective date of the notice of cancellation, if we cancel for non-payment of premium; or
  - b. At least 30 days prior to the effective date of:
    - (1) Cancellation, if cancelled for any reason other than nonpayment of premium; or
    - (2) Non-renewal, but not including conditional notice of renewal.
3. Our mailing or delivery of notification described in Paragraphs 1. and 2. above is intended as a courtesy only. Our failure to provide such mailing or delivery will not:
  - a. Extend the policy cancellation or non-renewal date;
  - b. Negate the cancellation or non-renewal; or
  - c. Provide any additional insurance that would not have been provided in the absence of this endorsement.
4. We are not responsible for the accuracy, integrity, timeliness and validity of information contained in the list provided to us as described in Paragraphs 1. and 2. above.

All other terms and conditions of this policy remain unchanged.

This endorsement changes the policy to which it is attached and is effective on the date issued unless otherwise stated.

**(The information below is required only when this endorsement is issued subsequent to preparation of the policy.)**

Endorsement Effective 07/01/2019  
Insured Uretek USA, Inc.

Policy No. WC0187946-03

Endorsement No.  
Premium \$

Insurance Company Zurich American Insurance Company