

**SPECIAL EVENTS PERMIT APPLICATION**  
**Lancaster County, Nebraska**

**Application must be received by the County Clerk**  
**a minimum of three (3) weeks prior to the event.**

**PLEASE READ THE GENERAL REQUIREMENTS PRIOR TO COMPLETING THE APPLICATION. THE HOLD HARMLESS AGREEMENT MUST BE SIGNED AND SUBMITTED AT TIME OF APPLICATION.**

**APPLICANT INFORMATION**

**Applicant Name:** Corey Godfrey and Craig Schmidt  
**Business/Organization Name (if applicable):** Gravel Adventures, LLC (Good Life Adventures)  
**Full Mailing Address:** 1910 Pawnee Street  
**Phone #:** (402) 438-2170      **Alternate Phone #:** (402) 840-0387  
**E-mail Address:** coreycycle@hotmail.com      spkhed@yahoo.com

**EVENT INFORMATION**

**Event Name:** Gravel Worlds  
**Event Description:** Bicycle ride  
**\*Date of Event:** 8/17/2019      **Alternate Date:** 8/18/2019  
**Start Time:** 6:00 am      **End Time:** 0:00 am

*\*In the event of cancellation, the County shall be notified by the applicant as soon as possible, however, not later than the day preceding the scheduled date.*

**Will the event be in/on a road?**       Yes       No

**Will the event be in/on sidewalk space?**       Yes       No

**Is part of the proposed route within the city limits of Lincoln or any other incorporated city or village?**       Yes       No

***If yes, please contact the City or Village Clerk of that jurisdiction to inquire about other necessary permits.***

**SPECIAL EVENTS PERMIT APPLICATION**  
**Lancaster County, Nebraska**

**Planned Route (describe in detail and attach map):** Leave Fallbrook Neighborhood on North 1st and stay primarily on gravel roads the rest of the route. Refer to map and cue sheets for complete details.

*(Attach additional sheets if necessary.)*

**Expected number of people attending:** 500

**Location(s) of event marshals/monitors:** Through out the route including any High

**\*Do you need sheriff escort/traffic control?**  Yes  No

**\*Do you need traffic control equipment (i.e., signs, cones, barricades)?**  Yes  No

*\*Applicant shall be responsible for reimbursing the County for such expenses.*

**Additional Comments:** See attached comments.

**The applicant agrees to pay all costs incurred by Lancaster County, Nebraska.**

**Signature:** 

**Date:** 2/10/19

**Return this application at least three (3) weeks prior to the event to:**  
**Lancaster County Clerk**  
**555 S. 10<sup>th</sup> Street, Room 108**  
**Lincoln, NE 68508**

**If you have questions regarding Special Event Permits,**  
**please contact the Clerk's Office at:**  
**Phone: (402) 441-7484**  
**E-mail: [coclerk@lancaster.ne.gov](mailto:coclerk@lancaster.ne.gov)**  
**Web site: [lancaster.ne.gov](http://lancaster.ne.gov)**

**For Office Use Only:**

- |   |                                   |  |
|---|-----------------------------------|--|
| <input type="checkbox"/> Application              | <input type="checkbox"/> Engineer | <input type="checkbox"/> Building & Safety |
| <input type="checkbox"/> Hold Harmless            | <input type="checkbox"/> LLCHD    | <input type="checkbox"/> Other _____       |
| <input type="checkbox"/> Map                      | <input type="checkbox"/> Planning | <input type="checkbox"/> Other _____       |
| <input type="checkbox"/> Certificate of Insurance | <input type="checkbox"/> Sheriff  | <input type="checkbox"/> WITHDRAWN _____   |

**SPECIAL EVENTS PERMIT APPLICATION**  
**Lancaster County, Nebraska**

**HOLD HARMLESS AGREEMENT**

**Event Name:** Gravel Worlds

**Date of Event:** August 17, 2019

The applicant shall indemnify and hold harmless, to the fullest extent allowed by law, Lancaster County, Nebraska (the "County"), and its agents, employees and representatives from all claims, demands, suits, actions, payments, liability, judgments (including court-ordered attorneys fees), arising out of or resulting from the special event listed above that results in bodily injury, sickness, disease, death, civil rights liability or damage to or destruction of tangible property including loss of use resulting therefrom, and that is caused in whole or in part by the acts or omissions of the applicant or anyone directly or indirectly employed by applicant or anyone for whose acts or omissions they may be liable, regardless of whether or not such claim, damage, loss or expense is caused in part by a party indemnified hereunder. Applicant shall maintain a policy or policies of insurance (or a self-insurance program) sufficient in coverage and amount to pay any judgments or related expenses from or in conjunction with any such claims.

In claims against any person or entity indemnified under this agreement by an employee or the applicant or anyone directly or indirectly employed by the applicant or anyone for whose acts they may be liable, the indemnification obligation under this agreement shall not be limited by a limitation on amount or type of damages, compensation or benefits payable by or for the applicant under workers' or workmen's compensation acts, disability benefit acts or other employee benefit acts.

Dated this 16 day of February, 2019.

**Applicant Signature:** 

**Printed Name:** Corey Godfrey

**Title/Legal Capacity:** Director

**Witness to Signature:** 

***REMINDER:*** *The applicant must also provide the County with proof of insurance; see General Requirements for coverage type and amounts.*

## Special Events Permit Application

### Lancaster County

Additional comments:

Thank you for your time and consideration with our permit for Gravel Worlds 2019 on Saturday August 17, 2019. We had a successful event in 2018 and we thank you again for your review and approval of the County permit. We hope to obtain another permit for 2019. We can answer any additional questions you may have regarding the event.

First and foremost, safety is always our number priority. All participants are required to obey all traffic laws, have front and rear lights for illumination, and ride safely at all times. In the 10 years of putting on our event we have never had an incident or a problem out in the county.

Most of the course is on gravel roads and the riders will be spread out in smaller groups or will be by themselves very early in the ride; the riders will not be in a large group. Typically, we have about 20% of the registered riders not show up to the event (so even less at the start). Currently, we have 377 riders registered. In the past, we have had a finish rate of around 65%, so as the day moves on there are even less riders on the roads. Over the span of the day riders will usually only see on average around 10 vehicles as there is less traffic on the gravel roads (it is actually safer than riding on the highways). Riders come from all over the United States and we'll also have numerous International participants in 2019 (New Zealand, UK, Ukraine, Canada and Brazil).

Many riders stay at the Graduate Hotel and spend money at the businesses in the downtown and Fallbrook areas. We have full support from Nebco, The Fallbrook Neighborhood Association, Schilling Bridge Restaurant and the Fallbrook YMCA (we have donated money the Strong Kids Campaign/Fallbrook YMCA the past few years). Participants will also spend money in the small towns they will be going through and at local small-town quick shops/stores. We are proud to be a part of many small-town business's best day profit wise for the year (for example, the grocery store in Malcolm each year). Last year, volunteers set up a tent in Malcolm and sold some snacks and water to the riders to help raise money for a new baseball field. There has also been a Boy Scout troop in Valparaiso that volunteers and raises money for their annual trip.

Please consider the above information regarding our permit application and let us know if you have any additional questions.

Respectfully,

Corey Godfrey

gravel worlds bucaneer 2019 v1				29.4 miles
Leg	Dir	Type	Notes	Total
	↑	Straight	At roundabout, take exit 2	0.0
0.0	→	Right	Turn right	0.0
0.1	→	Right	Turn right	0.1
0.0	←	Left	Turn left onto Fallbrook Boulevard	0.1
0.3	↑	Straight	Enter roundabout	0.4
0.6	→	Right	Turn slight right onto W Alvo Road	0.9
0.0	↑	Straight	Continue onto West Alvo Road	1.0
0.3	↑	Straight	At roundabout, take exit 2 onto W Alvo Road	1.2
0.1	↑	Straight	Continue onto West Alvo Road	1.3
0.5	←	Left	Turn left onto North 1st Street	1.8
0.1	↑	Straight	Continue onto North 1st Street	1.8
0.9	←	Left	Turn left onto West McKelvie Road	2.8
2.5	↑	Straight	Continue onto West McKelvie Road	5.3
4.6	→	Right	Turn right onto Malcolm Road, NE 55M Spur	9.9
0.6	←	Left	Turn slight left onto Malcolm Road	10.4
0.1	→	Right	Turn right onto South Lincoln Street	10.6
0.0	→	Right	Turn right onto East 2nd Street	10.6
0.1	←	Left	Turn left onto East Street	10.7
0.2	↑	Straight	Continue onto Northwest 105th Street	10.9
0.4	→	Right	Turn right onto West Bluff Road	11.3
1.5	←	Left	Turn left onto Northwest 84th Street	12.8
1.0	→	Right	Turn right onto West Waverly Road	13.8
1.0	←	Left	Turn left onto Northwest 70th Street	14.8
3.0	→	Right	Turn right onto West Branched Oak Road	17.9
1.5	→	Right	Turn right onto Northwest 48th Street	19.3
1.0	→	Right	Turn right onto West Raymond Road	20.3
0.0	←	Left	Turn sharp left onto 1st Street	20.3
0.5	↑	Straight	Continue onto Northwest Mill Grove Lane	20.8
0.4	→	Right	Turn slight right onto Northwest 40th Street	21.3
1.2	←	Left	Turn left onto West Waverly Road	22.5

Leg	Dir	Type	Notes	Total
0.7	→	Right	Turn right onto Northwest 27th Street	23.2
2.0	←	Left	Turn left onto West McKelvie Road	25.2
2.0	→	Right	Turn right onto North 1st Street	27.3
1.0	→	Right	Turn right onto West Alvo Road	28.3
0.5	↑	Straight	Enter roundabout	28.8
0.6	↑	Straight	Enter roundabout	29.4

Ride With GPS · <https://ridewithgps.com>

# Route 1

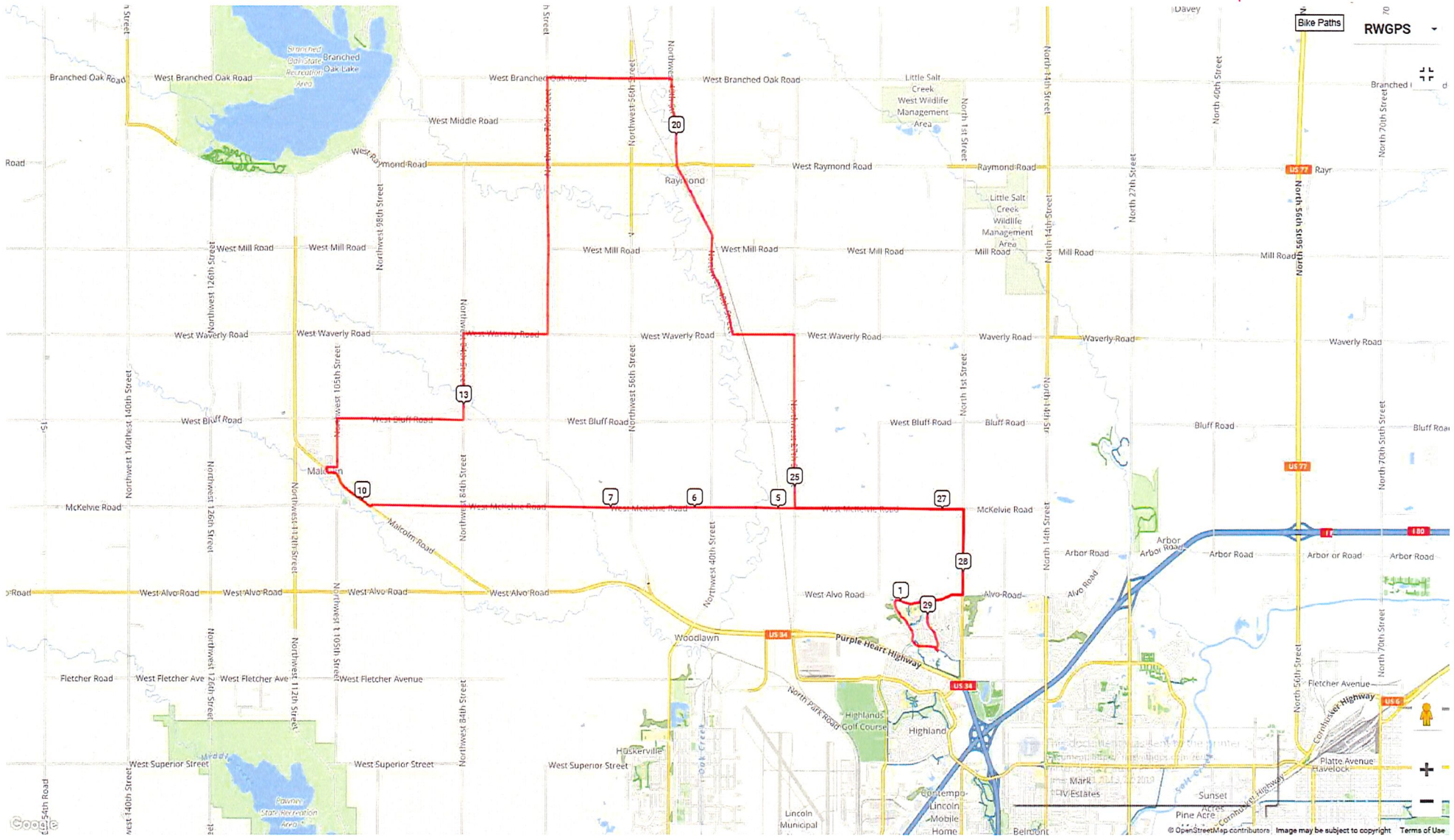

RWGPS

70

Bike Paths

US 77

US 77

US 77

US 77

US 77

US 77

US 77

US 77

US 77

US 77

US 77

US 77

US 77

US 77

US 77

US 77

gravel worlds privateer 2019 v1

74.8 miles

Leg	Dir	Type	Notes	Total
	→	Right	Turn right	0.0
0.1	→	Right	Turn right	0.1
0.0	←	Left	Turn left onto Fallbrook Boulevard	0.1
0.3	↑	Straight	Enter roundabout	0.4
0.6	→	Right	Turn slight right onto W Alvo Road	0.9
0.0	↑	Straight	Continue onto West Alvo Road	1.0
0.3	↑	Straight	At roundabout, take exit 2 onto W Alvo Road	1.3
0.1	↑	Straight	Continue onto West Alvo Road	1.3
0.5	←	Left	Turn left onto North 1st Street	1.8
0.1	↑	Straight	Continue onto North 1st Street	1.9
0.9	←	Left	Turn left onto West McKelvie Road	2.8
7.1	→	Right	Turn right onto Malcolm Road, NE 55M Spur	9.9
0.4	←	Left	Turn left onto Northwest 105th Street	10.3
0.2	→	Right	Turn right onto West McKelvie Road	10.5
2.5	←	Left	Turn left onto Northwest 140th Street	13.1
5.0	←	Left	Turn left onto West Holdrege Street	18.1
1.0	→	Right	Turn right onto Northwest 126th Street	19.0
1.0	↑	Straight	Continue onto Southwest 126th Street	20.0
1.0	→	Right	Turn right onto West A Street	21.0
1.0	←	Left	Turn left onto Southwest 140th Street	22.0
7.0	←	Left	Turn left onto West Saltillo Road	29.0
1.5	←	Left	Turn left onto Southwest 119th Street	30.5
2.2	↑	Straight	Continue onto Southwest 119th Street	32.7
0.3	→	Right	Turn right onto Midway Road	33.0
1.5	←	Left	Turn left onto Southwest 98th Street	34.5
0.3	→	Right	Turn right onto West Third Street	34.8
0.4	←	Left	Turn left onto Lancaster Avenue	35.2
0.2	←	Left	Turn left onto West Denton Road	35.5
0.4	→	Right	Turn right onto Southwest 98th Street	35.9
1.0	→	Right	Turn right onto West Old Cheney Road	36.9



Leg	Dir	Type	Notes	Total
4.0	←	Left	Turn left onto Southwest 40th Street	40.9
0.5	←	Left	Turn left onto West Claire Avenue	41.4
1.0	→	Right	Turn right onto Southwest 56th Street	42.4
0.5	←	Left	Turn left onto West Pioneers Boulevard	42.9
3.0	→	Right	Turn right onto Southwest 98th Street	45.9
5.9	←	Left	Turn left onto West Superior Street	51.8
0.5	→	Right	Turn right onto Northwest 105th Street	52.3
3.3	←	Left	Turn left onto Malcolm Road, NE 55M Spur	55.6
0.2	←	Left	Turn slight left onto Malcolm Road	55.8
0.1	→	Right	Turn right onto South Lincoln Street	55.9
0.0	→	Right	Turn right onto East 2nd Street	56.0
0.1	←	Left	Turn left onto East Street	56.1
0.2	↑	Straight	Continue onto Northwest 105th Street	56.3
0.4	→	Right	Turn right onto West Bluff Road	56.7
1.5	←	Left	Turn left onto Northwest 84th Street	58.2
1.0	→	Right	Turn right onto West Waverly Road	59.2
1.0	←	Left	Turn left onto Northwest 70th Street	60.2
3.0	→	Right	Turn right onto West Branched Oak Road	63.2
1.5	→	Right	Turn right onto Northwest 48th Street	64.7
1.0	→	Right	Turn right onto West Raymond Road	65.7
0.0	←	Left	Turn sharp left onto 1st Street	65.7
0.5	↑	Straight	Continue onto Northwest Mill Grove Lane	66.2
0.4	→	Right	Turn slight right onto Northwest 40th Street	66.6
1.2	←	Left	Turn left onto West Waverly Road	67.8
0.7	→	Right	Turn right onto Northwest 27th Street	68.5
2.0	←	Left	Turn left onto West McKelvie Road	70.6
2.0	→	Right	Turn right onto North 1st Street	72.6
1.0	→	Right	Turn right onto West Alvo Road	73.6
0.5	↑	Straight	Enter roundabout	74.1
0.6	↑	Straight	At roundabout, take exit 1 onto Fallbrook Boulevard	74.7
0.0	←	Left	Turn sharp left onto Fallbrook Boulevard	74.8

# Route 2

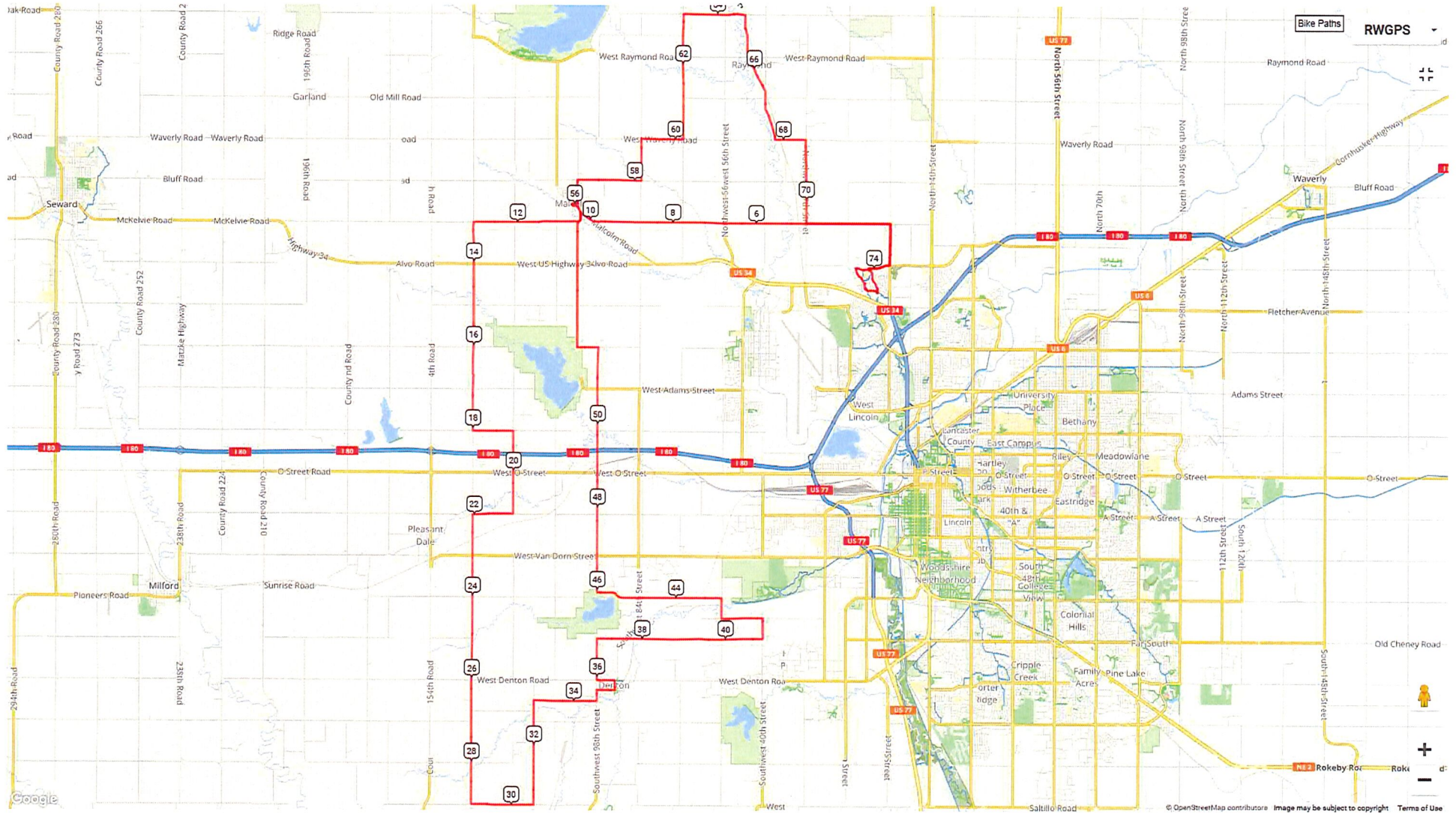

gravel worlds 2019 b/re-route/constuction

151.3 miles

Leg	Dir	Type	Notes	Total
	→	Right	Turn right	0.0
0.1	→	Right	Turn right	0.1
0.0	←	Left	Turn left onto Fallbrook Boulevard	0.1
0.3	↑	Straight	At roundabout, take exit 1 onto Tallgrass Parkway	0.4
0.2	→	Right	Turn right	0.6
0.0	←	Left	Turn left	0.6
0.2	→	Right	Turn right	0.8
0.0	→	Right	Turn right onto Tallgrass Parkway	0.8
0.3	→	Right	Turn slight right onto W Alvo Road	1.1
0.0	↑	Straight	Continue onto West Alvo Road	1.2
0.3	↑	Straight	At roundabout, take exit 2 onto W Alvo Road	1.4
0.1	↑	Straight	Continue onto West Alvo Road	1.5
0.5	←	Left	Turn left onto North 1st Street	2.0
0.1	↑	Straight	Continue onto North 1st Street	2.0
6.0	←	Left	Turn left onto West Branched Oak Road	8.0
1.0	→	Right	Turn right onto Northwest 12th Street	9.0
1.0	↑	Straight	Continue onto Northwest 12th Street	9.9
0.1	←	Left	Turn left onto West Davey Road	10.0
3.5	→	Right	Turn right onto West Branched Oak Road	13.5
3.0	→	Right	Turn right onto Northwest 91st Street	16.5
0.5	→	Right	Turn slight right onto Northwest Crouse Road	17.0
0.7	→	Right	Turn right onto Northwest 98th Street	17.7
2.0	←	Left	Turn left onto West Agnew Road	19.7
5.9	↑	Straight	Continue onto Agnew Road	25.7
2.1	→	Right	Turn right onto 210th Road	27.7
2.0	←	Left	Turn left onto Ashland Road	29.7
0.4	→	Right	Turn right onto Road ST	30.1
2.0	→	Right	Turn right onto Road 23, NE 66	32.1
0.0	←	Left	Turn left onto Road ST	32.1
0.5	→	Right	Turn right onto Road 23 1/2	32.6

Leg	Dir	Type	Notes	Total
1.5	←	Left	Turn left onto U Road	34.1
1.5	↑	Straight	Continue onto U Road	35.6
0.0	↑	Straight	Continue onto U Road	35.6
1.0	→	Right	Turn right onto 26 Road	36.6
2.3	←	Left	Turn left onto WX Road	38.9
0.6	↑	Straight	Continue onto W Road	39.6
0.5	→	Right	Turn right onto Road 27	40.0
3.8	→	Right	Turn right onto County Road 30	43.9
1.2	←	Left	Turn left onto County Road E	45.1
1.0	→	Right	Turn slight right onto County Road 29	46.1
0.9	←	Left	Turn left onto County Road D	47.0
1.0	→	Right	Turn right onto County Road 28, NE 79	48.0
1.5	←	Left	Turn left onto East 2nd Street	49.6
0.4	↑	Straight	Continue onto Main Road	49.9
0.6	→	Right	Turn right onto County Road 27	50.6
2.5	←	Left	Turn left onto West Ashland Road	53.1
0.9	→	Right	Turn right onto Northwest 56th Street	54.0
3.0	→	Right	Turn right onto West Rock Creek Road	57.0
1.0	←	Left	Turn left onto Northwest 70th Street	58.0
5.0	→	Right	Turn right onto West Waverly Road	63.0
1.0	←	Left	Turn left onto Northwest 84th Street	64.0
1.0	→	Right	Turn right onto West Bluff Road	65.0
1.5	←	Left	Turn left onto Northwest 105th Street	66.5
0.6	→	Right	Turn right onto East 2nd Street	67.1
0.1	←	Left	Turn left onto South Lincoln Street	67.2
0.0	←	Left	Turn left onto Malcolm Road	67.3
0.3	→	Right	Turn right onto Northwest 105th Street	67.6
0.2	→	Right	Turn right onto West McKelvie Road	67.8
2.5	←	Left	Turn left onto Northwest 140th Street	70.3
5.0	←	Left	Turn left onto West Holdrege Street	75.3
1.0	→	Right	Turn right onto Northwest 126th Street	76.3
1.0	↑	Straight	Continue onto Southwest 126th Street	77.3

Leg	Dir	Type	Notes	Total
1.0	→	Right	Turn right onto West A Street	78.3
1.0	←	Left	Turn left onto Southwest 140th Street	79.3
7.0	←	Left	Turn left onto West Saltillo Road	86.3
1.5	←	Left	Turn left onto Southwest 119th Street	87.8
2.2	↑	Straight	Continue onto Southwest 119th Street	90.0
0.3	→	Right	Turn right onto Midway Road	90.3
1.5	←	Left	Turn left onto Southwest 98th Street	91.8
0.3	→	Right	Turn right onto West Third Street	92.1
0.4	←	Left	Turn left onto Cass Avenue	92.5
0.0	→	Right	Turn right	92.5
0.1	→	Right	Turn right	92.5
0.0	←	Left	Turn left onto West Third Street	92.5
0.0	←	Left	Turn left onto Lancaster Avenue	92.5
0.2	←	Left	Turn left	92.8
0.0	←	Left	Turn left	92.8
0.0	→	Right	Turn right	92.8
0.0	←	Left	Turn left onto Lancaster Avenue	92.8
0.0	←	Left	Turn left onto West Denton Road	92.8
0.4	→	Right	Turn right onto Southwest 98th Street	93.3
1.0	→	Right	Turn right onto West Old Cheney Road	94.3
3.0	→	Right	Turn right onto Southwest 56th Street	97.3
2.0	→	Right	Turn right onto West Yankee Hill Road	99.3
1.0	←	Left	Turn left onto Southwest 70th Street	100.3
2.0	→	Right	Turn slight right onto Southwest 70th Street	102.2
0.0	→	Right	Turn slight right onto West Saltillo Road	102.3
0.1	←	Left	Turn left onto Southwest 72nd Street	102.4
6.0	←	Left	Turn left onto West Stagecoach Road	108.5
2.0	→	Right	Turn right onto Southwest 42nd Street	110.4
1.0	←	Left	Turn left onto West Panama Road	111.4
2.0	←	Left	Turn left onto Southwest 14th Street	113.4
2.0	←	Left	Turn left onto West Sprague Road	115.5
0.0	→	Right	Turn right onto Southwest 14th Street	115.5

Leg	Dir	Type	Notes	Total
0.1	←	Left	Turn left onto 2nd Street	115.5
0.2	←	Left	Turn left onto Buell Street	115.7
0.1	→	Right	Turn right onto West Sprague Road, NE 55N Rec	115.8
0.9	→	Right	Turn right onto Southwest 29th Street	116.7
1.0	←	Left	Turn left onto West Martell Road	117.7
1.0	→	Right	Turn right onto Southwest 42nd Street	118.7
4.0	→	Right	Turn slight right onto Southwest 42nd Street	122.7
0.1	→	Right	Turn slight right onto West Saltillo Road	122.8
0.1	←	Left	Turn slight left onto Southwest 40th Street	122.8
4.1	←	Left	Turn left onto West Old Cheney Road	126.9
1.0	→	Right	Turn right onto Southwest 56th Street	127.9
1.0	←	Left	Turn left onto West Pioneers Boulevard	128.9
3.0	→	Right	Turn right onto Southwest 98th Street	131.9
5.9	←	Left	Turn left onto West Superior Street	137.8
0.5	→	Right	Turn right onto Northwest 105th Street	138.3
3.3	→	Right	Turn right onto Malcolm Road, NE 55M Spur	141.6
0.4	←	Left	Turn left onto West McKelvie Road	142.0
7.1	→	Right	Turn right onto North 1st Street	149.1
1.0	→	Right	Turn right onto West Alvo Road	150.1
0.5	↑	Straight	Enter roundabout	150.6
0.6	↑	Straight	Enter roundabout	151.3

Ride With GPS · <https://ridewithgps.com>



# Route 3

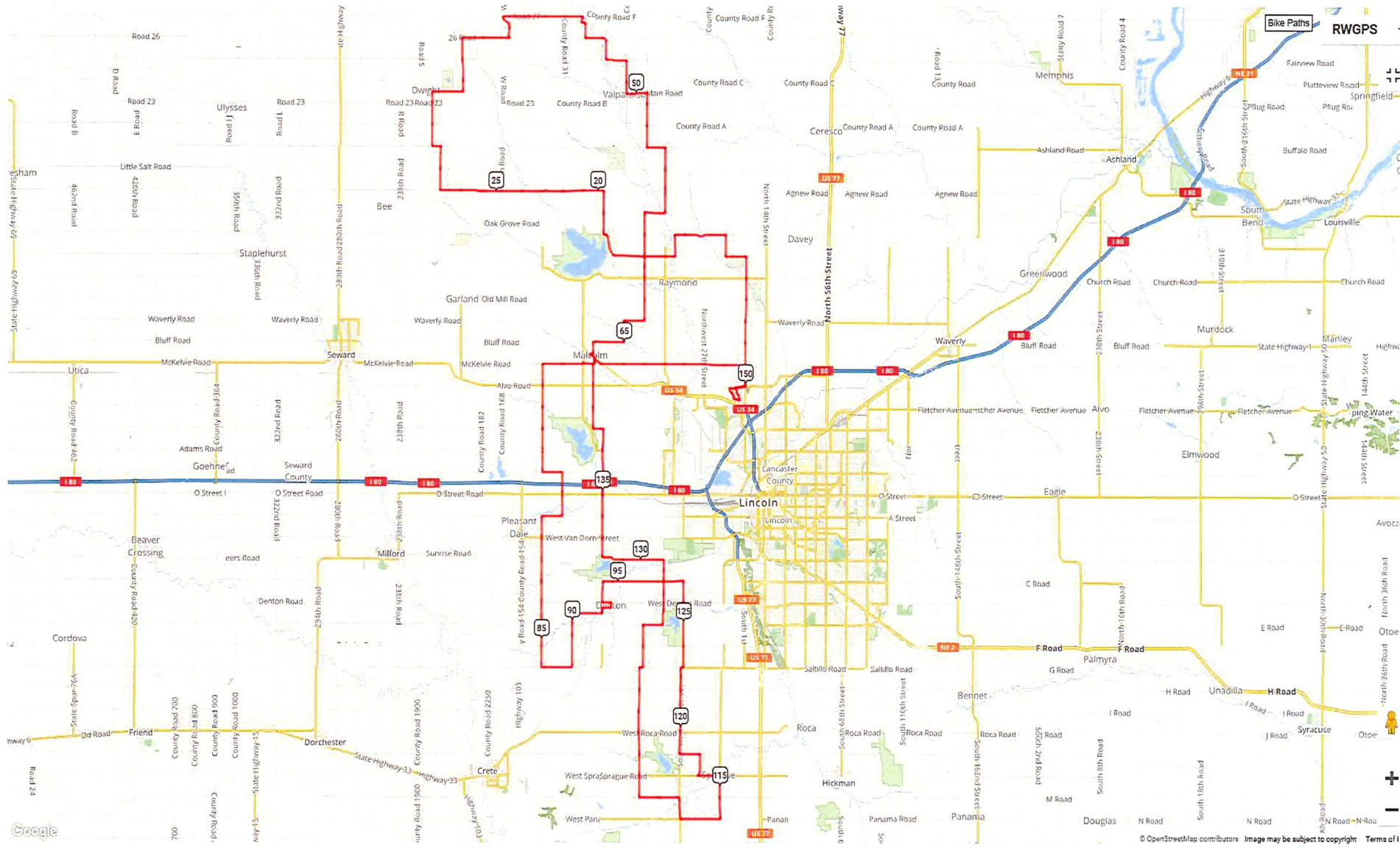





THIS ENDORSEMENT CHANGES THE POLICY. PLEASE READ IT CAREFULLY.

### ADDITIONAL INSURED - MANAGERS OR LESSORS OF PREMISES

This endorsement modifies insurance provided under the following:

COMMERCIAL GENERAL LIABILITY COVERAGE PART

#### SCHEDULE

**Name of Person(s) Or Organization(s) (Additional Insured):**

Effective Date: 08/16/2019

NEBCO.

1815 Y ST

LINCOLN, NE 68508

**Designation of Premises (Part Leased To You):**

575 FALLBROOK BLVD

LINCOLN, NE 68521

**Additional Premium: \$**

Information required to complete this Schedule, if not shown above, will be shown in the Declarations.

**A. Section II - Who is An Insured** is amended to include as an additional insured the person(s) or organization(s) shown in the Schedule, but only with respect to liability arising out of the ownership, maintenance or use of that part of the premises leased to you and shown in the Schedule and subject to the following additional exclusions:

This insurance does not apply to:

- 1. Any "occurrence" which takes place after you cease to be a tenant in that premises.
- 2. Structural alterations, new construction or demolition operations performed by or on behalf of the person (s) or organization(s) shown in the Schedule.

However:

- 1. The insurance afforded to such additional insured only applies to the extent permitted by law; and

2. If coverage provided to the additional insured is required by a contract or agreement, the insurance afforded to such additional insured will not be broader than that which you are required by the contract or agreement to provide for such additional insured.

**B.** With respect to the insurance afforded to these additional insureds, the following is added to **Section III - Limits Of Insurance:**

If coverage provided to the additional insured is required by a contract or agreement, the most we will pay on behalf of the additional insured is the amount of insurance:

- 1. Required by the contract or agreement; or
- 2. Available under the applicable Limits of Insurance shown in the Declarations;

whichever is less.

This endorsement shall not increase the applicable Limits of Insurance shown in the Declarations.

**THIS ENDORSEMENT CHANGES THE POLICY. PLEASE READ IT CAREFULLY.**

## **ADDITIONAL INSURED - MANAGERS OR LESSORS OF PREMISES**

This endorsement modifies insurance provided under the following:

COMMERCIAL GENERAL LIABILITY COVERAGE PART

### **SCHEDULE**

#### **Name of Person(s) Or Organization(s) (Additional Insured):**

Effective Date: 08/16/2019

CITY OF LINCOLN

CITY CLERKS OFFICE

555 S 10TH ST

LINCOLN, NE 68508

#### **Designation of Premises (Part Leased To You):**

575 FALLBROOK BLVD

LINCOLN, NE 68521

#### **Additional Premium: \$**

Information required to complete this Schedule, if not shown above, will be shown in the Declarations.

**A. Section II - Who is An Insured** is amended to include as an additional insured the person(s) or organization(s) shown in the Schedule, but only with respect to liability arising out of the ownership, maintenance or use of that part of the premises leased to you and shown in the Schedule and subject to the following additional exclusions:

This insurance does not apply to:

1. Any "occurrence" which takes place after you cease to be a tenant in that premises.
2. Structural alterations, new construction or demolition operations performed by or on behalf of the person (s) or organization(s) shown in the Schedule.

However:

1. The insurance afforded to such additional insured only applies to the extent permitted by law; and

2. If coverage provided to the additional insured is required by a contract or agreement, the insurance afforded to such additional insured will not be broader than that which you are required by the contract or agreement to provide for such additional insured.

**B.** With respect to the insurance afforded to these additional insureds, the following is added to **Section III - Limits Of Insurance:**

If coverage provided to the additional insured is required by a contract or agreement, the most we will pay on behalf of the additional insured is the amount of insurance:

1. Required by the contract or agreement; or
  2. Available under the applicable Limits of Insurance shown in the Declarations;
- whichever is less.

This endorsement shall not increase the applicable Limits of Insurance shown in the Declarations.

THIS ENDORSEMENT CHANGES THE POLICY. PLEASE READ IT CAREFULLY.

## ADDITIONAL INSURED - MANAGERS OR LESSORS OF PREMISES

This endorsement modifies insurance provided under the following:

COMMERCIAL GENERAL LIABILITY COVERAGE PART

### SCHEDULE

**Name of Person(s) Or Organization(s) (Additional Insured):**

Effective Date: 08/16/2019

LANCASTER COUNTY

555 S 10TH ST

LINCOLN, NE 68508

**Designation of Premises (Part Leased To You):**

575 FALLBROOK BLVD

LINCOLN, NE 68521

**Additional Premium: \$**

Information required to complete this Schedule, if not shown above, will be shown in the Declarations.

**A. Section II - Who is An Insured** is amended to include as an additional insured the person(s) or organization(s) shown in the Schedule, but only with respect to liability arising out of the ownership, maintenance or use of that part of the premises leased to you and shown in the Schedule and subject to the following additional exclusions:

This insurance does not apply to:

- 1. Any "occurrence" which takes place after you cease to be a tenant in that premises.
- 2. Structural alterations, new construction or demolition operations performed by or on behalf of the person (s) or organization(s) shown in the Schedule.

However:

- 1. The insurance afforded to such additional insured only applies to the extent permitted by law; and

2. If coverage provided to the additional insured is required by a contract or agreement, the insurance afforded to such additional insured will not be broader than that which you are required by the contract or agreement to provide for such additional insured.

**B.** With respect to the insurance afforded to these additional insureds, the following is added to **Section III - Limits Of Insurance:**

If coverage provided to the additional insured is required by a contract or agreement, the most we will pay on behalf of the additional insured is the amount of insurance:

- 1. Required by the contract or agreement; or
  - 2. Available under the applicable Limits of Insurance shown in the Declarations;
- whichever is less.

This endorsement shall not increase the applicable Limits of Insurance shown in the Declarations.

## Monet J. McCullen

---

**From:** Tom J. Cajka  
**Sent:** Tuesday, February 12, 2019 10:26 AM  
**To:** Monet J. McCullen  
**Subject:** RE: Request for County road review of Gravel Worlds 2019 routes - Saturday August 17, 2019

No objection.

Tom Cajka, Planner II  
County Planner  
Lincoln-Lancaster County Planning  
402-441-5662

---

**From:** Monet J. McCullen  
**Sent:** Monday, February 11, 2019 8:32 AM  
**To:** Amy L. Shandera <AShandera@lancaster.ne.gov>; Barbi M. Loschen <bloschen@lancaster.ne.gov>; David A. Derbin <DDerbin@lancaster.ne.gov>; David R. Cary <dcary@lincoln.ne.gov>; Greg R. Topil <gtopil@lincoln.ne.gov>; Jenifer T. Holloway <JHolloway@lancaster.ne.gov>; Josh D. Clark <JClark@lancaster.ne.gov>; Justin L. Daniel <jdaniel@lincoln.ne.gov>; Ken D. Schroeder <kschroeder@lancaster.ne.gov>; Robert K. Simmering <RSimmering@lincoln.ne.gov>; Steve S. Henrichsen <shenrichsen@lincoln.ne.gov>; Terry A. Kathe <tkathe@lincoln.ne.gov>; Tom J. Cajka <tcajka@lincoln.ne.gov>  
**Subject:** FW: Request for County road review of Gravel Worlds 2019 routes - Saturday August 17, 2019

All,  
I have attached a special event permit application for Gravel Worlds, for their event on Saturday, August 17, 2019 for their annual bike ride from 6am to 12am. Please have recommendations back to me no later than March 13, 2019.

Jen,  
I did speak with the applicant about insurance documents and he said the insurance is pending because the insurer likes to know the exact route. Unfortunately the route may change based on the County Engineer assessment. Once I get recommendations back he will work on getting insurance documents and I will forward them to you.

Thanks,  
Monét

---

**From:** Corey Godfrey <coreycycle@hotmail.com>  
**Sent:** Sunday, February 10, 2019 3:03 PM  
**To:** Ken D. Schroeder <kschroeder@lancaster.ne.gov>  
**Cc:** Monet J. McCullen <MMcCullen@lancaster.ne.gov>; Craig Schmidt <spkhed@yahoo.com>  
**Subject:** Request for County road review of Gravel Worlds 2019 routes - Saturday August 17, 2019

Hi, Ken –

Hope all is well and you're having a great winter thus far.

LANCASTER  
COUNTY

Pamela L. Dingman, P.E.  
County Engineer

ENGINEERING

Kenneth D. Schroeder, R.L.S.  
Deputy County Surveyor

DEPARTMENT

DATE: March 20, 2019

TO: Monet McCullen  
County Clerk's Office

FROM: Ken Schroeder   
County Surveyor

SUBJECT: SPECIAL EVENTS PERMIT – GRAVEL ADVENTURES, LLC  
GRAVEL WORLDS – BICYCLE RIDE  
SATURDAY, AUGUST 17, 2019 - FROM 6:00 A.M. TO MIDNIGHT

---

Upon review, this office would offer the following comments:

1. No parking allowed along County roads.
2. Suggest using traffic control coordinators at busy intersections to inform the traveling public of the special event in progress.
3. It appears that there are areas of event routes which require traveling along a dirt road. To protect dirt roads from excessive rutting damage due to rainfall, motorized vehicles will not be allowed on dirt roads if they become muddy.
4. The following roadway and/or drainage projects may have an impact on proposed event routes:  
*NOTE: Please reference below listed conflicts with attached "2019 Construction Projects & Gravel Worlds Bicycle Ride" map.*
  - a) There is a drainage pipe replacement project scheduled to be under construction which will require road closings (closing dates are not yet determined). The projects, Culverts F-138 and F-249, are located on N 1<sup>st</sup> Street between W McKelvie Road and W Bluff Road. *Work can be scheduled at this location to not conflict with Gravel Worlds on August 17, 2019.*
  - b) There is a bridge replacement project scheduled for Bridge C-91 which will result in the closure of W Raymond Road from NW 27<sup>th</sup> Street to just east of N 1<sup>st</sup> Street (including the intersection of W Raymond Road and N 1<sup>st</sup> Street). The intersection of W Raymond Road and N 1<sup>st</sup> Street will be closed to vehicular traffic; this work is scheduled between April 1 and November 15, 2019.
  - c) Resurfacing is scheduled on W Raymond Road from west of NW 48<sup>th</sup> Street to east of NW 27<sup>th</sup> Street and from east of N 1<sup>st</sup> Street to N 14<sup>th</sup> Street; this work has not been scheduled. The intersections, with the exception, of N 1<sup>st</sup> Street, should be open to north/south traffic on the weekends.

**SUBJECT:** SPECIAL EVENTS PERMIT – GRAVEL ADVENTURES, LLC  
GRAVEL WORLDS – BICYCLE RIDE  
SATURDAY, AUGUST 17, 2019 - FROM 6:00 A.M. TO MIDNIGHT

- d) Chip sealing is scheduled on NW Crouse Road from W Raymond Road north to W Davey Road; this work has not been scheduled. *Work can be scheduled at this location to not conflict with Gravel Worlds on August 17 and 18, 2019.*
  - e) Chip sealing is scheduled on W Raymond Road from NW Crouse Road east to Highway 79; this work has not been scheduled. The intersections should be open to north/south traffic on the weekends.
  - f) There is work scheduled at Bridge E-117 located on NW 84<sup>th</sup> Street between W Bluff Road and W Waverly Road; however, the road should be open to through traffic and the estimated completion date for this work is July 1, 2019.
  - g) There is a drainage pipe replacement project scheduled to be under construction which will require road closings (closing date is not yet determined). The project, Culvert N-7, is located on W Pioneers Boulevard between SW 84<sup>th</sup> Street and SW 56<sup>th</sup> Street. *Work can be scheduled at this location to not conflict with Gravel Worlds on August 17 and 18, 2019.*
  - h) Resurfacing is scheduled on W Denton Road from SW 112<sup>th</sup> Street east to the village limits of Denton; this work has not been scheduled. *Work can be scheduled at this location to not conflict with Gravel Worlds on August 17 and 18, 2019.*
  - i) When viewing the attached map, there are a few construction sites that may appear to be, in conflict with the proposed bicycle routes. Information for these sites is as follows:
    - a. A drainage pipe replacement project for Culvert M-87 located on W Superior Street west of NW 105<sup>th</sup> Street.
    - b. A bridge replacement project for Bridge N-19 located on W Pioneers Blvd between SW 112<sup>th</sup> Street and SW 98<sup>th</sup> Street.
    - c. A drainage pipe replacement project for Culvert N-11 located on SW 98<sup>th</sup> Street north of W Old Cheney Road.
5. Permits and other regulations and/or permissions of use may be required for areas of this event within the jurisdiction of the Nebraska Department of Transportation, Game and Parks Department, City of Lincoln Public Works Department, Villages of Raymond, Malcolm, Denton and Sprague and applicable neighboring Counties and Villages.
6. Suggest this application be reviewed by applicable law enforcement agencies for safety precautions and reviewed by applicable Attorney's offices for insurance compliance.

**Cc:** Amy Shandera, Lancaster County Sheriff's Office  
Jenifer Holloway, Lancaster County Attorney's Office  
Ron Bohaty, Road Maintenance Division Head

**Attachments:** "2019 Construction Projects & Gravel Worlds Bicycle Ride" map

KDS/bml

F:\Clerical\Private\Special Permits Events-Other\GravelAdventures,LLC2019.docx



# LANCASTER COUNTY, NEBRASKA

## 2019 CONSTRUCTION PROJECTS & GRAVEL WORLDS BICYCLE RIDE

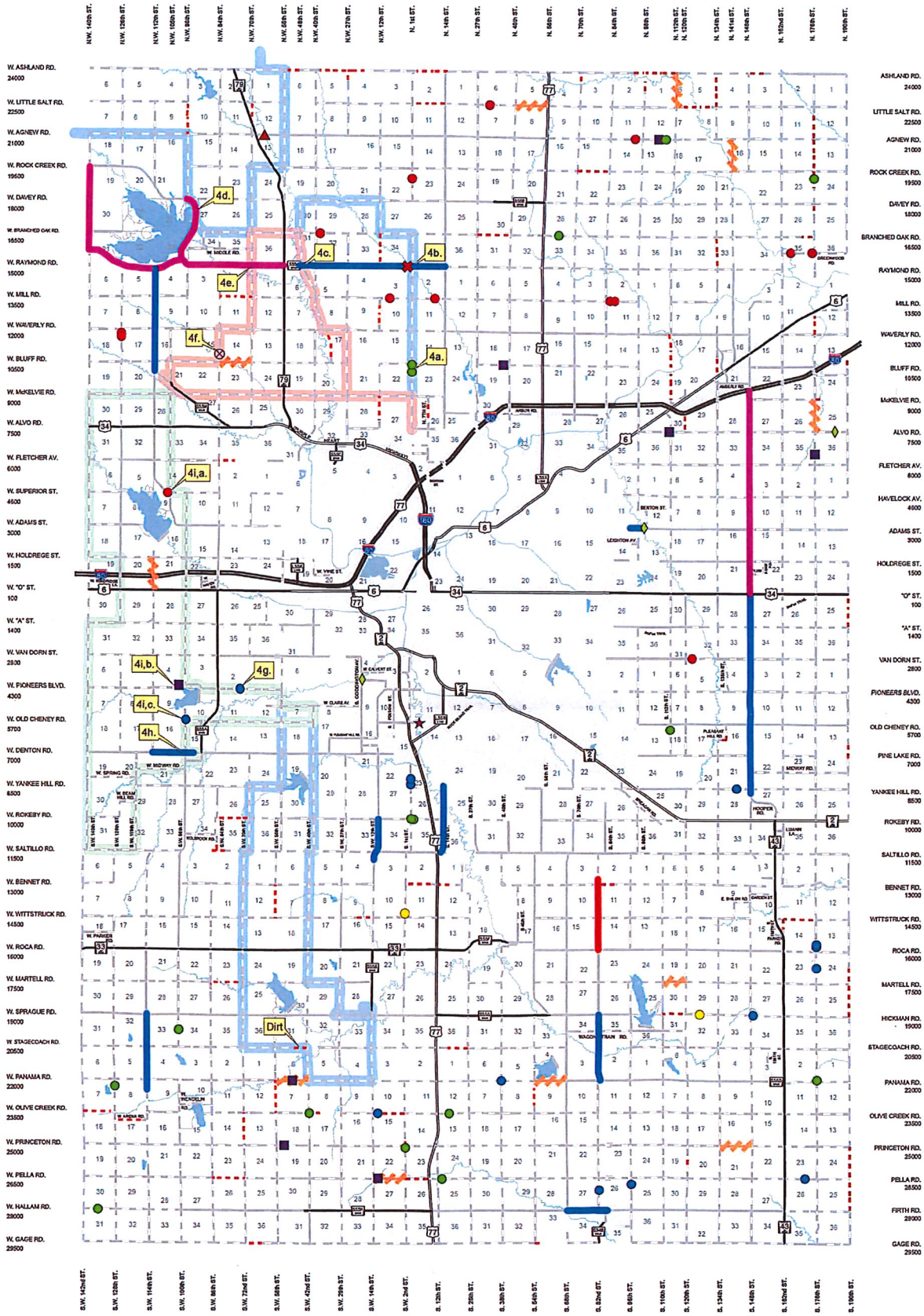

**SOURCE:**  
Lancaster County Records, Lancaster County Engineering Department  
City Limits for Lincoln, City of Lincoln-Lancaster County Planning Department  
Census Bureau TIGER/Line Data, U.S. Department of Commerce  
Digital Aerial Orthophotography, NIROC - Nebraska-Iowa Regional Orthophoto Consortium  
U.S.G.S. Topographic Quadrangles, U.S. Department of the Interior

**CONSTRUCTION**

- BRIDGE
- PHASE I - CULVERTS
- PHASE II - CULVERTS
- CULVERT REPLACEMENT
- COUNTY CULVERTS
- BOX CULVERTS
- DROP PIPES
- BANK STABILIZATION
- CHANNEL REPAIR
- EROSION CONTROL
- RESURFACING
- CHIP SEALING
- GRADING
- CLOSED - INDEFINITELY
- DIRT ROAD

**GRAVEL WORLDS**  
AUG. 17, 2019

- BUCANEER VI
- PRIVATEER VI
- GRAVEL WORLDS VI 0 1 2 3 Miles

**LANCASTER COUNTY ENGINEERING DEPARTMENT**  
444 Chencycreek Road Bldg. C  
Lincoln, Nebraska 68528  
Tel: 402-441-7681 Fax: 402-441-8692  
<http://lancaster.ne.gov/hq/engineering/index.htm>

**LANCASTER COUNTY SURVEYOR**

0 1 2 3 4 Kilometers  
COPYRIGHT © 2017 - LANCASTER COUNTY ENGINEERING DEPARTMENT, NEBRASKA, U.S.A.  
F:\GIS\ConstMap\Road\Race\VCEDConstructionGravelWorld2019.mxd  
Printing Date: 3/15/2019

## Monet J. McCullen

---

**From:** Laura G. Conant  
**Sent:** Monday, March 25, 2019 9:09 AM  
**To:** Monet J. McCullen  
**Cc:** Justin L. Daniel; Kelsey A. Varisco  
**Subject:** RE: Special Event - Gravel Worlds

The Gravel Worlds Bicycle ride event is approved by LLCHD.

Laura Conant, REHS, CP-FS  
Senior Environmental Health Specialist  
Lincoln-Lancaster County Health Department  
402-441-8025

---

**From:** Kelsey A. Varisco  
**Sent:** Friday, March 22, 2019 12:59 PM  
**To:** Laura G. Conant <LConant@lincoln.ne.gov>  
**Cc:** Justin L. Daniel <jdaniel@lincoln.ne.gov>  
**Subject:** FW: Special Event - Gravel Worlds

Hi Laura,  
Could you please review and respond to Monet? Thank you.  
Kelsey

---

**From:** Monet J. McCullen  
**Sent:** Friday, March 22, 2019 10:31 AM  
**To:** Amy L. Shandera <AShandera@lancaster.ne.gov>; Barbi M. Loschen <bloschen@lancaster.ne.gov>; David A. Derbin <DDerbin@lancaster.ne.gov>; David R. Cary <dcary@lincoln.ne.gov>; Greg R. Topil <gtopil@lincoln.ne.gov>; Jenifer T. Holloway <JHolloway@lancaster.ne.gov>; Josh D. Clark <JClark@lancaster.ne.gov>; Justin L. Daniel <jdaniel@lincoln.ne.gov>; Kelsey A. Varisco <KVarisco@lincoln.ne.gov>; Ken D. Schroeder <kschroeder@lancaster.ne.gov>; Robert K. Simmering <RSimmering@lincoln.ne.gov>; Steve S. Henrichsen <shenrichsen@lincoln.ne.gov>; Terry A. Kathe <tkathe@lincoln.ne.gov>; Tom J. Cajka <tcajka@lincoln.ne.gov>  
**Subject:** Special Event - Gravel Worlds

All,  
I have attached a special permit application for Gravel worlds event on August 17, 2019. The applicant's have been working with the Engineering Department for months trying to come up with routes to avoid any County Engineering projects. They are intending to use three separate routes and the riders are able to choose what path they would like to take (I believe all have the same starting and ending point). All three routes are attached, along with the County Engineer recommendation for your reference. Please have your recommendations back to me by Wednesday, May 1, 2019.

Here are also the links they provided if you would like to be able to zoom into the routes:

[https://ridewithgps.com/routes/29079425?privacy\\_code=76AvQVdc2CZYjkhW](https://ridewithgps.com/routes/29079425?privacy_code=76AvQVdc2CZYjkhW)



# Office of the Sheriff Lancaster County

Terry T. Wagner  
Sheriff

Todd Duncan  
Chief Deputy

575 S. 10th Street, Lincoln, Nebraska 68508-2869  
Phone (402) 441-6500 Fax (402) 441-8320



---

March 22, 2019

Ms. Monet McCullen  
Lancaster County Clerk's Office  
County-City Building  
Lincoln, NE 68508

Re: Special Events Permit from Corey Godfrey and Craig Schmidt with Gravel Adventures, LLC..

Dear Ms. McCullen:

This letter is regarding a request for a Special Events Permit from Corey Godfrey and Craig Schmidt with Gravel Adventures, LLC to hold "Gravel Worlds" a bicycle ride on roads maintained by Lancaster County. The race will take place on August 17<sup>th</sup> 2019, between the hours of 6:00 am and 00:00 am and will include approximately 500 participants. The event will start in the Fallbrook area and participants will have three separate routes they are able to choose from. There are also three separate maps that are provided to show the routes.

In examining the application for the "Gravel Worlds bicycle ride" we recommend the following:

- 1) Prior to the event, the organizer must review the course to determine potential problems that could endanger participants and equipment. The organizer is responsible for noting these problems to the participants, and if severe enough, shall cancel the race.
  - 2) Crowd control and spectator parking must be addressed. Adequate parking, restrooms, and spectator space must be provided to avoid parking and spectator spill over onto the road and assure safe conditions. Parking and other associated facilities shall be located off highway right of way, unless established vehicle parking areas, such as park and ride lots, are available.
  - 3) Riders shall follow rules of the road unless special traffic control is approved and provided.
  - 4) Approaches to all major intersections shall be controlled by corner marshals should display advance warning signs.
- 
-

- 5) Any individuals involved in directing traffic shall wear a Class 2 high-visibility vest meeting American National Safety Institute (ANSI) standards.
- 6) Applicants must follow all suggestions of the County Engineers Office and abide by their safety and precautionary suggestions.
- 7) Event organizers are responsible for clean-up of the race course after the event. This includes removal of water bottles, food bags, and other race litter along the course.

The Lancaster County Sheriff's Office has no objections to this permit if the applicants follow the listed suggestions.

Sincerely,

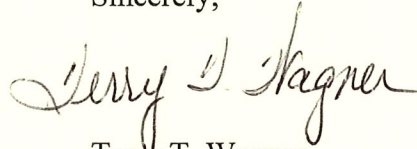
A handwritten signature in cursive script that reads "Terry T. Wagner". The signature is written in black ink and is positioned above the printed name.

Terry T. Wagner  
Lancaster County Sheriff