

BEFORE THE BOARD OF COUNTY COMMISSIONERS
OF LANCASTER COUNTY, NEBRASKA

IN THE MATTER OF THE)
CLOSURE OF BRIDGES S-179, Q-110,) RESOLUTION NO. R-19-0026
Y-74 AND CULVERT M-38)

WHEREAS, general supervision and control of the public roads of Lancaster County (“County”) is vested in the Board of County Commissioners of Lancaster County, Nebraska, (the “Board”) pursuant to Neb. Rev. Stat. § 39-1402;

WHEREAS, the Lancaster County Engineer (“Engineer”) in her capacity as County Highway Superintendent, has control, government, and supervision of all the public roads and bridges in the county under the general supervision and control of the Board pursuant to Neb. Rev. Stat. § 39-1507;

WHEREAS, the Engineer on March 20, 2019, discovered that Bridge S-179, located on Roca Road between S 96th Street and S 110th Street, presented a clear and present danger to the public;

WHEREAS, the Engineer on March 20, 2019, discovered that Culvert M-38, located on W A Street between SW 98th Street and SW 112th Street, presented a clear and present danger to the public;

WHEREAS, the Engineer on March 27, 2019, discovered that Bridge Q-110, located on Pine Lake Road between S 120th Street and S 134th Street, presented a clear and present danger to the public;

WHEREAS, the Engineer on March 27, 2019, discovered that Bridge Y-74, located on S 148th Street between Pella Road and Firth Road, presented a clear and present danger to the public;

WHEREAS, the Engineer has temporarily closed Bridges S-179, Q-110, Y-74 and Culvert

M-38 to mitigate the clear and present danger to the public;

WHEREAS, the Engineer recommends Bridges S-179, Q-110, Y-74 and Culvert M-38 remain closed until appropriate steps can be taken to eliminate the clear and present danger to the public;

NOW, THEREFORE, BE IT RESOLVED, by the Board of County Commissioners of Lancaster County that the Board accepts the recommendation of the Lancaster County Engineer, and that therefore the Board, pursuant to its supervisory powers contained in Neb. Rev. Stat. §§ 39-1402 and 39-1507, hereby closes Bridges S-179, Q-110, Y-74 and Culvert M-38, to alleviate a clear and present danger to the public.

DATED this _____ day of April, 2019, at the County-City Building, Lincoln, Lancaster County Nebraska.

BY THE BOARD OF COUNTY
COMMISSIONERS OF LANCASTER
COUNTY, NEBRASKA

APPROVED AS TO FORM
this _____ day of
April, 2019.

for PAT CONDON
Lancaster County Attorney

LANCASTER COUNTY, NEBRASKA



NO SCALE

NW 140TH ST. NW 126TH ST. NW 112TH ST. NW 105TH ST. NW 98TH ST. NW 84TH ST. NW 70TH ST. NW 66TH ST. NW 40TH ST. NW 27TH ST. NW 12TH ST. N. 1ST ST. N. 14TH ST. N. 27TH ST. N. 40TH ST. N. 56TH ST. N. 70TH ST. N. 84TH ST. N. 98TH ST. N. 112TH ST. N. 120TH ST. N. 134TH ST. N. 141ST ST. N. 148TH ST. N. 162ND ST. N. 176TH ST. N. 190TH ST.

W. ASHLAND RD.
W. LITTLE SALT RD.
W. AGNEW RD.
W. ROCK CREEK RD.
W. DAVEY RD.
W. BRANCHED OAK RD.
W. RAYMOND RD.
W. MILL RD.
W. WAVERLY RD.
W. BLUFF RD.
W. MCKELVIE RD.
W. ALVO RD.
W. FLETCHER AV.
W. SUPERIOR ST.
W. ADAMS ST.
W. HOLDREGE ST.
W. 'O' ST.
W. 'A' ST.
W. VAN DORN ST.
W. PIONEERS BLVD.
W. OLD CHENEY RD.
W. DENTON RD.
W. YANKEE HILL RD.
W. ROKEBY RD.
W. SALTILLO RD.
W. BENNET RD.
W. WITTSTRUCK RD.
W. ROCA RD.
W. MARTELL RD.
W. SPRAGUE RD.
W. STAGECOACH RD.
W. PANAMA RD.
W. OLIVE CREEK RD.
W. PRINCETON RD.
W. PELLA RD.
W. HALLAM RD.
W. GAGE RD.

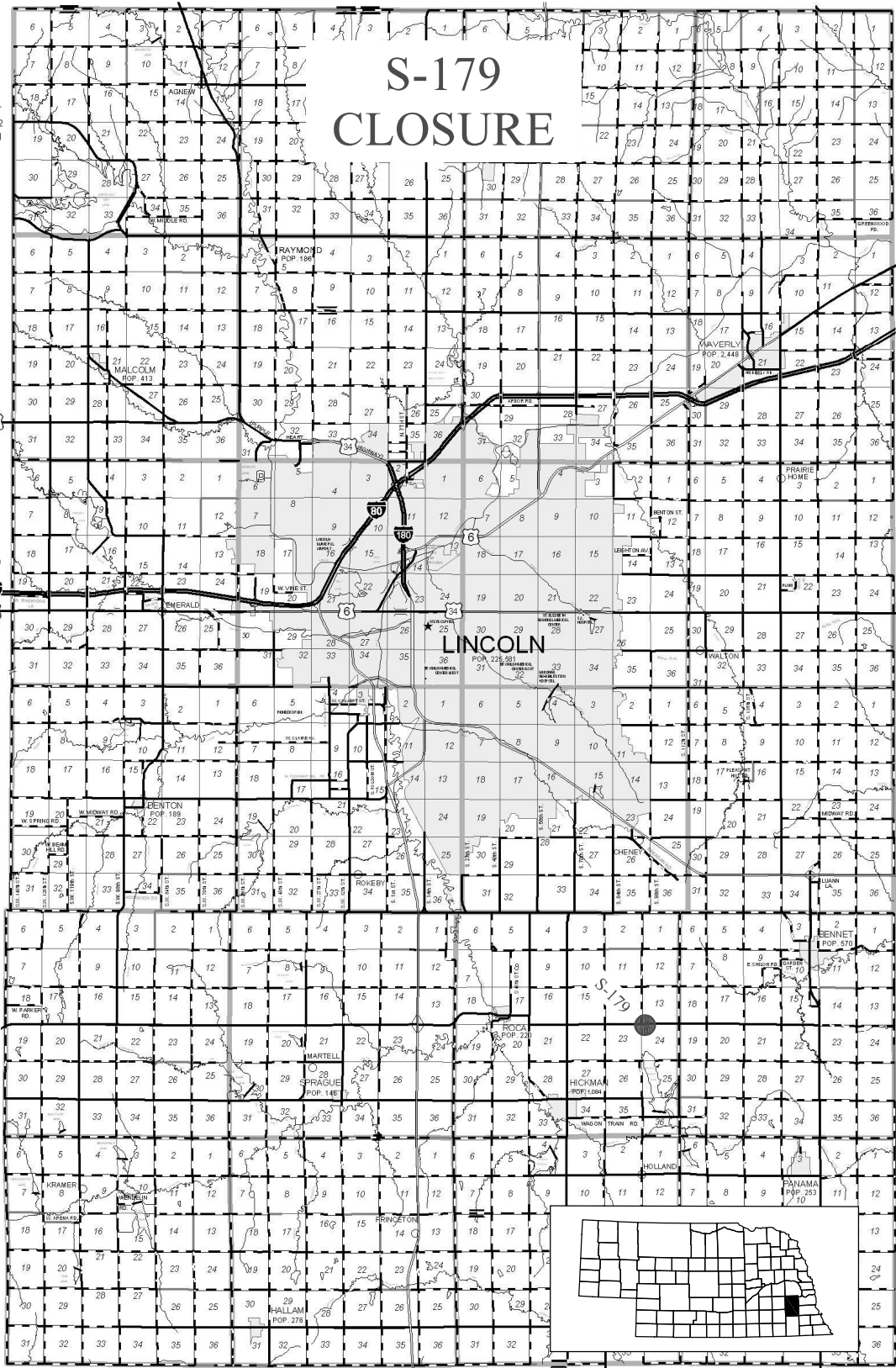

ASHLAND RD.
LITTLE SALT RD.
AGNEW RD.
ROCK CREEK RD.
DAVEY RD.
BRANCHED OAK RD.
RAYMOND RD.
MILL RD.
WAVERLY RD.
BLUFF RD.
MCKELVIE RD.
ALVO RD.
FLETCHER AV.
HAVELOCK AV.
ADAMS ST.
HOLDREGE ST.
'O' ST.
'A' ST.
VAN DORN ST.
PIONEERS BLVD.
OLD CHENEY RD.
PINE LAKE RD.
YANKEE HILL RD.
ROKEBY RD.
SALTILLO RD.
BENNET RD.
WITTSTRUCK RD.
ROCA RD.
MARTELL RD.
HICKMAN RD.
STAGECOACH RD.
PANAMA RD.
OLIVE CREEK RD.
PRINCETON RD.
PELLA RD.
FIRTH RD.
GAGE RD.

SW 142ND ST. SW 128TH ST. SW 114TH ST. SW 100TH ST. SW 86TH ST. SW 72ND ST. SW 58TH ST. SW 42ND ST. SW 29TH ST. SW 14TH ST. SW 2ND ST. S. 12TH ST. S. 25TH ST. S. 38TH ST. S. 54TH ST. S. 68TH ST. S. 82ND ST. S. 96TH ST. S. 110TH ST. S. 120TH ST. S. 134TH ST. S. 148TH ST. S. 162ND ST. S. 176TH ST. S. 190TH ST.

LANCASTER COUNTY, NEBRASKA



NW 140TH ST.
NW 126TH ST.
NW 112TH ST.
NW 105TH ST.
NW 98TH ST.
NW 84TH ST.
NW 70TH ST.
NW 56TH ST.
NW 40TH ST.
NW 27TH ST.
NW 12TH ST.
N. 1ST ST.
N. 14TH ST.
N. 27TH ST.
N. 40TH ST.
N. 56TH ST.
N. 70TH ST.
N. 84TH ST.
N. 98TH ST.
N. 112TH ST.
N. 120TH ST.
N. 134TH ST.
N. 141ST ST.
N. 148TH ST.
N. 162ND ST.
N. 176TH ST.
N. 190TH ST.

W. ASHLAND RD.
 W. LITTLE SALT RD.
 W. AGNEW RD.
 W. ROCK CREEK RD.
 W. DAVEY RD.
 W. BRANCHED OAK RD.
 W. RAYMOND RD.
 W. MILL RD.
 W. WAVERLY RD.
 W. BLUFF RD.
 W. McKELVIE RD.
 W. ALVO RD.
 W. FLETCHER AV.
 W. SUPERIOR ST.
 W. ADAMS ST.
 W. HOLDREGE ST.
 W. 'O' ST.
 W. 'A' ST.
 W. VAN DORN ST.
 W. PIONEERS BLVD.
 W. OLD CHENEY RD.
 W. DENTON RD.
 W. YANKEE HILL RD.
 W. ROKEBY RD.
 W. SALTILLO RD.
 W. BENNET RD.
 W. WITTSTRUCK RD.
 W. ROCA RD.
 W. MARTELL RD.
 W. SPRAGUE RD.
 W. STAGECOACH RD.
 W. PANAMA RD.
 W. OLIVE CREEK RD.
 W. PRINCETON RD.
 W. PELLA RD.
 W. HALLAM RD.
 W. GAGE RD.

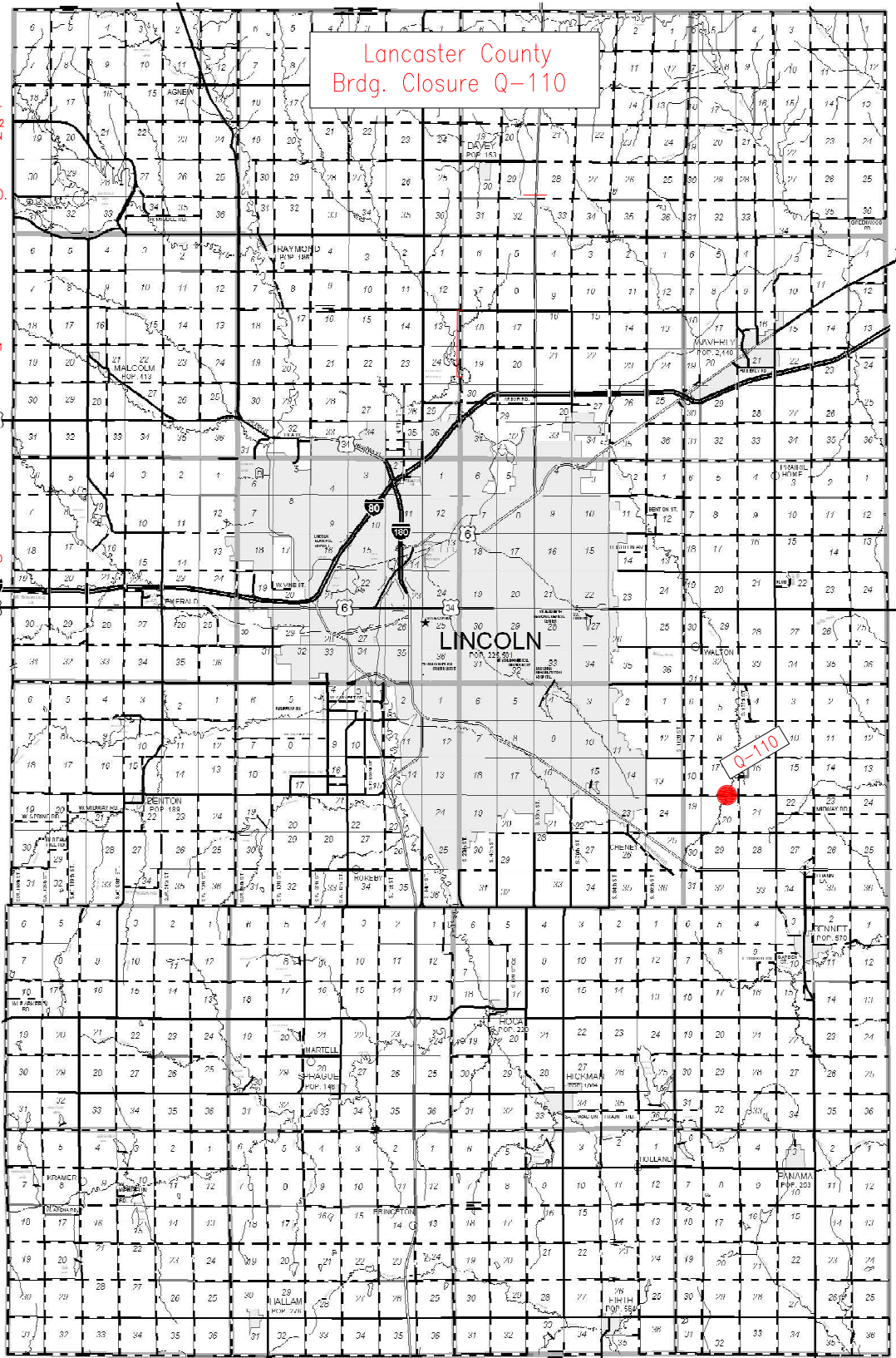

ASHLAND RD.
 LITTLE SALT RD.
 AGNEW RD.
 ROCK CREEK RD.
 DAVEY RD.
 BRANCHED OAK RD.
 RAYMOND RD.
 MILL RD.
 WAVERLY RD.
 BLUFF RD.
 McKELVIE RD.
 ALVO RD.
 FLETCHER AV.
 HAVELOCK AV.
 ADAMS ST.
 HOLDREGE ST.
 'O' ST.
 'A' ST.
 VAN DORN ST.
 PIONEERS BLVD.
 OLD CHENEY RD.
 PINE LAKE RD.
 YANKEE HILL RD.
 ROKEBY RD.
 SALTILLO RD.
 BENNET RD.
 WITTSTRUCK RD.
 ROCA RD.
 MARTELL RD.
 HICKMAN RD.
 STAGECOACH RD.
 PANAMA RD.
 OLIVE CREEK RD.
 PRINCETON RD.
 PELLA RD.
 FIRTH RD.
 GAGE RD.

SW 142ND ST.
SW 128TH ST.
SW 114TH ST.
SW 100TH ST.
SW 86TH ST.
SW 72ND ST.
SW 58TH ST.
SW 42ND ST.
SW 29TH ST.
SW 14TH ST.
SW 2ND ST.
S. 12TH ST.
S. 25TH ST.
S. 38TH ST.
S. 54TH ST.
S. 68TH ST.
S. 82ND ST.
S. 96TH ST.
S. 110TH ST.
S. 120TH ST.
S. 134TH ST.
S. 148TH ST.
S. 162ND ST.
S. 176TH ST.
S. 190TH ST.

LANCASTER COUNTY, NEBRASKA

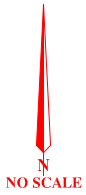

NW 140TH ST. NW 126TH ST. NW 112TH ST. NW 105TH ST. NW 98TH ST. NW 84TH ST. NW 70TH ST. NW 56TH ST. NW 40TH ST. NW 27TH ST. NW 12TH ST. N. 1ST ST. N. 14TH ST. N. 27TH ST. N. 40TH ST. N. 56TH ST. N. 70TH ST. N. 84TH ST. N. 98TH ST. N. 112TH ST. N. 120TH ST. N. 134TH ST. N. 141ST ST. N. 148TH ST. N. 162ND ST. N. 176TH ST. N. 190TH ST.

R 5 E R 6 E R 7 E R 8 E

W. ASHLAND RD.
 W. LITTLE SALT RD.
 W. AGNEW RD.
 W. ROCK CREEK RD.
 W. DAVEY RD.
 W. BRANCHED OAK RD.
 W. RAYMOND RD.
 W. MILL RD.
 W. WAVERLY RD.
 W. BLUFF RD.
 W. McKELVIE RD.
 W. ALVO RD.
 W. FLETCHER AV.
 W. SUPERIOR ST.
 W. ADAMS ST.
 W. HOLDREGE ST.
 W. 'O' ST.
 W. 'A' ST.
 W. VAN DORN ST.
 W. PIONEERS BLVD.
 W. OLD CHENEY RD.
 W. DENTON RD.
 W. YANKEE HILL RD.
 W. ROKEBY RD.
 W. SALTILLO RD.
 W. BENNET RD.
 W. WITTSTRUCK RD.
 W. ROCA RD.
 W. MARTELL RD.
 W. SPRAGUE RD.
 W. STAGECOACH RD.
 W. PANAMA RD.
 W. OLIVE CREEK RD.
 W. PRINCETON RD.
 W. PELLA RD.
 W. HALLAM RD.
 W. GAGE RD.

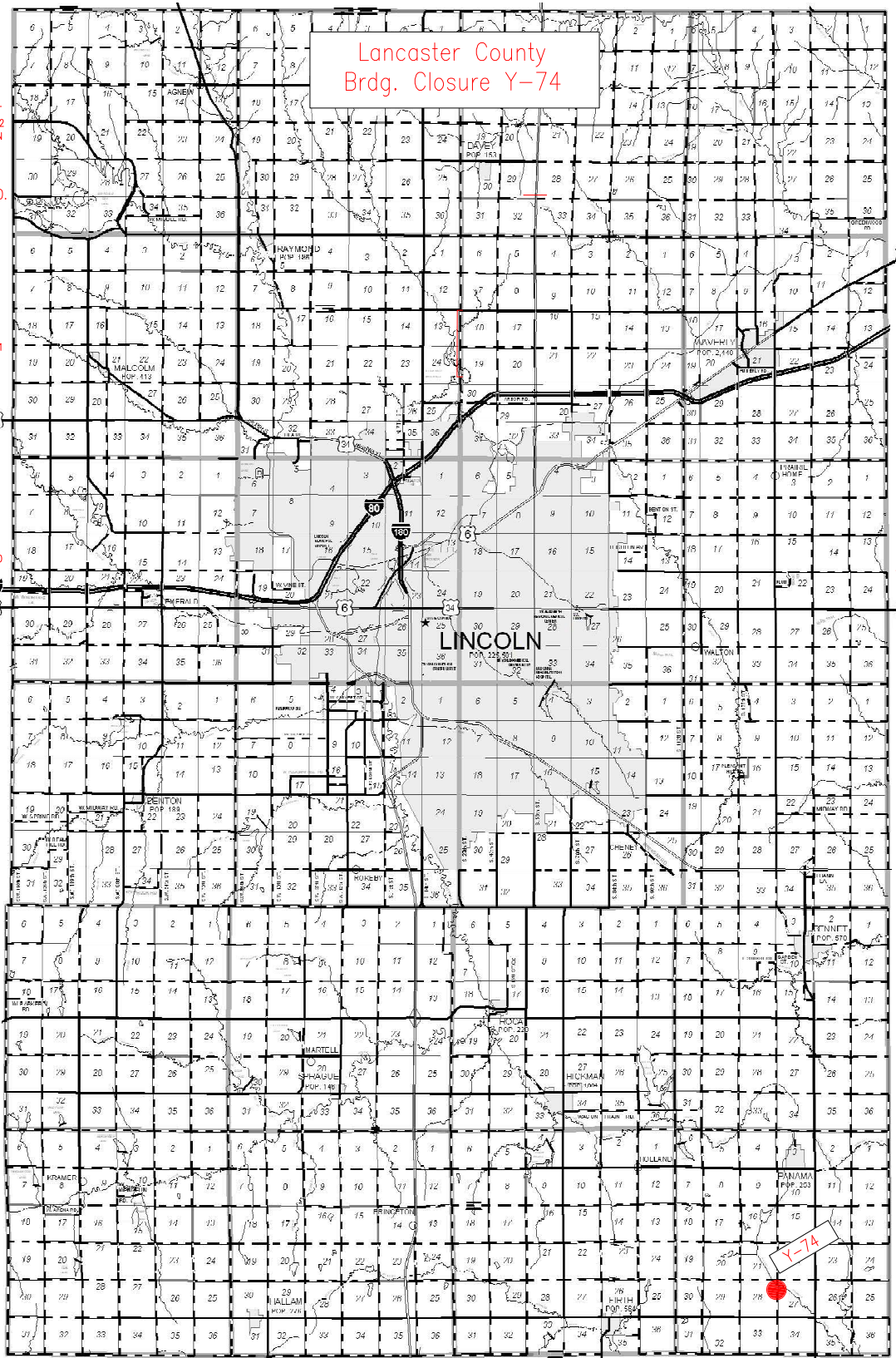

ASHLAND RD.
 LITTLE SALT RD.
 AGNEW RD.
 ROCK CREEK RD.
 DAVEY RD.
 BRANCHED OAK RD.
 RAYMOND RD.
 MILL RD.
 WAVERLY RD.
 BLUFF RD.
 McKELVIE RD.
 ALVO RD.
 FLETCHER AV.
 HAVELOCK AV.
 ADAMS ST.
 HOLDREGE ST.
 'O' ST.
 'A' ST.
 VAN DORN ST.
 PIONEERS BLVD.
 OLD CHENEY RD.
 PINE LAKE RD.
 YANKEE HILL RD.
 ROKEBY RD.
 SALTILLO RD.
 BENNET RD.
 WITTSTRUCK RD.
 ROCA RD.
 MARTELL RD.
 HICKMAN RD.
 STAGECOACH RD.
 PANAMA RD.
 OLIVE CREEK RD.
 PRINCETON RD.
 PELLA RD.
 FIRTH RD.
 GAGE RD.

SW 142ND ST. SW 128TH ST. SW 114TH ST. SW 100TH ST. SW 86TH ST. SW 72ND ST. SW 58TH ST. SW 42ND ST. SW 29TH ST. SW 14TH ST. SW 2ND ST. S. 12TH ST. S. 25TH ST. S. 38TH ST. S. 54TH ST. S. 68TH ST. S. 82ND ST. S. 96TH ST. S. 110TH ST. S. 120TH ST. S. 134TH ST. S. 148TH ST. S. 162ND ST. S. 176TH ST. S. 190TH ST.

R 5 E R 6 E R 7 E R 8 E

LANCASTER COUNTY, NEBRASKA



NO SCALE

NW 140TH ST. NW 126TH ST. NW 112TH ST. NW 105TH ST. NW 98TH ST. NW 84TH ST. NW 70TH ST. NW 66TH ST. NW 40TH ST. NW 27TH ST. NW 12TH ST. N. 1ST ST. N. 14TH ST. N. 27TH ST. N. 40TH ST. N. 56TH ST. N. 70TH ST. N. 84TH ST. N. 98TH ST. N. 112TH ST. N. 120TH ST. N. 134TH ST. N. 141ST ST. N. 148TH ST. N. 162ND ST. N. 176TH ST. N. 190TH ST.

R5E

R6E

R7E

R8E

W. ASHLAND RD.
W. LITTLE SALT RD.
W. AGNEW RD.
W. ROCK CREEK RD.
W. DAVEY RD.
W. BRANCHED OAK RD.
W. RAYMOND RD.
W. MILL RD.
W. WAVERLY RD.
W. BLUFF RD.
W. MCKELVIE RD.
W. ALVO RD.
W. FLETCHER AV.
W. SUPERIOR ST.
W. ADAMS ST.
W. HOLDREGE ST.
W. 'O' ST.
W. 'A' ST.
W. VAN DORN ST.
W. PIONEERS BLVD.
W. OLD CHENEY RD.
W. DENTON RD.
W. YANKEE HILL RD.
W. ROKEYB RD.
W. SALTILLO RD.
W. BENNET RD.
W. WITTSTRUCK RD.
W. ROCA RD.
W. MARTELL RD.
W. SPRAGUE RD.
W. STAGECOACH RD.
W. PANAMA RD.
W. OLIVE CREEK RD.
W. PRINCETON RD.
W. PELLA RD.
W. HALLAM RD.
W. GAGE RD.

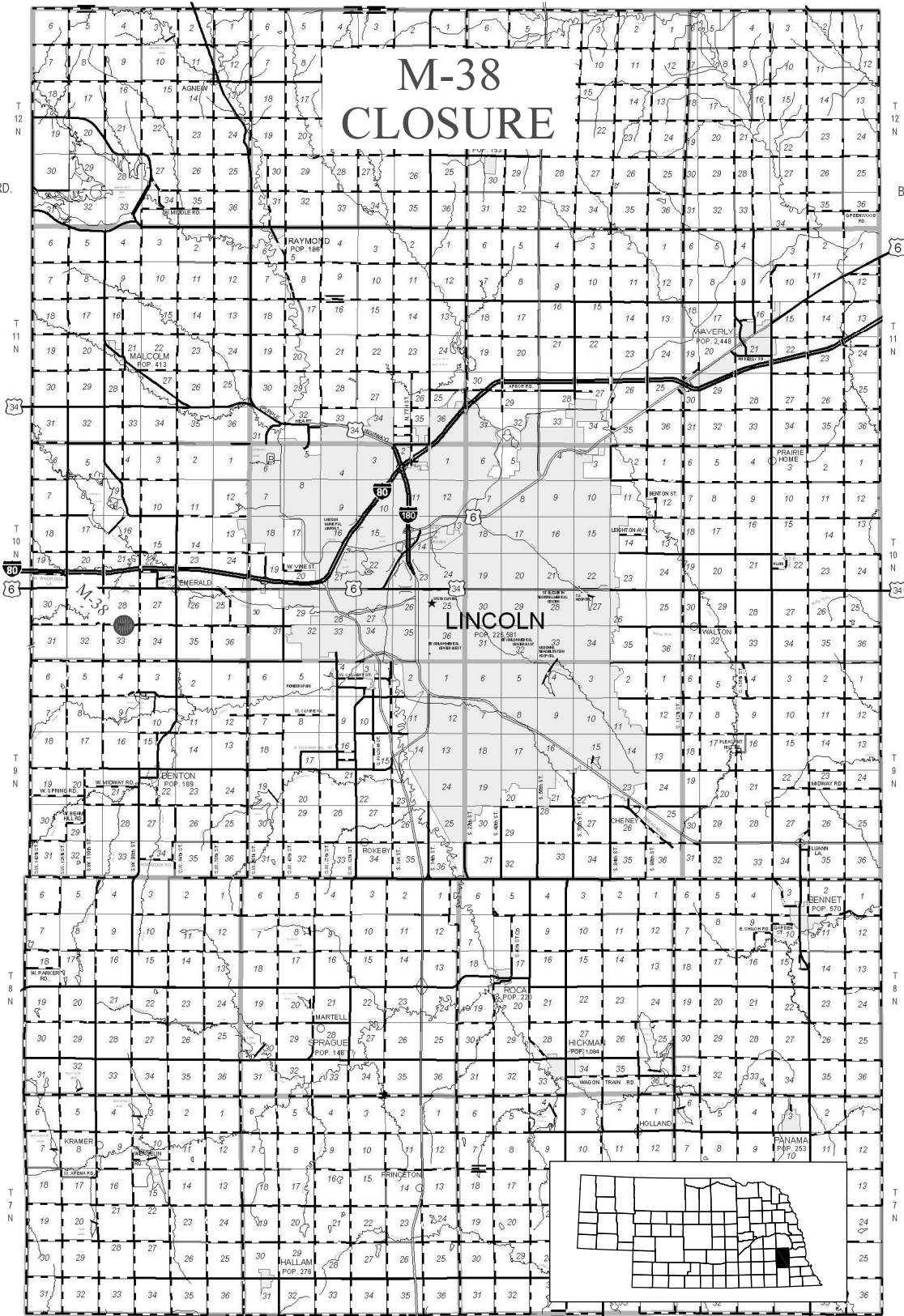

ASHLAND RD.
LITTLE SALT RD.
AGNEW RD.
ROCK CREEK RD.
DAVEY RD.
BRANCHED OAK RD.
RAYMOND RD.
MILL RD.
WAVERLY RD.
BLUFF RD.
MCKELVIE RD.
ALVO RD.
FLETCHER AV.
HAVELOCK AV.
ADAMS ST.
HOLDREGE ST.
'O' ST.
'A' ST.
VAN DORN ST.
PIONEERS BLVD.
OLD CHENEY RD.
PINE LAKE RD.
YANKEE HILL RD.
ROKEYB RD.
SALTILLO RD.
BENNET RD.
WITTSTRUCK RD.
ROCA RD.
MARTELL RD.
HICKMAN RD.
STAGECOACH RD.
PANAMA RD.
OLIVE CREEK RD.
PRINCETON RD.
PELLA RD.
FIRTH RD.
GAGE RD.

SW 142ND ST. SW 128TH ST. SW 114TH ST. SW 100TH ST. SW 86TH ST. SW 72ND ST. SW 58TH ST. SW 42ND ST. SW 29TH ST. SW 14TH ST. SW 2ND ST. S. 12TH ST. S. 25TH ST. S. 38TH ST. S. 54TH ST. S. 68TH ST. S. 82ND ST. S. 96TH ST. S. 110TH ST. S. 120TH ST. S. 134TH ST. S. 148TH ST. S. 162ND ST. S. 176TH ST. S. 190TH ST.

R5E

R6E

R7E

R8E