

**STAFF MEETING MINUTES  
LANCASTER COUNTY BOARD OF COMMISSIONERS  
THURSDAY, SEPTEMBER 13, 2018  
COUNTY-CITY BUILDING  
ROOM 113 - BILL LUXFORD STUDIO  
8:30 A.M.**

Commissioners Present: Todd Wiltgen, Chair; Jennifer Brinkman, Vice Chair; Deb Schorr, Roma Amundson and Bill Avery

Others Present: Kerry Eagan, Chief Administrative Officer; Ann Ames, Deputy Chief Administrative Officer; Dan Nolte, County Clerk; Cori Beattie, Deputy County Clerk and Leslie Brestel, County Clerk's Office

*Advance public notice of the Board of Commissioners Staff Meeting was posted on the County-City Building bulletin board and the Lancaster County, Nebraska web site and provided to the media on September 12, 2018.*

The Chair noted the location of the Open Meetings Act and opened the meeting at 8:31 a.m.

**AGENDA ITEM**

**1) APPROVAL OF STAFF MEETING MINUTES FOR SEPTEMBER 4, 2018 AND THE LEGISLATIVE RETREAT SEPTEMBER 6, 2018**

**MOTION:** Brinkman moved and Schorr seconded approval of the September 4, 2018 Staff Meeting minutes. Avery, Brinkman, Schorr and Wiltgen voted yes. Amundson was absent. Motion carried 4-0.

**MOTION:** Brinkman moved and Schorr seconded approval of the September 6, 2018 Legislative Retreat minutes.

The Chair asked for any discussion. Brinkman said the NACO Legislative Retreat date needs to be corrected in the minutes from September 11, 2018 to October 11, 2018.

**ROLL CALL:** Avery, Brinkman, Schorr and Wiltgen voted yes. Amundson was absent. Motion carried 4-0.

Amundson entered the meeting at 8:35 a.m.

Wiltgen exited and re-entered the meeting at 8:35 a.m. and 8:39 a.m., respectively.

**2) INSURANCE RENEWALS – Sue Eckley, County Risk Manager; and Tom Champoux, UNICO President**

Sue Eckley, County Risk Manager; and Tom Champoux, UNICO President, presented the Insurance Review for Lancaster County (see agenda packet). The following items were highlighted: Trabert

Hall (has its own stand-alone insurance policy), drone coverage, admitted and non-admitted insurance carriers, and terrorism coverage. Eckley noted the County will compare market rates for Master Auto and Sheriff's Department auto insurances. Champoux reviewed the auto loss history for the past five years.

Amundson asked if the Master Auto rates are due to experience and types of vehicles. Champoux answered rates are dependent on the County's own loss rates and the national loss experience.

Wiltgen inquired about any additional reviews of the cyber liability policy. Eckley stated there have been no reviews but she recommended one.

**MOTION:** Amundson moved and Schorr seconded to authorize the Chair to sign the insurance forms.

The Chair asked for any discussion. Schorr noted the Board is declining terrorism insurance.

**ROLL CALL:** Amundson, Avery, Wiltgen, Brinkman and Schorr voted yes. Motion carried 5-0.

**3) SECOND QUARTER 2018 INVESTMENT REVIEW FOR THE 401(a) LANCASTER COUNTY EMPLOYEES RETIREMENT PLAN AND THE 457(b) DEFERRED COMPENSATION PROGRAM** – Mike McCann, Prudential Vice President, Key Accounts; Robb D. Craddock, Prudential Vice President, Investment Strategy; Frank Picarelli, Senior Vice President, Segal Marco Advisors; and Crystal Vacura, Team Leader West/Midwest Plans and Senior Counselor for Lancaster County

Robb D. Craddock, Prudential Vice President, Investment Strategy; Frank Picarelli, Senior Vice President, Segal Marco Advisors; and Leah Kaslik, Prudential Insurance, Account Representative, joined by conference call.

Craddock, Picarelli, McCann, and Vacura reviewed the Investment Monitor (see agenda packet) with the following highlights: the indication of a possible recession or market correction; the Gibraltar Guaranteed fund was replaced with the Prudential Stable Value fund; the decrease in amount of distributed assets, and Goalmaker. McCann outlined the upgrade to the Prudential website, featuring a personalized, customizable financial wellness module.

Amundson asked for contributing factors to a downturn. Craddock said a correction is defined as a 10% downturn from market peak to market drop. He feels valuations are on the high end.

Avery asked if the Oakmark Equity and Income Investor fund was still available to which Eagan replied yes, although there were discussions last year of eliminating it; however, due to consolidation challenges, the fund was not eliminated.

Brinkman exited and re-entered the meeting at 9:43 a.m. and 9:47 a.m., respectively.

Schorr asked if the decrease in amount of distributed assets is normal. McCann said no, with baby boomers retiring the distribution tends to go up.

**4) 2018 ONE AND SIX YEAR ROAD AND BRIDGE PROGRAM** – Pam Dingman, Lancaster County Engineer

Pam Dingman, Lancaster County Engineer, reviewed the One and Six Year Road and Bridge Construction Program Fiscal Year 2019 draft report (Exhibit A). This next year's focus will be maintenance and fixing of roads and bridges. The Engineer's Office is reviewing several new processes to extend the life of asphalt: foam injection systems; micro-overlays; and tack coats.

Currently, thirteen bridges are closed, many of which are scour critical. There are concerns for four bridges and structures around Raymond Road and North 14th Street. Wiltgen asked if these are bridged box culverts or replacements. Dingman replied F88 is a bridge to bridge; F86, F82 and F78 are all currently bridges which perhaps two can be bridge to box culverts. These could be considered for the Transportation Innovation Act.

Dingman reviewed the standby projects, focusing on the East Beltway with possible purchase of 57 acres of East Beltway property, and pavement needs for detours of South Beltway construction. The State plans to close portions of Highway 77 and Saltillo Road during construction.

Dingman reviewed Scour Critical Bridges (Exhibit B) and hoped to have only 18 left by the end of 2018 construction.

Wiltgen asked for the status on 98<sup>th</sup> Street, from O Street to the south. Dingman stated there is no funding in the current budget for pavement. The City asked the County to shift the pavement section ten feet, which would require extensive flood plain work and environmental permits. She felt the City should do that or the City and the County could mutually apply for aid.

The One and Six Year Road and Bridge Construction Program hearing was set for October 9, 2018 at 6:30 p.m. at the City-County Building. Staff will be available 30 minutes early for discussion.

**5) POTENTIAL LITIGATION** – Jen Holloway, Deputy County Attorney; Sara Hoyle, Human Services Director; and Pam Dingman, Lancaster County Engineer

**MOTION:** Schorr moved and Amundson seconded to enter Executive Session at 10:29 a.m. for the purposes of potential litigation and to protect public interest.

The Chair said it has been moved and seconded that the Board enter Executive Session.

**ROLL CALL:** Avery, Amundson, Brinkman, Schorr and Wiltgen voted yes. Motion carried 5-0.

The Chair restated the purpose for the Board entering Executive Session.

Avery and Schorr exited the meeting.

**MOTION:** Amundson moved and Brinkman seconded to exit Executive Session at 11:00 a.m. Amundson, Brinkman and Wiltgen voted yes. Avery and Schorr were absent. Motion carried 3-0.

## **6) ANNUAL REPORT FROM SARA HOYLE – Human Services Director**

Schorr and Avery entered the meeting at 11:02 a.m. and 11:05 a.m. respectively.

Sara Hoyle, Human Services Director, reviewed the Lincoln/Lancaster Human Services Annual Report (Exhibit E), highlighting lower Diversion numbers; pre-adjudication services; Operation Tipping Point; Keno funds; General Assistance client application, assistance and programs; Social Security Audit; the contract with Department of Law and Psychology at University of Nebraska-Lincoln (UNL) for expanded data analysis efforts with non-profit organizations; and crisis stabilization for youth if LB 1112 is passed.

Wiltgen asked how the Truancy Diversion model is working in out-state Nebraska. Hoyle answered Judge Reggie Ryder, Lancaster County Juvenile Court, has spoken with out-state Nebraska judges about truancy diversion. Hoyle said UNL is studying data on the outcomes of judges versus county attorneys leading the session.

Schorr asked if youth can go through the Restore program more than once. Hoyle answered it is a one-time only pre-diversion program.

Hoyle discussed how the Diversion program is reviewed with minority families, especially immigrant and refugee families. She reviewed the Qualtrics survey sent to Diversion families. An additional question will be added to the survey regarding parental expectations.

Hoyle reported Probation is looking at partnering with Cedars for a reception center for the Probation screening process. Chief Jeff Bleimeister, Lincoln Police Department, has agreed to pilot the partnership for misdemeanor cases. Due to staffing requests and the lack of inclusive discussion with all parties involved, Hoyle is concerned as pre-adjudicated services are statutorily paid for by the County.

Regarding Operation Tipping Point, Brinkman suggested incorporating a multi-media approach to the advertising of successful minority leaders in the community.

Wiltgen asked Hoyle how Medicaid expansion will affect services. Hoyle said the County's responsibilities will depend on how the law is written.

Hoyle stressed more behavioral health funding is needed to better serve clients. She stated she would also like more leadership and management training for herself and additional training for staff on how to work with juveniles. Hoyle felt she has support from Human Resources regarding resources and guidance aimed at helping staff become better at their jobs.

## **7) CHIEF ADMINISTRATIVE OFFICER REPORT**

### **A. Tax Equalization Review Commission (TERC) Expert Contract**

Kerry Eagan, Chief Administrative Officer, presented the Board with rates from Great Plains Appraisal related to the Tax Equalization Review Commission (TERC) expert contract. Rates from Kubert Appraisal Group were presented at the September 4, 2018 staff meeting. Schorr felt the County's



over twenty years of experience with Tom Kubert were insignificant to the dollar amount difference.

**MOTION:** Schorr moved and Amundson seconded to award the TERC expert contract to Kubert Appraisal Group. Brinkman, Schorr, Avery, Amundson and Wiltgen voted yes. Motion carried 5-0.

- B.** Claim for Review – PV # 622825 – 622827 to Tamara Jo Dirks, M.S., LADC From the Mental Health Crisis Center in the Amount of \$238.00. This Provider Does Not Have a Current Contract.

Scott Etherton, Mental Health Crisis Center Director, said the contract had expired but the services were still being used. He said the new software system has a section for employee reminders, which will be used to track contracts.

**MOTION:** Brinkman moved and Amundson seconded to move the claim to the next Tuesday meeting as a regular claim. Brinkman, Schorr, Avery, Amundson and Wiltgen voted yes. Motion carried 5-0.

- C.** Claim for Review – PV # 622824 – to Dr. Zakaria Siddiqui, From the Mental Health Crisis Center in the Amount of \$3,625.00. This Provider Does Not Have a Current Contract.

See Item 7. B. for explanation.

**MOTION:** Brinkman moved and Schorr seconded to move the claim to the next Tuesday meeting as a regular claim. Brinkman, Schorr, Avery, Amundson and Wiltgen voted yes. Motion carried 5-0.

- D.** Claim for Review - PV # 623416 – to NexTraq from the Lancaster County Assessor in The Amount of \$493.05. The Invoice is Dated April 15, 2018. This Claim is Beyond the 90 Day Time Period.

Eagan reported the claim was beyond the 90-day time period due to miscommunication on the invoice.

**MOTION:** Amundson moved and Brinkman seconded to move the claim to the next Tuesday meeting as a regular claim.

The Chair asked for any discussion. Schorr asked why the Assessor is paying for cellular phone service. Eagan replied it was for GPS tracking on the vehicles.

**ROLL CALL:** Amundson, Avery, Wiltgen, Brinkman and Schorr voted yes. Motion carried 5-0.

## **8) GENERAL ADMINISTRATIVE ITEMS**

- A.** 2018 Food Bank Drive Final Report

There was \$1,000 more donated this year than last and almost 600 pounds more food.

## **9) DISCUSSION OF BOARD MEMBER MEETINGS ATTENDED**

### **A. Lincoln Chamber of Commerce Coffee – Wiltgen/Schorr**

Wiltgen reported the committee had updates on the budget, priorities, and the Special Permit No. 18025 hearing for the construction of a commercial feedlot located at 13350 West Wittstruck Road.

### **B. JDAI Collaborative – Amundson**

Amundson said Hoyle discussed the funding process and new form, comprehensive juvenile services plan, JDAI committees, JDAI survey results, transferring the juvenile justice system to improved public safety and youth outcomes.

### **C. Region V Meetings – Wiltgen**

Wiltgen reported he missed the Executive meeting. At the regular meeting the following were highlighted: new funding methodology delay for developmental disabilities, the State population calculations are differing from what the Regions are reporting; financial statements were approved; Region V Services made \$1,700,000 due to planning; report from Behavioral Health; \$1,300,000 million in excess funds were not reallocated as they were obligated funds; rate study. Wiltgen said there is a problem with contracts as the State wants details that seem to violate Health Insurance Portability and Accountability Act (HIPAA).

### **D. Public Building Chair Meeting W/Mayor – CANCELLED**

### **E. Railroad Transportation Safety District – Schorr/Wiltgen/Amundson**

Schorr said the committee approved the 2018 audit, gave an update on the 33<sup>rd</sup> and Cornhusker project, had a presentation from Aemal Khattak, Ph.D. on his project analyzing railroad crossings in Lancaster County, proclaimed September 23-29, 2018 National Rail Safety Week and had a presentation from Operation Lifesaver. She stated due to error with the original public notice, there will be a special meeting at 8:45 a.m. on Tuesday, September 18 to approve the budget.

### **F. Lancaster County Board Chair and Vice-Chair Meeting W/Mayor – CANCELLED**

### **G. General Assistance Monitoring Committee – Wiltgen**

Wiltgen said he did not attend the meeting.

### **H. Lincoln-Lancaster County Board of Health – Avery**

Avery stated the committee discussed fugitive smoke from Kansas and the budget for the next year.

### **I. Mental Health Crisis Center Advisory Board – Avery**

Avery stated the meeting was postponed for two weeks.

**J. Lancaster County Fairgrounds Joint Public Agency – Wiltgen/Amundson**

Wiltgen said the budget and a 1% spending authority increase were approved; an attorney bill was paid; and the board from the National High School Rodeo Association will be at the Lancaster Event Center.

**K. Nebraska State JDAI Collaborative - Amundson**

Amundson reported the focuses were what Lancaster County has done with the study, youth absconding from placement, and western Nebraska's lack of resources to deal with juveniles.

**10) SCHEDULE OF BOARD MEMBER MEETINGS-**

For informational purposes only.

**11) EMERGENCY ITEMS**

There were no emergency items.

**12) ADJOURNMENT**

**MOTION:** Schorr moved and Brinkman seconded to adjourn the meeting at 12:24 p.m. Amundson, Avery, Wiltgen, Brinkman and Schorr voted yes. Motion carried 5-0.

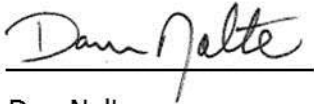

Dan Nolte  
Lancaster County Clerk



# ONE AND SIX-YEAR ROAD AND BRIDGE CONSTRUCTION PROGRAM

## FISCAL YEAR 2019



## LANCASTER COUNTY, NEBRASKA

LANCASTER COUNTY ENGINEERING DEPARTMENT

444 CHERRY CREEK ROAD, BLDG. C • LINCOLN, NE 68528

(402) 441-7681

<http://lancaster.ne.gov/engineer>

PAMELA L. DINGMAN  
COUNTY ENGINEER

# LANCASTER COUNTY, NEBRASKA

## Completed Roadway Improvements - through 2018

KENNETH D. SCHROEDER  
COUNTY SURVEYOR

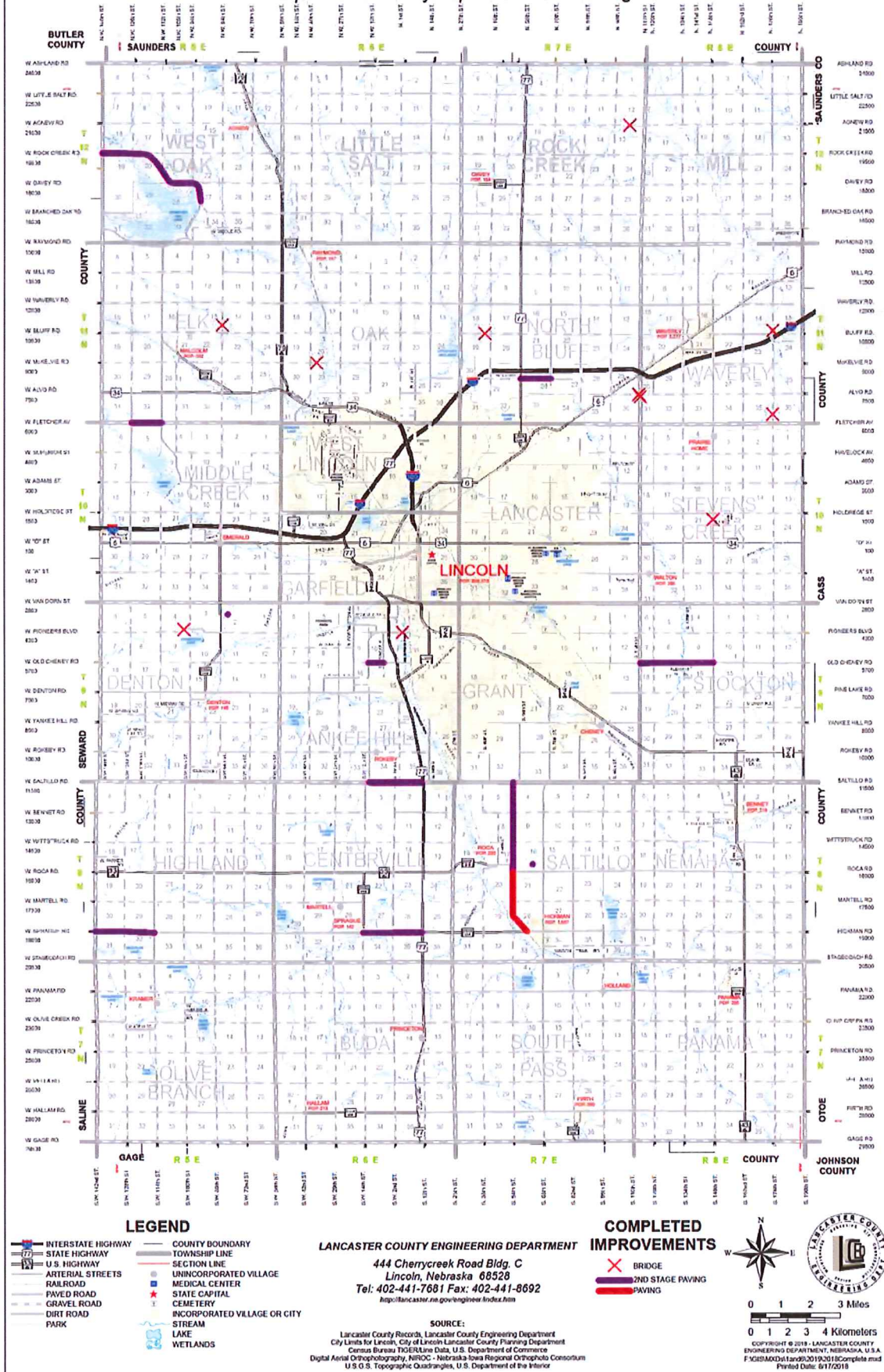

## 2018 ROAD PROJECTS COMPLETED OR UNDER CONSTRUCTION

Location	Township & Section	Length (Miles)	Improvement	Cost
S 54th Street (Saltillo Road to Roca Road)	Saltillo W-4,9,16	3.0	2nd Stage Pavement	\$660,763
S 54th Street (Roca Road to City of Hickman)	Saltillo W-21,28 IN-28	2.2	Pavement	\$1,110,871
Arbor Road (N 56 <sup>th</sup> Street to N 70 <sup>th</sup> Street)	North Bluff IN-28	1.0	2nd Stage Pavement	\$172,966
Branched Oak Lake Road	West Oak S-18,17 IN-20,21 S-21 IN-27	4.2	2nd Stage Pavement	\$199,986
W. Fletcher Avenue (NW 126 <sup>th</sup> Street to NW 112 <sup>th</sup> Street)	Elk S-32	1.0	2nd Stage Pavement	\$274,307
Meadow View Subdivision	Denton IN-2	0.5	2nd Stage Pavement	\$214,945
Old Cheney Road (S 112 <sup>th</sup> Street to S 148 <sup>th</sup> Street)	Stockton S-7,8,9	2.5	2nd Stage Pavement	\$527,293
W Old Cheney Road (SW 12 <sup>th</sup> Street to Highway 77)	Yankee Hill S-10	1.0	2nd Stage Pavement	\$223,450
The Preserve at Cross Creek Subdivision (1st, 2nd and 4th Addition)	Saltillo IN-16	1.4	2nd Stage Pavement	\$297,375
W Saltillo Road (SW 12 <sup>th</sup> Street to Hwy 77)	Yankee Hill S-34,35	2.0	2nd Stage Pavement	\$407,031
W Sprague Road (SW 14 <sup>th</sup> Street to Highway 77)	Centerville S-26,27	2.0	2nd Stage Pavement	\$421,597
W Sprague Road (SW 114 <sup>th</sup> Street to SW 142 <sup>nd</sup> Street)	Highland S-29,30	2.0	2nd Stage Pavement	\$434,186
				\$4,944,770

## 2018 BRIDGE PROJECTS COMPLETED OR UNDER CONSTRUCTION

Location	Township & Section	Improvement	Cost
NW 84 <sup>th</sup> Street (E-117)	Elk W-14	Concrete Box Culvert	\$265,583
N 112 <sup>th</sup> Street (H-66)	Waverly W-31	Scour Repair	\$42,400
N 148 <sup>th</sup> Street (J-143)	Stevens Creek W-22	Concrete Box Culvert	\$327,872
N 176 <sup>th</sup> Street (H-211)	Waverly W-36	Concrete Box Culvert	\$178,320
N 176 <sup>th</sup> Street (H-119)	Waverly W-13	Scour Repair	\$334,496
Agnew Road (B-147)	Rock Creek S-12	Concrete Box Culvert	\$233,557
Alvo Road (G-111)	North Bluff S-25	Concrete Box Culvert	\$196,648
Bluff Road (G-144)	North Bluff S-18	Concrete Box Culvert	\$180,377
W McKelvie Road (F-225)	Oak S-20	Concrete Box Culvert	\$148,300
W Pioneers Boulevard (N-19)	Denton S-4	Concrete Box Culvert	\$262,352
W Pioneers Boulevard (O-175)	Yankee Hill S-2	Scour Repair	\$217,776
J-143, F-225, G-111 and G-144 were not finished on schedule. Funds were re-encumbered in current year to complete. O-175 is part of an interlocal agreement with Lower Platte South NRD.			\$2,387,681



PAMELA L. DINGMAN  
COUNTY ENGINEER

# LANCASTER COUNTY, NEBRASKA

## Proposed Roadway Improvement Program - Fiscal Year 2019

KENNETH D. SCHROEDER  
COUNTY SURVEYOR

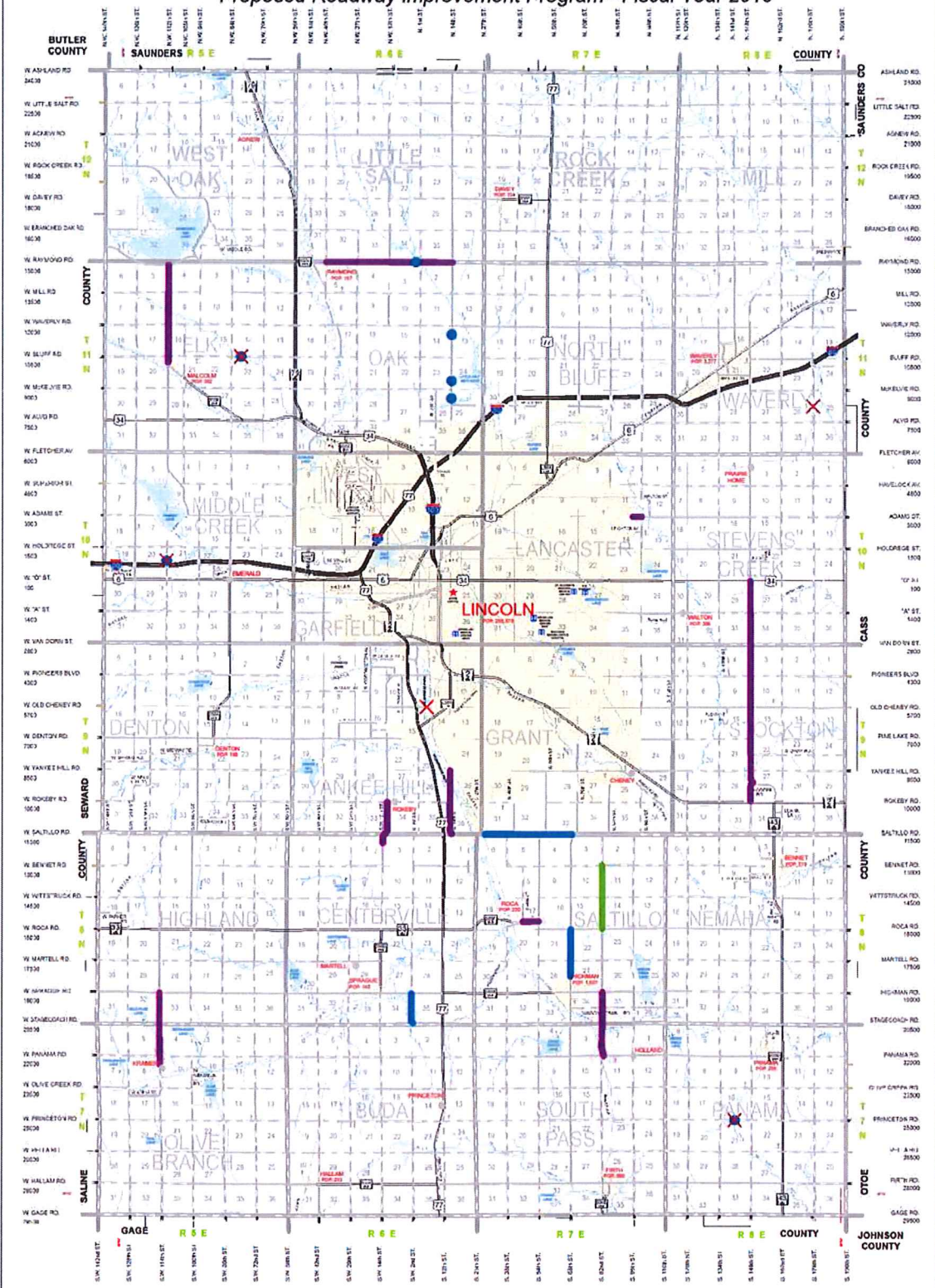

**LEGEND**

- INTERSTATE HIGHWAY
- STATE HIGHWAY
- U.S. HIGHWAY
- ARTERIAL STREETS
- RAILROAD
- PAVED ROAD
- GRAVEL ROAD
- DIRT ROAD
- COUNTY BOUNDARY
- TOWNSHIP LINE
- SECTION LINE
- UNINCORPORATED VILLAGE
- MEDICAL CENTER
- STATE CAPITAL
- CEMETERY
- INCORPORATED VILLAGE OR CITY
- STREAM
- LAKE
- WETLANDS

**LANCASTER COUNTY ENGINEERING DEPARTMENT**  
 444 Cherrycreek Road Bldg. C  
 Lincoln, Nebraska 68528  
 Tel: 402-441-7681 Fax: 402-441-8692  
<http://lancaster.ne.gov/engineering/index.htm>

SOURCE:  
 Lancaster County Records, Lancaster County Engineering Department  
 City Limits for Lincoln, City of Lincoln-Lancaster County Planning Department  
 Census Bureau TIGER/Line Data, U.S. Department of Commerce  
 Digital Aerial Orthophotography, NROCC - Nebraska-Iowa Regional Orthophoto Consortium  
 U.S.G.S. Topographic Quadrangles, U.S. Department of the Interior

**PROPOSED IMPROVEMENTS**

- ENGINEERING
- BRIDGE
- ENGINEERING
- GRADING
- 2ND STAGE PAVING

0 1 2 3 Miles

0 1 2 3 4 Kilometers

Copyright © 2019, LANCASTER COUNTY ENGINEERING DEPARTMENT, NEBRASKA, U.S.A.  
 FIGS\MADs\land\2019\2019.mxd  
 Printed Date: 8/20/2018



## 2019 ROAD PROJECTS

Location	Township & Section	Existing Surface	ADT Count	Length (Miles)	Improvement	Estimated Cost
SW 2 <sup>nd</sup> Street (W Stagecoach Road)	Centerville W-35	Gravel	-	-	Engineering	\$0
SW 12 <sup>th</sup> Street (W Rokeby Road to 12000 SW 12 <sup>th</sup> Street)	Yankee Hill W-34	Pavement	569	1.25	2 <sup>nd</sup> Stage Pavement	\$287,500
S 14 <sup>th</sup> Street (Saltillo Road to Yankee Hill Road)	Yankee Hill W-25,36	Pavement	2,062-2,394	2.0	2 <sup>nd</sup> Stage Pavement	\$460,000
S 68 <sup>th</sup> Street (Roca Road to City of Hickman)	Saltillo W-22,27	Pavement	4,982-5,251	1.3	Engineering	\$80,000
S 82 <sup>nd</sup> Street (Roca Road to Bennet Road)	Saltillo W-11, 14	Gravel	100-139	2.0	Grading	\$550,000
S 82 <sup>nd</sup> Street (Panama Road to Hickman Road)	Saltillo W-35 South Pass W-2	Pavement	607-614	2.0	2 <sup>nd</sup> Stage Pavement	\$460,000
NW 112 <sup>th</sup> Street (W Raymond Road to Village of Malcolm)	Elk W-4,9,16,21	Pavement	607-1928	4.0	2 <sup>nd</sup> Stage Pavement	\$920,000
SW 114 <sup>th</sup> Street (W Sprague Road to Village of Kramer)	Highland W-33 Olive Branch W-4,9	Pavement	252-536	2.6	2 <sup>nd</sup> Stage Pavement	\$598,000
S 148 <sup>th</sup> Street (O Street to Rokeby Road)	Stevens Creek W-27,34 Stockton W-3,10,15,22,27	Pavement	3,842-5,006	7.0	2 <sup>nd</sup> Stage Pavement	\$1,610,000
Adams Street (Stevens Creek to City of Lincoln)	Lancaster S-11	Pavement	505	0.5	2 <sup>nd</sup> Stage Pavement	\$115,000
Raymond Road (N 14 <sup>th</sup> Street to Village of Raymond)	Little Salt S-32,33,34,35	Pavement	2,448-2,841	4.5	2 <sup>nd</sup> Stage Pavement	\$1,000,000
Roca Road (S 46 <sup>th</sup> Street to S 56 <sup>th</sup> Street)	Saltillo S-17	Pavement	1,460	0.5	2 <sup>nd</sup> Stage Pavement	\$130,000
Saltillo Road (S 27 <sup>th</sup> Street to S 68 <sup>th</sup> Street)	Grant S-31,32,33	Pavement	5,558-6,610	3.0	Engineering	\$750,000
Lower Platte South NRD is working with NRCS on intersection of SW 2 <sup>nd</sup> Street and W Stagecoach Road.						\$6,960,500

## 2019 STANDBY ROAD PROJECTS

Location	Township & Section	Existing Surface	ADT Count	Length (Miles)	Improvement	Estimated Cost
SW 14th Street (Highway 33 to Bennet Road)	Centerville W-10,15	Gravel	341-344	2.0	Pavement	\$1,005,000
S 98th Street (Old Cheney Road to Van Dorn Street)	Grant W-1,12	Gravel	242-713	2.0	Pavement	\$1,005,000
N 162nd Street (Highway 6 to Davey Road)	Mill W-26,35 Waverly W-2,11	Gravel	201-419	4.0	Pavement	\$2,100,000
East Beltway	Stockton IN-29,20,17,8,5 Stevens Creek IN-32,29,20,17,8,5 Waverly IN-32,29	-	-	13.0	Engineering ROW	\$1,650,000
						\$5,760,000

## 2019 BRIDGE PROJECTS

Location	Township & Section	ADT Count	Improvement	Estimated Cost
N 14 <sup>th</sup> Street (F-79)	Oak W-25	3,769-3,899	Engineering	\$30,000
N 14 <sup>th</sup> Street (F-82)	Oak W-24	3,769-3,899	Engineering	\$30,000
N 14 <sup>th</sup> Street (F-86)	Oak W-13	3,769-3,899	Engineering	\$30,000
NW 112 <sup>th</sup> Street (M-164)	Middle Creek W-21	56	Engineering	\$30,000
			Concrete Box Culvert	\$200,000
N 176 <sup>th</sup> Street (H-115)	Waverly W-25	41	Concrete Box Culvert	\$150,000
W Bluff Road (E-171)	Elk S-14	78	Engineering	\$30,000
			Concrete Box Culvert	\$200,000
W Old Cheney Road (O-37)	Yankee Hill S-11	9,938	Scour Repair	\$240,000
W Princeton Road (Y-181)	Panama S-16	22	Engineering	\$30,000
			Concrete Box Culvert	\$125,000
W Raymond Road (C-91)	Little Salt S-34	2729	140' Concrete Slab Bridge	\$1,500,000
NEMA Hazard Mitigation Grant will reimburse 75% of H-115 cost.				\$2,595,000

## 2019 STANDBY BRIDGE PROJECTS

Location	Township & Section	ADT Count	Improvement	Estimated Cost
W Panama Road (W-122)	Buda S-6	95	Engineering	\$30,000
			Concrete Box Culvert	\$175,000
W Pella Road (W-174)	Buda S-22	21	Engineering	\$30,000
			Concrete Box Culvert	\$175,000
W Princeton Road (W-164)	Buda S-18	48	Engineering	\$30,000
				\$440,000

PAMELA L. DINGMAN  
COUNTY ENGINEER

# LANCASTER COUNTY, NEBRASKA

KENNETH D. SCHROEDER  
COUNTY SURVEYOR

## Proposed Roadway Improvement Program - Fiscal Year 2020 - 2024

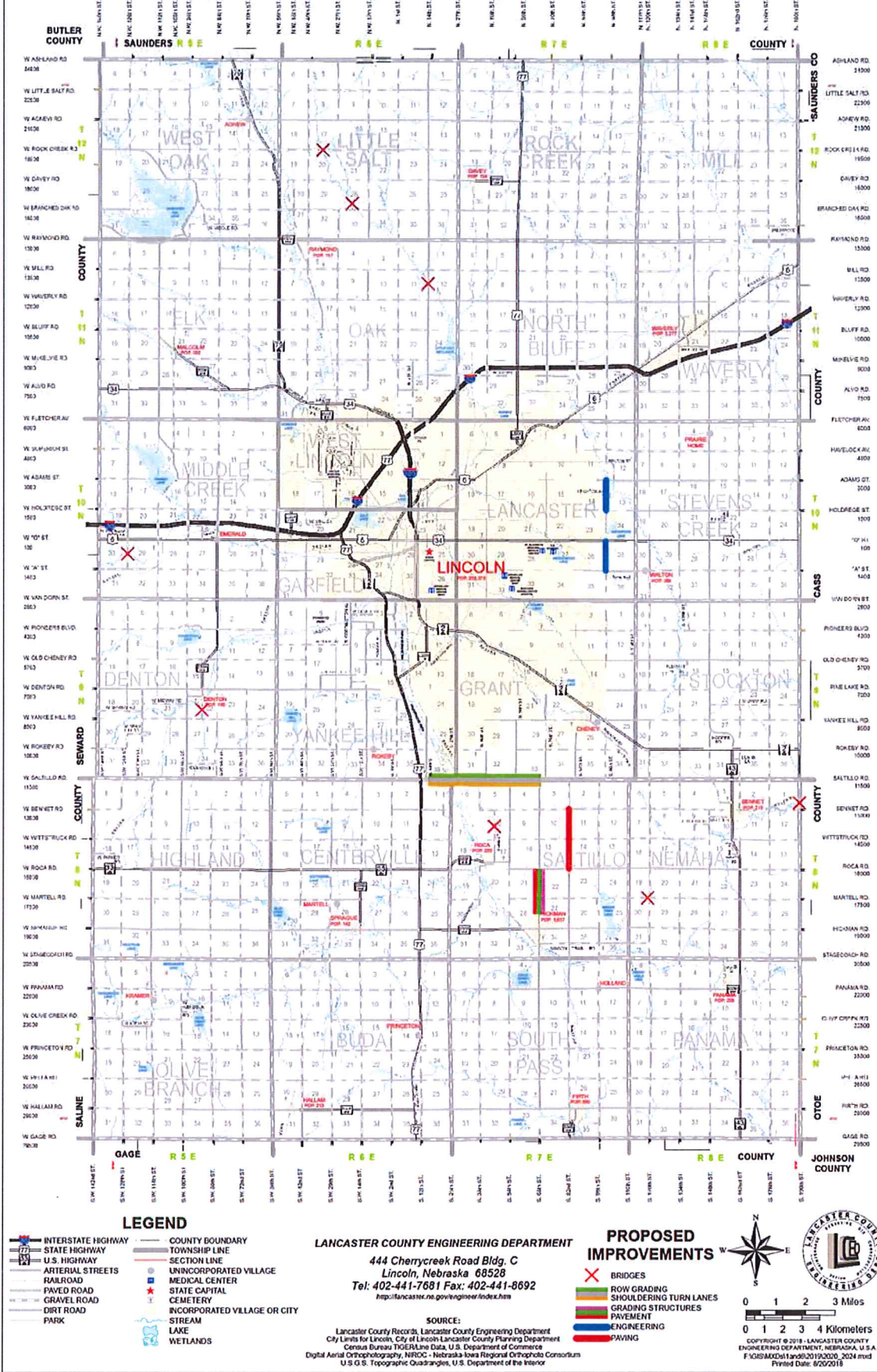

### 2020-2024 ROAD PROJECTS

Location	Township & Section	Existing Surface	ADT Count	Length (Miles)	Improvement	Estimated Cost
S 68th Street (Roca Road to City of Hickman)	Saltillo W-22,27	Pavement	4,982-5,251	1.3	Grading Structures Pavement	\$1,500,000
S 82nd Street (Roca Road to Bennet Road)	Saltillo W-11,14	Gravel	100-139	2.0	Pavement	\$1,200,000
N 98 <sup>th</sup> Street (Adams Street to Holdrege Street)	Lancaster W-13	Gravel	376-449	1.0	Engineering	\$75,000
S 98 <sup>th</sup> Street (A Street to O Street)	Lancaster W-25	-	-	1.0	Engineering	\$75,000
Saltillo Road (S 14th Street to S 68th Street)	Yankee Hill S-36 Grant S-31,32,33	Pavement	6,299-7,937	3.8	ROW Grading Shoulders Turn Lanes	\$1,000,000
Various Locations	Varies	Pavement	Varies	Varies	2 <sup>nd</sup> Stage Pavement	\$12,000,000
						\$15,850,000

### 2020-2024 BRIDGE PROJECTS

Location	Township	ADT Count	Improvement	Estimated Cost
N 14th St (F-88)	Oak W-12	3,703	125' 3-Span Concrete Slab Bridge	\$1,250,000
NW 19th St (C-262)	Little Salt IN-28	4	100' 3-Span Concrete Slab Bridge	\$1,000,000
S 46 <sup>th</sup> St (S-59)	Saltillo IN-8	225	Concrete Box Culvert	\$175,000
SW 91st St (N-114)	Denton IN-22	15	Concrete Box Culvert	\$125,000
NW 126th St (M-178)	Middle Creek W-29	38	125' 3-Span Concrete Slab Bridge	\$1,250,000
S 190 <sup>th</sup> St (R-15)	Nemaha E-1	51	125' 3-Span Concrete Slab Bridge	\$1,250,000
Martell Rd (R-210)	Nemaha S-19	36	Concrete Box Culvert	\$175,000
W Rock Creek Rd (C-220)	Little Salt S-17	28	100' 3-Span Concrete Slab Bridge	\$1,000,000
				\$6,225,000



# LANCASTER COUNTY SCOUR CRITICAL BRIDGES

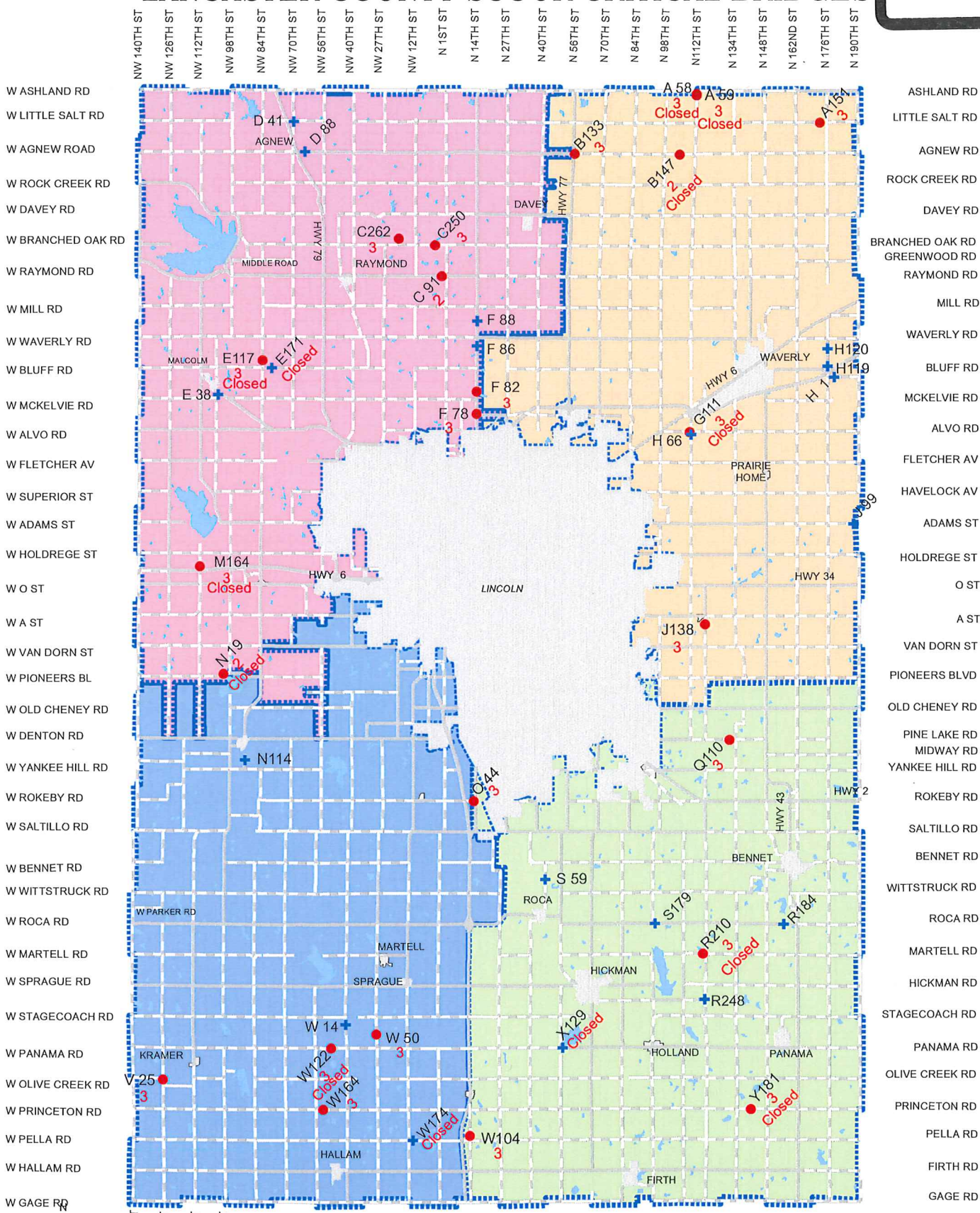

**Scour Type**  
 ● Critical - 24 (U, 6, 3 or less)  
 + Susceptible - 19 (as per county Inspectors)

**43 SITES**  
 7/17/2018

# LANCASTER COUNTY PAVED ROAD BRIDGE & BOX NEEDS

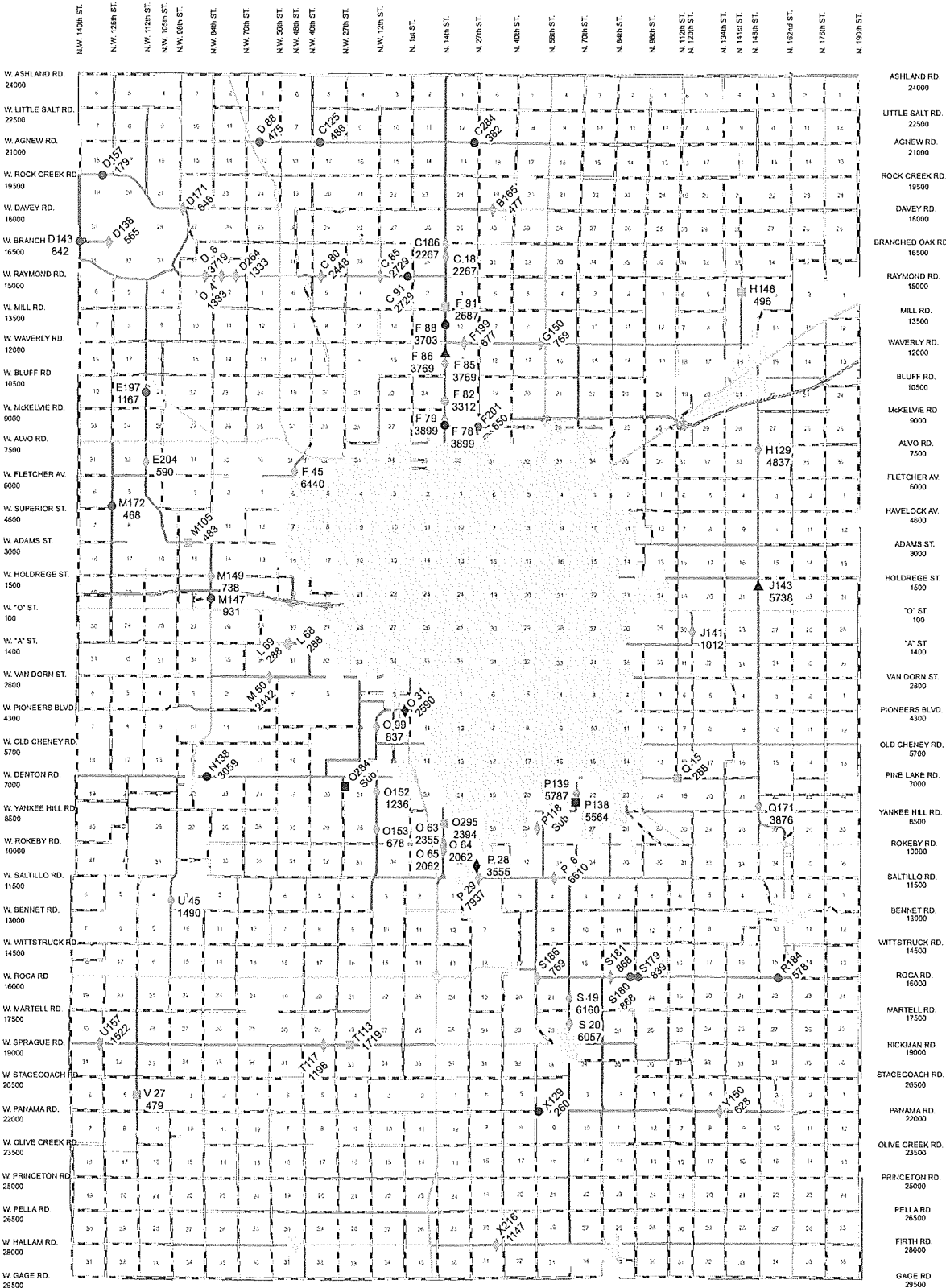

**Bridge Length Bridges**

- Critical
- ◊ Urgent
- Undesireable

**Under 20' Bridges**

- ▲ Critical

**Bridge Length CBCs**

- Critical
- ◻ Urgent

**Under 20' CBCs**

- ◆ Critical
- ◇ Urgent





# LANCASTER COUNTY ADT & MOVEMENT

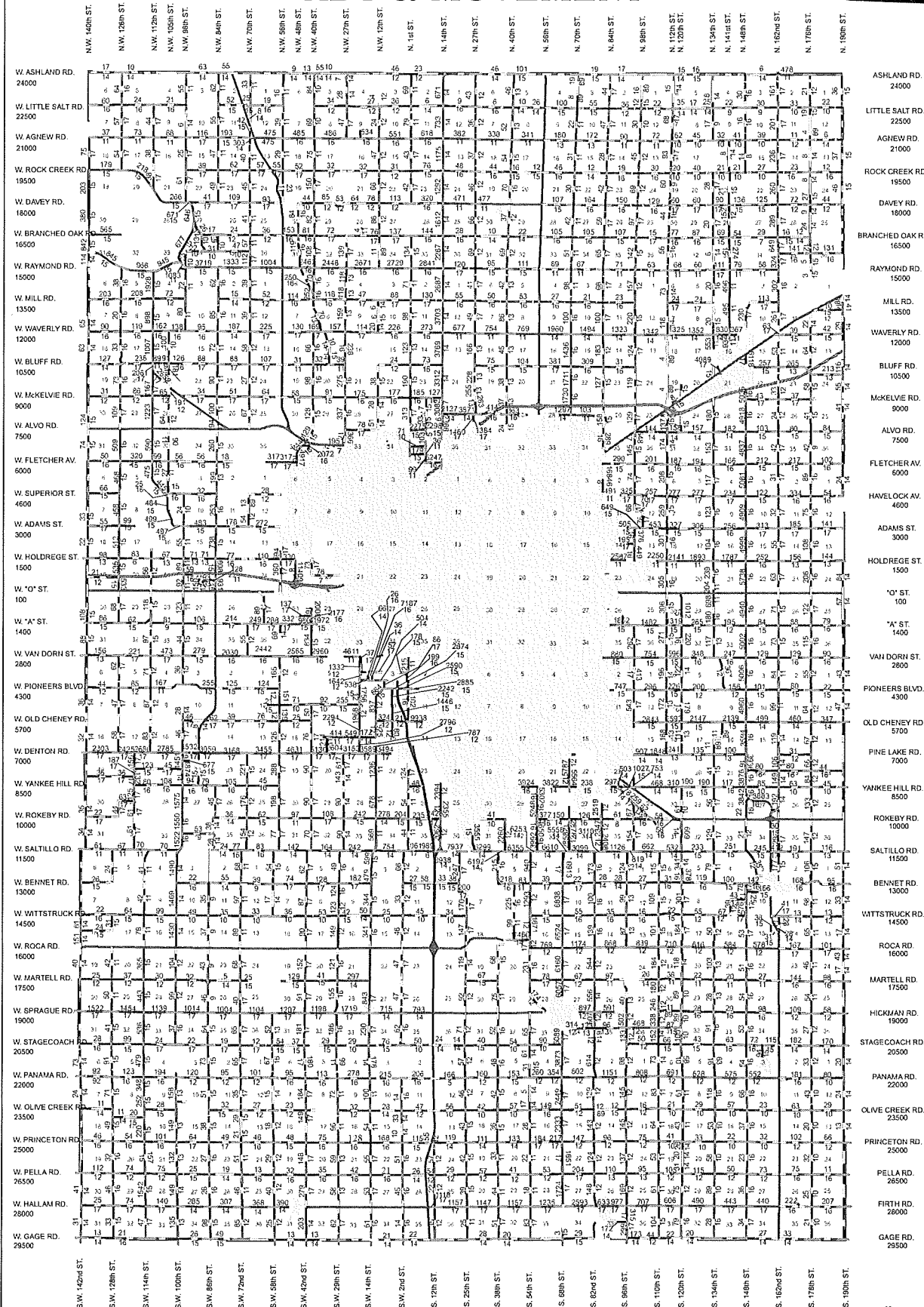

REV 10/20/17  
Prepared By: A Brunke  
P:\ArcGISMap Proj\Traffic Count\ADT Movement 11x17.mxd

**TRAFFIC COUNTS**  
 BLUE TEXT = COUNT  
 RED TEXT = YEAR

**MOVEMENT**  
 THROUGH  
 STOP  
 YIELD

**ROAD TYPE**  
 PAVED  
 GRAVEL  
 DIRT





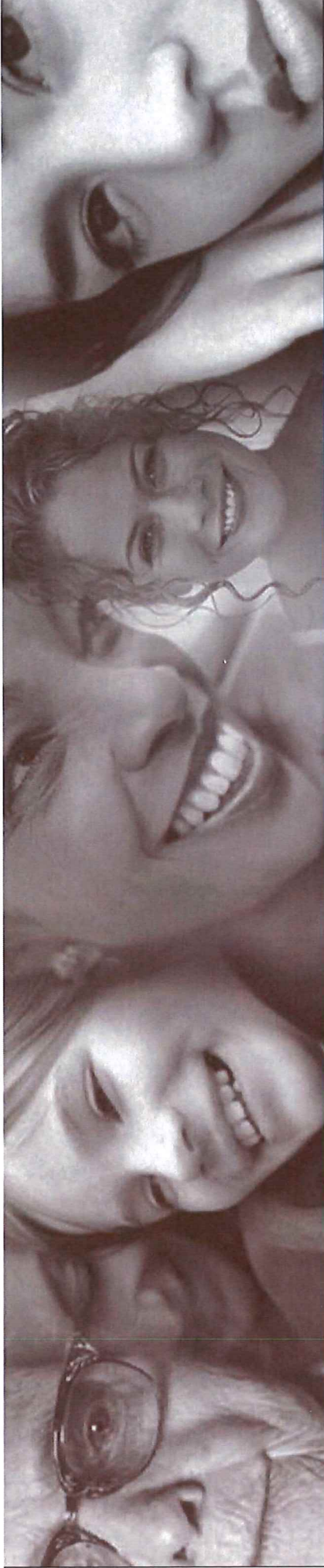

# Lincoln/Lancaster Human Services

2018 Department Report

Sara Hoyle, Director



# Mission

Lincoln/Lancaster County Human Services serves as a guide to Lancaster County and the City of Lincoln to respond to human needs in order to achieve the highest level of self-sufficiency, safety, and quality of life possible through a collaborative approach that is expedient and cost effective to Lancaster County citizens.

"It was once said that the moral test of government is how that government treats those who are in the dawn of life, the children; those who are in the twilight of life, the elderly; and those who are in the shadows of life, the sick, the needy and the handicapped".

-Hubert H. Humphrey



# Office Overview

- Funded Jointly through City and County
- 12 Staff
  - 5 General Assistance Employees
  - 5 Juvenile Justice Employees
  - 1 Administrative Assistant
  - 1 Director
- 3.5 Million in Grants and Contracts
- 250 Contracts
- Over 1,500 Clients Served Annually

## TEAMWORK

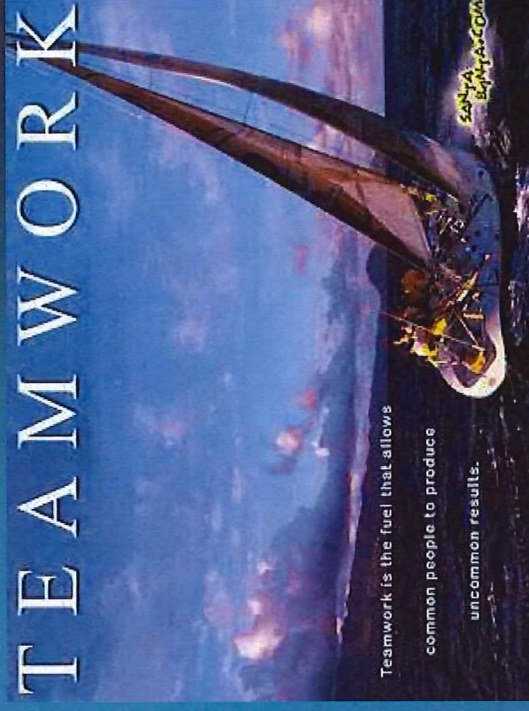

# Direct Services

Early Assessments

Supervision of Pre-Adjudicated Youth

Coordination of Operation Tipping Point with LPD

Administer School Based Diversion Programs

Coordination of Truancy Diversion Program

Facilitation and Data Collection for Disproportionate Minority Contact Committee

Facilitation of Systems Meetings & Coordination

Determine Eligibility of Applicants for General Assistance

Screen for Cremation Assistance

Work with Medicaid for Reimbursement of Services

Case Manage Clients on General Assistance

Provide Assistance to Non-Profit Agencies

Participate in a Variety of Community Initiatives

Educate and Provide Input on Local and State Initiatives

Grant Administration



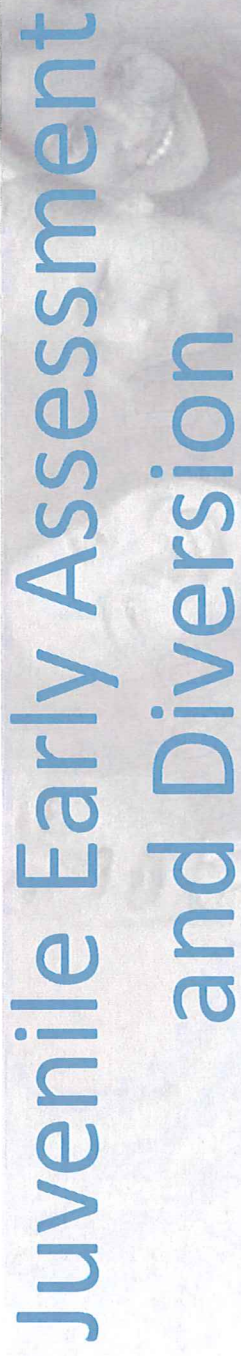

Juvenile Early Assessment  
and Diversion

Early Assessment

Truancy Diversion

School Based Diversion

Diversion & Intensive Diversion

# Truancy Diversion

- Over 350 participants since 2010  
(approx. 50 per year)
- 3 Middle Schools (minimal enrollment)
- 4 High Schools (majority enrolled)
- 39 active students enrolled
- UNL evaluation
- Decrease in Court Involved Truancy Cases
- LINC'S





# Early Assessment

658 out of 714 families referred completed Assessments (92%)

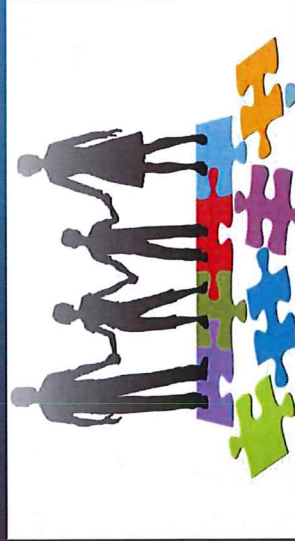

## Outcomes

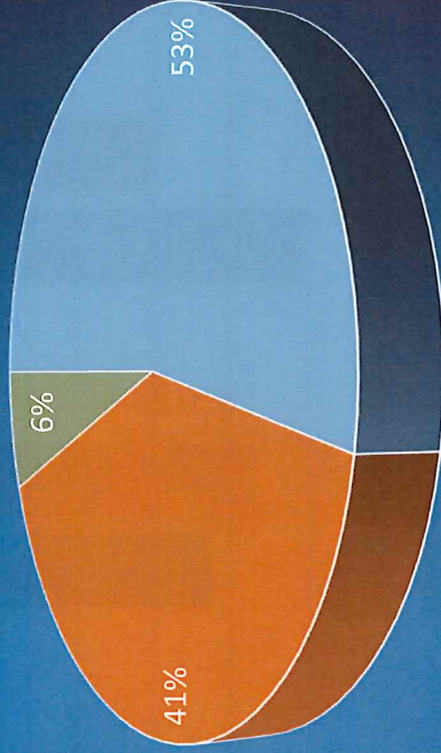

□ No Charged   □ Juvneile Diversion   □ Filed

# RESTORE

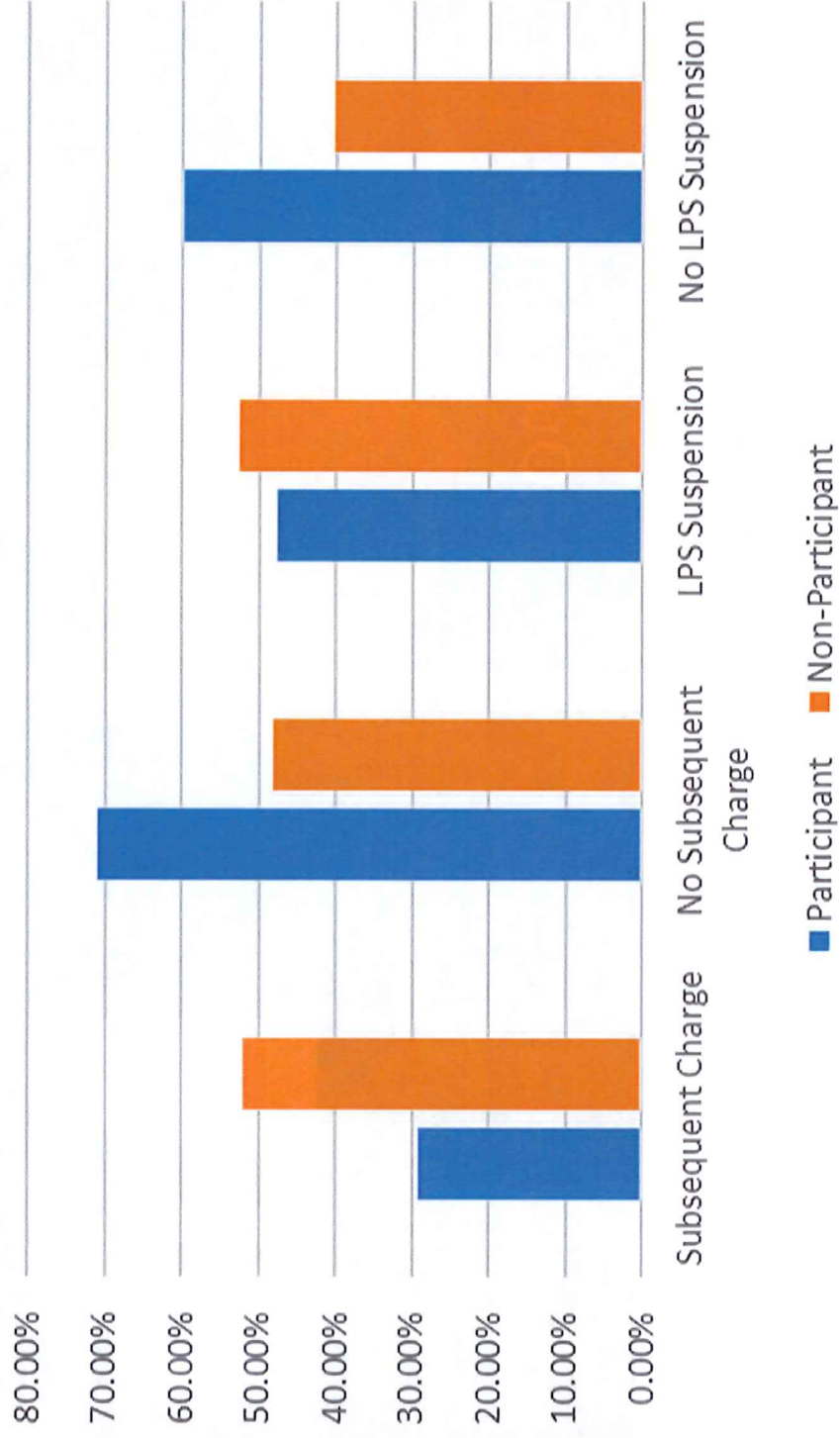



# RESTORE

## Minority Youth Referred to Programming

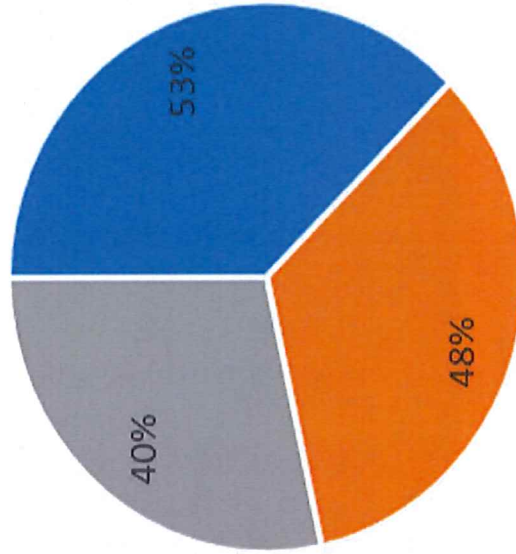

■ RESTORE ■ SAMI ■ Diversion

# Diversion

- Fee Reduced by over 50%
- Community Partnerships
- On-line Courses
- Higher Risk Youth on Diversion
- 2016 – 542 youth enrolled
- 2017 – 337

Days from Referral to Case Plan Signed

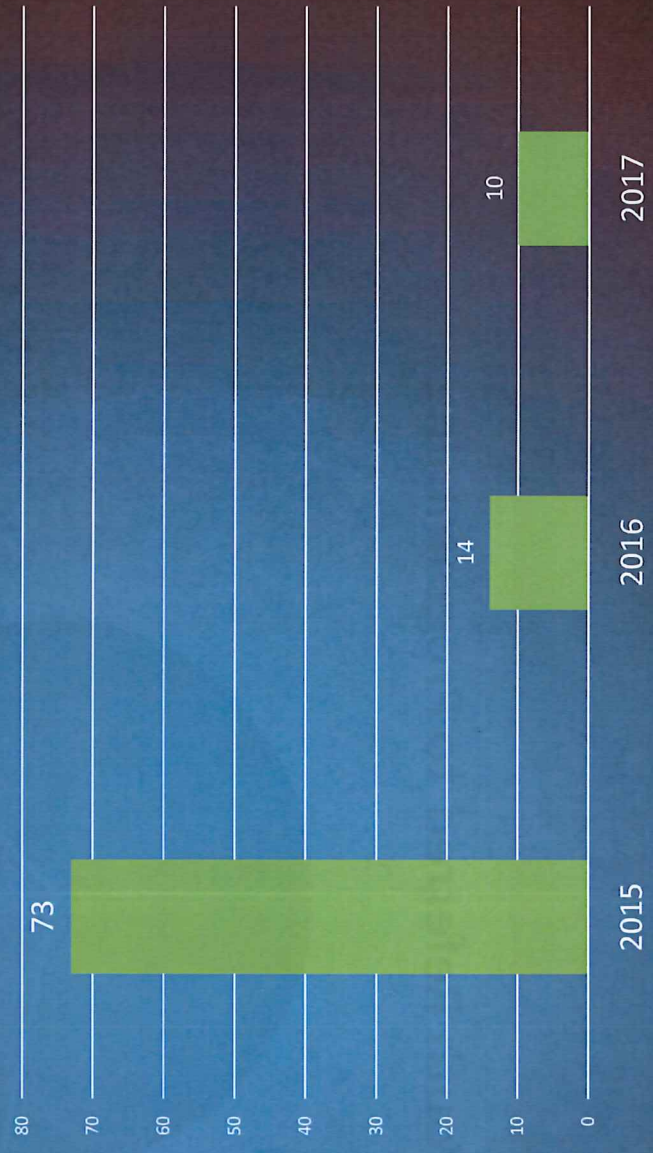



# Juvenile Diversion Enrollment

## Overall Enrollment

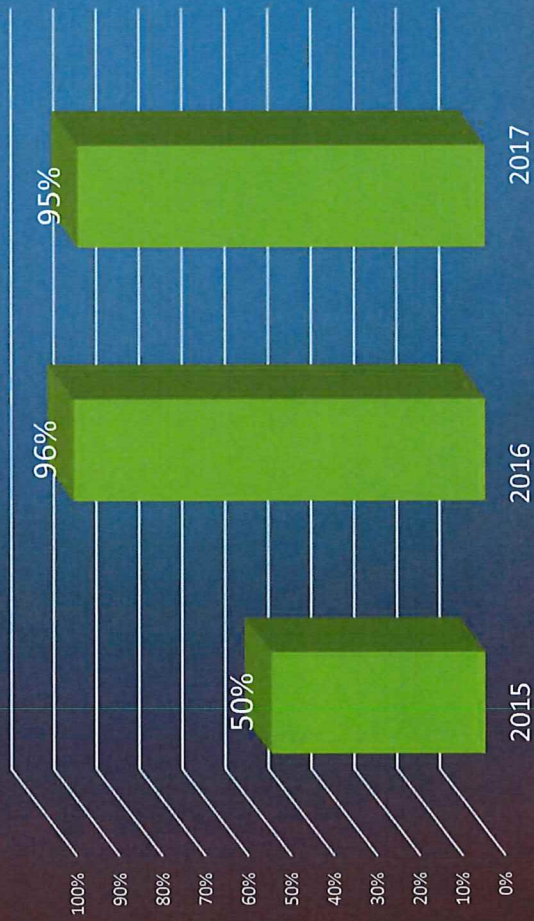

## Minority Enrollment

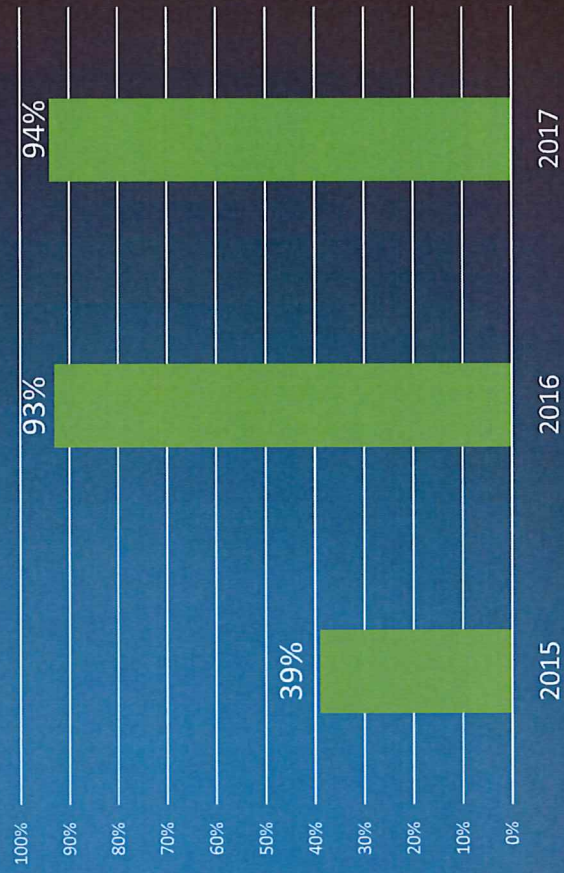

# Days in Juvenile Diversion

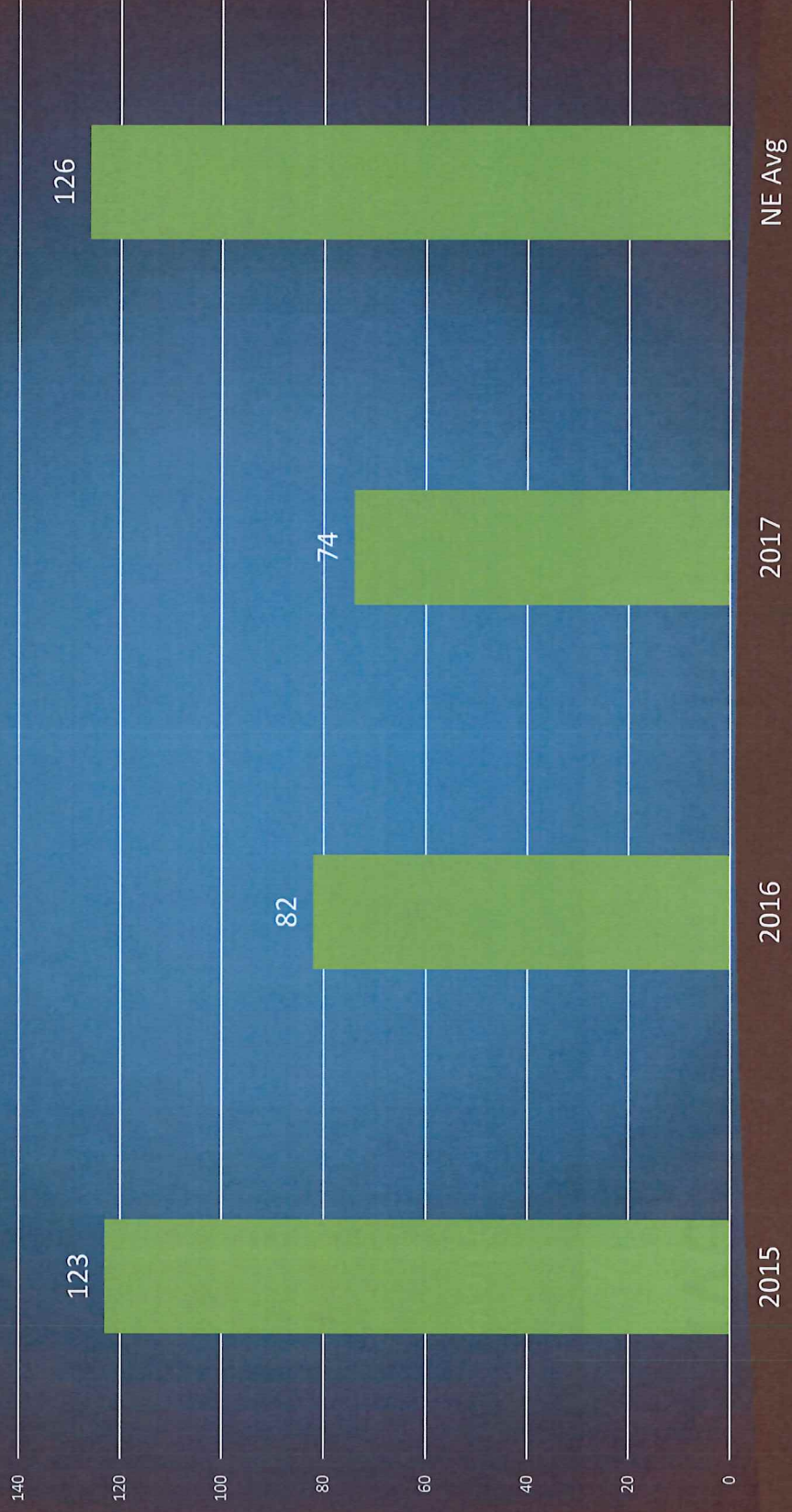



# Successful Discharges from Juvenile Diversion

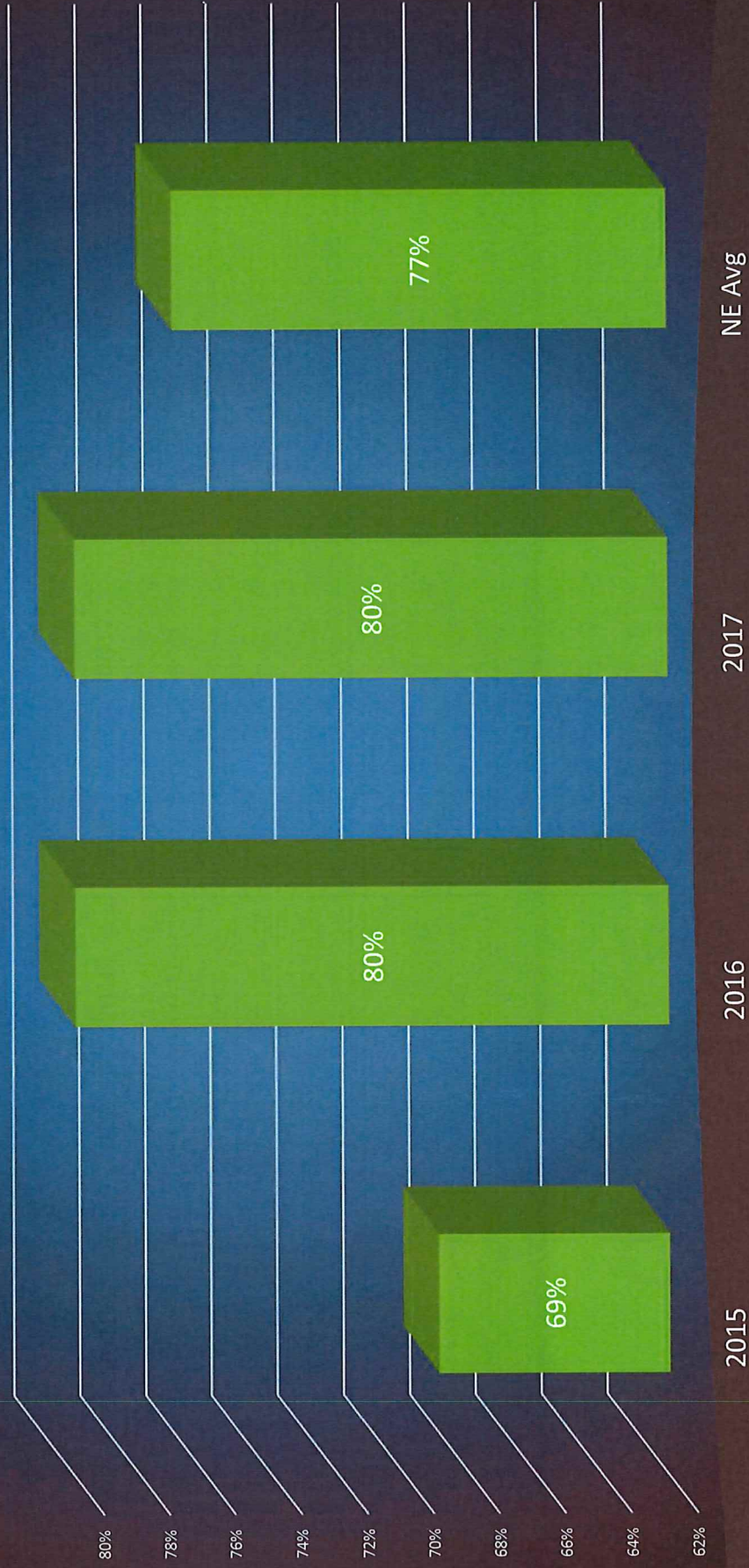

# Unsuccessful Discharges





# Juvenile Justice System Overview

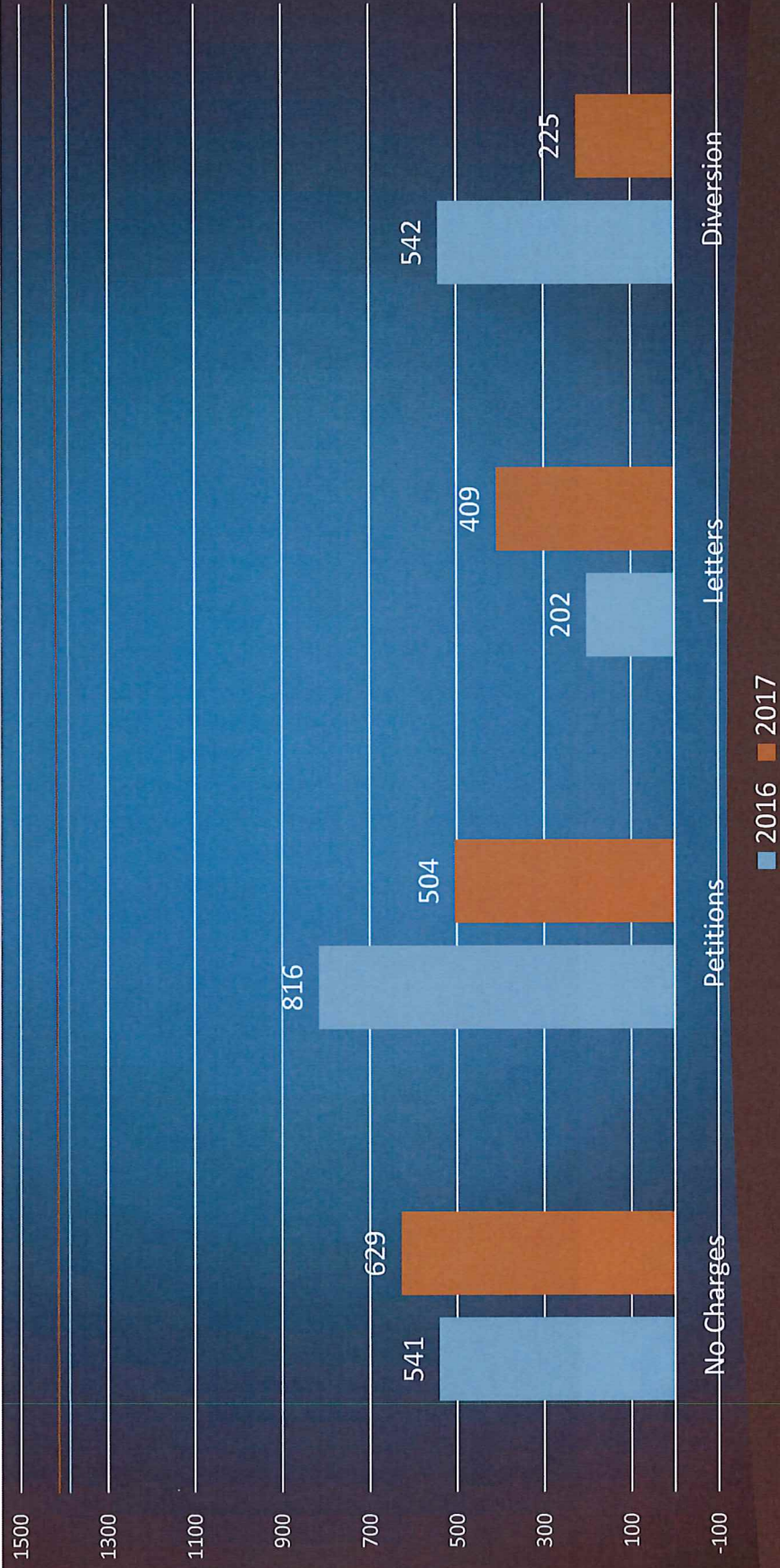

# Diversion Recidivism Rate

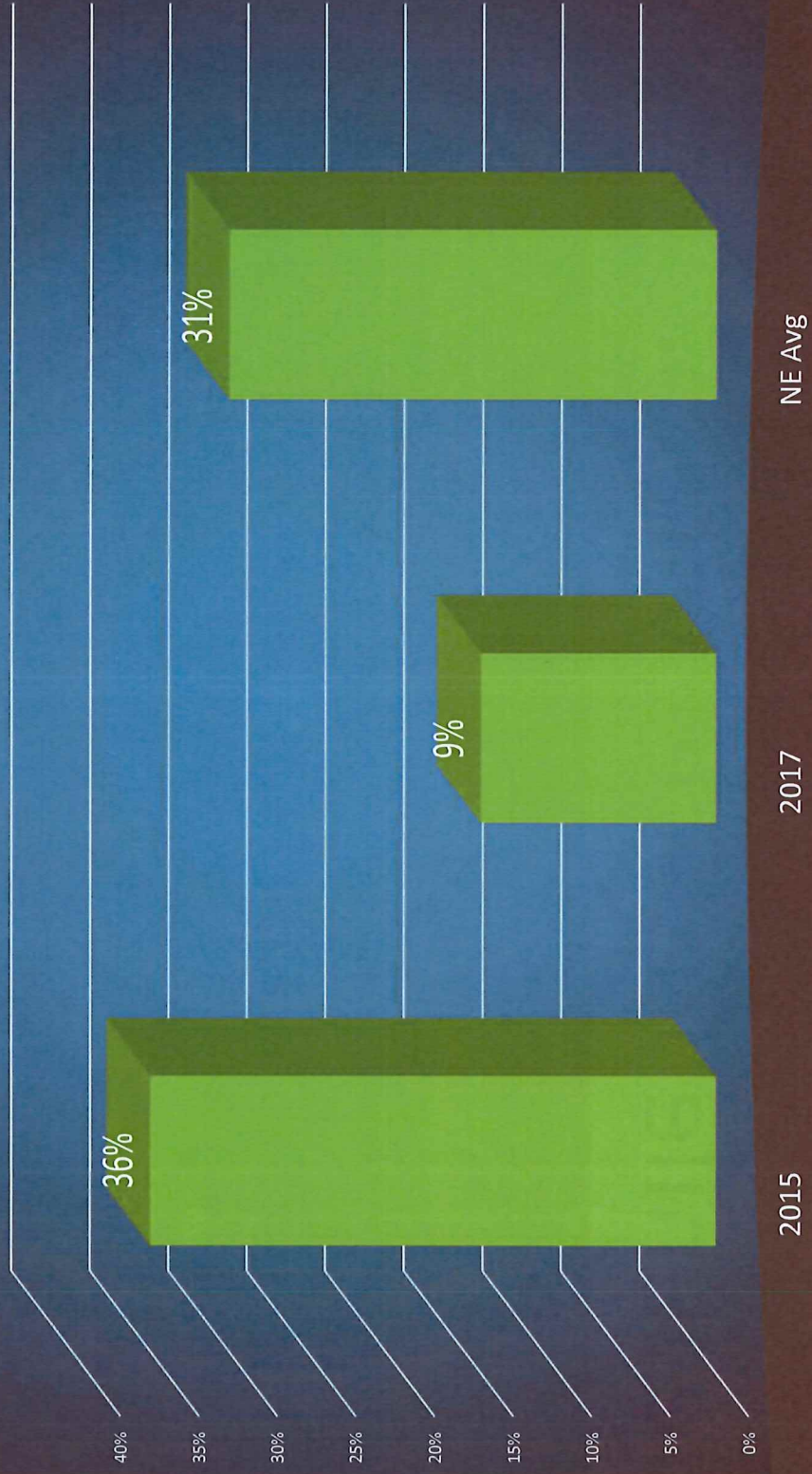



# How reasonable or unreasonable were the Diversion Case Worker's expectations of your child?

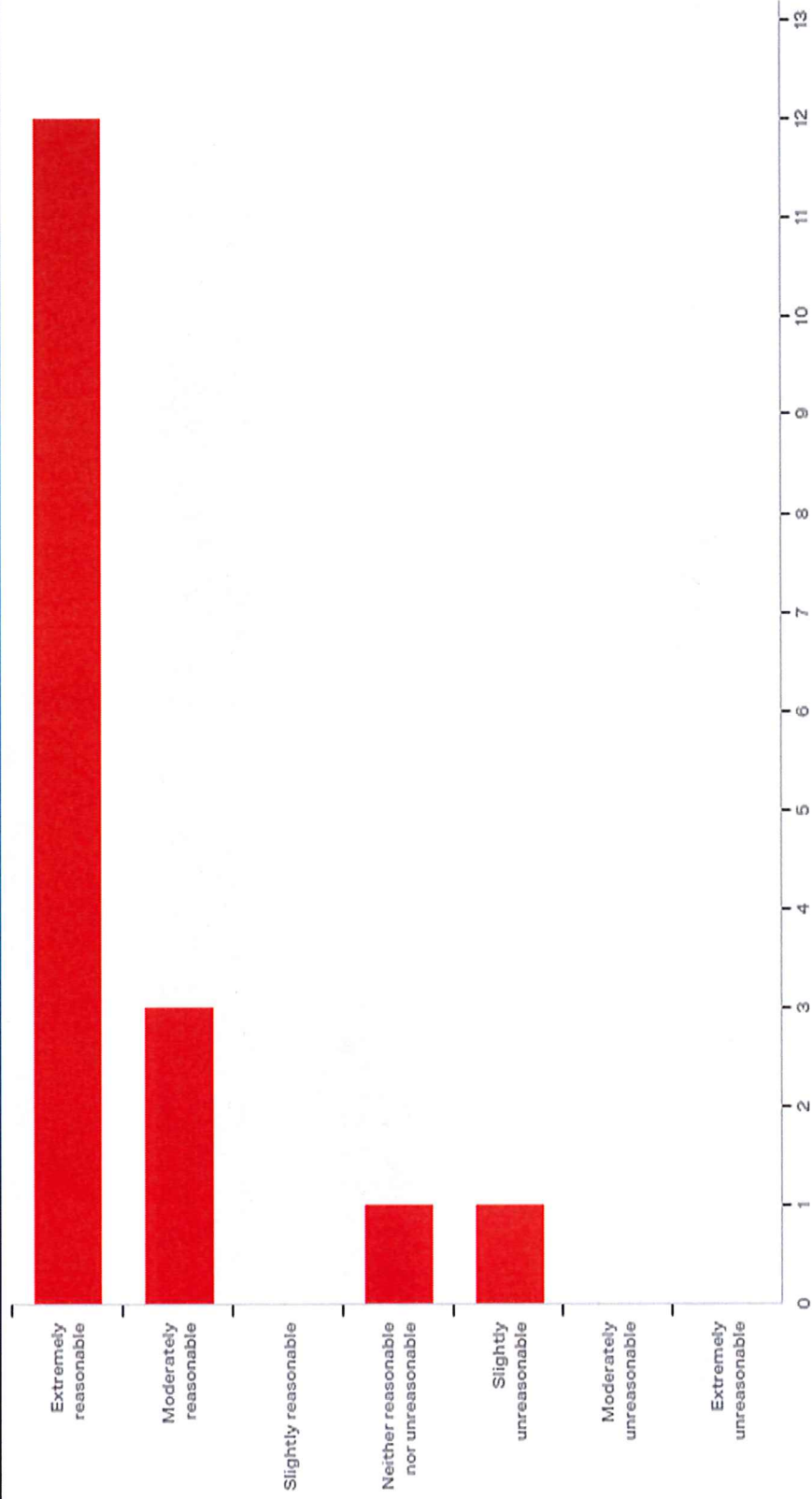

# How challenging was this program for your child?

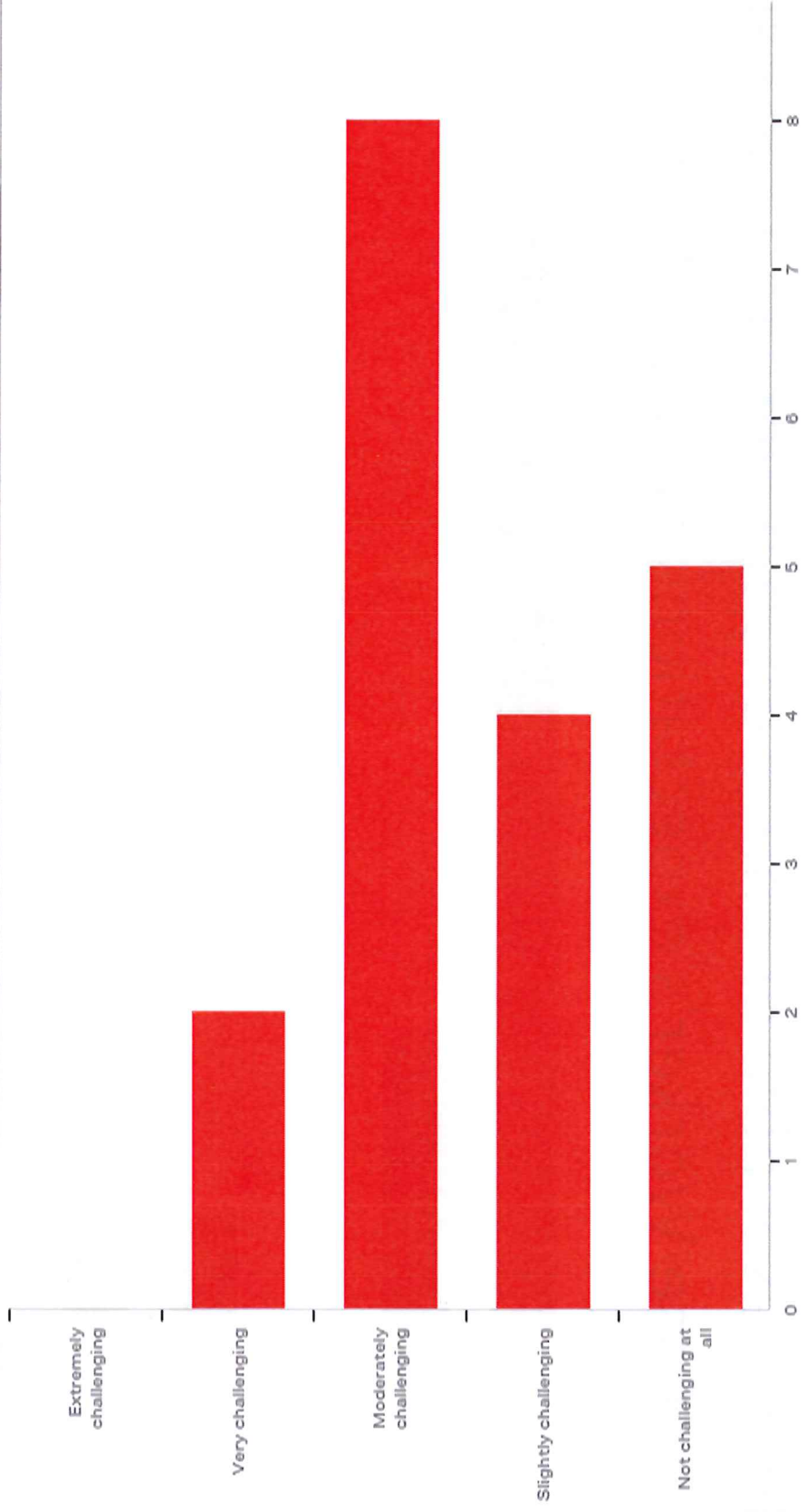

# How much did your child learn from this program?

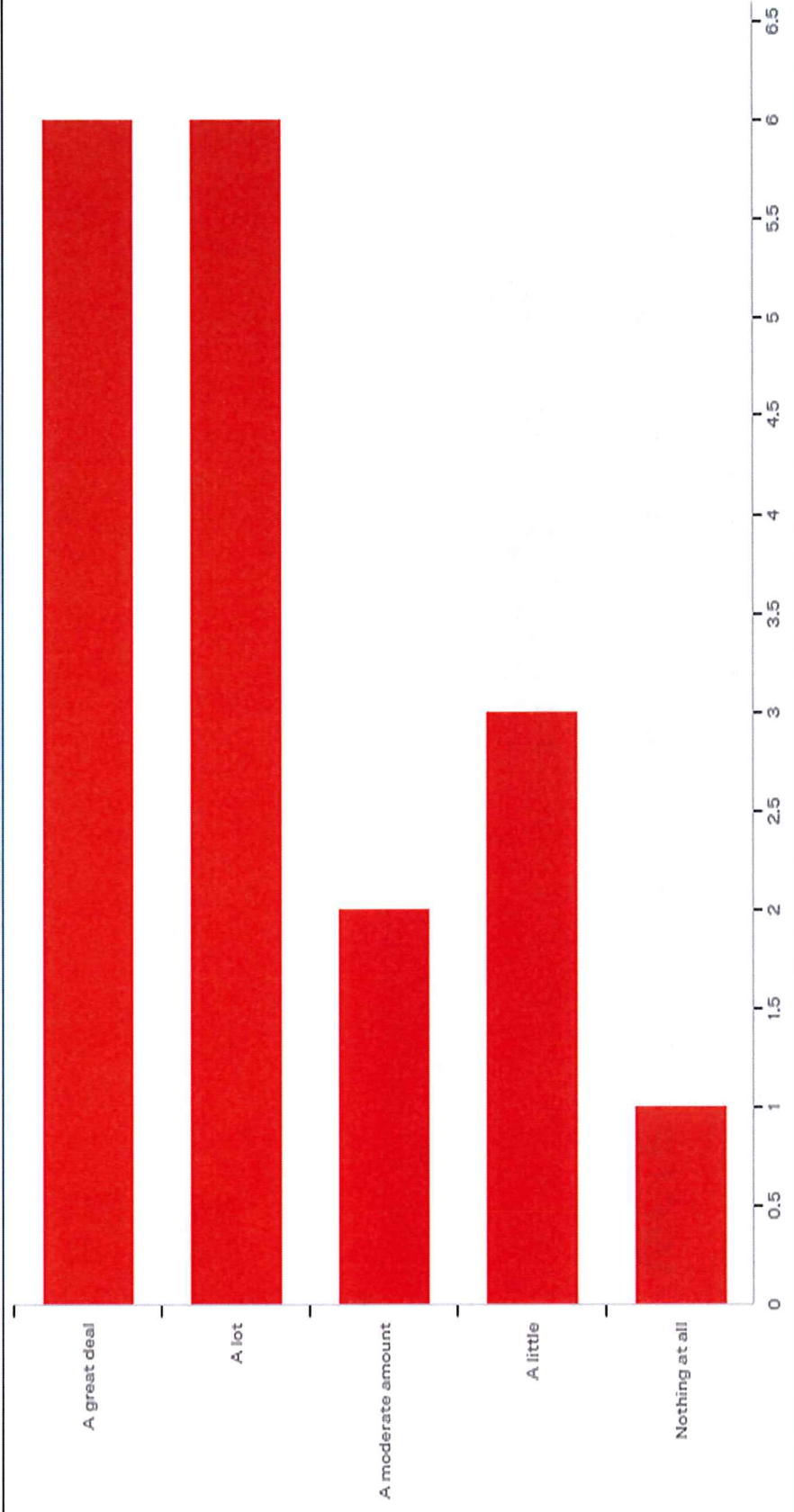

# Overall, how satisfied or dissatisfied were you with Juvenile Diversion?

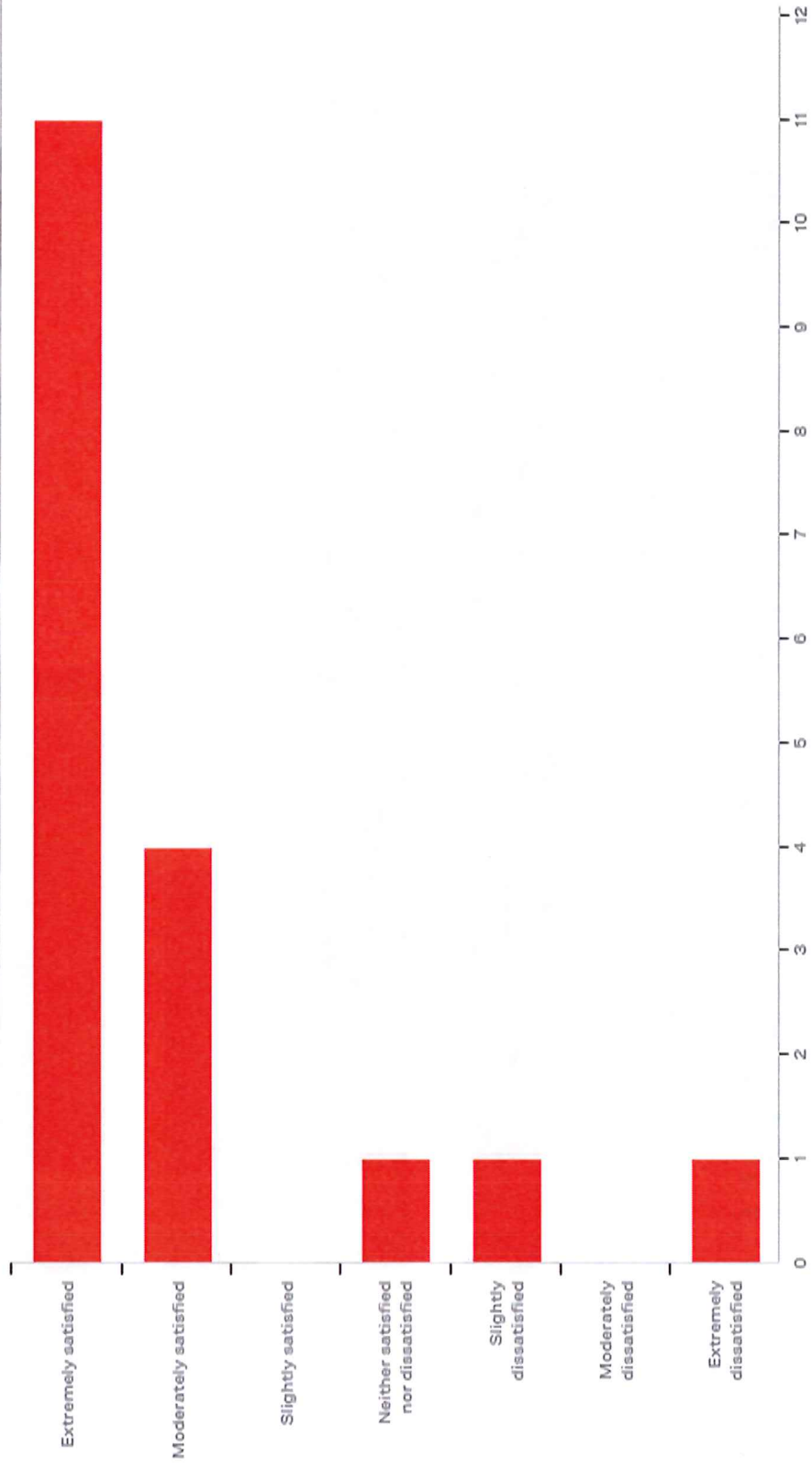



# Pre-Adjudicated Services

- 31 youth served last fiscal year
- 97% did not receive new law violations
  - Average age is 17

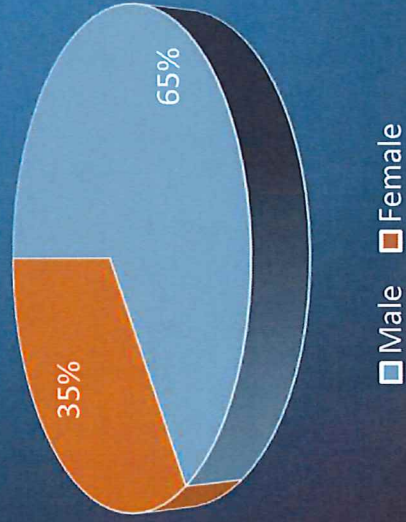

Population Breakdown

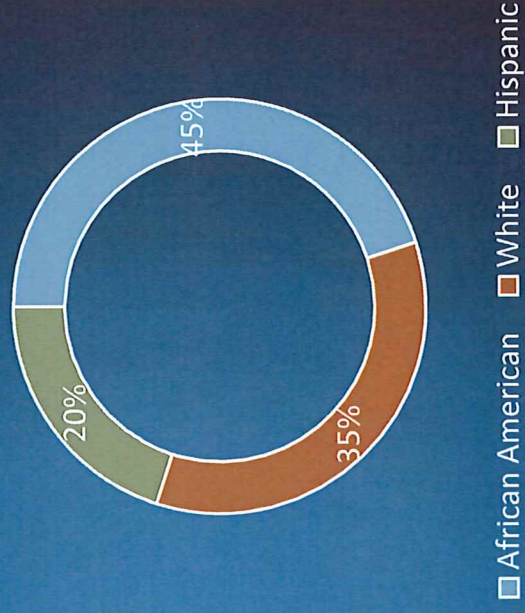



# Warrant Hold Program

- 86% of Youth Attended Court
- 100% Minority Youth
- Average Age is 16 Years
- Partnership with the School
- Home Visits
- Referrals from Judiciary



# Operation Tipping Point

Contracted with Nebraska Center for Children, Family, and the Law to help us identify youth at risk of joining gangs. Data reviewed from the Nebraska Risk and Protective Factor Student Survey; Summary Reports for each neighborhood in the City of Lincoln; and the Lincoln Public Schools Annual Statistics to selected targeted schools to partner.

- 65 total referrals
- 64 entered the program
- 26 remained after June 30
- 27 successful discharges
- 11 unsuccessful discharges
- 1 could not reach

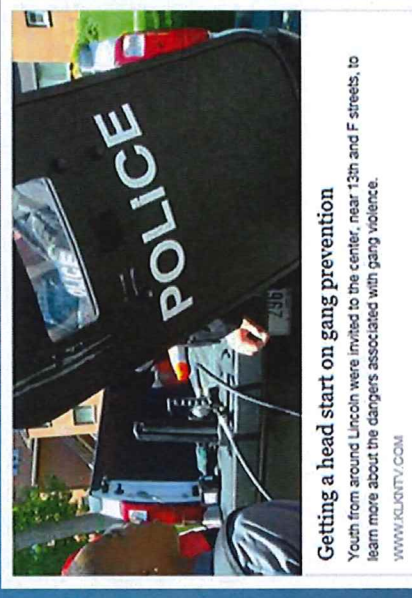



# Taking Care of Our Most Vulnerable Citizens



# Joint Budget Committee & Keno

## JBC 2018-2019

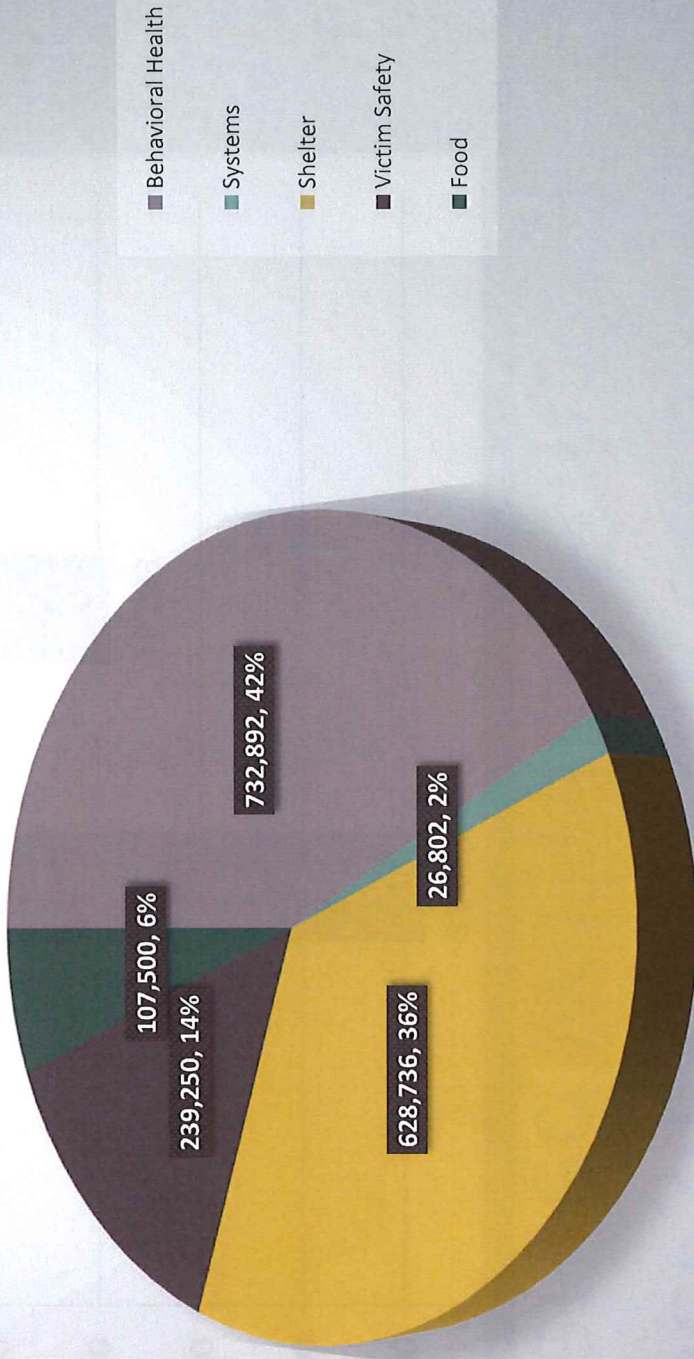



# Number of Unduplicated Citizens Served with JBC Funding

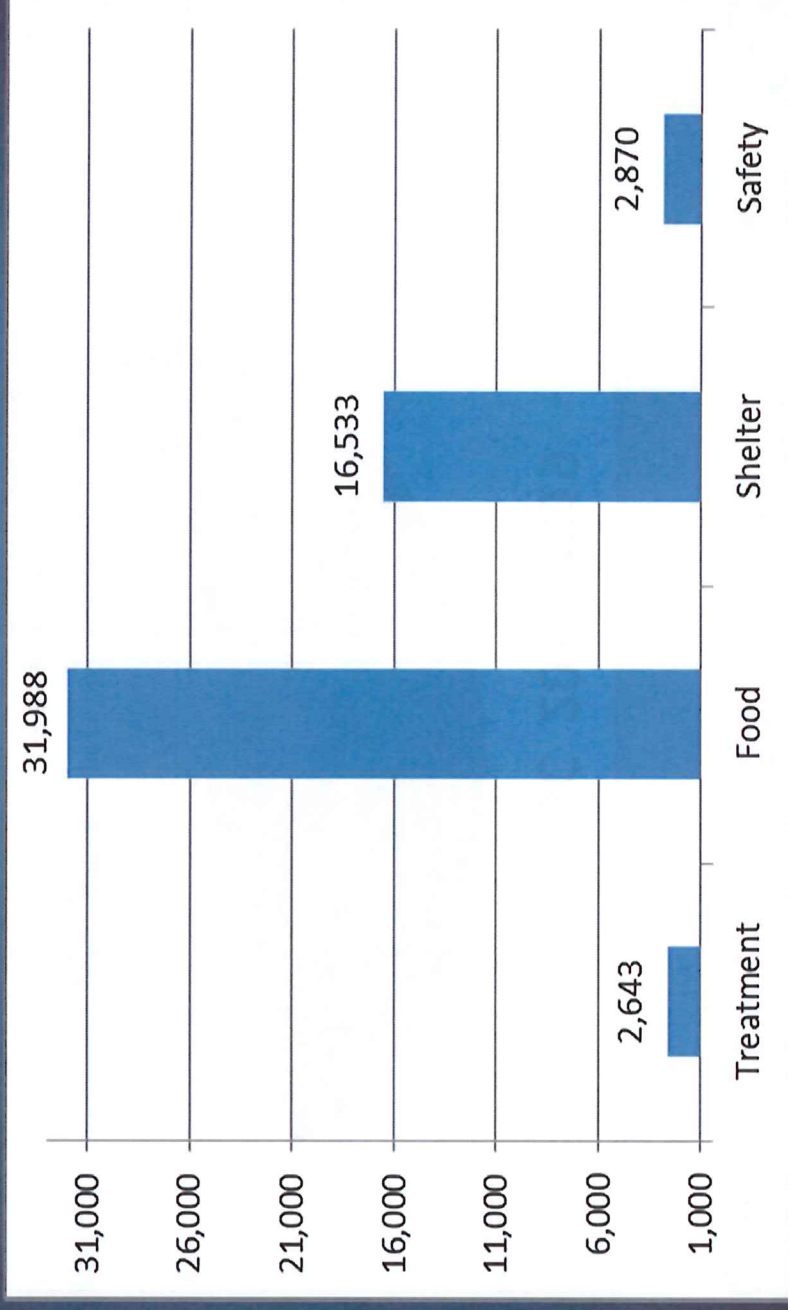



# JBC Funding History

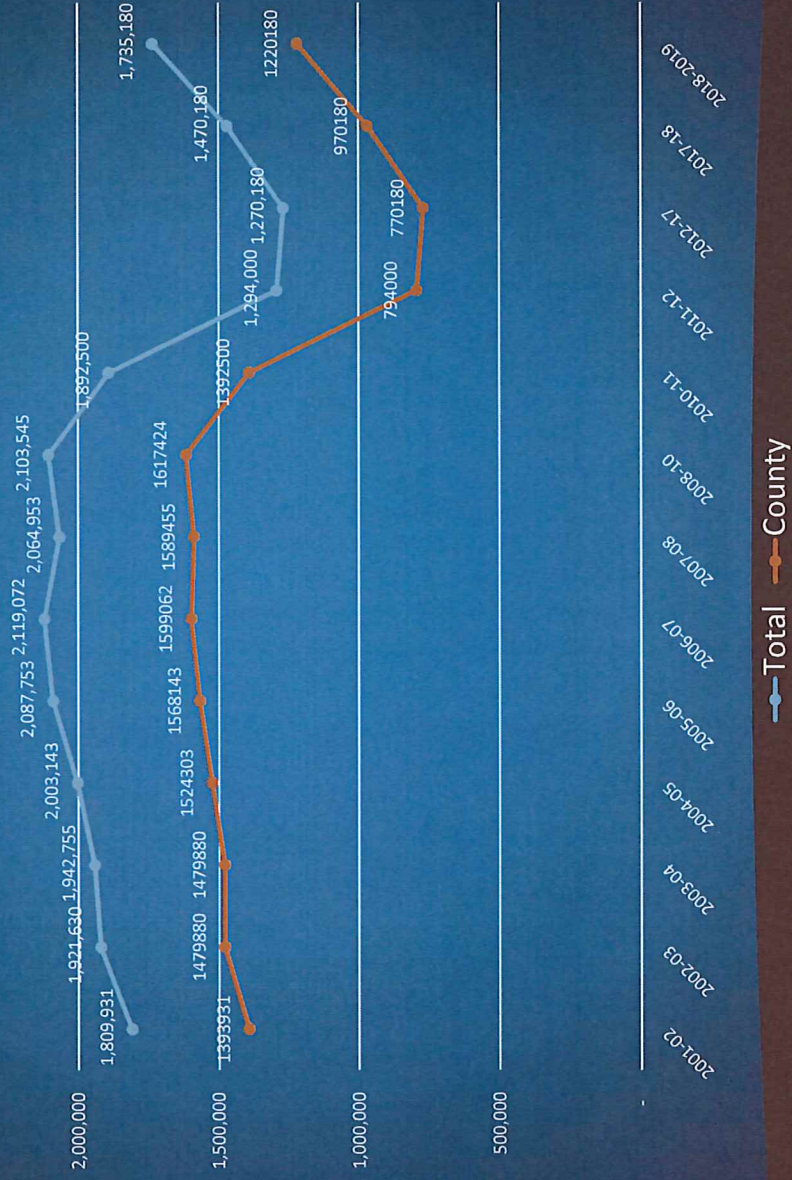

# Keno

- The City and County each contribute 5% of their respective share of Keno lottery proceeds to the Keno Human Services Prevention Fund to be used for community betterment purposes
- Priority Areas are: Problem Gambling Prevention, Family Violence, Behavioral Health, Early Childhood and Youth Development, Basic Needs/Self Sufficiency, and New Americans Programs
- Redesigned Application and Guidelines
- Worked with the City for Consistency Among Committee Members' Appointments

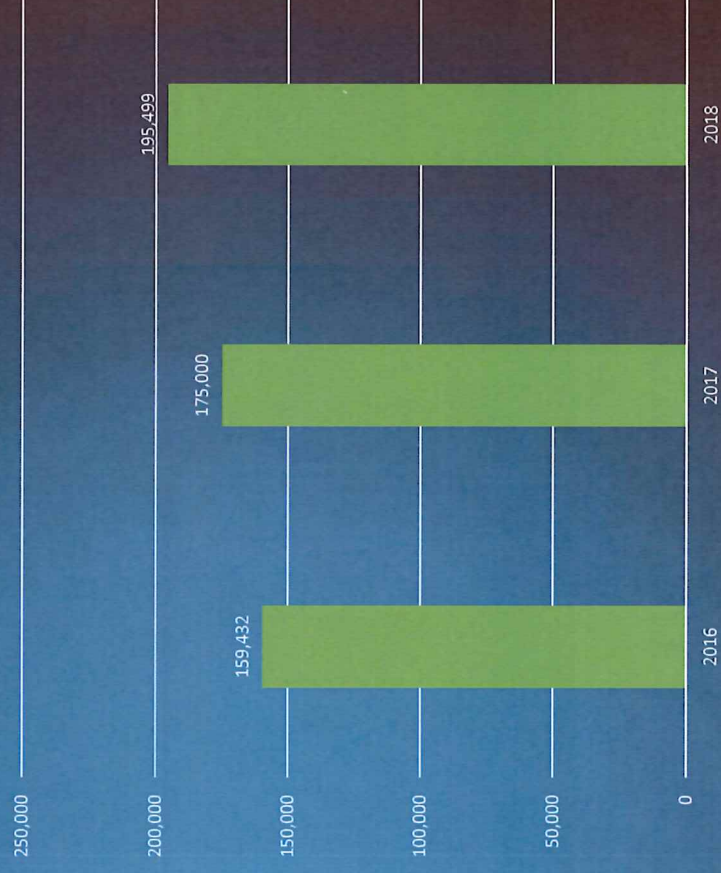



# Community Outreach/Committees

- Region V Behavioral Health Advisory Committee
- New Americans Taskforce
  - Lincoln Unites
  - Refugee Mental Health
- Funders Group
- Homeless Coalition
- Joint Budget Committee
- Keno Prevention Committee
- Human Services Federation
- Juvenile Justice Review Committee
- Reducing Racial & Ethnic Disparities
- Nebraska Crime Commission Grant and Community Planning Committee
- Steering Committee
- Community Action Program Committee
- Justice Council
- General Assistance Monitoring Committee
- Plus more Committees and Agency Site Visits. . .



# Grant Writing and Administration

- Grants Written & Awarded
  - State \$1,099,926
  - Federal \$500,000
  - 35 Contracts
- County Funds Awarded
  - JBC \$1,220,180
    - 32 Contracts
  - JJPF \$400,000
    - 18 Contracts
- City Funds Awarded
  - JBC \$515,000
    - 12 Contracts
  - Keno\* \$195,499
    - 25 Contracts

\*Keno is City/County Funds Administered through City Contracts

```
ab # n(3.5xcd)/[r~4.906i] x bc~ 56.1rx pke 9243JNM
{3.4219d} x {trdt} kt1.1.ort~9bt}bc~ 56.1rx pke 9243JNM
m2356f0rkt14 n x {3.4219d}bc~ 56.1rx pke 9243JNM
rk# 231 {3.4219d}n(3.5xcd)/[r~4.906i] x bc~n(3.5xcd)
jr5099 9d} x {trdt} 1.ort~9bt}bc~ 56.1rx pke 9243JNM
/[r~4.906i] x bc~n(3.5xcd)/[r~4.906i] x bc~ x {3.421
9d}bc~x bc~n(3.5xcd)/[r~4.906i] x {3.4219d}bc~ 56.1
56.1rx pke 9243JNM6i] x {3.4219d}bc~ 56.1rx pke 924
rk# 231 {3.4219d}n(3.5xcd)/[r~4.906i] x bc~n(3.5xcd)
jr5099 /[r~4.906i] x bc~n(3.5xcd)/[r~4.906i] x
{3.4219d}bc~ 56.1rx pke 9243JNMjr5099 /[r~4
231 {3.219d}n(3.5xcd)/[r~4.906i] x bc~n(3.5xcd)
jr5099 /[r~4.906i] x bc~n(3.5xcd)/[r~4.906i] x
bc~ 56.1rx pke 9243JNMrk# 231 {3.4219d}n(3.5xcd)
/[r~4.906i] x bc~n(3) kt30 = X
```



**"It's a foolproof formula for writing grant applications."**

# General Assistance Clients

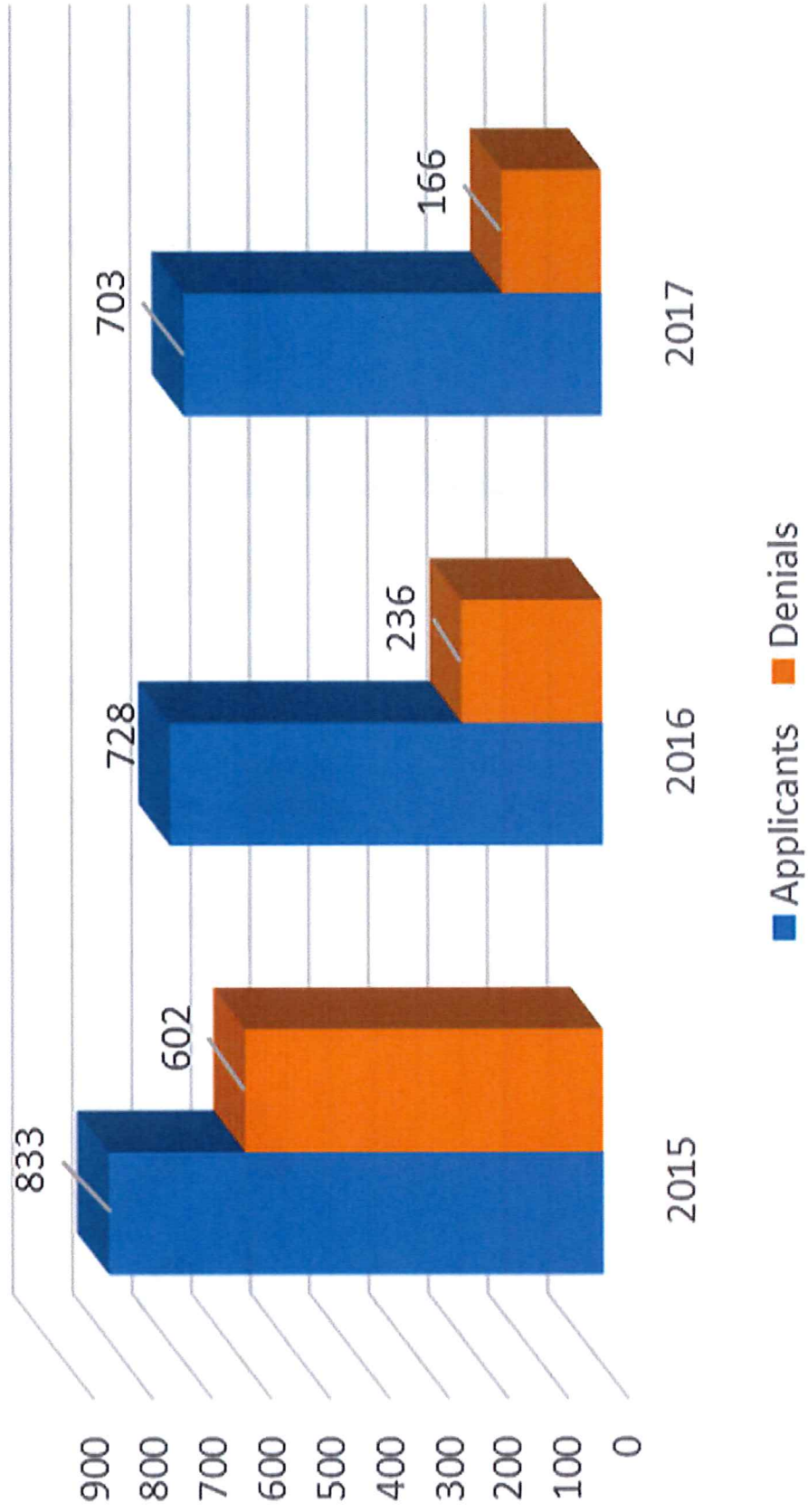

# Assistance Provided

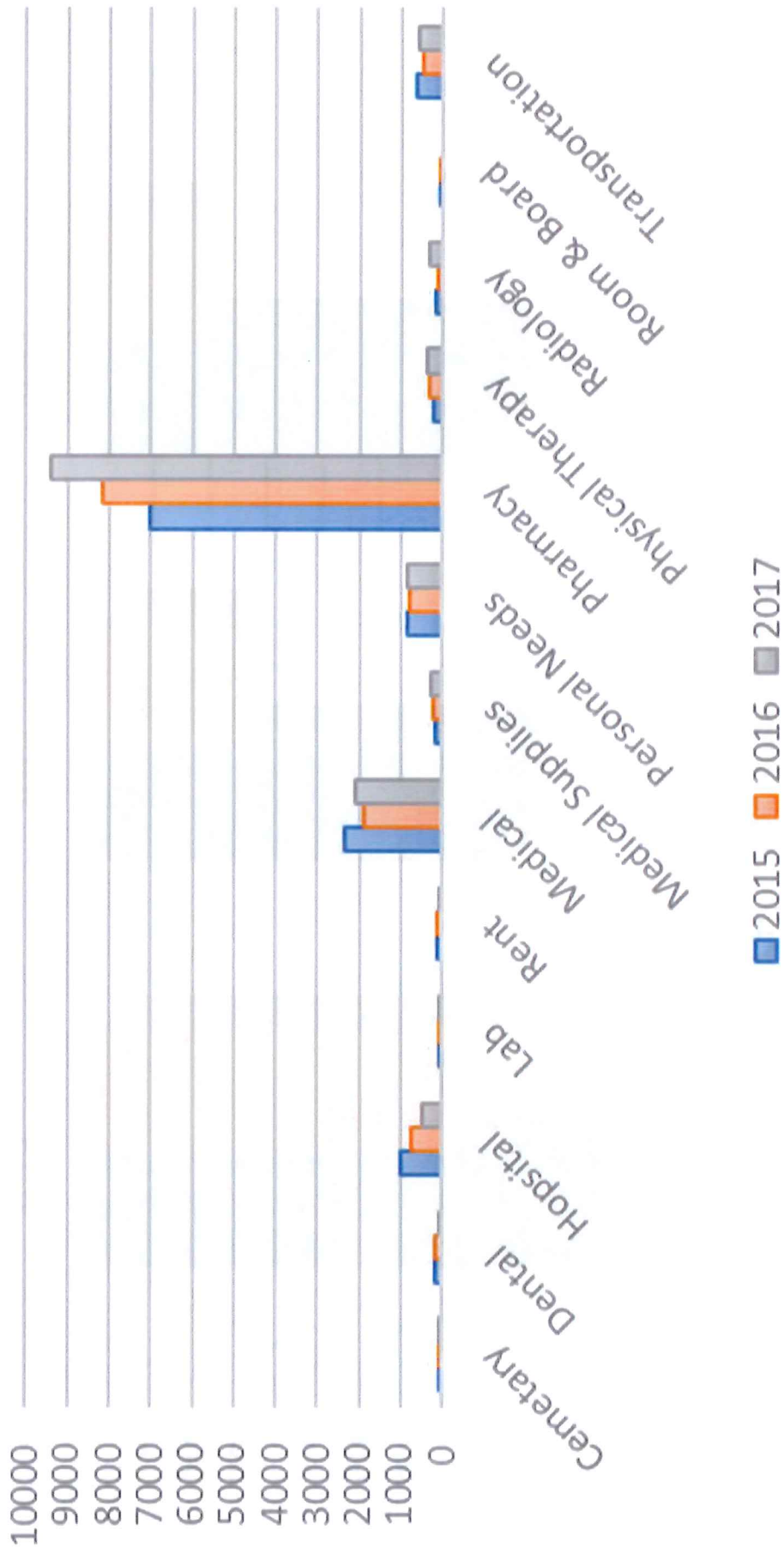



# Assistance Provided

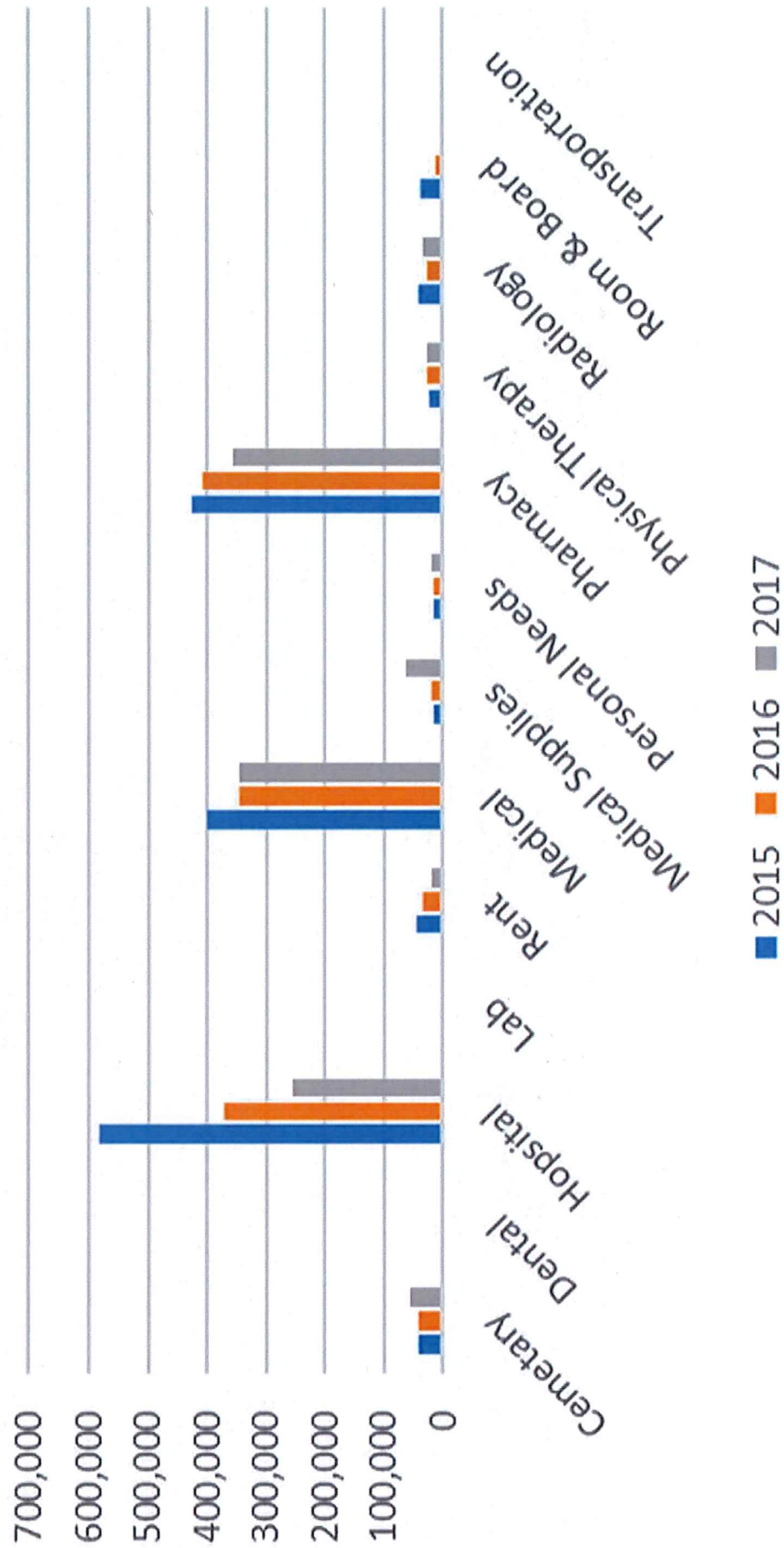

# General Assistance – Revenues & Expenditures

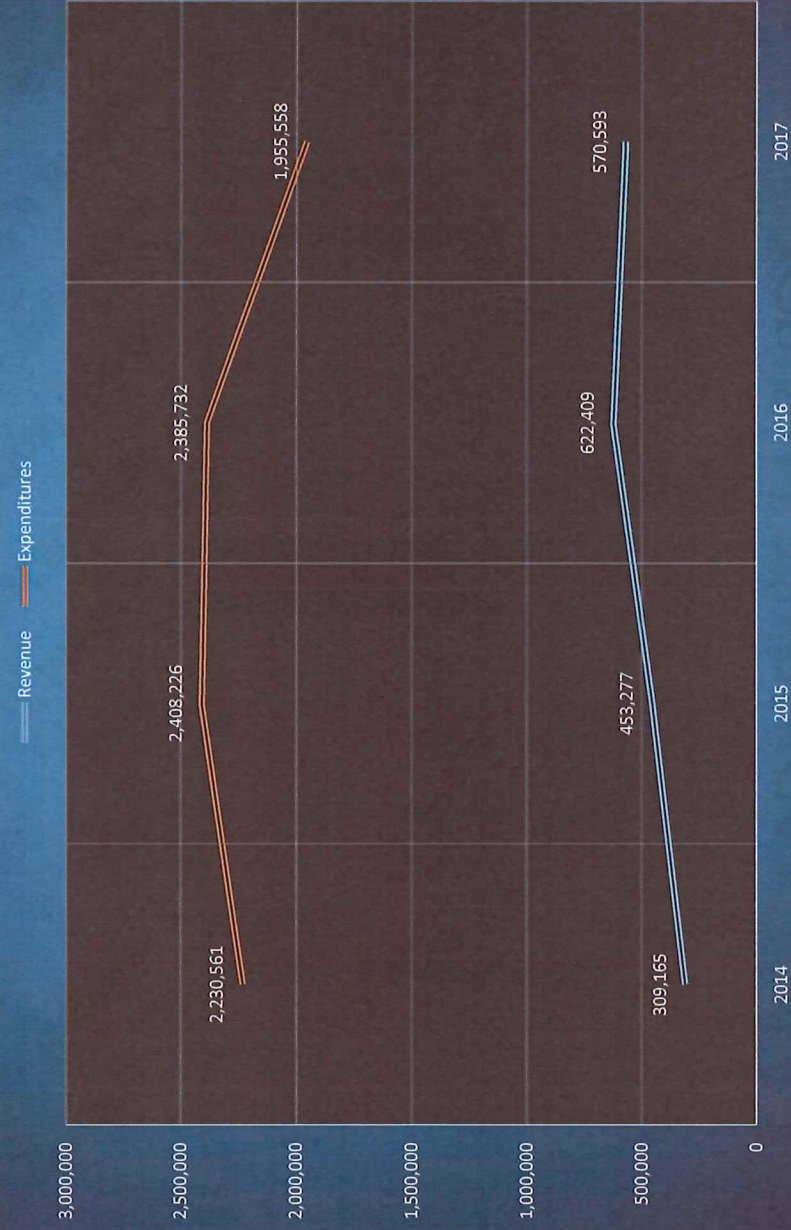



# Total Dollar Amount of Accounts Owed to General Assistance

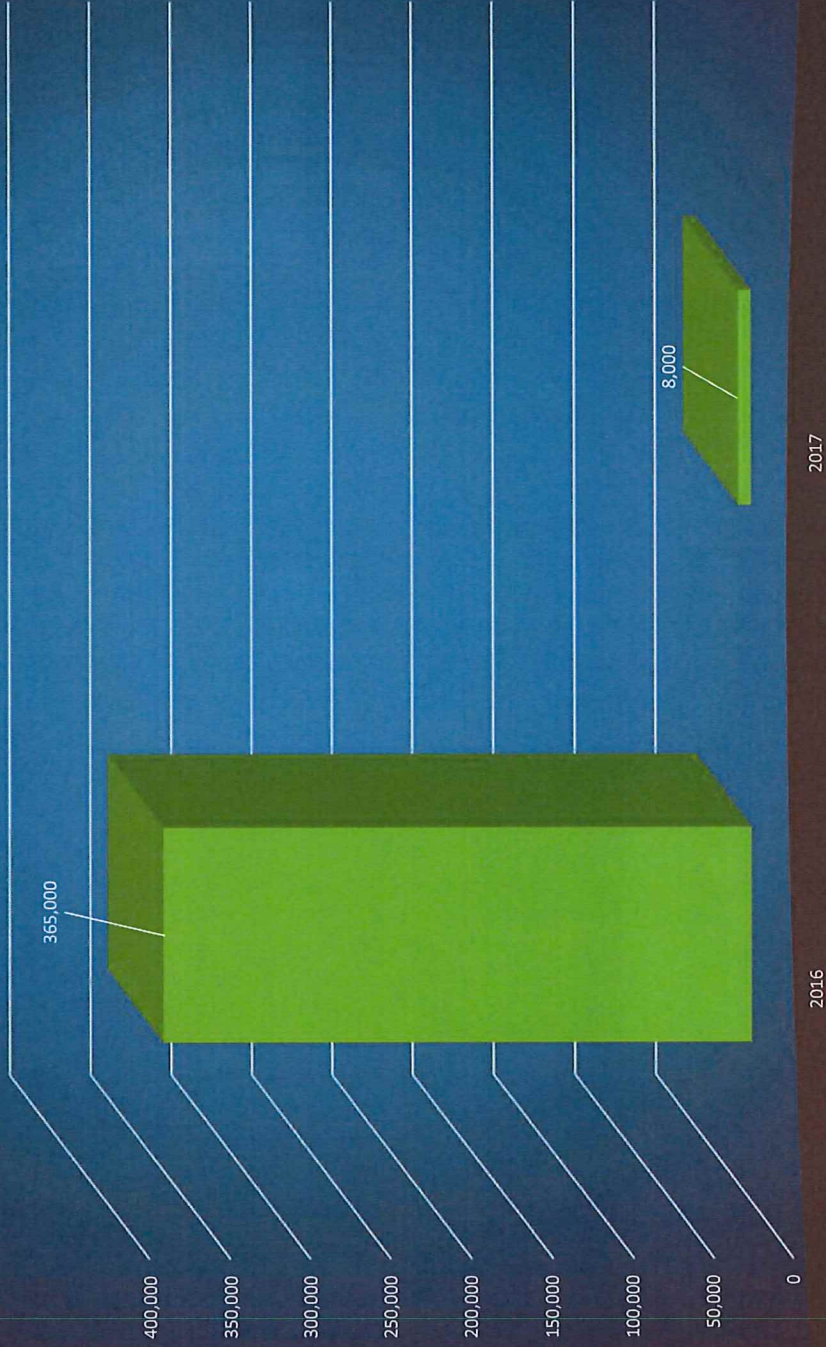

2017

2016



# Accomplishments

- Social Security Audit
- 22% (\$523,726) reduction in General Assistance Budget
- JDAI
- Expanded Data Analysis Efforts
- Juvenile Justice Community Plan 2018-2021
- Increased Community Partnerships
- General Assistance Providing Assistance through SOAR
- LPS Interlocal
- JBC Visioning

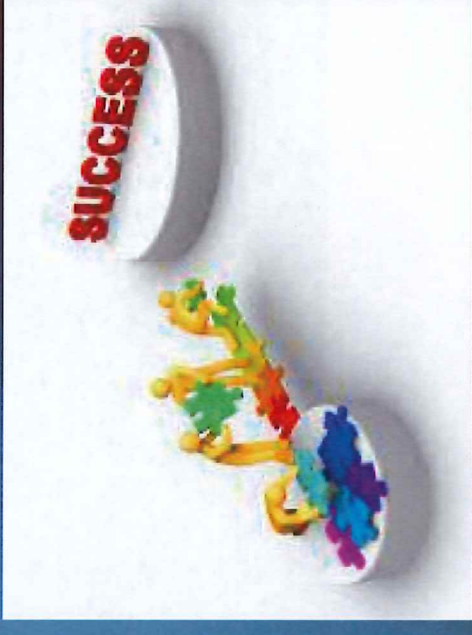



# Short-Term Goals

- Merged Databases for Juvenile Justice and Statistical Analysis Ability
- Partner with 10 new Community Based Agencies
- Build and Enhance Family Outreach and Support
- JDAI
- Partner with Cultural Centers for Diversion Outreach Opportunities
- Contract Timetable





# Long-Term Goals

- 85% Success Rate for Youth on Diversion
- No more than 8% Recidivism Rate for Diversion Youth
- Partner with Probation to have the Nebraska Youth Screen Validated for New Americans
- Work Collaboratively to Decrease Minority Youth Entering the System
- Collectively work to Expand and Enhance Crisis Stabilization for Youth
- Ensure Community Partners are Adequately Funded



# Challenges

- On-Going Juvenile Justice System Reform
- Medicaid Expansion
- Unfunded Mandates
- Federal & State Funding
- Behavioral Health Needs
- Contracts

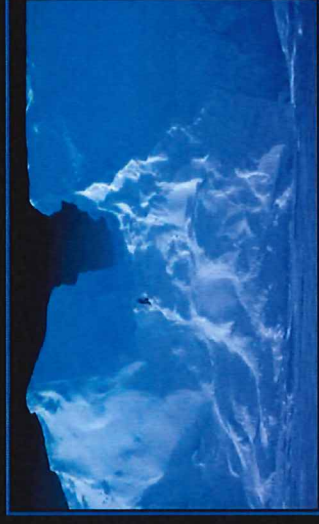

## CHALLENGE

"Success is when you realize obstacles you face are challenges to help you become better - and your response equals the challenge."

- Stephen Covey

# Harassment Training

Everyone trained by Human Resources in August 18'

Ongoing Plans for Future Training

- Supportive Culture
- New Employees Trained within 1<sup>st</sup> month
- Work with HR to individualize training for the Human Services Department
- Ensure management team is cognizant of signs to look for and supports culture where employees can come forward





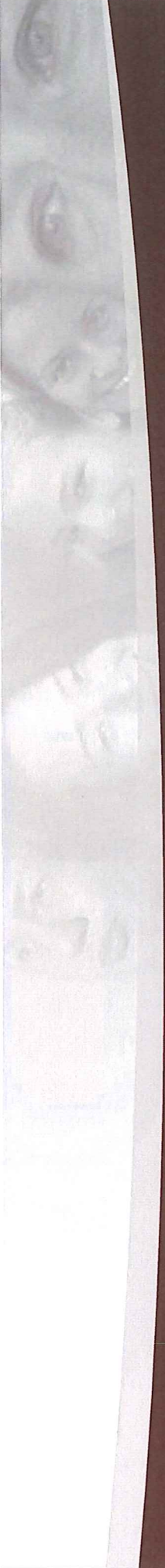

The cost of human life and  
happiness is the first and only  
object of good government.

– Thomas Jefferson





**POLICYHOLDER DISCLOSURE  
NOTICE OF TERRORISM  
INSURANCE COVERAGE**

You are hereby notified that under the Terrorism Risk Insurance Act, as amended, (the "Act"), you have a right to purchase insurance coverage for losses resulting from acts of terrorism, *as defined in Section 102(1) of the Act*: The term "act of terrorism" means any act that is certified by the Secretary of the Treasury—in consultation with the Secretary of Homeland Security, and the Attorney General of the United States—to be an act of terrorism; to be a violent act or an act that is dangerous to human life, property, or infrastructure; to have resulted in damage within the United States, or outside the United States in the case of certain air carriers or vessels or the premises of a United States mission; and to have been committed by an individual or individuals as part of an effort to coerce the civilian population of the United States or to influence the policy or affect the conduct of the United States Government by coercion.

Coverage under your policy may be affected as follows:

YOU SHOULD KNOW THAT WHERE COVERAGE IS PROVIDED BY THIS POLICY FOR LOSSES RESULTING FROM CERTIFIED ACTS OF TERRORISM, SUCH LOSSES MAY BE PARTIALLY REIMBURSED BY THE UNITED STATES GOVERNMENT UNDER A FORMULA ESTABLISHED BY FEDERAL LAW. However, your policy may contain other exclusions which might affect your coverage, such as an exclusion for nuclear events. UNDER THE FORMULA, THE UNITED STATES GOVERNMENT GENERALLY REIMBURSES 85% THROUGH 2015; 84% BEGINNING ON JANUARY 1, 2016; 83% BEGINNING ON JANUARY 1, 2017; 82% BEGINNING ON JANUARY 1, 2018; 81% BEGINNING ON JANUARY 1, 2019 AND 80% BEGINNING ON JANUARY 1, 2020 OF COVERED TERRORISM LOSSES EXCEEDING THE STATUTORILY ESTABLISHED DEDUCTIBLE PAID BY THE INSURANCE COMPANY PROVIDING THE COVERAGE. THE PREMIUM CHARGED FOR THIS COVERAGE IS PROVIDED BELOW AND DOES NOT INCLUDE ANY CHARGES FOR THE PORTION OF LOSS THAT MAY BE COVERED BY THE FEDERAL GOVERNMENT UNDER THE ACT.

YOU SHOULD ALSO KNOW THAT THE ACT, CONTAINS A \$100 BILLION CAP THAT LIMITS U.S. GOVERNMENT REIMBURSEMENT AS WELL AS INSURERS' LIABILITY FOR LOSSES RESULTING FROM CERTIFIED ACTS OF TERRORISM WHEN THE AMOUNT OF SUCH LOSSES IN ANY ONE CALENDAR YEAR EXCEEDS \$100 BILLION. IF THE AGGREGATE INSURED LOSSES FOR ALL INSURERS EXCEED \$100 BILLION, YOUR COVERAGE MAY BE REDUCED.

**Acceptance or Rejection of Terrorism Insurance Coverage**

	I hereby elect to purchase terrorism coverage, subject to the limitations of the Act, for acts of terrorism as defined in the Act, for a prospective premium of <u>\$4,600.00</u> .
<b>X</b>	I hereby decline to purchase terrorism coverage for certified acts of terrorism. I understand that I will have no coverage for losses resulting from certified acts of terrorism.

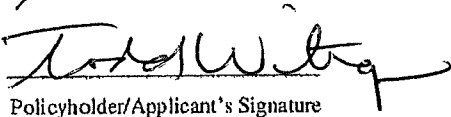
  
Policyholder/Applicant's Signature

\_\_\_\_\_  
Insurance Company

\_\_\_\_\_  
Print Name

\_\_\_\_\_  
Policy Number

# Board of Commissioners of Lancaster County

## Client Authorization to Bind Coverage

After careful consideration of Gallagher's proposal dated 8/14/2018, we accept the following coverage(s). Please check the desired coverage(s) and note any coverage amendments below:

	LINE OF COVERAGE	CARRIER
<input checked="" type="checkbox"/> Accept <input type="checkbox"/> Reject	General Liability	Gemini Insurance Company (W. R. Berkley Group)
<input type="checkbox"/> Accept <input checked="" type="checkbox"/> Reject	TRIA Coverage	
<input checked="" type="checkbox"/> Accept <input type="checkbox"/> Reject	Excess Workers' Compensation	Midwest Employers Casualty Company (W. R. Berkley Group)
<input checked="" type="checkbox"/> Accept <input type="checkbox"/> Reject	Cyber Liability	Indian Harbor Insurance Company (XL Group plc)
<input type="checkbox"/> Accept <input checked="" type="checkbox"/> Reject	TRIA Coverage	

The above coverage may not necessarily represent the entirety of available insurance products. If you are interested in pursuing additional coverages other than those addressed in the coverage considerations included in this proposal, please list below:

---



---

### Producer/ Insured Coverage Amendments and Notes:

---



---



---

  
 Client Initials

# Board of Commissioners of Lancaster County

---

## Client Authorization to Bind Coverage

Provide Quotations or Additional Information on the Following Coverage Considerations:

**Note: Selecting the "Reject All or Accept All" option will override any selections that you make below.**

Reject All  Accept All - Coverages for Consideration

### **Umbrella**

Yes  No Increased Limits

### **Other Coverage Considerations**

Yes  No Cyber Risk

It is understood this proposal provides only a summary of the details; the policies will contain the actual coverages.

We confirm the values, schedules, and other data contained in the proposal are from our records and acknowledge it is our responsibility to see that they are maintained accurately.

We agree that your liability to us arising from your negligent acts or omissions, whether related to the insurance or surety placed pursuant to these binding instructions or not, shall not exceed \$20 million, in the aggregate. Further, without limiting the foregoing, we agree that in the event you breach your obligations, you shall only be liable for actual damages we incur and that you shall not be liable for any indirect, consequential or punitive damages.

By:

\_\_\_\_\_  
Print Name (Specify Title)

\_\_\_\_\_  
Company

  
\_\_\_\_\_  
Signature

Date:

\_\_\_\_\_



**STATE OF NEBRASKA**  
**SURPLUS LINES TAX CONSENT FORM**

AGENT:

RE:

POLICY NUMBER:

DATE:

"With regard to this application for insurance, said coverage or portions thereof, may be written in an Insurance Company that is not licensed to do business in Nebraska, and in the event of the insolvency of such company the policy will not be covered by the Nebraska property and liability insurance guaranty association."

\_\_\_\_\_  
Signature of Agent

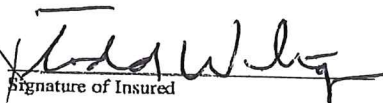
  
\_\_\_\_\_  
Signature of Insured

\_\_\_\_\_  
Date

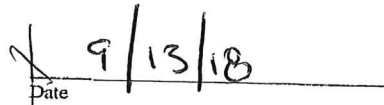
  
\_\_\_\_\_  
Date

SL-03/CB-01  
1/79