

**STAFF MEETING MINUTES
LANCASTER COUNTY BOARD OF COMMISSIONERS
COUNTY-CITY BUILDING
ROOM 113 - BILL LUXFORD STUDIO
THURSDAY, JULY 13, 2017
8:30 A.M.**

Commissioners Present: Todd Wiltgen, Chair; Bill Avery, Vice Chair; Deb Schorr; Roma Amundson; and Jennifer Brinkman

Others Present: Kerry Eagan, Chief Administrative Officer; Ann Ames, Deputy Chief Administrative Officer; Dennis Meyer, Budget and Fiscal Officer; Dan Nolte, County Clerk; Ann Taylor, County Clerk's Office

Advance public notice of the Board of Commissioners Staff Meeting was posted on the County-City Building bulletin board and the Lancaster County, Nebraska web site and provided to the media on July 12, 2017.

The Chair noted the location of the Open Meetings Act and opened the meeting at 8:32 a.m.

Allison Lotto, Records Administrator, appeared and introduced Sara Alcorn, who will be assuming that position.

1. APPROVAL OF THE STAFF MEETING MINUTES FOR JULY 6, 2017

MOTION: Avery moved and Schorr seconded approval of the July 6, 2017 Staff Meeting minutes. Amundson, Avery, Schorr, Brinkman and Wiltgen voted yes. Motion carried 5-0.

2. PLACE MATTERS MAPPING PROJECT PRESENTATION AND BROCHURE - Lori Seibel, Community Health Endowment President/Chief Executive Officer (CEO)

Lori Seibel, Community Health Endowment President/Chief Executive Officer (CEO), gave a presentation on the Place Matters Community Mapping Project. She also disseminated copies of the Community Health Endowment of Lincoln's Annual Report to the Community 2016-2017 (Exhibit A).

In response to a question from Wiltgen, Seibel said law enforcement often engages with mental health clients who have not committed a crime but are in need of services and said they have made a significant investment in the use of peers provided through the Mental Health Association to get those individuals into the appropriate resources. Siebel also reported that she and a group of individuals which included Joe Kelly,

County Attorney; Jeff Bliemeister, Lincoln Chief of Police; and Phil Tegeler, Executive Director, The Bridge (alcoholism treatment program), recently visited the new Kansas City Assessment and Triage Center for individuals in mental health crises. She said the facility gives law enforcement officers and hospitals a place to take individuals who aren't breaking the law in a significant way and don't have a medical condition a place where they can remain for up to 23 hours. Those individuals are reconnected to services while they are in the facility and are diverted from more costly care. She suggested further exploration of that concept. Wiltgen noted there is space available in the building that houses the Lancaster County Mental Health Crisis Center.

Schorr said the National League of Cities has an initiative that is looking at arrests and jail rate of individuals ages 18-25. She said Kurt Elder, Geographic Information Systems (GIS) Analyst, City Urban Development, took the Community Health Endowment's data regarding poverty and overlaid it with arrest records from that population and will be presenting that work in a webinar for the National League of Cities.

**3. LINCOLN/LANCASTER COUNTY PLANNING COMMISSION
APPLICANT - KEVIN BERNADT**

Kevin Bernadt, candidate for appointment to the Lincoln/Lancaster County Planning Commission, shared his background and his perspective on planning issues.

**4. LINCOLN/LANCASTER COUNTY PLANNING COMMISSION
APPLICANT - CRISTY JOY**

Cristy Joy, candidate for appointment to the Lincoln/Lancaster County Planning Commission, shared her background and perspective on planning issues (see Exhibits B and C).

Schorr asked David Cary, Lincoln/Lancaster County Planning Department Director, who was present for the presentations, to provide information on the areas of expertise for the current members of the Planning Commission.

**5. APPRAISAL OF TRABERT HALL AND FORMER ATTENTION CENTER
FOR YOUTH - Don Killeen, County Property Manager; Jason Pickerel,
Great Plains Appraisal, Inc.; Steve Henrichsen, Development Review
Manager, Planning Department; Ed Zimmer, Historic Preservation Planner,
Planning Department**

Jason Pickerel, Great Plains Appraisal, Inc., who recently performed an appraisal of Trabert Hall (2202 South 11th Street) for the County, stated his appraisal was based on an assumption the property would be re-zoned B-3 (Commercial District). **NOTE:** Discussion took place at the June 29, 2017 Staff Meeting on whether it would be better

to have a change of zone in place before selling the property and the appropriate zoning. Trabert Hall is currently zoned P (Public) which is limited to government. There was also discussion at the meeting of the potential to have the building declared a local landmark and to seek a special permit for historic preservation that would allow uses that might otherwise be permitted under B-3 zoning. It would require R-4 (Residential District) zoning. A suggestion was made at that meeting to combine County owned property at 2220 South 10th Street, the former Attention Center for Youth, to make it more attractive to developers. Pickerel said it has been brought to his attention that that R-4 zoning is more likely, based on the Planning Department's recommendation, and said R-4 zoning would negatively impact the value of the property by 30%-45%. Don Killeen, County Property Manager, said re-zoning to R-4 would create a "windfall" profit for the next owner at a cost to the County.

Ed Zimmer, Historic Preservation Planner, Planning Department, said he believes Trabert Hall meets the characteristics of the zoning code for landmark designation. He said that would open the possibility of a special permit and said it seems like asking to continue the longtime use of the building would be reasonable.

Kerry Eagan, Chief Administrative Officer, questioned the possibility of B-3 conditional zoning, which would not allow the entire range of B-3 uses, or "grandfather" (exempted from provisions) rights. He compared it to the re-zoning and sale of the former Community Mental Health Center Building (2201 South 17th Street). Steve Henrichsen, Development Review Manager, Planning Department, said this is a different circumstance than when the County sold the CMHC Building. He said the County might have an argument for O-2 or O-3 (Office District) zoning. Henrichsen also explained that government does not have "grandfather" rights.

Schorr asked Pickerel for his thoughts on how O-2 or O-3 zoning would affect the value. Pickerel said the condition and layout of the property present problems for certain uses and said if there is an R-4 designation, developers would likely be looking at complete redevelopment.

Schorr then asked Pickerel to address selling the former Attention Center for Youth in conjunction with Trabert Hall. Pickerel said the properties would need to be sold separately to maximize their value. It was also pointed out that the properties are not contiguous.

Zimmer estimated it would take three months to get the property re-zoned and secure a landmark designation.

Brinkman questioned whether there are any risks to seeking a landmark designation. Zimmer said it would impede immediate demolition, adding the owner would be guaranteed the right to demolition under Chapter 27.57 of the City Zoning Ordinances.

Henrichsen noted that a special permit would also be required if a private entity wished to purchase the former Attention Center for Youth and provide human services. There was consensus to delay action on that property.

MOTION: Schorr moved and Avery seconded to ask the Planning Department to prepare an application to re-zone Trabert Hall to R-4 (Residential District) with historic designation and special permit conditions. Avery, Schorr, Brinkman, Amundson and Wiltgen voted yes. Motion carried 5-0.

The Planning Department agreed to provide an update on the process at the July 27th Staff Meeting.

6. BREAK

The meeting was recessed at 10:14 a.m. and Avery exited the meeting. The meeting was reconvened at 10:30 a.m.

7. DEPUTY CHIEF ADMINISTRATIVE OFFICER PROJECTS:

A. Strategic Planning

Ann Ames, Deputy Chief Administrative Officer, reported on a proposal from Lane Gewecke Consulting to provide "team building" activities this fall. Individual interviews would be conducted with County Commissioners and County Board staff members. The consultant would prepare a report that would identify commonalities. A half-day session would then be scheduled to discuss the County's vision, mission and shared values. The cost is estimated at \$4,000 to \$6,000. Meyer said he can build that amount into the budget.

Avery returned to the meeting at 10:32 a.m.

There was consensus to have the consultant also conduct interviews with the heads of the following departments: Adult Probation, Community Corrections, Corrections, Emergency Management, Juvenile Probation and the Mental Health Crisis Center.

MOTION: Amundson moved and Brinkman seconded to direct Ann Ames, Deputy Chief Administrative Officer, to establish the strategic planning activities, at a cost not to exceed \$6,000. Schorr, Brinkman, Amundson, Avery and Wiltgen voted yes. Motion carried 5-0.

B. Lancaster County Website

Ames discussed a proposal from Firespring to update the County's website. She said

she also spoke to two other organizations that create government-only websites but said their cost was in excess of \$100,000. Firespring is proposing to meet with stakeholders and develop a "roadmap" of what is needed to create the website at a cost of \$2,500 to \$3,500. The County could continue to work with Firespring, another web company or Information Services (IS). Ames said IS has indicated it could create a mockup of a website within the buildable hours it has designated for the County (500 per year) but not until August. She noted the full 500 hours were used last year for general maintenance of the website.

Schorr asked whether the buildable hours could be reduced if the County moved forward with the proposal from Firespring. Meyer said it is too late in the budget process and said costs would likely be allocated elsewhere. Ames said IS would still host the website and felt departments would be able to maintain it on their own. She said she would also like Firespring to assist the County with its branding so the County has a cohesive web presence.

Wiltgen said he will share this information with the Information Services Policy Committee (ISPC) at its meeting later in the day. Brinkman asked him to apprise the Board if the ISPC has any concerns.

MOTION: Schorr moved and Amundson seconded to direct Ann Ames, Deputy Chief Administrative Officer, to move forward with the proposal from Firespring. Brinkman, Amundson, Avery, Schorr and Wiltgen voted yes. Motion carried 5-0.

There was consensus to include the following departments in the stakeholder meeting: County Assessor/Register of Deeds, County Clerk, County Sheriff, County Treasurer and a representative of the Courts. Other departments will be notified and will be considered for inclusion if they have an interest.

Ames said IS also asked her if the County wanted to reactivate the Website Team and she declined on behalf of the Board. Board members concurred with that decision.

C. County Board Correspondence

Ames said she is willing to take care of all written constituent complaints but felt the process should be refined.

Wiltgen said he personally responds to emails he receives and copies other Board members. The correspondence is also copied to HPRM, an electronic document and records management system formerly known as TRIM. In terms of telephone calls, Wiltgen said he types a summary and emails it to the Board's email so it will be placed in HPRM and included in the monthly constituent report. If the call was from a constituent that lives in one of the other Commissioner's districts, he will also forward the summary to that Commissioner.

D. Staff Meeting Agenda Format

Amundson suggested that Ames have a separate item each week on the Staff Meeting agenda so she can report on the projects she is working on.

MOTION: Amundson moved and Brinkman seconded to include a Deputy Chief Administrative Officer report in the County Board Staff Meeting agenda. Brinkman, Amundson, Avery, Schorr and Wiltgen voted yes. Motion carried 5-0.

8. POTENTIAL LITIGATION – David Deputy, Deputy County Attorney

MOTION: Schorr moved and Avery seconded to enter Executive Session at 11:00 a.m. for the purpose of protecting the public interest with regards to potential litigation.

The Chair said it has been moved and seconded that the Board enter into Executive Session.

ROLL CALL: Amundson, Avery, Schorr, Brinkman and Wiltgen voted yes. Motion carried 5-0.

The Chair restated the purpose for the Board entering into Executive Session.

MOTION: Schorr moved and Avery seconded to exit Executive Session at 11:05 a.m. Avery, Schorr, Brinkman, Amundson and Wiltgen voted yes. Motion carried 5-0.

ADMINISTRATIVE OFFICER REPORT

- A. Claim for Review - Payment Voucher (PV) No. 577146, Dated June 30, 2017 to Karen Wobig, County Extension Educator, Unit Leader, in the Amount of \$73.22 for Reimbursement of Meals Paid for Other County Employees While Attending an Out-of-Town Conference. County Resolution No. R-14-0032 States "Traveling Employees Will be Required to Personally Pay for Meals and Request the Per Diem from the County"

Eagan said County Resolution No. R-14-0032 may not be applicable because the individuals for whom Karen Wobig, County Extension Educator, Unit Leader, is seeking reimbursement are not county employees.

There was consensus to hold the item until Wobig is present.

- B. Nebraska Association of County Officials (NACO) Southeast District Meeting (September 14, 2017, Camp Carol Joy Holling, Ashland, Nebraska)

Amundson, Avery, Brinkman and Wiltgen indicated plans to attend the meeting.

There was consensus to cancel the Staff Meeting on September 14th and to schedule a Staff Meeting on September 19th, if necessary.

DISCUSSION OF OTHER BOARD MEMBER MEETINGS ATTENDED

- A. Through the Eyes of a Child Initiative Meeting

Amundson said she attended the meeting and said there were updates on Juvenile Probation, electronic pre-sentence investigations (PSI's), and the Juvenile Detention Alternatives Initiative (JDAI).

DISCUSSION OF BOARD MEMBER MEETINGS

- A. Public Building Commission (PBC) Vice Chair Meeting with Mayor - Amundson

Amundson said parking and radio transmission issues were discussed.

9. BOARD OF EQUALIZATION (BOE) FINAL ACTION PROCESS - Dan Nolte, County Clerk; Cori Beattie, Deputy County Clerk

Cori Beattie, Deputy County Clerk, noted final action of the property valuation protests is scheduled on August 8th.

There was consensus to:

- Take the final action in a separate meeting from the Board of Equalization (BOE) Meeting scheduled on that date and to not televise the meeting.
- Make material related to protests available on the internal website.
- Revise the Referee Recommended Value letter to include the following language: *"The most expeditious way to submit your information is to hand-deliver, email or fax it to the Clerk's Office. If documents are sent through the mail, there is a risk they will not arrive timely."*
- Issue a press release regarding the deadline to submit additional information.
- Recommend the City-County Common Meeting scheduled for August 8th be cancelled.

RETURNING TO ITEM 12A

Karen Wobig, County Extension Educator, Unit Leader, appeared and gave an overview of the claim. She said these types of claims have been paid in the past. Wobig also indicated she will be submitting a hotel bill for these individuals as well.

There was consensus to ask the County Attorney's Office to review and make recommendation regarding the claim.

10. BUDGET UPDATE - Dennis Meyer, Budget and Fiscal Officer

A. Terry Wagner, County Sheriff

Terry Wagner, County Sheriff, noted he indicated at Mid-Year Budget Retreat that he would like to add six additional deputies to the Patrol Division over the next six years. He said he would now like to accelerate that process and add two deputies a year over the next three years (see letter of explanation in the agenda packet). Wagner indicated he would be willing to use asset forfeiture funds to purchase patrol vehicles for those deputies provided there are funds available and the vehicles would be in addition to the department's normal budgeted vehicle allotment.

MOTION: Schorr moved and Brinkman seconded to add one additional sheriff's deputy in Fiscal Year 2017-2018. Avery, Schorr, Brinkman, Amundson and Wiltgen voted yes. Motion carried 5-0.

Wiltgen noted the new deputy will need to complete basic academy and field training before they can operate independently. The new deputy would not be able to get into an academy class until December.

Avery exited the meeting at 11:48 a.m.

B. Joe Nigro, Public Defender

Joe Nigro, Public Defender, discussed his request for two additional felony attorneys (see Exhibit D). He said the number of case overloads has increased dramatically and said case standards would justify adding five attorneys. Nigro said adding an attorney would save the County approximately \$20,000 in legal costs once they reach a full caseload. He said the conflict rate for felonies is approximately 40% and said the cost for legal services is the same whether it is due to a conflict or case overload. Nigro said felony drug cases constitute approximately 56% of the felony cases and said 80% are possession cases, which are low level felonies. He said the Courts' cost figures don't always match the Public Defender's figures because the Courts pay when the cases are closed which could take 18 months or more.

Avery returned to the meeting at 11:52 a.m.

Nigro said the Indigent Defense Advisory Committee has submitted a letter in support of the request. **NOTE:** A copy was not provided to the County Clerk's Office. He said he is concerned about the cost of the legal system to the taxpayers and cited a few of the issues he has worked on to help reduce costs such as problem solving courts, bond and fine reform, and a drug diversion program.

Wiltgen expressed concern that that conflict and overload cases are not being properly tracked. He said the information that has been provided is incomplete. Jared Gavin, District Court Administrator, appeared and said he is working on a way to provide that information and believes it can be done going forward (see Exhibit E). Wiltgen said he would like to see a monthly report. Nigro noted most of the conflicts occur in County Court. He added the Public Defender's Office tries to retain the most serious cases because they are the most costly.

Schorr asked whether legal costs in County and District Court could be reduced at this time if the request is approved. Nigro said there would be a time lag for savings but said he believes there will be an eventual savings in the cost of appointed counsel because his office will be able to take on more cases and can do them at less cost. Gavin reiterated that the Courts don't allow a billing until a case is closed and that can take time.

MOTION: Schorr moved and Wiltgen seconded to approve the hiring of one additional public defender in Fiscal Year 2017-2018.

Schorr said she would be willing to consider authorizing the second public defender if statistics show actual savings. Wiltgen said he is not opposed to revisiting the issue at mid-year. Nigro said he intends to delay the hiring until office renovations are completed so there will be office space available for the new attorney. He also explained that it takes time to train the attorneys on new dockets so it will take time to see the savings.

Avery said he wants to make sure that the Public Defender is not being held to a stricter standard than other department heads, citing the emphasis on numbers to verify the need. Wiltgen said he has consistently said he wants to see that evidence.

Wiltgen said he would also like to see the percentage of individuals being represented by the Public Defender's Office who are in state correctional facilities. Nigro said he believes it would involve a low number of cases.

Wiltgen also inquired asked support from the Nebraska Commission on Public Advocacy (NCPA). Nigro said the NCPA has provided significant assistance to the County through

involvement in major cases. He said NCPA should be able to provide information on how many appointments they have accepted.

ROLL CALL: Amundson, Avery, Schorr, Brinkman and Wiltgen voted yes. Motion carried 5-0.

ADDITIONAL BUDGET DISCUSSION

There was consensus to hold a special Staff Meeting on Tuesday, July 18th to discuss the budget further.

It was also noted the Budget Monitoring Committee will meet on August 10th.

Further discussion took place regarding the County Engineer's budget request and action taken at the July 6, 2017 Staff Meeting to allocate \$1,000,000 in additional funding to the County Engineer's budget. Brinkman said the Board has not verified what it wants to do with the funds that were allocated for Bridge C-91 (North 1st Street and Raymond Road), noting the County Engineer cannot move forward with construction because the Nebraska Department of Roads (NDOR) needs to use Raymond Road as a detour while it makes repairs to Highway 79. She said she would like to see those funds carried over to next year. Wiltgen said the funds are in the budget and it is up to Pam Dingman, County Engineer, how to spend them. Brinkman questioned whether Dingman is able to hold that money from this year's allocation in a sinking fund for next year. Dennis Meyer, Budget and Fiscal Officer, said there was a balance of \$3,500,000 in the Bridge & Special Road Fund (Fund 21) which would have included the additional \$1,500,000 that was budgeted for that bridge. He said he believes those funds are no longer designated for that bridge because it was not included in the projects Dingman reported on at that meeting. Wiltgen said the Board allocated those funds to the County Engineer last year and she spent them this year. He said those funds are built into the budget again this year, as well as an additional \$1,000,000. Schorr added it is unlikely County Engineering could even begin construction until the following budget year because of the detour project. Brinkman said Dingman needs the funds for that specific. Wiltgen said Dingman would need to encumber the project, adding he believes it is disingenuous for the County Engineer to say the Board will not fund the bridge because it did. Brinkman felt the \$1,500,000 in this year's budget should be for other projects and the \$1,500,000 from last year should be carried over in a sinking fund for the projects she identified last year. Schorr pointed out that the County Engineer already has \$3,500,000 in sinking funds. Brinkman responded that Dingman also has more than \$10,000,000 in projects that she needs to address. She said Dingman did not include the bridge project on her list because she was counting on keeping the \$1,500,000 from last year and getting the same allocation, plus the additional \$1,000,000 that was allocated to her, for new projects. Amundson said that was her understanding as well. Meyer said her budget of expenditures would need to be \$1,500,000 higher than what is shown. Brinkman said

then she will bring a proposal forward to increase the County Engineer's budget allocation. Wiltgen said the Board can discuss it at a future staff meeting and said it would probably be beneficial to have Dingman present.

11. ACTION ITEMS

There were no action items.

12. ADMINISTRATIVE OFFICER REPORT

- A. Claim for Review - Payment Voucher (PV) No. 577146, Dated June 30, 2017 to Karen Wobig, County Extension Educator, Unit Leader, in the Amount of \$73.22 for Reimbursement of Meals Paid for Other County Employees While Attending an Out-of-Town Conference. County Resolution No. R-14-0032 States "Traveling Employees Will be Required to Personally Pay for Meals and Request the Per Diem from the County"
- B. Nebraska Association of County Officials (NACO) Southeast District Meeting (September 14, 2017, Camp Carol Joy Holling, Ashland, Nebraska)

Items A and B were moved forward on the agenda.

13. DISCUSSION OF OTHER BOARD MEMBER MEETINGS ATTENDED

- B. Through the Eyes of a Child Initiative Meeting

Item was moved forward on the agenda.

14. DISCUSSION OF BOARD MEMBER MEETINGS

- B. Public Building Commission (PBC) Vice Chair Meeting with Mayor - Amundson

Item was moved forward on the agenda.

- C. Public Building Commission (PBC) - Amundson, Brinkman

No report was given.

- D. Lincoln-Lancaster County Board of Health - Amundson

The meeting was cancelled.

E. Lancaster County Mental Health Crisis Center Advisory Board – Avery

No report was given.

15. SCHEDULE OF BOARD MEMBER MEETINGS

Informational only.

16. EMERGENCY ITEMS

There were no emergency items.

ADJOURNMENT

MOTION: Schorr moved and Wiltgen seconded to adjourn the meeting at 12:50 p.m. Schorr, Brinkman, Amundson, Avery and Wiltgen voted yes. Motion carried 5-0.

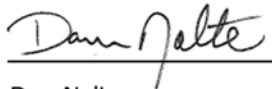

Dan Nolte
Lancaster County Clerk





Contact CHE for a copy of our most recent audited financial statements.

Download a list of all past grants from the CHE website, www.chelincoln.org

Local nonprofit and governmental organizations can use CHE's community room for business-related purposes free of charge between 8 - 4:30, Monday through Friday.

Contact Jodi Loos, 402-436-5516, for more information and to reserve the room.

Annual Report to the Community 2016-2017



PLACE
matters
More Than Ever

Community Health  Endowment of Lincoln

250 N. 21st Street, Suite 2
Lincoln, NE 68503
402-436-5516
www.chelincoln.org

 [facebook.com/chelincoln](https://www.facebook.com/chelincoln)

 [@che_lincoln](https://twitter.com/che_lincoln)

Community Health Endowment of Lincoln



A message from CHE Leadership

Not long ago the term “maker space” entered our vocabulary. It was coined to describe a physical space to create and produce, a place where ideas could be transformed into reality, where a “maker” could invent solutions with freedom and take risks.

Despite this contemporary entry to our dictionary, history is filled with maker spaces. Consider the shed behind Henry Ford’s home where he constructed and refined his first engine from salvaged scrap metal. Imagine the barn warmed by a wood stove where Wilson Greatbatch spent two years developing a prototype for the first implantable pacemaker. Zena Weiler’s kitchen was her maker space as she perfected Valentino’s pizza sauce recipe to the delight of generations of Nebraskans!

Sheds. Barns. Kitchens. Classrooms. Laboratories. Workplaces. All maker spaces.

What would happen if we viewed each Lincoln neighborhood as a maker space? What if we invested the same curiosity, dedication, and tenacity we saw from the likes of Ford, Greatbatch, and Weiler? What if we believed that anything was possible in these unique communities of people?

This Annual Report features people who have become deeply embedded in Lincoln neighborhoods, thrown their collective arms around the distinctive challenges that exist there, and made things happen to improve the health, lives, and futures of their residents. They have created maker spaces; they have become place makers. They have sought out new people and places in their own community and, together with them, are creating legacies of positive change.

As history tells us, not every idea will work. Not every problem will be easily solved. But our place makers chose to see a neighborhood, a place, through the lens of promise and value by calling it their own.

And, as they say, the rest is history.



Charles Wilson, M.D., Chair



Lori Vrtiska Seibel, President/CEO

2016-17 Board of Trustees

CHAIR
Charles Wilson, M.D.
Cardiologist, Retired

VICE CHAIR
Michael Molvar, D.D.S.
UNMC College of Dentistry, Retired

SECRETARY
Don Herz,
City of Lincoln, Retired

TREASURER
Thomas Sullivan, CFA
Union Bank Investment Management Corporation

Tom Beckius
McCombs Commerical Realty
(served through November 2016)

Georgia Blobaum
Advanced Medical Imaging
(served through January 2017)

Carole Burt
Community Volunteer

Kathy Campbell
Former Nebraska State Senator

Judy Halstead
Lincoln-Lancaster County Health Department

Dan Marvin
MIM Co. and Former Lincoln City Council Member

Loren Mestre-Roberts
City of Lincoln

Kim Moore
CHI Health St. Elizabeth

Kimberly A. Russel
Bryan Health

DiAnna Schimek
Former Nebraska State Senator

Jose Soto
Southeast Community College

Rusty Vanneman
CLS Investments

Ellen Weissinger, Ph.D.
University of Nebraska-Lincoln

Staff

Lori Vrtiska Seibel
President/CEO

Marcia White
Program Manager

Jodi Loos
Office Manager

Corey Oldenhuis
Communications/Community Outreach Intern



Front row from left: Michael Molvar, DiAnna Schimek, Charles Wilson, Ellen Weissinger, Kathy Campbell.
Second row: Marcia White, Dan Marvin, Carole Burt, Loren Mestre-Roberts, Tom Sullivan, Judy Halstead, Lori Seibel, Kim Moore.
Back row: Don Herz, Kim Russel, Corey Oldenhuis, Jodi Loos, Jose Soto.
Not pictured: Tom Beckius, Georgia Blobaum, Rusty Vanneman

2017-18

Funding Priorities

CHE has three funding priority areas for 2017-18. By inviting applications that address these priorities, CHE strives to tackle recognized community challenges, create lasting impact, and make Lincoln the healthiest community in the nation.

Health Innovation

- Helping adults and/or children stay healthy outside of a clinical setting
- Embracing bold ideas and community-based solutions that enhance traditional models of health care and/or behavioral health care

Early Childhood Investments

- Reducing or eliminating childhood toxic stress
- Reducing childhood obesity
- Improving maternal health and birth outcomes

Prevention

- Fostering healthy behaviors that lead to improved health outcomes

Funding Preferences

Grant requests in the three priority areas have an improved chance of success when certain factors are also considered. While including these factors in a grant application does not guarantee CHE funding, applicants are encouraged to consider the following funding preferences whenever possible:

Cross-Sector Collaboration

- The application creates intentional linkages between cross-sector partners in areas such as health, housing, neighborhoods, finance/banking, economic development, education, and others.

Impact of Poverty

- The application recognizes the role poverty plays in causing or addressing a community issue.

Use of Local Data

- The application uses local data to inform the need, target group, and/or geographic area to be addressed.

Evidence-Based Models

- The application uses evidence-based models or proven approaches to inform program design and delivery.

For more information, visit www.chelincoln.org and click on Grant Program.

Grants and Programs

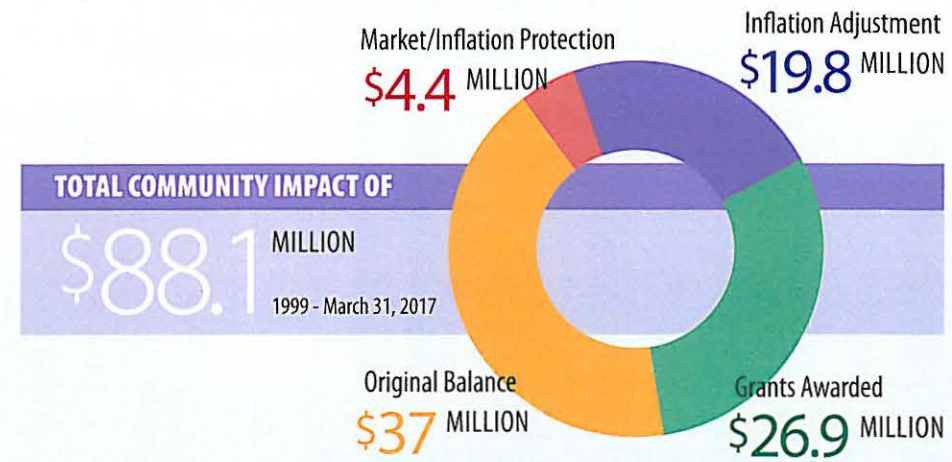

In 2016-2017

CHE awarded **23** NEW GRANTS **44** YEARS OF FUNDING **\$2.45** MILLION

In 2016-2017

there were **22** SITE VISITS WITH GRANTEEES with total Trustee attendance of **92**

Since 1999

CHE has funded **131** DIFFERENT AGENCIES **\$26.9** MILLION returned to the community

Since 1999

CHE has funded **337** NEW PROJECTS **741** YEARS OF FUNDING

Place Maker Profile: Growing Great Beginnings Community Action Partnership of Lancaster and Saunders Counties



Katherine Juarez Lopez and Sheila Stratton enjoy homemade chicken soup.

"Katherine, you made soup!" exclaims Sheila Stratton, enveloped by the mouthwatering aroma of simmering chicken and vegetables. Sheila is the Nutrition and Wellness Coach for Early Head Start and Head Start, programs of the Community Action Partnership of Lancaster and Saunders Counties (CAP). She's been working with Katherine Juarez Lopez since shortly after Katherine's son, Drago, was born. Katherine admits her first attempt at soup wasn't as successful. The broccoli was mushy and tasteless. Now she knows she cooked it too long. That was before she met Sheila. Today, her soup was a success!

Katherine's face lights up when Sheila

compliments her culinary intuition. That will serve her well as she completes her goal of learning to cook six healthy meals. Goal setting differs for each family. Sheila is helping Jessica Parker, mother of three, with her goal of having a backyard garden. "I don't have a green thumb at all," Jessica joked, "so it'll be a fun experiment."

Through the CHE-funded Growing Great Beginnings project, Sheila works directly with clients like Katherine and Jessica and provides support to CAP Family Educators like Brenda Landazuri. Brenda also works with Katherine. "Katherine is fiercely determined to be a good mom and give little Drago the best possible start

works to make sure that Head Start parents get to know each other. They really care."

Chris and Shaneika walk in through the same

front door at Health 360 with vastly different needs but leave equally served. That's the definition of "health beyond health care."

Health is not created solely in the doctor's office. Health innovation means helping people stay healthy outside of a clinical setting. This takes creative solutions that bring people and organizations together in unexpected or nontraditional partnerships. Here are some recent examples of people working to make health beyond health care a reality in Lincoln:

- ▶ Friendship Home advocates help victims of domestic violence and their children access health services and connect to medical homes.
- ▶ People completing substance abuse treatment at The Bridge Behavioral Health receive peer support to prevent relapse and readmission.
- ▶ Lincolniters know more about challenges faced by people living in poverty, and people living in poverty are supported in their efforts to achieve self-sufficiency through the Food Bank of Lincoln's Bridges Out of Poverty program.
- ▶ People with mental health challenges have access to The Orchard, a drop-in, peer-run center for daily support and social connection.
- ▶ Low-income patients of the Health 360 clinic receive help from Legal Aid of Nebraska with legal issues that may negatively affect their health.
- ▶ The Family Violence Council assures that specially trained nurses are always available to examine and support victims of sexual assault.
- ▶ The UNL Center for Civic Engagement's VITA Coalition provides free tax preparation to low-income individuals and families so they receive tax credits for which they qualify and strengthen their financial stability.
- ▶ 10 Health TV, the nation's only 24/7 government-access television channel devoted to health and wellness programming, continues to produce a wide variety of programs and expand to social media platforms.



Dr. Sarah Castillo checks Zhy'Anah Dancy's ears.

Place Maker Profile: Health 360 Health 360 Community



Therapist Kylie Lowe and Health 360 client Chris Anderson are all smiles after reflecting on Chris' progress.

His warm laugh and constant jokes make it hard to imagine, but Chris Anderson was living in fear. After he was diagnosed with PTSD and bipolar disorder, the unknown was everywhere. It was scary. Chris juggled doctor visits, prescriptions, and therapy sessions, all without fully understanding his diagnosis.

The decision to try the Health 360 clinic eventually enabled Chris to say, "Now my life makes sense."

To the diverse clients it serves, Health 360 makes sense. Why not bring a host of services — primary and behavioral health care, dental and pharmacy services, quality early childhood education, legal services, refugee services, and access to fresh produce — together in one location? For Chris, it means that miscommunication between him, his pharmacy, and his doctor is no more. It also means that before or after

appointments with his therapist Kylie, Chris can chat with his community support worker, Michael, who is both a professional and a trusted friend.

"I've got the greatest support team in the world," Chris said. "They never condescend or treat me like I'm the problem."

Just down the hall from Chris's appointment, Shaneika Dancy's two-year-old daughter, Zhy'Anah, gets a routine check-up. As Zhy smiles at her new, colorful Band-Aid, Shaneika recalls when the Health 360 clinic treated her daughter's breathing problem the same day she called. She also talks about how the Head Start program next door is helping improve Zhy's speech. It's not just the results Shaneika loves. Like Chris, she praises the integration and committed staff.

"Now that Zhy goes to Head Start here, she doesn't miss a day of school if she has a doctor's appointment," said Shaneika, "and the staff here

on a healthy life," says Brenda. Growing Great Beginnings helps parents learn about screen time, physical activity, sleep and bedtime, mealtime parenting, and nutrition including eating fruits and vegetables, limiting sugary drinks, and breastfeeding exclusively for at least three months. During a recent workshop, parents

learned about reading food labels and looked for things like serving size and added sugar.

The lessons stick. Even though her son is just three months old, Katherine has turned little Drago's swing to face away from the television. "Now he doesn't stare at it when it's on." Another step in a great beginning.

Health in the earliest years means children can thrive and grow up to be healthy adults. Even infants and young children are affected adversely when exposed to chronic stress. Informed by the first Place Matters Community Mapping Project, CHE identified investment in early childhood as a funding priority in 2015 and affirmed that priority in 2017. Here are a few recent examples of CHE's investment in early childhood:

- ▶ Families in southwest Lincoln will have greater access to quality early childhood education through the expansion and renovation of the Willard Community Center.
- ▶ More low-income and at-risk families are served with home visitation and parent support

through CEDARS and the Lincoln-Lancaster County Health Department's collaboration on the Healthy Families America program.

- ▶ At Lutheran Family Services, children under age five and their families receive focused mental health services to reduce stress and improve day-to-day functioning.
- ▶ More low-income families have access to Early Head Start and Head Start programs through classrooms on the Health 360 campus at 2301 O Street.
- ▶ 95% of the clients served through extended dental clinic hours at the Lincoln-Lancaster County Health Department were children, minimizing absences of children from school and parents' time away from work.



Place Maker Profile: Feet First

F Street Rec Center, Lincoln Parks & Recreation

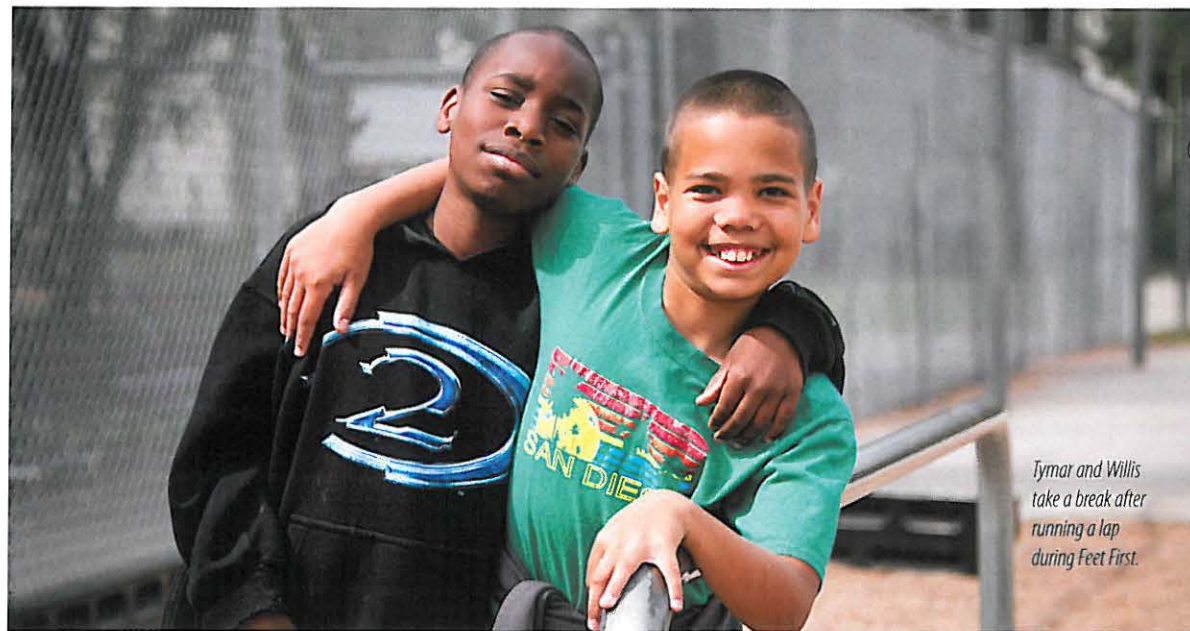

Tymar and Willis take a break after running a lap during Feet First.

Like many fifth graders, Willis Giebelhaus is a boy of few words.

What do you like best about Feet First?
"Running."

How has Feet First helped you? "I run faster."

What would you tell your friends about Feet First? "To do it."

But then you watch Willis run. And you see joy.

Willis is one of the faster runners at Everett Elementary School, one of three Feet First running clubs operated by Lincoln Parks & Recreation's F Street Community Center. McPhee Elementary School and F Street also host clubs. Mary Johnson, Learning Center Supervisor at F Street, was inspired

by a Philadelphia program that involved homeless people in running. As an avid runner herself, Mary knows the physical and mental benefits of running, and the sense of control it can give. "I've seen how it changes people," she said. She wanted that for the people who use F Street, located in the part of Lincoln with one of the highest childhood obesity rates. A Spark! grant from CHE and the Lincoln Running Company's generous donation of running shoes for all the participants got Feet First started in the fall of 2016.

In its first six months, Feet First served more than 50 youth and several adults and families. And, it's working. At the end of two, eight-week sessions, 100% of the youth participants with

usable data showed improvements in mile times. A survey administered at the beginning of the program and again after the second session showed improvements in feelings of self-efficacy such as "When I make plans, I am certain I can make them work."

Willis loves to finish first or tie with his friend,

Tymar. But that doesn't mean his run is over.

What happens when you finish first, we ask. "I go help the other kids. Cheer them on. Encourage them."

A few words that speak volumes about the power of running, of caring coaches and community members, and Feet First.

A child who is obese is more likely to grow up to be an obese adult. Obesity and the diseases that accompany it can take as much as a decade off a person's life. Reducing childhood obesity and fostering healthy behaviors are included in two of CHE's funding priorities. Here are a few recent examples of work being done to help Lincoln residents create healthier lifestyles:

- ▶ A health and wellness center will soon be under construction at City Impact in central Lincoln.
- ▶ Patients at the Health 360 clinic and residents of surrounding neighborhoods have access to fresh, local produce during the summer months through Community Crops Veggie Van.
- ▶ Students can get fresh fruit at public school food markets operated by the Food Bank of Lincoln.
- ▶ Expanded space at the Boys & Girls Club at Park Middle School will allow for increased membership and additional programming.
- ▶ An annual Streets Alive! festival brings a celebration of healthy, active living to a targeted neighborhood.
- ▶ A collaboration between the Malone Center and El Centro de las Americas promotes education, screening and early detection among people of color who are at higher risk for certain types of cancer.

Everett Elementary School students run together during Feet First.





*Cristy K. Joy, AIA NCARB LEED AP
801 West Rock Creek Road
Raymond, Nebraska 68428
402-429-7150*

Opening Statement

Hello, members of the Lancaster County Board of Commissioner and guests, I am a registered Architect and my career is dedicated to my passionate in planning and design. I am deeply committed to smart growth, sustainability and the balance of urbanization with agricultural interests. I bring energy and personal responsiveness to the needs of every assignment.

First, regarding education, I have my Architectural degree from the University of Nebraska-Lincoln. My focus has always been an integration of innovative and traditional thoughts for a well-balanced approach in my company. Our repeat customers and steady company growth measures our success.

I also love and cherish being involved with the community. I have been President of the AIA Lincoln Board, a member of WasteCap now known as the Nebraska Recycling Council, Lincoln Green by Design, and the past President of the Lux Center for the Arts. I have also had the opportunity to be a speaker at the University of Nebraska, and a presenter at AIA meetings on Design Build, LEED, Law Construction and Architecture in Design Build.

Closing

First, I would like to thank you, the members of the Lancaster County Board of Commissioners, for your time and your effort. Second, I hope I have been able to show that I have the knowledge, skills, background and abilities for the position on the Planning Commission and how my education, training, and experience have prepared me for this position. Something I have that I believe that sets me apart from the other well qualified candidates is my motivation, dedication, desire, and most of all, enthusiasm for sustainable growth in Lincoln and Lancaster County.

When you appoint me to the position on the Planning Commission, you can count on me to continue with my motivation, dedication, desire, and enthusiasm for the community and to our comprehensive plan.

When the going gets tough, I plan to be the member of the Planning Commission and carry my own weight by being well informed on the issues. I have prepared myself to be the best that I can be so that I can provide the best possible service to the members of the commission and the citizens that are served by the Commission.

Thank you very much!

Where I live – My home

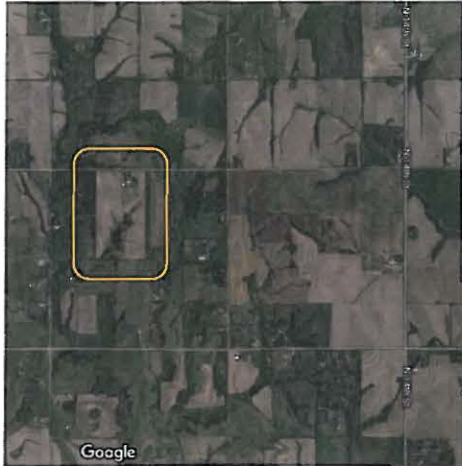
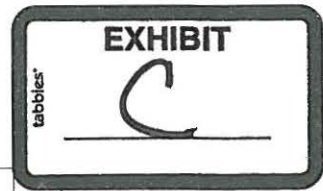

801 West Rock Creek Road
Raymond, Nebraska

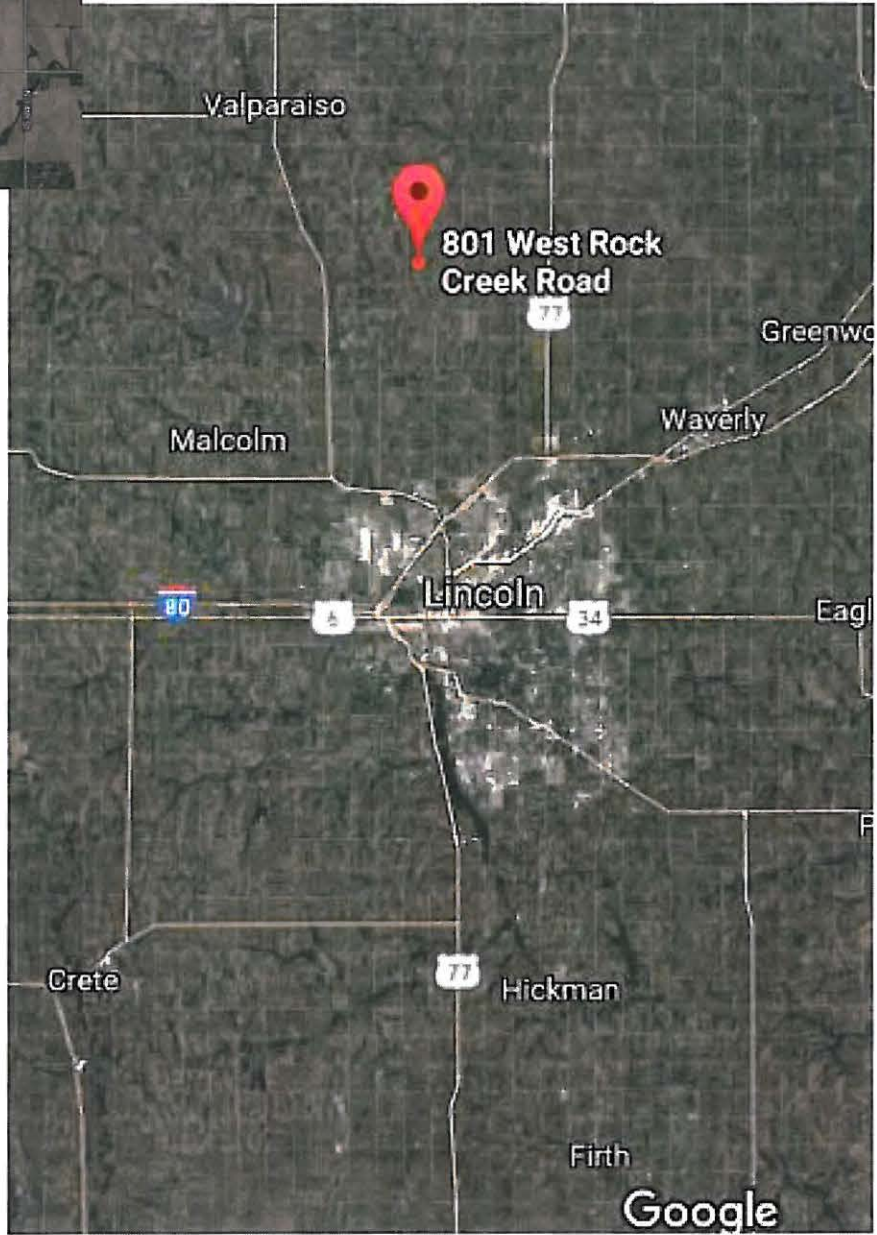
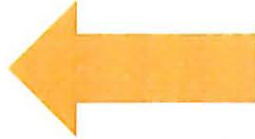

Creativity is intelligence having fun!

Where I live – My home

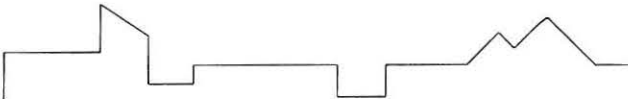

Creativity is intelligence having fun!

Where I Work – My Office



48ROCK -2436 N 48th Street



Creativity is intelligence having fun!



Where I Work – My Office



48ROCK -2436 N 48th Street



Creativity is intelligence having fun!

Where I Work - Projects

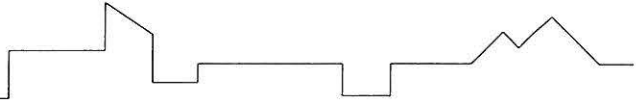

Planning
T.I.F
Design



Piedmont Shopping Center



Creativity is intelligence having fun!

Where I Work - Projects



The Bridge
33RD & 'O' Street



Creativity is intelligence having fun!

Where I Work

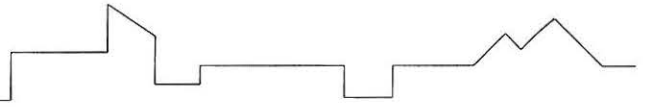

One Technology Place
Garner Industries



Creativity is intelligence having fun!



Where I Work

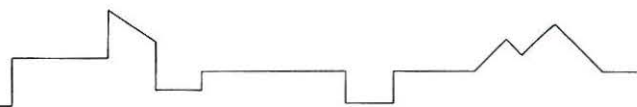

First State Bank

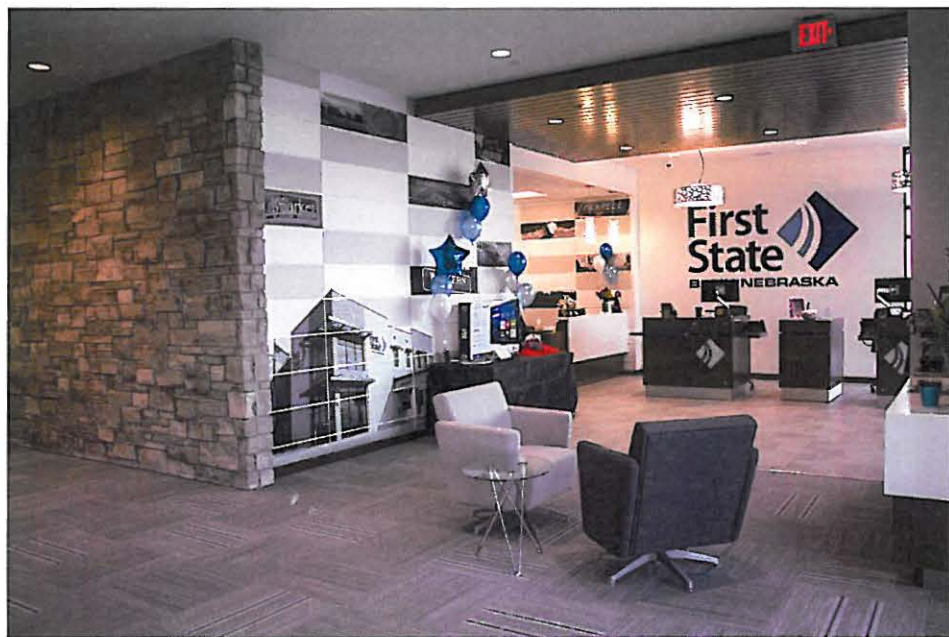

Creativity is intelligence having fun!



Where I Work

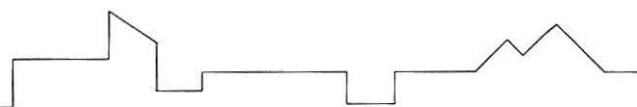

  ARCHI - ETC, LLC
ARCHITECTURE INTERIORS



Sporting Village



Creativity is intelligence having fun!



Where I Work



Cornhusker Bank – 56th & South



Creativity is intelligence having fun!

Where I Work

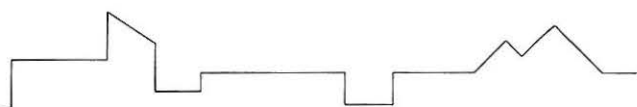

Carnegie Historic - Beatrice



Creativity is intelligence having fun!



My Family

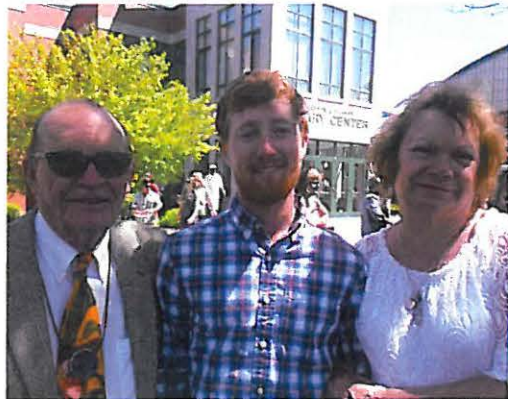
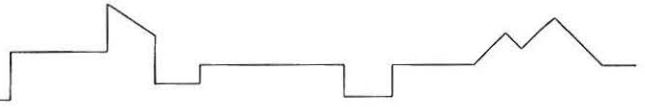

Creativity is intelligence having fun!



My Family



Creativity is intelligence having fun!



My Community

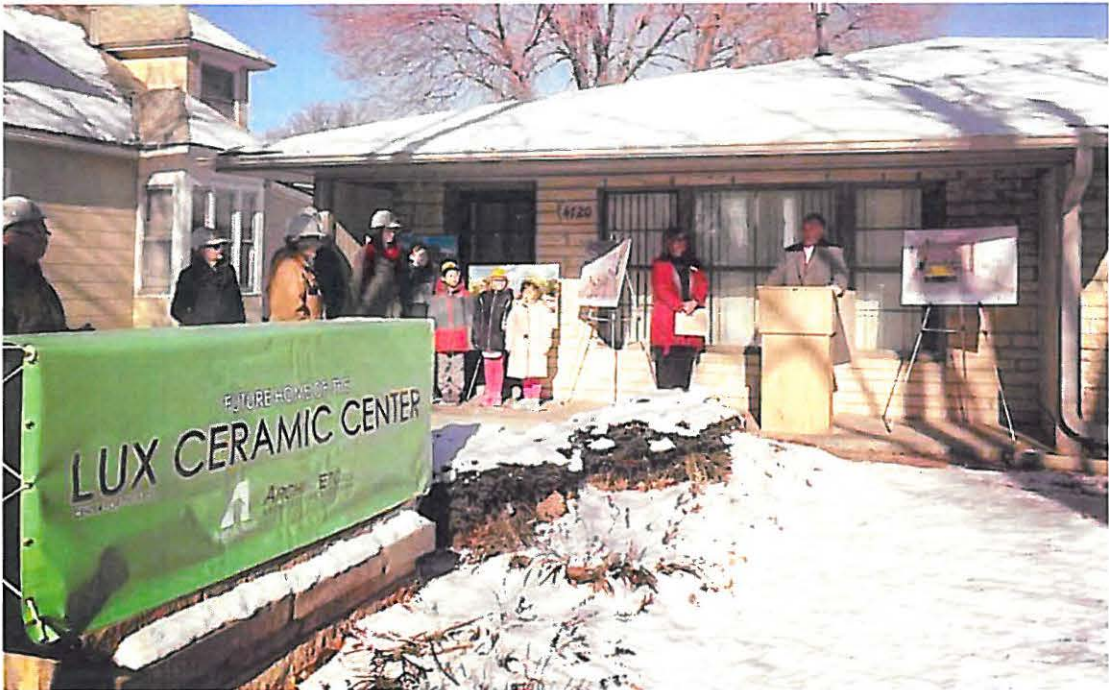

Haymarket in White LUX Center for the Arts

Creativity is intelligence having fun!

My Community



Relay for Life – NE Wesleyan
Pinnacle Bank Arena
The Haymarket

Creativity is intelligence having fun!



My Organizations

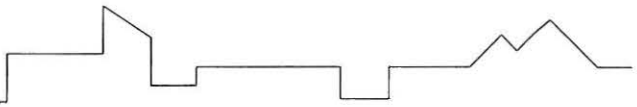

AIA Lincoln Board
LUX Center for the Arts

Creativity is intelligence having fun!



LEED & Sustainability

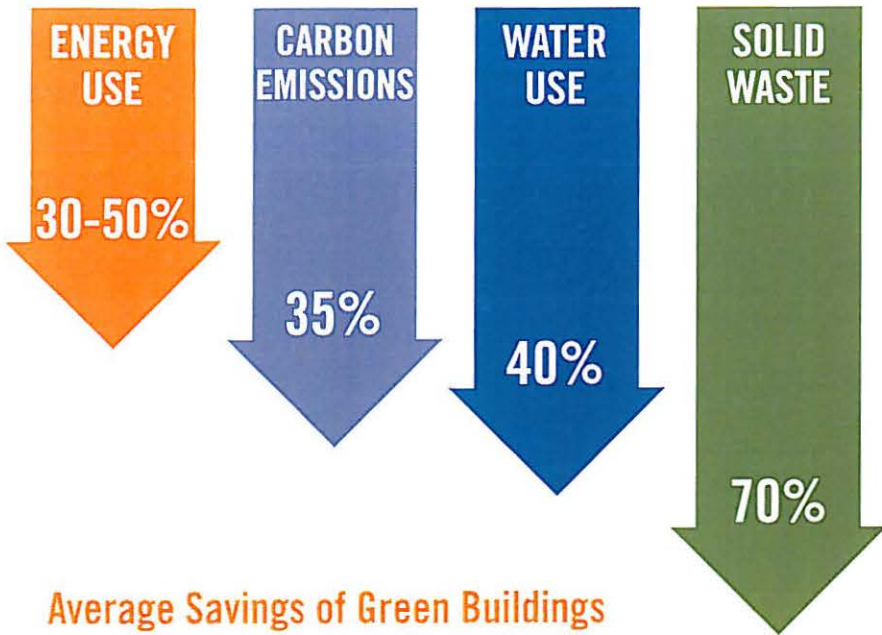

reEnergize
LEED Buildings



reEnergize
building energy smart communities

Creativity is intelligence having fun!



My Interests

English Springer Spaniels
AKC Field Trialing
Hunting

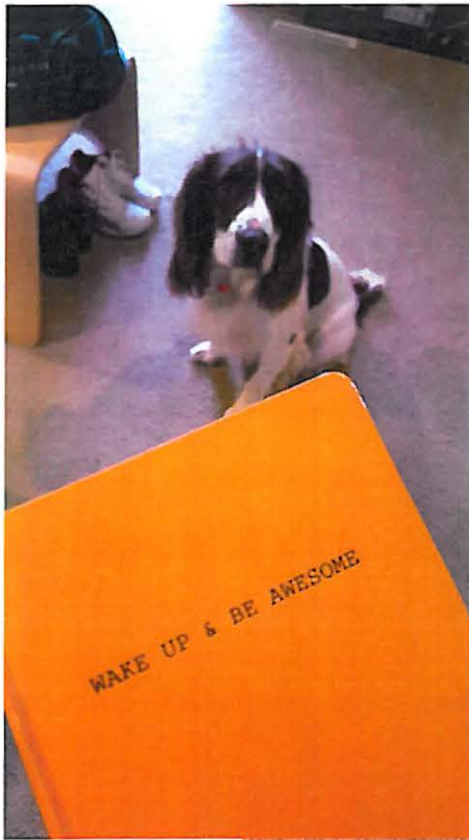

Creativity is intelligence having fun!



CORNHUSKER

B A N K

July 7, 2017

Dear Lancaster County Commissioners:

I am pleased to provide this letter of recommendation for Cristy Joy. I have had the privilege of working with Cristy on key initiatives for our bank to include the complete renovation of our 56th and South Street branch recently. Her attention to detail and ability to manage complex projects with many moving parts and participants made our experience fantastic with her and her team.

Without hesitation, I want to convey the trust and integrity you will find in working with Cristy is of the utmost highest level. Her knowledge of our community, the architectural profession and her ability to solve problems and create win/win solutions set her apart.

Cristy would be a great asset to assist any community in planning. Her attitude of stewardship along with her eye for detail combined with her outstanding customer service skills provide for a unique blend that will benefit any community.

I would be happy to answer any questions and I can be reached at 402-430-8302 anytime.

Sincerely,

Barry J. Lockard

President/CEO





AIA
Nebraska

July 12, 2017

Lincoln/Lancaster County Commission
555 S 10th St, Ste 213
Lincoln, NE, 68508

Dear Commissioners:

Please accept this personal reference in support of Cristy Joy, AIA, of Architecture + Etcetera, as an appointment to the Lincoln/Lancaster County Planning Commission.

As a licensed architect, Cristy is an exceptional problem solver, as well as the knowledgeable and experienced to deal with the myriad of complex issues facing the Planning Commission.

Fortunately, I have had the opportunity to work with Cristy as she served in numerous leadership capacities within the American Institute of Architects, Lincoln and Nebraska Chapters. Most recently she served as the AIA Lincoln Chapter President and was invaluable at collaborating with the Board and other members across Nebraska in developing solutions relating to repositioning of our organization. Cristy is an excellent listener, collaborator and exceptionally positive person during challenges situations. She also has been a strong advocate for policy to improve the design and construction industry locally, statewide and nationally.

I highly recommend Cristy Joy, AIA, be appointed a member of the Lincoln/Lancaster County Planning Commission. Please feel free to contact me if you have any questions regarding her qualifications.

Sincerely,

Sara A. Kay, Hon AIA
Executive Director

The American Institute of Architects

AIA Nebraska
335 North 8th Street, Suite A
Lincoln, NE 68508

T (402) 858 1929

www.aiane.org

July 12, 2017

Planning Commission committee:

I would like to submit this letter of support for Cristy Joy to serve on the Planning Commission.

I have worked for many years with Cristy in a professional capacity. Most recently we engaged Cristy to design and help re-build the Piedmont Shopping Center in Lincoln. She turned what many considered as one of the most blighted developments in the City of Lincoln into what many today think is one of our most attractive.

Cristy's incredible adaptability and balance provides the perfect blend to maintain the character of the neighborhood and at the same time to do it in a practical way so that a project is financially feasible.

Cristy's great connection with the people of Lincoln and relentless perseverance to always do the right thing makes her a valuable asset to our community.

One additional thing I appreciate about Cristy is that she works extremely well with other people in a collaborative environment. This will serve her well if she is chosen to serve on the Planning Commission.

With Cristy's abilities, adaptability, and dedication, she will make an outstanding Planning Commissioner. If you have any questions, please feel free to contact me.

Respectfully,

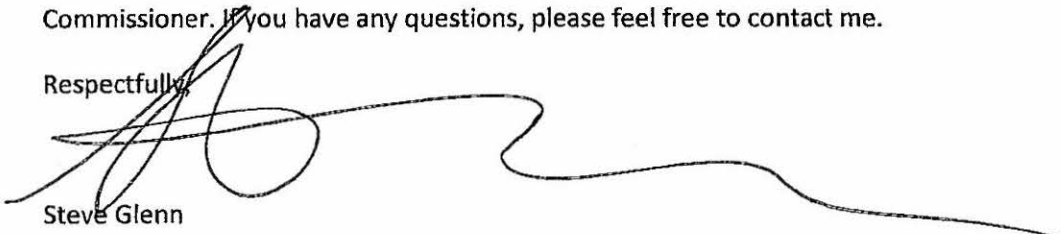

Steve Glenn

CEO
Executive Travel
steveg@executivetravel.com
402-458-9849

Lancaster County Planning Commission
Lincoln, Nebraska

Att: Lancaster County Planning Commission Board of Commissioners

With the recent departure of Ken Weber from the Lancaster County Board, I understand that a commissioner will be appointed. In considering a new Commissioner, I would like to recommend Cristy Joy to the position.

As you are aware, Cristy Joy is licensed Architect that is the owner and lead Architect for Archi-etc, Lincoln, Nebraska. As a client, we have worked with Cristy and her team on hundreds of projects over the past 25 years. We have appreciated Cristy's performance and creativity as we continue this relationship today.

Her experience and expertise would prove invaluable to the Commission on many issues. Her knowledge of code review, long term planning and introducing an architectural perspective would enhance the fabric of the community. We have enjoyed her creative intuitiveness, enthusiasm and common sense approach in bringing new ideas and solution to many of our projects. Cristy would bring this same energy and professionalism to your board.

Active in many community activities, Cristy works tirelessly to bring her talents and the support of others to many community causes. This network of support and dedication has made the difference in hundreds of lives in our community.

My brother's and the entire Speedway family support the recommendation of Cristy Joy to the County Planning Board.

Feel free to contact me with any questions on specific projects or information you may need in this appointment process.

Thank you,

Craig A Smith
Partner
Speedway Properties | Museum of American Speed | Speedway Motors
PO Box 81906 Lincoln, NE 68501
340 Victory Lane Lincoln, NE 68528
T 402.323.3112 | F 402.323.3101 | C 402.540.3112
casmith@speedwaymotors.com



Center
for
People
in
Need

July 10, 2017

Dear Lancaster County Commissioners,

Cristy Joy is a great candidate for the appointment of a member of the Planning Commission. She has worked with the Center for People in Need for the past nine and a half years when we moved into the facility at 3901 N. 27th Street Unit 1.

Our building is in a constant state of construction activity due to our receiving multiple program-related grants. Along the way, Cristy Joy's firm, ARCHI+ETC.LLC, with Ayars & Ayars, Inc. and have been our architectural and construction partners, negotiating with ease all of the state and federal construction guidelines.

They have worked miracles on retrofitting our building on relatively short notice to meet federal grant deadlines. They have carefully planned the work schedule, thinking of every contingency to minimize work change orders during the projects.

We wholeheartedly recommend Cristy Joy for the Planning Commission appointment and know she will give you her best effort.

Sincerely,

Beatty Brasch
Executive Director
Center for People in Need



The State Bank of
TABLE ROCK

MOVING FORWARD WITH THE TIMES
SINCE 1885

Dear Lancaster County Commissioners,

The purpose of my letter is to recommend **Cristy Joy** to fill the vacancy on your Planning Board.

Cristy has been associated with our Bank in many ways. She has helped us expand our facilities to help us better serve our customers and community. She has also worked with our local school districts to make their learning environment more useful for the students and the teaching staff. She has been our customer of ours for several years and has demonstrated the ability to manage her finances very well.

Cristy is the lead Architect and Owner of Archi+Etc.LLC. She has many years experience in the field. She designs projects for Ayars and Ayars to build. Her work with us has been very favorable. She takes the time to interview us, get our ideas, views the site and puts together a nice plan. We review the drawings together make any necessary changes. She is very patient and is very accommodating. We have always been pleased with her work.

Cristy has excellent people skills. She can communicate with anyone and make them feel comfortable and welcome. Her presentation of a project is very impressive. She knows her stuff. She can manage a project and be very detailed, yet easy for the lay person to understand.

I highly recommend Cristy Joy to fill you vacant position.

Sincerely,



Mark S. Joy,
President and CEO



TABLE ROCK
402 Houston
P. O. Box D
Table Rock, NE 68447
(402) 839-2035
Fax (402) 839-2095

DUBOIS
301 Miner Street
P. O. Box 145
DuBois, NE 68345
(402) 859-4595
Fax (402) 859-4595

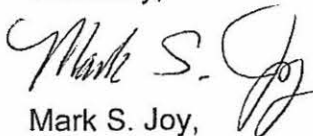
PAWNEE CITY
650 G Street
P. O. Box 193
Pawnee City, NE 68420
(402) 852-2075
Fax (402) 852-2508

HUMBOLDT
301 Nemaha
P. O. Box 335
Humboldt, NE 68376
(402) 862-2434
Fax (402) 862-2457

ROCA
4125 Main Street
P. O. Box 10
Roca, NE 68430
(402) 484-5444
Fax (402) 484-5680

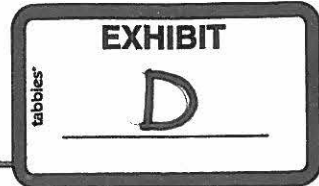

Minette M. Genuchi

Subject: FW: Indigent Defense Average Cost Per Case

From: Joseph D. Nigro
Sent: Wednesday, July 12, 2017 9:06 PM
To: Todd J. Wiltgen; Becky G. Bruckner
Cc: Jared Gavin; Dennis M. Meyer; Kerry P. Eagan; Jennifer J. Brinkman; Bill P. Avery; Roma B. Amundson; Deb E. Schorr; Ann E. Ames; Monica L. Ross
Subject: RE: Indigent Defense Average Cost Per Case

These are our totals for conflicts and overloads from Monica Ross, our office manager. When Monica says "she," she is referring to Becky Bruckner:

I am assuming she used fiscal years for her numbers so I get:

FY15-16

Felony conflicts 765 - - Misd conflicts 541 for a total of 1306 conflicts
Felony overload 297 - - Misd overload 30 for a total of 327 overloads
Grand total of 1633 (about 100 short of her number)

FY16-17

Felony conflicts 688 - - Misd conflicts 540 for a total of 1228 conflicts
Felony overload 574 - - Misd overload 211 for a total of 785 overloads.
Grand total of 2013 (31 cases different from her number)

I asked Monica to calculate the percentage of conflicts of total cases opened a few weeks before the fiscal year ended. In FY15/16, it was 36.2% of felonies opened, 21.3% of County Attorney filed misdemeanors, and 18.6% of City Attorney filed misdemeanors. In FY 16/17, it was 40.8% of felonies opened, 27.7% of County Attorney filed misdemeanors, and 23.8% of City Attorney filed misdemeanors. We filed overload motions in 574 felonies in FY 16/17. Adding two attorneys will allow us to take approximately 240 more felonies in a year. This may mean the number of conflicts caused by taking more cases may increase, but the County will save money by letting us add two attorneys. Even after adding these attorneys, we will still have to file a large number of overload motions unless felony filings decrease. We cannot control the number of felonies filed, but we can save the taxpayers money with additional attorneys. An attorney in our office costs the taxpayers less than assigned counsel handling the same number of cases, because assigned counsel bill by the hour. I propose adding two attorneys to our staff to save the taxpayers money for legal costs.

Thanks,

Joe Nigro
Lancaster County Public Defender

From: Todd J. Wiltgen
Sent: Wednesday, July 12, 2017 11:22 AM
To: Becky G. Bruckner <bbruckner@lancaster.ne.gov>

Cc: Jared Gavin <JGavin@lancaster.ne.gov>; Joseph D. Nigro <jnigro@lancaster.ne.gov>; Dennis M. Meyer <DMMeyer@lancaster.ne.gov>; Kerry P. Eagan <KEagan@lancaster.ne.gov>; Jennifer J. Brinkman <JBrinkman@lancaster.ne.gov>; Bill P. Avery <BAvery@lancaster.ne.gov>; Roma B. Amundson <RAmundson@lancaster.ne.gov>; Deb E. Schorr <DSchorr@lancaster.ne.gov>; Ann E. Ames <AAmes@lancaster.ne.gov>
Subject: Re: Indigent Defense Average Cost Per Case

Joe,

Will you be able to provide the requested information? Please let me know. Thank you.

Todd

Sent from my iPhone

On Jul 11, 2017, at 3:21 PM, Becky G. Bruckner <bbruckner@lancaster.ne.gov> wrote:

I do not have a way to break down what type of cases or the reason why the PD could not represent the individual.

Criminal-felonies and misdemeanor

2015-16	1740 cases/\$282,235/\$162 per case
2016-17	2044 cases/\$444,101.03/ \$217 per case

GAL

2015-16	123 cases/\$37,522.52/\$305 per case
2016-17	184 cases/\$55,935.81/ \$303 per case

Becky G. Bruckner
Judicial Administrator
Lancaster County Court
575 South 10th Street
Lincoln, NE 68508
402/441-7295

From: Todd J. Wiltgen
Sent: Tuesday, July 11, 2017 12:10 PM
To: Jared Gavin; Becky G. Bruckner
Cc: Joseph D. Nigro; Dennis M. Meyer; Kerry P. Eagan; Jennifer J. Brinkman; Bill P. Avery; Roma B. Amundson; Deb E. Schorr; Ann E. Ames
Subject: Indigent Defense Average Cost Per Case

Becky and Jared,

In preparation for the budget discussion during Thursday's staff meeting, I reviewed the Lancaster County Indigent Defense Advisory Committee report from 2012 (<http://lancaster.ne.gov/pdefen/pdf/idac.pdf>).

I asked Dennis to update Table 1. I believe it would also be beneficial to update Table 2 minus the Juvenile Court numbers. Would you please provide the average costs per case for the last two years for your respective courts? Could you break out the numbers for conflict and work load cases. Attached is the format I would like to use.

Please let me know if you have any questions. Thank you in advance for your assistance.

Todd Wiltgen
Chair, Lancaster County Board of Commissioners
555 South 10th Street, Suite 110
Lincoln, NE 68508
Office - (402) 441-7447
Fax - (402) 441-6301
Home - (402) 304-7685
twiltgen@lancaster.ne.gov

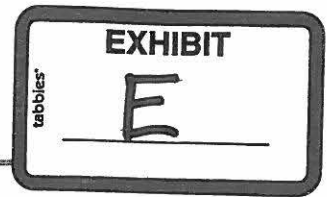

Minette M. Genuchi

Subject: FW: Indigent Defense Average Cost Per Case

From: Jared Gavin
Sent: Wednesday, July 12, 2017 3:58 PM
To: Todd J. Wiltgen
Cc: Joseph D. Nigro; Dennis M. Meyer; Kerry P. Eagan; Jennifer J. Brinkman; Bill P. Avery; Roma B. Amundson; Deb E. Schorr; Ann E. Ames; Becky G. Bruckner
Subject: RE: Indigent Defense Average Cost Per Case

I have been and will continue to work on the breakdown of conflict versus overload cases. It is, however, pretty labor intensive so I'm not sure if I will have this data for the meeting tomorrow.

I did want to provide similar data to County Court numbers:

Criminal Cases

2015-2016 464 cases / \$482,657.69 / \$1,040.21 per case
2016-2017 694 cases / \$739,918.04 / \$1,066.16 per case

Civil Cases

2015-2016 74 cases / \$26,029.55 / \$351.75 per case
2016-2017 103 cases / \$45,717.66 / \$443.86 per case

Thank you.

Jared D. Gavin

District Court Administrator
Lancaster County District Court
575 S 10TH ST, 3RD FLOOR
LINCOLN NE 68508
jgavin@lancaster.ne.gov | PH: 402.441.9187 | FAX: 402.441.3833

From: Becky G. Bruckner
Sent: Tuesday, July 11, 2017 3:21 PM
To: Todd J. Wiltgen <TWiltgen@lancaster.ne.gov>; Jared Gavin <JGavin@lancaster.ne.gov>
Cc: Joseph D. Nigro <jnigro@lancaster.ne.gov>; Dennis M. Meyer <DMMeyer@lancaster.ne.gov>; Kerry P. Eagan <KEagan@lancaster.ne.gov>; Jennifer J. Brinkman <JBrinkman@lancaster.ne.gov>; Bill P. Avery <BAvery@lancaster.ne.gov>; Roma B. Amundson <RAmundson@lancaster.ne.gov>; Deb E. Schorr <DSchorr@lancaster.ne.gov>; Ann E. Ames <AAmes@lancaster.ne.gov>
Subject: RE: Indigent Defense Average Cost Per Case

I do not have a way to break down what type of cases or the reason why the PD could not represent the individual.

Criminal-felonies and misdemeanor

2015-16 1740 cases/\$282,235/\$162 per case
2016-17 2044 cases/\$444,101.03/ \$217 per case

GAL

2015-16 123 cases/\$37,522.52/\$305 per case

2016-17 184 cases/\$55,935.81/ \$303 per case

Becky G. Bruckner
Judicial Administrator
Lancaster County Court
575 South 10th Street
Lincoln, NE 68508
402/441-7295

From: Todd J. Wiltgen
Sent: Tuesday, July 11, 2017 12:10 PM
To: Jared Gavin; Becky G. Bruckner
Cc: Joseph D. Nigro; Dennis M. Meyer; Kerry P. Eagan; Jennifer J. Brinkman; Bill P. Avery; Roma B. Amundson; Deb E. Schorr; Ann E. Ames
Subject: Indigent Defense Average Cost Per Case

Becky and Jared,

In preparation for the budget discussion during Thursday's staff meeting, I reviewed the Lancaster County Indigent Defense Advisory Committee report from 2012 (<http://lancaster.ne.gov/pdefen/pdf/idac.pdf>).

I asked Dennis to update Table 1. I believe it would also be beneficial to update Table 2 minus the Juvenile Court numbers. Would you please provide the average costs per case for the last two years for your respective courts? Could you break out the numbers for conflict and work load cases. Attached is the format I would like to use.

Please let me know if you have any questions. Thank you in advance for your assistance.

Todd Wiltgen
Chair, Lancaster County Board of Commissioners
555 South 10th Street, Suite 110
Lincoln, NE 68508
Office - (402) 441-7447
Fax - (402) 441-6301
Home - (402) 304-7685
twiltgen@lancaster.ne.gov