

**STAFF MEETING MINUTES
LANCASTER COUNTY BOARD OF COMMISSIONERS
COUNTY-CITY BUILDING, ROOM 113
THURSDAY, DECEMBER 1, 2011
8:30 A.M.**

Commissioners Present: Deb Schorr, Chair
Bernie Heier, Vice Chair
Larry Hudkins
Jane Raybould
Brent Smoyer

Others Present: Kerry Eagan, Chief Administrative Officer
Gwen Thorpe, Deputy Chief Administrative Officer
Dan Nolte, County Clerk
Cori Beattie, Deputy County Clerk
Ann Taylor, County Clerk's Office

The Chair opened the meeting at 8:32 a.m.

AGENDA ITEM

1 APPROVAL OF THE MINUTES OF THE TUESDAY, NOVEMBER 17, 2011 STAFF MEETING

MOTION: Heier moved and Smoyer seconded approval of the minutes of the November 17, 2011 Staff Meeting. Smoyer, Hudkins, Heier, Raybould and Schorr voted aye. Motion carried 5-0.

2 ADDITIONS TO THE AGENDA

A. 2012 Board Meeting Schedule

MOTION: Smoyer moved and Heier seconded approval of the addition to the agenda. Raybould, Heier, Smoyer, Hudkins and Schorr voted aye. Motion carried 5-0.

3 BRYAN LGH MENTAL HEALTH SERVICES - Kim Russel, President and Chief Executive Officer (CEO), BryanLGH Health System; Shannon Engler, Director of Mental Health Services, BryanLGH Health System

Kim Russel, President and Chief Executive Officer (CEO), BryanLGH Health System, said Lincoln General Hospital was the first general hospital in the nation to offer inpatient psychiatric services. She said hospital board members made a commitment to the City to continue to provide psychiatric services when Lincoln General Hospital and Bryan Memorial Hospital were merged in 1997 to form BryanLGH Medical Center. Those services are provided on the former Lincoln General Hospital campus, which is now known as BryanLGH West. Russel said a significant financial investment was made to remodel that facility, including the mental health service areas.

Shannon Engler, Director of Mental Health Services, BryanLGH Health System, gave an overview of the mental health services offered at BryanLGH (Exhibit A):

- Inpatient Mental Health Services (Senior, Adult, Adolescent, and Child Units)
- Mental Health Observation
- Partial Hospitalization Services
- Psychiatrist Office
- Primary Care Physician
- Community Providers
- Mental Health Outpatient Services
- Prevention/Community Outreach

Engler noted BryanLGH has a dedicated Mental Health Emergency Department within the Emergency Department at BryanLGH West and approximately 6,000 patients are evaluated each year. He said more than 3,300 individuals were admitted to the inpatient units last year. Outpatient services provide close to 10,000 individual services. Specialized services include cognitive behavioral therapy for insomnia, bariatric surgery evaluations, psychological treatment for chronic pain, memory disorder evaluations, post-traumatic stress disorder screening and referral with trauma services and groups for men who are deemed domestically violent.

Russel said funding will become more challenging in the future because of the impact of health care reform, noting more profitable areas are currently subsidizing the hospital's mental health services operations.

Hudkins asked whether BryanLGH is still interested in acquiring the building that currently houses the Community Mental Health Center (CMHC) and is contiguous to the BryanLGH West campus. Russel said BryanLGH is always open to discussion.

Kerry Eagan, Chief Administrative Officer, noted the efforts of the CMHC Planning Committee and HMA (Health Management Associates of Chicago, Illinois), the consultant hired by the Community Health Endowment (CHE) to study a broad

integration of physical and mental health services and said he believes there will be collaboration opportunities. He said there may also be funding opportunities under the Health Care Innovation Grant (see Item 12D).

4 JAIL CONSTRUCTION UPDATE - John Sampson and Chuck Richter, Sampson Construction Company; Greg Newport, The Clark Enersen Partners; Mike Thurber, Corrections Director; Brad Johnson, Transition Coordinator

Chuck Richter, Sampson Construction Company, gave an update on construction of the new Lancaster County Adult Detention Facility (LCADF) (see Exhibit B for progress photographs). He said site paving, including sidewalks, has been completed. Most of the windows have been installed and masonry and block work is nearly complete. Paving of the intersection at the entrance to the facility is also nearing completion.

John Sampson, Sampson Construction Company, noted most of the subcontractors that provided labor and materials for the project are located within 50 miles of the facility. He also stressed that staff should assess the facility and finishes and relay any concerns.

Greg Newport, The Clark Enersen Partners, said they have advertised for the systems furniture for the project and plan to have the vendors give demonstrations in the design studio space in the Landmark One Building (1010 Lincoln Mall). He will notify the Board when those plans are finalized.

Raybould asked for an update on the situation involving the geothermal wells that will serve the facility. **NOTE:** The Nebraska Department of Health and Human Services (DHHS) determined that 145 of the 667 wells were drilled a half-inch too small to meet state specifications. Mike Thurber, Corrections Director, said approximately 50 of the wells have been re-drilled. He said the work is scheduled to be completed by the end of December.

Schorr inquired about transition activities. Brad Johnson, Transition Coordinator, said they are still working through scenarios.

5 PURCHASE OF REAL PROPERTY (EXECUTIVE SESSION) - Don Killeen, County Property Manager

MOTION: Smoyer moved and Hudkins seconded to enter Executive Session at 9:23 a.m. for the purpose of protecting the public interest with regards to the purchase real property.

The Chair restated the motion for the record.

ROLL CALL: Hudkins, Smoyer, Raybould, Heier and Schorr voted aye. Motion carried 5-0.

Smoyer exited the meeting.

MOTION: Raybould moved and Hudkins seconded to exit Executive Session at 10:00 a.m. Raybould, Heier, Hudkins and Schorr voted aye. Smoyer was absent from voting. Motion carried 4-0.

Smoyer returned to the meeting at 10:01 a.m.

6 COMMUNITY CORRECTIONS STAFFING - Kim Etherton, Community Corrections Director

Kim Etherton, Community Corrections Director, presented information regarding the number of participants in the House Arrest, Pretrial Release and Community Service Programs for the period of July 1, 2006 to November 15, 2011 (Exhibit C). She noted the number of participants in the Pretrial Release Program has doubled this year with the addition of a grant program that provides housing options for homeless, non-violent defendants who had been considered ineligible because of their homeless circumstance. Etherton noted she has asked to retain a Clerk II position that was added in 2008 and slated to be eliminated (see November 17, 2011 Staff Meeting minutes) as that person is responsible for enrolling individuals in the programs and pulling their files at the courthouse. She said there are also plans to add a Veterans Diversion Program which will increase the need for clerical support. The budget impact of retaining the position is estimated to be \$30,000 for the remainder of the year.

MOTION: Heier moved and Raybould seconded to retain the Clerk II position for another six months at the same salary. Raybould, Heier, Smoyer, Hudkins and Schorr voted aye. Motion carried 5-0.

7 A) FINANCIAL CONSULTANT CONTRACT; AND B) PROJECTS UNDER NEBRASKA REVISED STATUTE §23-120 - Dennis Meyer, Budget and Fiscal Officer

A) Financial Consultant Contract

Dennis Meyer, Budget and Fiscal Officer, said the contract with Ameritas Investment Corporation to have Scott Keene, Vice President and Managing Director, provide financial consulting services with respect to financing debt of Lancaster County will expire in January, 2012. He said there is no cost to the County unless bonds are issued. Meyer asked whether the Board would like to enter into another contract with

Ameritas or proceed with the request for proposal (RFP) process.

MOTION: Hudkins moved and Smoyer seconded to direct the County Attorney's Office to prepare a contract with Ameritas Investment Corporation for financial consulting services stipulating that: 1) The contract will cover a period of four (4) years, with an option to renew for an additional four (4) year term; and 2) Scott Keene will be the individual who will primarily perform the services. Hudkins, Smoyer, Heier, Raybould and Schorr voted aye. Motion carried 5-0.

B) Projects Under Nebraska Revised Statute §23-120

Meyer said he will schedule a resolution on the December 6, 2011 County Board of Commissioners Meeting agenda to impose a levy for the following projects pursuant to Nebraska Revised Statute §23-120: 1) The 2004 bond issue for various County projects; 2) 50% of the debt service for the Lincoln-Lancaster County Health Department addition; and 3) The Building Fund levy. He said the County is authorized to make an annual levy not to exceed 5.2 cents for the costs and indebtedness for such projects but will only be levying .6493 cents.

8 VETERAN SERVICES CONTRACT FOR SHARED SOFTWARE PROGRAM - Gary Chalupa, Veterans Service Officer/General Assistance Director; Brittany Behrens, Deputy County Attorney

Gary Chalupa, Veterans Service Officer/General Assistance Director, asked the Board to sign a memorandum of understanding (MOU) with the State of Nebraska Department of Veterans Affairs and Lancaster County that will allow his department use of a web-based system to track and assist veterans and eligible dependents in accessing benefits. He said this system is a vast improvement over the software system the department currently uses and will be the first step in moving towards a paperless system. Chalupa said the cost will be \$900 a year, compared to \$700 a year for the current software program.

Brittany Behrens, Deputy County Attorney, said the State asked that the indemnification and e-verification provisions be removed. The reason for removing the e-verification provision is because it is already statutorily required of both entities. She noted the County Attorney's Office is involved in discussions with the Nebraska Attorney General's Office regarding the application of the County's standard indemnification provision to State entities and departments.

Schorr asked whether moving to this system will reduce the department's Information Services (IS) costs. Chalupa said no, as their server usage costs are minimal. He said there should be savings in other areas such as postage and office supplies.

NOTE: The MOU will be scheduled on the December 6, 2011 County Board of Commissioners Meeting agenda for action.

EMERGENCY ITEMS AND OTHER BUSINESS

Schorr said she and three other commissioners attended the November 30th Bennet Planning Commission meeting. She said proposed changes to the intersection of Highways 2 and 43, commonly known as the "Bennet corner", were discussed but the commissioners departed before the Bennet Planning Commission reached a conclusion. Schorr said the County Board has asked to be notified if the Bennet Planning Commission makes a recommendation regarding this issue to the Bennet Village Board.

Schorr, Heier and Raybould indicated plans to attend the Bennet Village Board Meeting on December 12th.

9 COUNTY ZONING REGULATIONS (20 ACRE RULE) - Marvin Krout, Planning Director; Sara Hartzell, Planner

Sara Hartzell, Planner, presented diagrams of current options for subdividing an 80-acre parcel, i.e., 20-acre minimum lot size requirement or "two 3's per 40 (a 40-acre parcel may be subdivided creating two buildable lots of not less than 3 acres and one unbuildable outlot of not less than 30 acres) (Exhibit D). **NOTE:** The first option requires a survey and is registered with the Register of Deeds. The second is approved through a final plat. Hudkins pointed out that the 550 feet of frontage shown in the diagrams will not work if the parcel is long and narrow. Marvin Krout, Planning Director, said it is his understanding that the Building and Safety Department has been asked to not enforce the 550 feet of frontage requirement in the County's Zoning Regulations when building permits are submitted for parcels over 20 acres. Hartzell said she was told Building and Safety will grant a building permit on an interior parcel that has no frontage provided it has an access easement. It was noted the County Engineer must approve the driveway permits. Hudkins felt the Zoning Regulations should be amended to clarify that 500 feet of frontage is a matter of practice, rather than a requirement. Krout suggested the County Engineer could be given authority to waive the requirement.

Hartzell said an alternative would be to allow a 3 to 5-acre parcel for every 20 acres with the remainder an unbuildable outlot (see Exhibit D) and said it could have a shared driveway or a public access easement to the rest of the land to provide for a future roadway. Hudkins said he favors asking for 66 feet, rather than 60 feet, of right-of-way. Hartzell said the lots could also be structured to coordinate with future

development of an adjacent lot (shared access) (see Exhibit D). She said this information was shared with the Planning Commission and said they were supportive.

Hartzell also discussed options for providing additional bonuses for Community Unit Plans (CUP's) (see Exhibit D). Krout said the Planning Department is not opposed to "bumping" the 20% bonus to 25%. Schorr suggested that the bonuses be retroactive for individuals who did a CUP and still have 50% of their lots available for sale. Krout said language could be drafted to allow those CUP's to be amended administratively. Schorr also suggested that the changes be phased in over an 18 to 24 month period to prevent a surplus of new lots from flooding the market and depressing land prices. Smoyer felt economic conditions will keep that from happening.

Raybould asked Don Thomas, County Engineer, who was in attendance, whether he is comfortable with the proposed increase in density. Thomas said he is.

Krout said the Planning Department will work with the County Attorney's Office to draft language for the Board's consideration.

10 ACTION ITEMS

- A. Authorize Board Chair to Sign Letter Accepting Resignation of Travis Parker, Community Mental Health Center (CMHC) Deputy Director

MOTION: Heier moved and Smoyer seconded approval. Raybould, Heier, Smoyer, Hudkins and Schorr voted aye. Motion carried 5-0.

ADDITIONS TO THE AGENDA

- A. 2012 Board Meeting Schedule

A list of dates when Commissioner Raybould has a scheduling conflict for the Tuesday morning County Board of Commissioners meetings was disseminated (Exhibit E). There was general consensus to tentatively reschedule meetings from 9:30 a.m. to 5:00 p.m. on the following dates:

- February 7th
- May 15th
- September 18th

The Board will also hold an evening meeting in November to coordinate with the public hearing on the One and Six Year Road and Bridge Improvement Program (date to be determined). Don Thomas, County Engineer, said he would prefer that the public hearing be scheduled for 7:00 p.m. to better accommodate the public.

11 CONSENT ITEMS

There were no consent items.

12 ADMINISTRATIVE OFFICER REPORT

A. Management Team Agenda (December 8, 2011)

The meeting was canceled. A presentation by representatives of the Lincoln Public Schools (LPS) on disaster recovery will be rescheduled.

B. Mid-Year Budget Retreat Location

Minette Genuchi, Administrative Assistant, County Board, appeared and suggested the Rainforest Room at the Lincoln Children's Zoo, 1222 South 27th Street, as the location for the retreat which is scheduled for February 9th.

C. Vending Machine Request for Proposal (RFP) Update

Eagan said he is not aware of any new developments.

D. Health Care Innovation Grant

Board consensus was to indicate that Lancaster County is interested in being a participant in the grant (see agenda packet for information).

E. County Extension Board Appointments (Clancy Dempsey & Pablo Cervantes)

The Board scheduled the item on the December 6, 2011 County Board of Commissioners Meeting agenda.

F. Telephone Testimony at County Board Meeting

Eagan said he has received a request to provide telephone testimony on a homestead exemption appeal from a woman who lives out-of-state. The property in question was owned by her mother, who is deceased.

Scott Gaines, Chief Administrative Deputy Assessor/Register of Deeds, appeared and said there is no leeway in state statutes for the Board to grant the appeal.

Board consensus was to deny the request and indicate she may submit written testimony or contact commissioners individually.

G. Community Mental Health Center (CMHC) Management Update

Schorr noted Travis Parker, CMHC Deputy Director, will be leaving at the end of the year (see Item 10A).

Eagan said Dean Settle, CMHC Director, is still planning to retire at the end of December but has agreed to return for six months, on a contract basis, to assist with CMHC's transition. It was noted there will be a four day gap between the time that Parker will leave and Settle will return and on-call coverage has been arranged.

13 PENDING

There were no pending items.

14 DISCUSSION OF BOARD MEMBER MEETINGS

A. Visitors Promotion Committee (VPC) - Smoyer

Smoyer said he was unable to attend the meeting. Eagan said discussion focused on Visitors Improvement Fund grant requests from the Lincoln Parks and Recreation Department for improvement of Boosalis Trail and Speedway Motors for expansion of the Smith Collection Museum of American Speed.

B. Community Mental Health Center (CMHC) Advisory Committee - Raybould

Raybould said they discussed legislative issues, staffing, the wait list for services and the work of the CMHC Planning Committee which includes a "listening tour", focus groups and a town hall meeting.

Schorr noted four of the commissioners attended the town hall meeting that was held at Auld Recreation Center on November 21st. The purpose of the meeting was to solicit public input on how to best provide mental health services in the community.

C. Lincoln Independent Business Association (LIBA) Monthly Meeting - Hudkins, Heier

Hudkins and Heier reported discussion of upcoming elections, the County's "20-acre rule" and property valuations.

D. Lancaster County Correctional Facility Joint Public Agency (JPA) -
Schorr, Heier

Heier said they paid claims including a principal and interest payment on the bonds in the amount of \$3,673,440.

15 EMERGENCY ITEMS AND OTHER BUSINESS

Item was moved forward on the agenda.

16 ADJOURNMENT

MOTION: Smoyer moved and Raybould seconded to adjourn the meeting at 11:37 a.m. Hudkins, Smoyer, Schorr, Heier and Raybould voted aye. Motion carried 5-0.

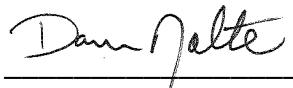

Dan Nolte
Lancaster County Clerk



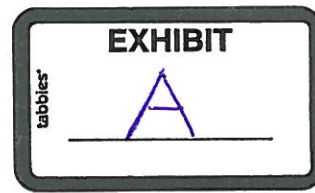

11/30/2011

Mental Health Services

November 2011

Overview



Brief History

- 1939 Lincoln General Hospital becomes 1st general hospital in nation to provide adult psychiatric inpatient services.
- 1965 Bryan Memorial Hospital begins providing adult inpatient mental health services.
- 1985 Youth Behavioral Medicine Service unit opens.
- January 1990 Activity Center building is built (now called Counseling Center).
- October 1990 Affective Disorders Unit opens.
- Winter 1992 Child and Adolescent Psychiatric Services becomes two separate units.



Brief History cont.

- January 1993 Mental Health Triage begins in the Emergency Department.
- April 1994 Adult Partial Hospitalization program begins.
- Summer 1994 Men's Domestic Abuse Group begins
- November 1997 Merger between Bryan Memorial Hospital and Lincoln General Hospital is official.
- June 2003 Senior Mental Health unit opens.
- May 2004 Mental Health Services moves to new facility at BryanLGH West
- May 2006 BryanLGH Heartland Psychiatry hospitalist program begins.



Brief History cont.

- February 2008 Cognitive Behavioral Therapy for Insomnia (CBT-I) Treatment at the Counseling Center begins
- July 2009 Local Outreach To Suicide Survivors (LOSS) Team begins.
- September 2009 Nebraska State Suicide Prevention Coalition co-chair helped state of Nebraska secure and implement 3 year, \$1.5 million dollar SAMHSA grant.
- June 2011 Co-leader in the development and implementation of the Electronic Behavioral Health Information Network (eBHIN).
- September 2011 Peer Specialist Program begins in our Mental Health Emergency Department.

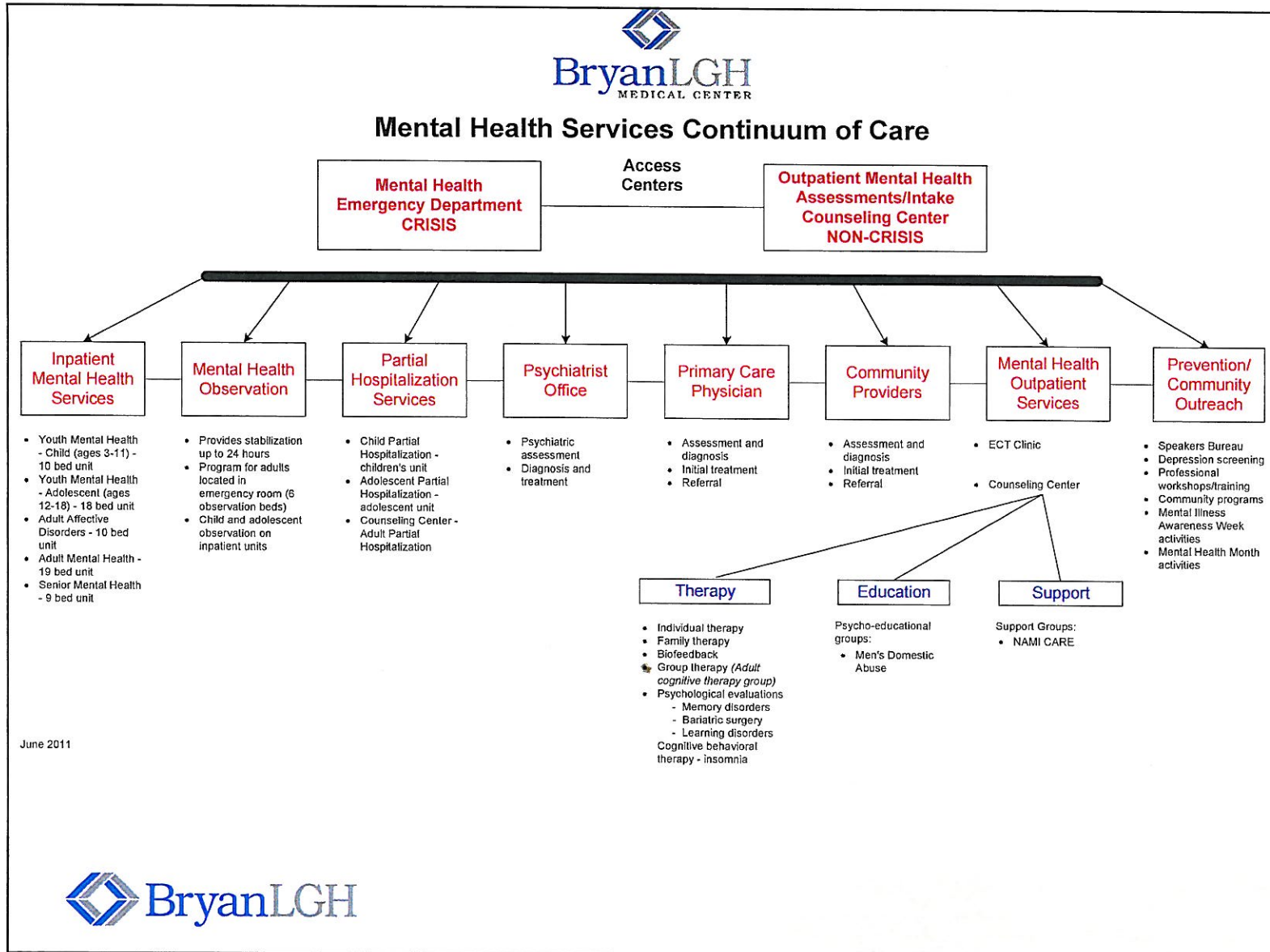

Mental Health Emergency Department



Mental Health Emergency Service A Department within a Department

- Dedicated functional area of the West Emergency Department..
- The only Mental Health Emergency Department in Nebraska. One of relatively few in the nation.
- Evaluates around 6,000 patient a year.
- Incorporate Peer Specialists into the treatment team to support and advocate for psychiatric patients. State of the art practice.
 - Peer Specialists are:
 - Individuals with a mental health diagnosis
 - Trained by the local Mental Health Association and BryanLGH's Mental Health Service
 - Providing an effective connection between professional care givers and psychiatric patients during the crisis of an emergency room visit

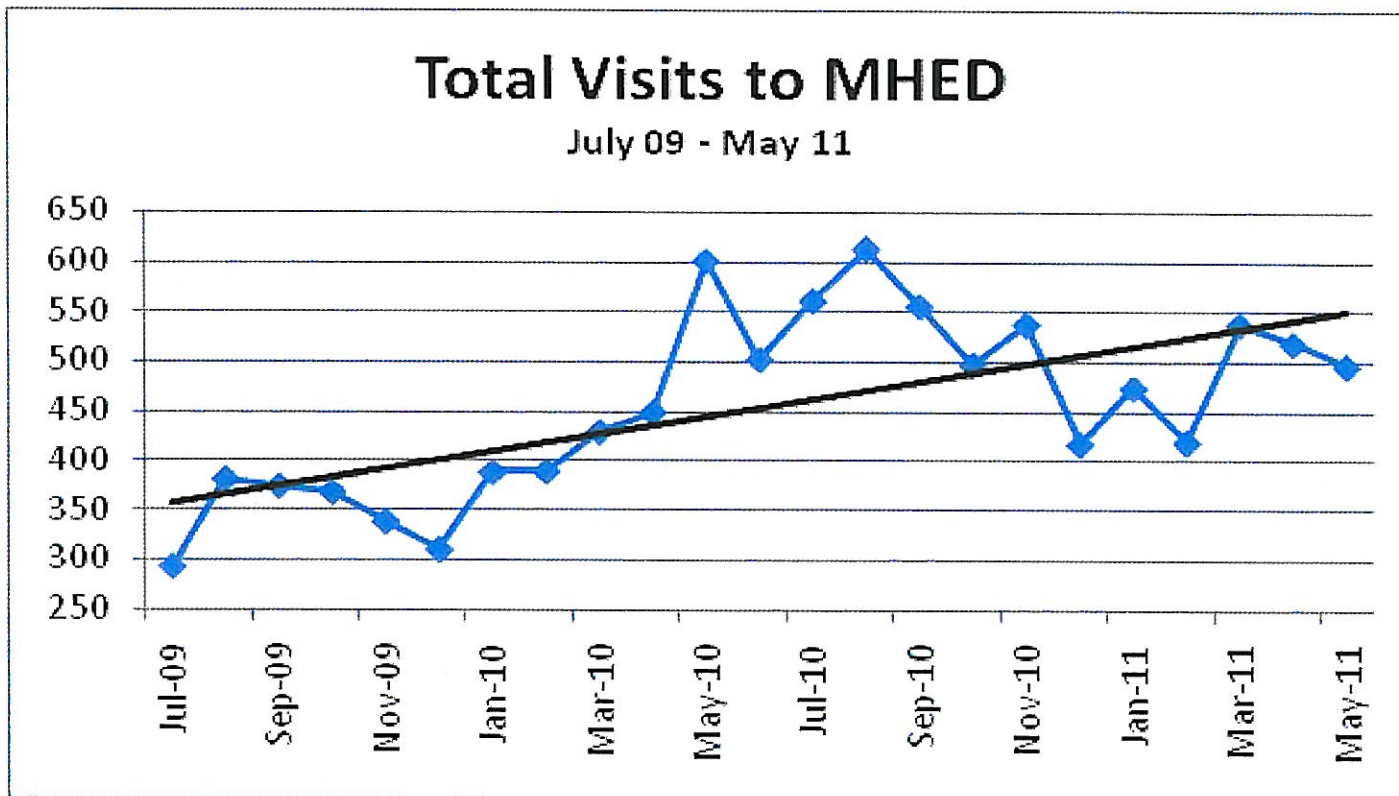

- We evaluate around 6,000 patients a year in the Mental Health ED.



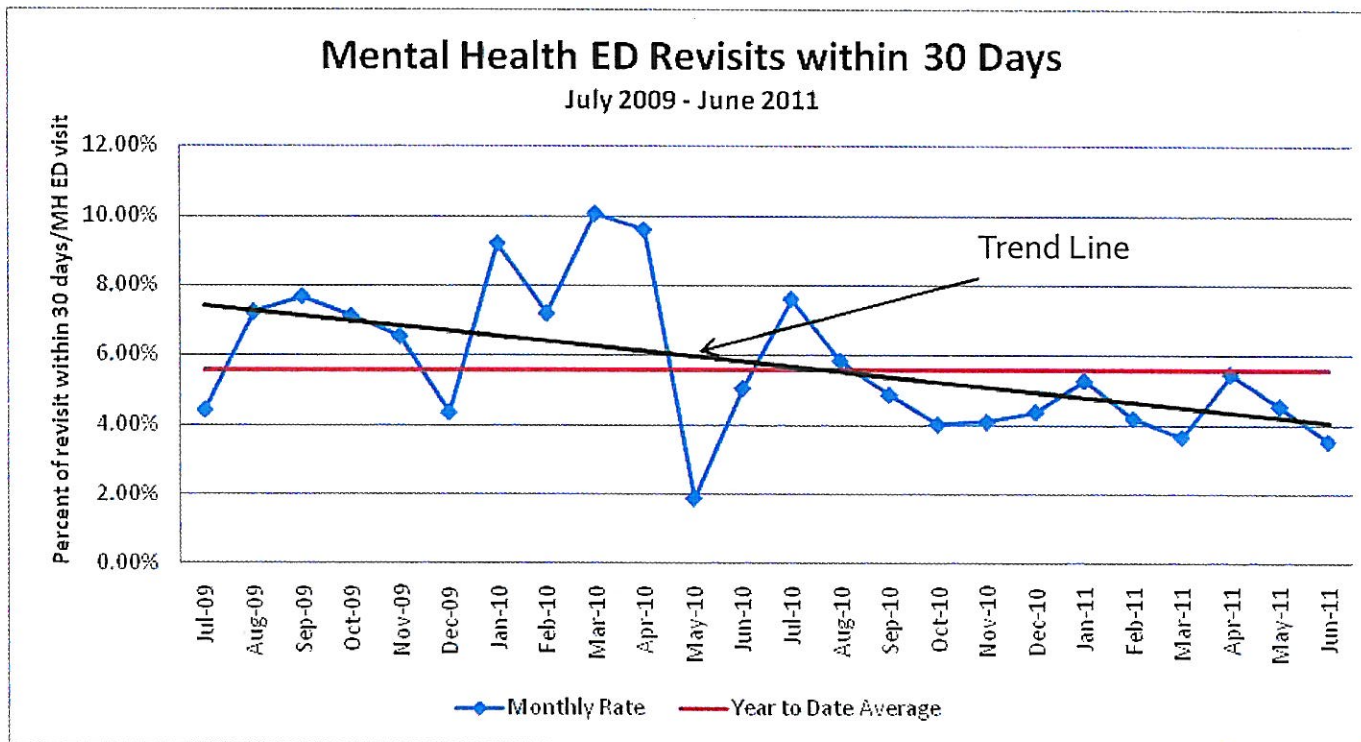

- MHS launched a large scale prevention of avoidable readmissions program in June 2010. It has been successful for the inpatient units and the MHED through partnering on the project.
- ED Connections assists with case management services for many patients.



Youth Psychiatric Inpatient Services

Adolescent Unit

850 patients last yr.

Ages 13-18

18 Bed unit

4 semi private rooms

10 private rooms

Child Unit

310 patients last yr.

Ages 3-12

10 Bed unit

All private rooms

Only dedicated child unit in entire state.

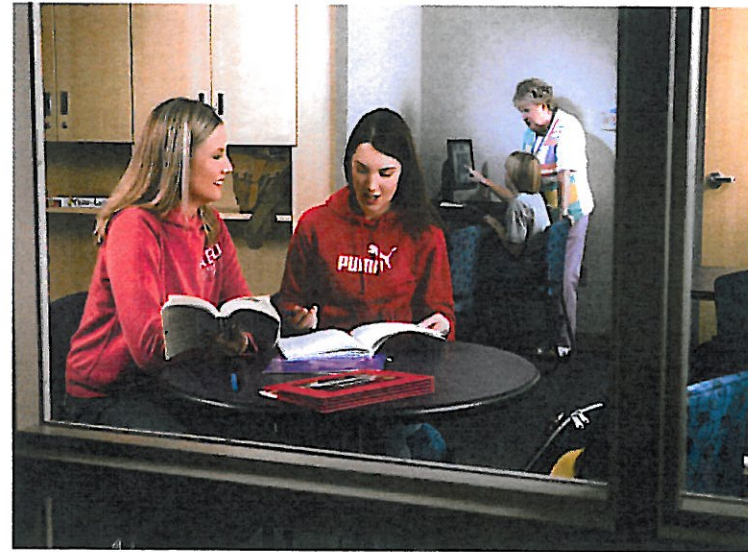

Patient Satisfaction Data – Youth

September 14, 2011

- Score 78.12% (90th percentile) for the question
 - “I would recommend BryanLGH Medical Center without hesitation to others.”



Adult Psychiatry

Adult Unit

1,100 patients last yr.

Ages 19 and older

19 Bed unit

6 semi private rooms

7 private rooms

Locked Unit

Affective Disorders Unit

700 patients last yr.

Ages 19 and older

10 Bed unit

8 private rooms

One semi-private room

Focus on disorders of mood, e.g.. Depression



*Patient Satisfaction Data – Adult
August 1- September 19th, 2011*

- Score 88.46% (97th percentile) for the question
 - “I would recommend BryanLGH Medical Center without hesitation to others.”



Senior Mental Health Services

Senior Unit

Ages 55 and older
230 patients last yr.
10 Bed unit
 6 private rooms
 2 semi-private rooms
Provide medical and
psychiatric care



Patient Satisfaction Data – Senior September 30, 2011

- Score 81.03% (94th percentile) for the question
 - “I would recommend BryanLGH Medical Center without hesitation to others.”



BryanLGH Counseling Center



Providing a full array of outpatient mental health services. Over 9,800 individual services provided last year.



Specialized Services

- Cognitive Behavioral Therapy for Insomnia
 - Only provider in region offering this service. Staff specially trained .
- Bariatric Surgery Evaluations
- Psychological Treatment for Chronic Pain
- Memory Disorder Evaluations
 - Evaluations conducted as part of comprehensive screening in the Memory Disorders program.
- Post Traumatic Stress Disorder Screening and Referral with Trauma Services
 - Screening tool implemented for all trauma patients.
- Groups for Men who are Domestically Violent
 - Largest provider in Lincoln
 - Serving approximately 100 men each week

*Patient Satisfaction Data
Counseling Center
June 1- September 19th, 2011*

- Score 92.86% (99th percentile) for the question
 - “I would recommend BryanLGH Counseling Center without hesitation to others.”
- Score 88.89% (91st percentile) for the question
 - “BryanLGH Counseling Center has very high quality doctors/therapists.”

“I’m am so totally satisfied with my care here; I can’t think of anything you could do better.”



MHS Statewide Outreach

- Primary leader in development of the Nebraska Statewide Suicide Prevention Coalition.
 - Coalition recognized by the State Department of Health and Human Services as the primary group responsible for coordinating Nebraska's Suicide Prevention Efforts.
 - Dave Miers, PhD, BryanLGH MHS Manager is an original founding member and Co-Chair of the Coalition.
- Co-developed the Lincoln/Lancaster Local Outreach to Suicide Survivors Program (LOSS Team).
 - Hosted First National LOSS Team Conference at BryanLGH in May of 2011.
- Helped State of Nebraska to secure a Substance Abuse and Mental Health Services Administration (SAMHSA) grant for suicide prevention – \$1.5 Million.
 - Grant has provided seed grants to local communities to implement suicide prevention programs.
 - Question, Persuade, Refer (QPR) training identified as Nebraska's Gatekeeper program and implemented statewide (Like CPR).
- Co-leader in the development of the Electronic Behavioral Health Information Network (eBHIN).
 - A behavioral health electronic record and patient information database shared across many member organizations.
 - Shannon Engler, Director of MHS is a founding and current board member.

Safety Net

- Our Mental Health Services provide around 6,000 emergency department evaluations for people experiencing mental health crisis each year. Twenty four hours a day, seven days a week.
- Our inpatient units provide the most acute level of mental health care. Last year we admitted more than 3,300 people.
- Our outpatient services provide close to 10,000 individual services helping clients remain active community members.

Mental Health Services

Fiscal Year 2011

- **Net Income Per Case**

Inpatient	\$(1,311)
Outpatient	\$(110)

Current and Future Concerns

- Affordable Care Act
- Accountable Care Organizations
- Bundled Care Organizations
- Health Insurance Exchanges
- Nebraska Full Risk Behavioral Health Managed Care Contract
- Disproportionate Share for Hospitals sunset
- Medicaid payment reductions and increased denials for treatment
- Lack of long-term care solutions for difficult to manage clients
- CMHC services and clients

**Lancaster County
Adult Detention Facility**



Lincoln, Nebraska

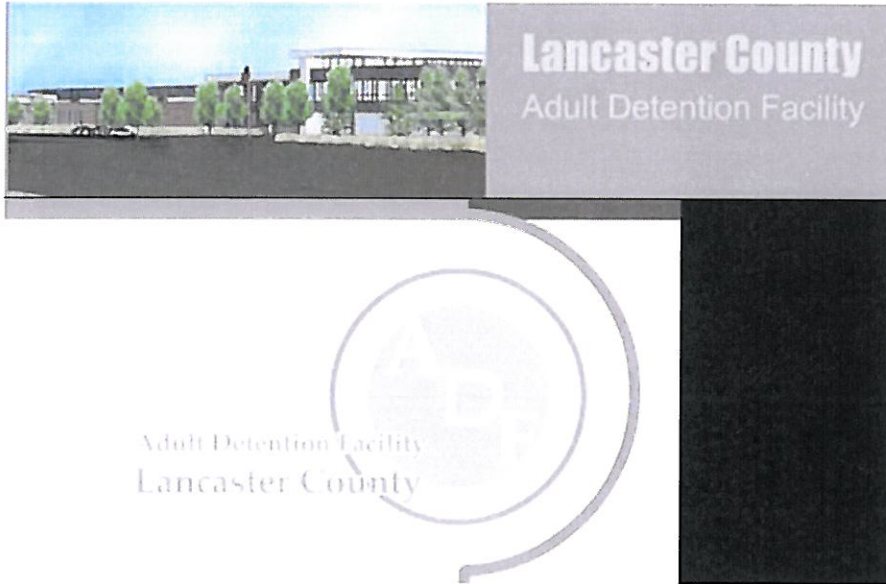

**Progress Photos
December 1, 2011**

November 4, 2011

Administration Offices



November 16, 2011 Acoustical Tile Ceilings in Pod 'F'



November 18, 2011 Concrete Patio at West End



November 23, 2011 Sidewalks at NW Corner of Building



November 30, 2011 Installing Fence South of Building



November 30, 2011

South Elevation



November 30, 2011

Concrete Floor Polishing at Pod 'G'



November 30, 2011

Pod 'F'



November 30, 2011

Pod 'E'



November 30, 2011

Booking Area



November 30, 2011

Laundry Room



November 30, 2011

Kitchen



Department of Community Corrections

July 01, 2006-November 15, 2011

Participants

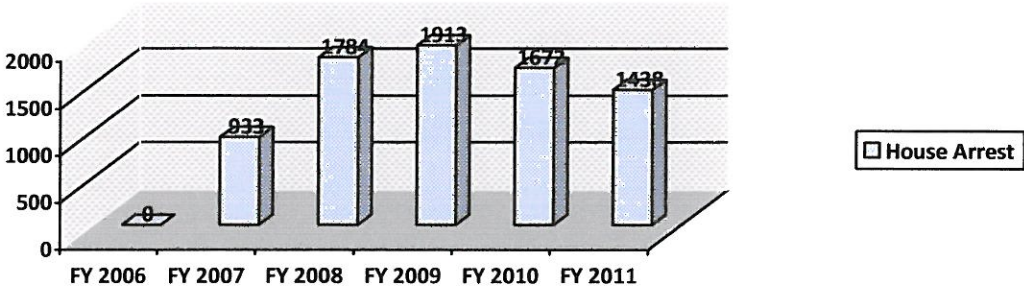

Participants

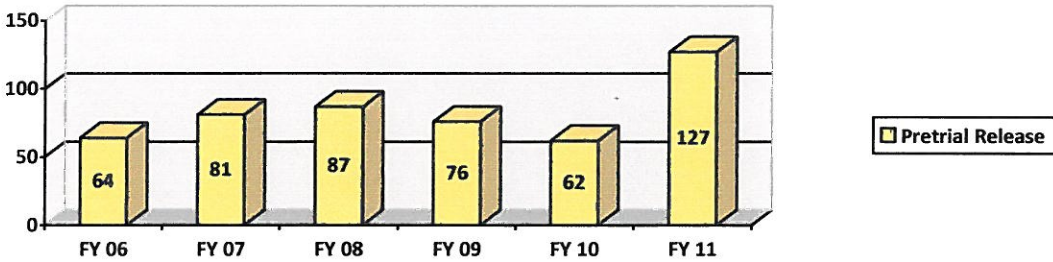

Cases Opened

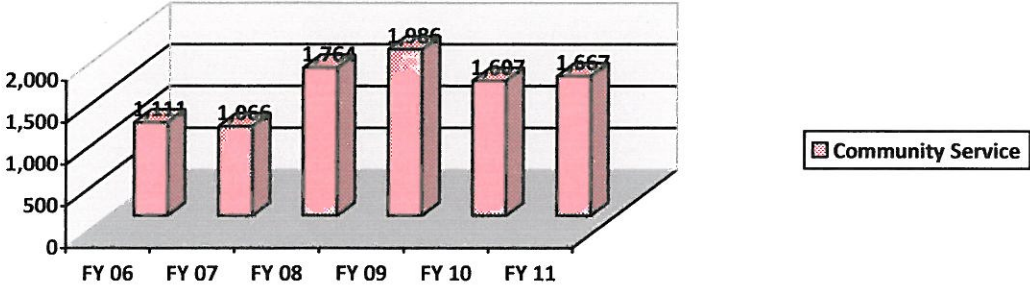

Totals # Participants

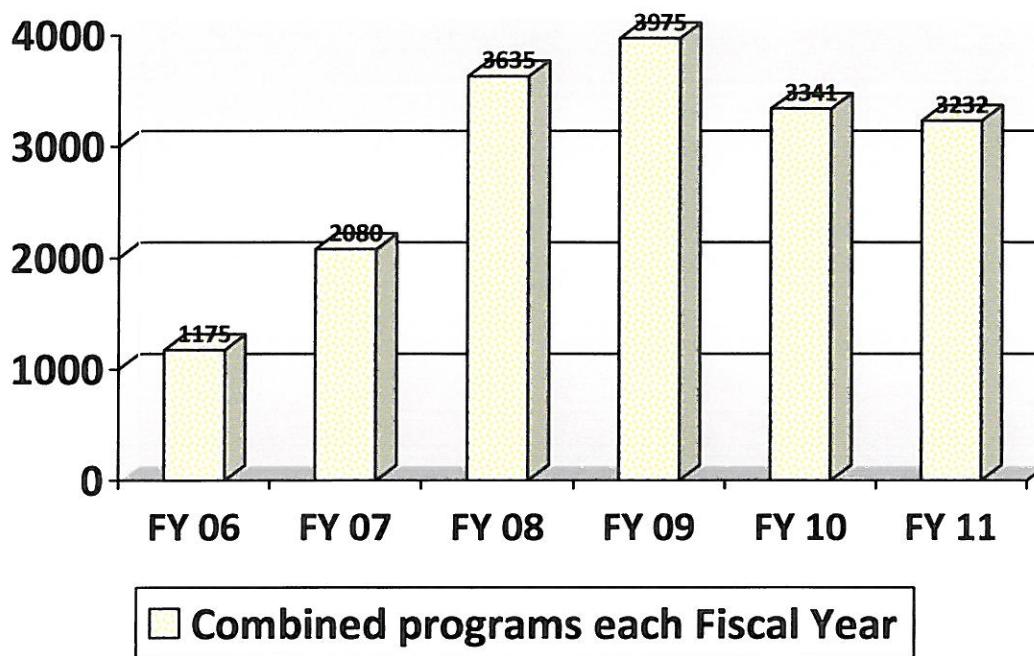

An additional Clerk position was added in July, 2008. This was deemed necessary for the efficient function of the department as the number of participants began to rise. The previous mode of operations, utilizing case managers to provide coverage at the court house for Community Service and the House Arrest programs, began to compromise the level of case management services available to the increasing number of participants.

While pretrial numbers are always significantly lower, compared to House Arrest, these participants require higher percentages of staff time and Pretrial numbers have doubled this year with the addition of the homeless (grant) program.

July 01, 2006-November 15, 2011

Trends

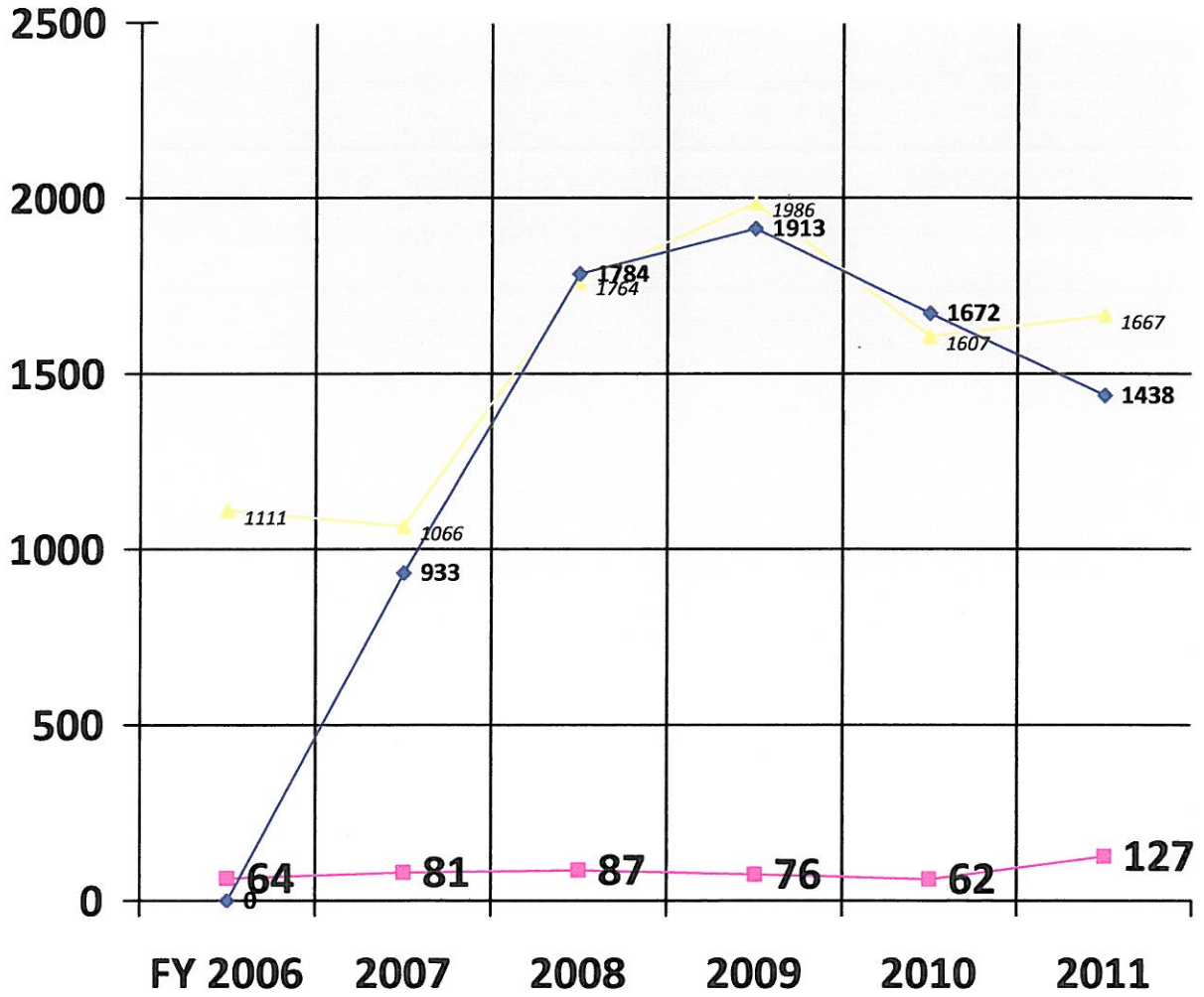

—■— Pretrial Release —▲— Community Service —◆— House Arrest

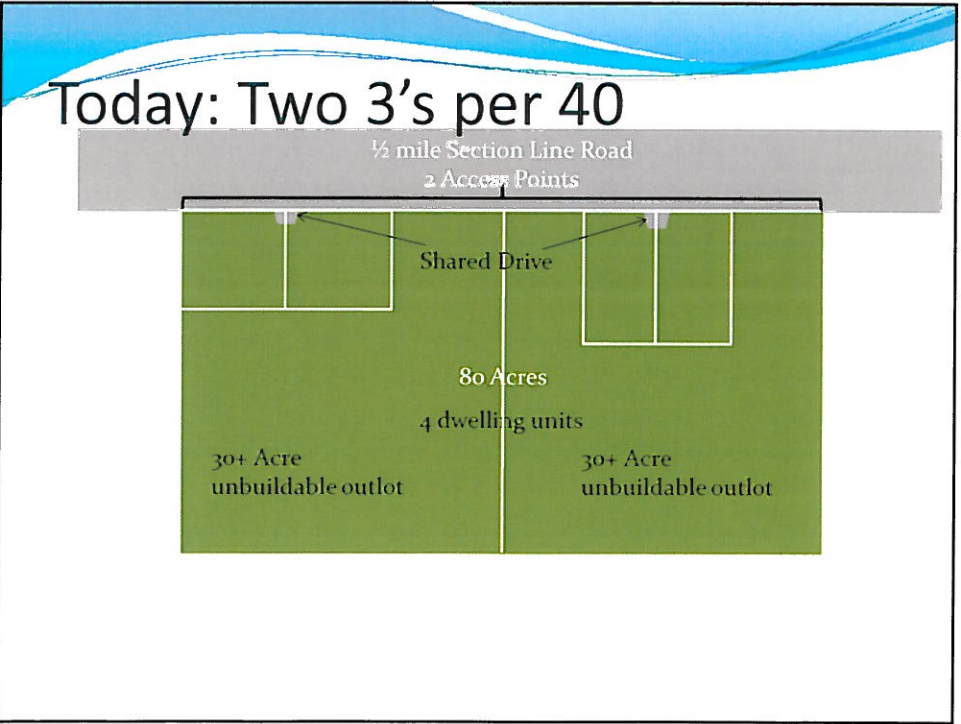

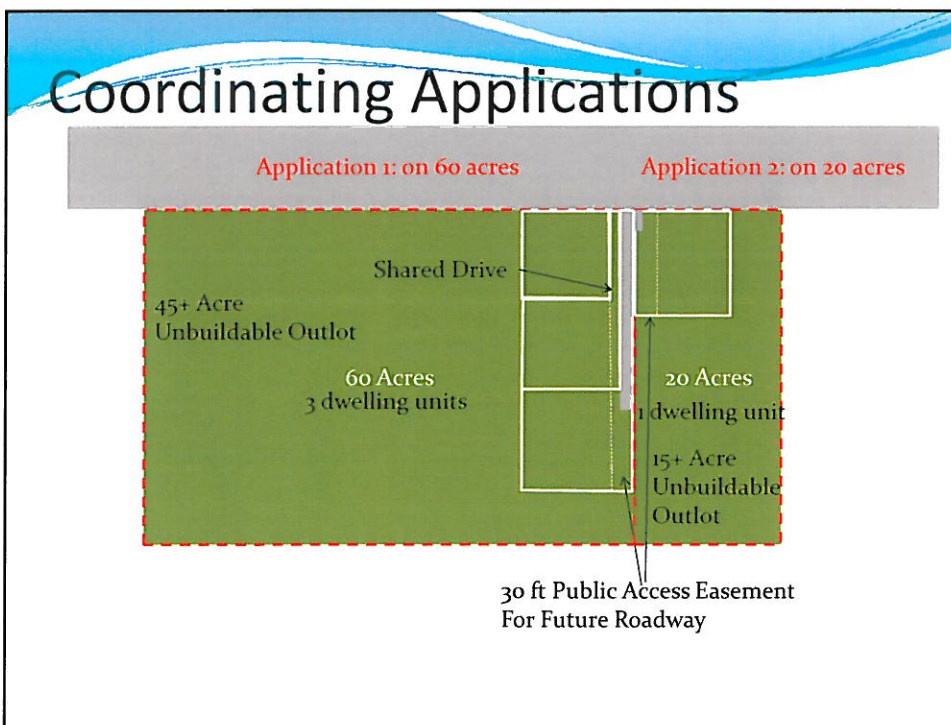
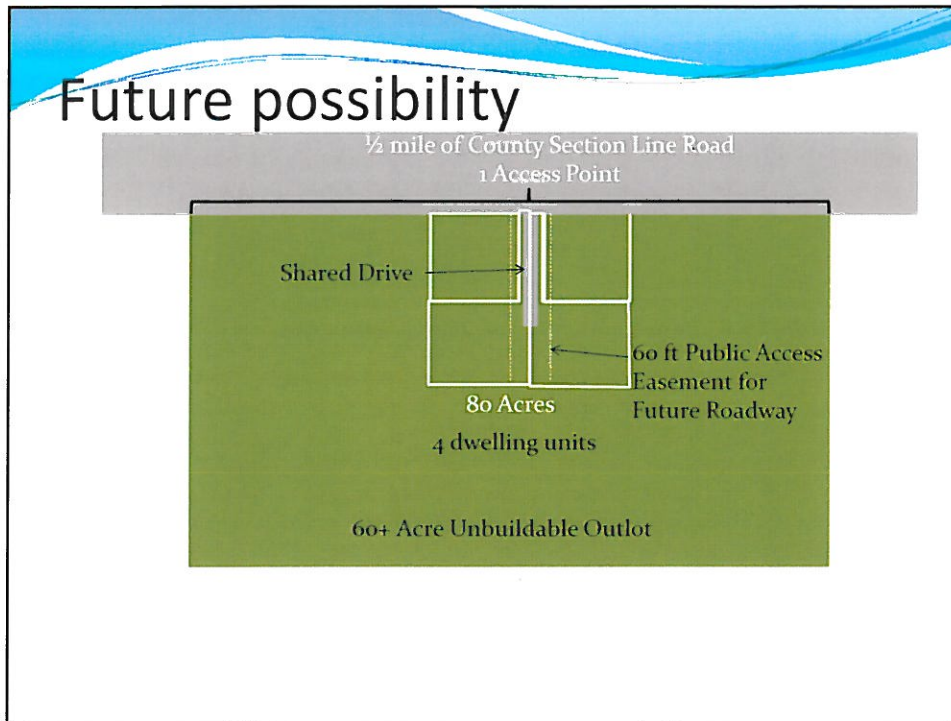

CUP Bonuses

Bonus	Resultant Lots per Area							
	Acres	80	100	160	200	240	320	640
None	4	5	8	10	12	16	32	
20% (current)	4	6	9	12	14	19	38	
25%	5	6	10	12	14	19	40	
30%	5	6	10	13	15	20	41	
40% (CB suggestion)	5	7	11	14	16	22	44	

Cost of Road in a CUP vs Need for Bonus:

- Estimated cost of Local County Road: \$15 per linear foot
- Avg lot frontage of about 300 feet for a 3 acre lot, usually lots on both sides of road: $300 \times \$15/2 = \$2,250/\text{lot}$ for road costs

•10 lots = \$22,500 vs. two extra lots to sell at \$60,000 each = \$120,000 from bonus lots

Tuesday Morning Sales Meetings 2012

Meetings will begin at 8am unless otherwise noted

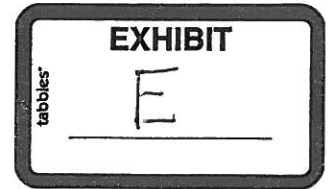

January 10 (start at 9am)

February 7 (start at 9am)

March 13 (start at 9am)

April 10

May 15

June 12

July 17

August 14

September 18

October 9

November 6

November 27