

# Engineering Technologies, Inc.

EXHIBIT A

Mechanical & Electrical Consulting Engineers

October 6, 2009

Mr. Byron Blum  
Engineering Specialist  
Public Works & Utilities Department  
531 Westgate Blvd., Suite 100  
Lincoln, NE 68528

Re: University of Nebraska  
19<sup>TH</sup> & Vine Parking Structure, Lincoln, NE  
ETI Project No. 2009-070

#### PRINCIPALS

THOMAS A. ERNST, PE.  
Electrical Engineer  
JON R. JACKSON, PE.  
Mechanical Engineer  
MARTIN D. KASL, PE.  
Mechanical Engineer  
GARY W. LOOP, PE.  
Electrical Engineer  
DANIEL W. SCHINSTOCK, PE.  
Mechanical Engineer  
DANIEL L. THOMPSON, PE.  
Mechanical Engineer

Dear Byron:

On behalf of the University of Nebraska, we are requesting permission from the City of Lincoln to directionally bore one (1) 4" HDPE conduit and one (1) 3" HDPE conduit below Vine Street, per the attached drawing. These conduits will be used for fiber optic and telephone services for the new parking structure that is currently under construction along 19<sup>th</sup> & Vine Streets, north of Sandoz Hall, in Lincoln, Nebraska.

Please respond at your earliest convenience. If there are any questions of if you need additional information, please do not hesitate to call.

Sincerely,

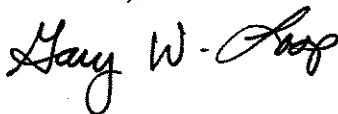

Gary W. Loop, PE

#### OFFICES

##### Lincoln

Sharp Building  
206 South 13<sup>th</sup> Street, Suite 800  
Lincoln, Nebraska 68508  
Tel ~ (402) 476-1273  
Fax ~ (402) 476-1274

##### Omaha

4559 South 133rd Street  
Omaha, Nebraska 68137  
Tel ~ (402) 330-2772  
Fax ~ (402) 330-2630

cc: Howard Parker – UNL  
Dennis Coudriet – BVH  
Dan Rosenthal - REGA

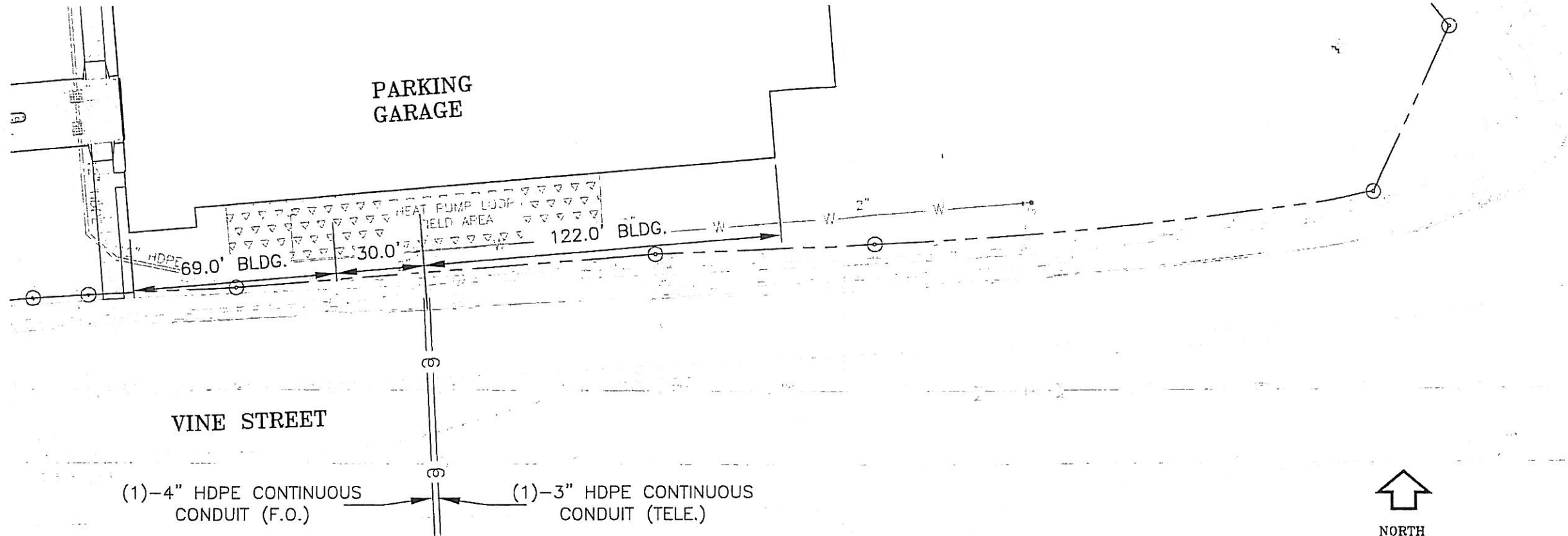

SITE PLAN

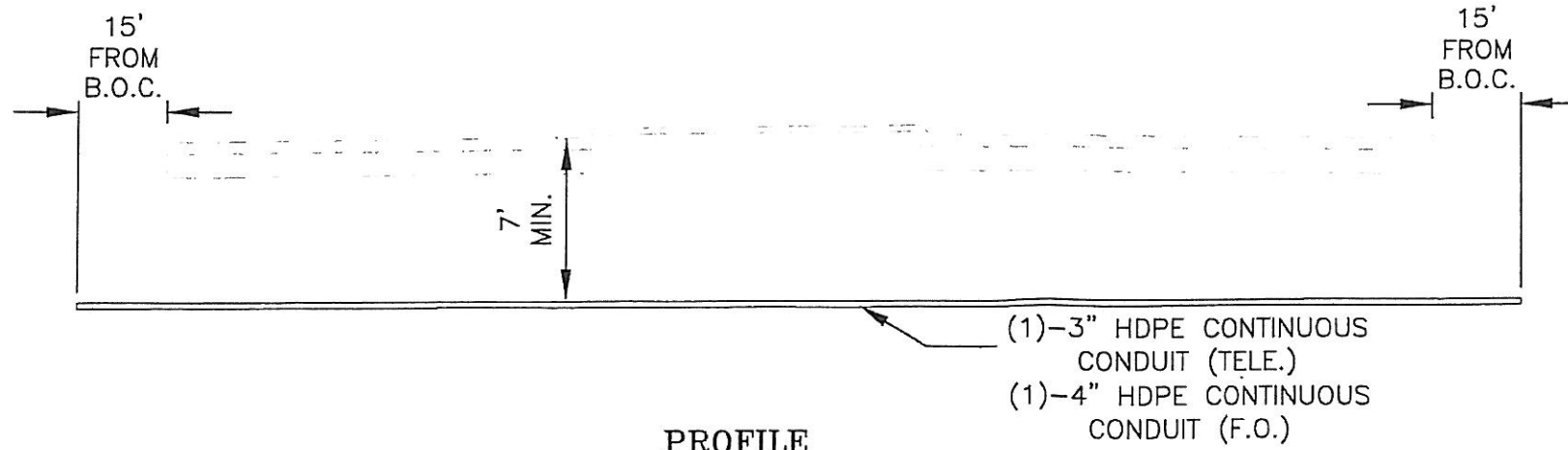

PROFILE  
NO SCALE

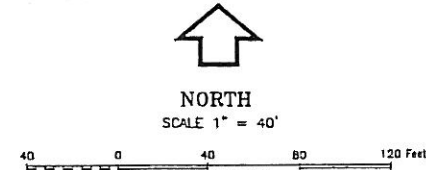

Retain the Location Request Number for YOUR Own Protection!

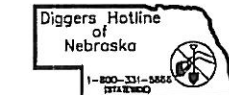

NOTE: UNDERGROUND UTILITY LOCATIONS SHOWN ARE FROM INFORMATION PROVIDED TO US FROM UTILITY COMPANIES. UTILITY COMPANIES MAKE NO WARRANTIES OR GUARANTEES REGARDING THE ACCURACY OF THE INFORMATION CONTAINED IN THEIR OCCUPANTS AND PROVIDES IT ONLY AS GENERAL INFORMATION TO THE RECEIVER. FOR SPECIFIC LOCATIONS DURING CONSTRUCTION CALL "DIGGERS HOTLINE" 1-800-331-5666 (STATEWIDE) PRIOR TO DIGGING.

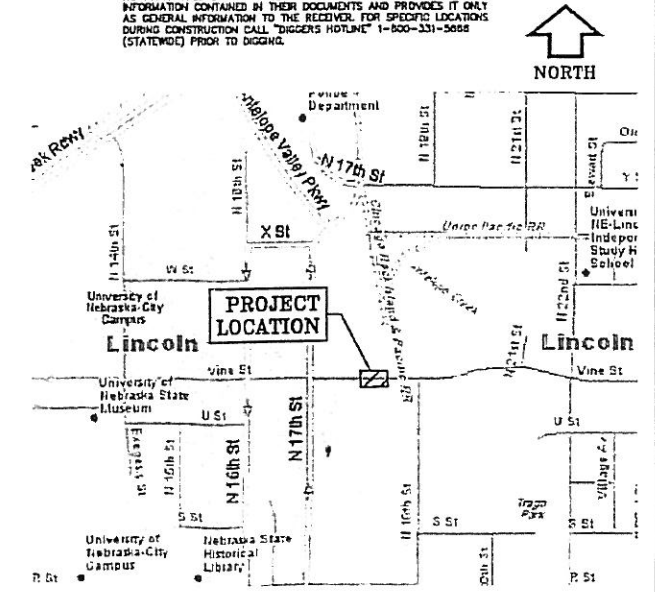

VICINITY MAP  
NO SCALE

ISSUED FOR:	DATE:	BY:

PROJECT		
091022		
NO.	DESCRIPTION	DATE

**REGA**  
ENGINEERING GROUP, INC.  
1620 SOUTH 70TH ST., SUITE 103  
LINCOLN, NEBRASKA 68506  
(402) 484.7342  
• ENGINEERING  
• PLANNING  
• LAND SURVEYING

UNIVERSITY of NEBRASKA  
19TH AND VINE  
PARKING GARAGE

DATE: 10/2009  
DESIGNED BY: DR  
DRAWN BY: SDB  
CHECKED BY: DR/RB/SDB

SHEET NO.  
1 of 1