

**SIDEWALK CAFE
PERMIT APPLICATION**

**CITY OF LINCOLN, NEBRASKA
LMC 14.50**

EXHIBIT "A"

Applicant

Name: Hans Wanamaker
Home Address: 1617 Nemaha St.
68502
Home Phone: 420-5310
Business Name: 475-0625
Grillwalker / Cookie Comp.
Business Address: 138 N. 12 Street
68508
Business Phone: 475-0625

Manager of Cafe

Name: Hans Wanamaker
Address: 1617 Nemaha St
68502
Phone: 420-5310

Record Owner of Property

Name: Wells Fargo Bank
Address: 1248 "O" Street
Phone: 434-4266

Does the record property owner agree to such use? yes no

Please attach a notarized letter of consent by record property owner for the use of said property.

Sidewalk Cafe Area

Please list days and hours of operation: _____
Monday - Friday 11:30^{a.m.} - 2:00 p.m.
Friday and Sat. 11:30 p.m - 1:30 a.m.

Please describe how the sidewalk cafe will be supervised and maintained: The Grillwalker will supervise the area. When grillwalker is not there, the area will be totally clear.
How many patrons will be served in cafe area? unlimited

Please describe any permitted advertising and street furniture used (photos may be attached): Just the grillwalker.

Please describe food and drink to be offered for sale: Bratwursts served in a bread roll with ketchup or mustard.

Please attach six copies of a plat or drawing indicating, to scale, the amount of surface public right of way you are seeking permission to use and the location of all furniture, equipment, and any other article occupying public space, if any.

Please attach Certificate of Insurance (Applicant shall at all times maintain a policy of liability insurance from a company licensed to do business in the State of Nebraska with a minimum of combined single limit of \$500,000 aggregate for any one occurrence. The insurance shall name the City of Lincoln as an additional insured.)

Permit Fees and Rent

An annual permit fee of \$100.00 must be paid to the City Clerk on the day of original permit approval.

- Paid Check # _____
- Cash

Annual rent of 25¢ (twenty five cents) per square foot of sidewalk space used must be paid to the City Clerk on the day of original permit approval.

- Paid Check # _____
- Cash

Hold Harmless

In consideration of being issued a permit for the use of surface space for a sidewalk cafe the undersigned applicant agrees to hold harmless the City of Lincoln and the officers and employees of the City for any loss or damage arising out of the use, or the discontinuance of any use. The undersigned agrees and understands that the use of the surface space is temporary, on a day to day basis; that the undersigned does not acquire any right, title, or interest in such space; that the undersigned may be required by the City at any time to vacate all or any part of the surface space that the undersigned has been given permission to use; that upon demand to vacate such space, the undersigned agrees to promptly remove any personal property placed thereon by the undersigned and to return the surface space to the same condition that it was in prior to commencement of such use or to reimburse the City for the cost of removing such property and restoring the surface space to its prior condition and that the undersigned has no recourse against either the City or its officers, employees or agents, either for any loss or damage occasioned by his or her being required to vacate all or any part of the surface space which the undersigned has been granted permission to use.

The undersigned further agrees at all times hereafter to comply with all municipal ordinances, rules and regulations of the City of Lincoln, Nebraska.

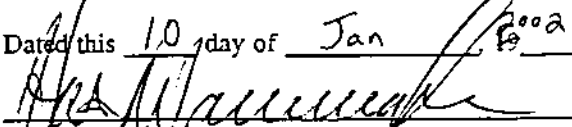
Dated this 10 day of Jan 2002

Applicant

Witness

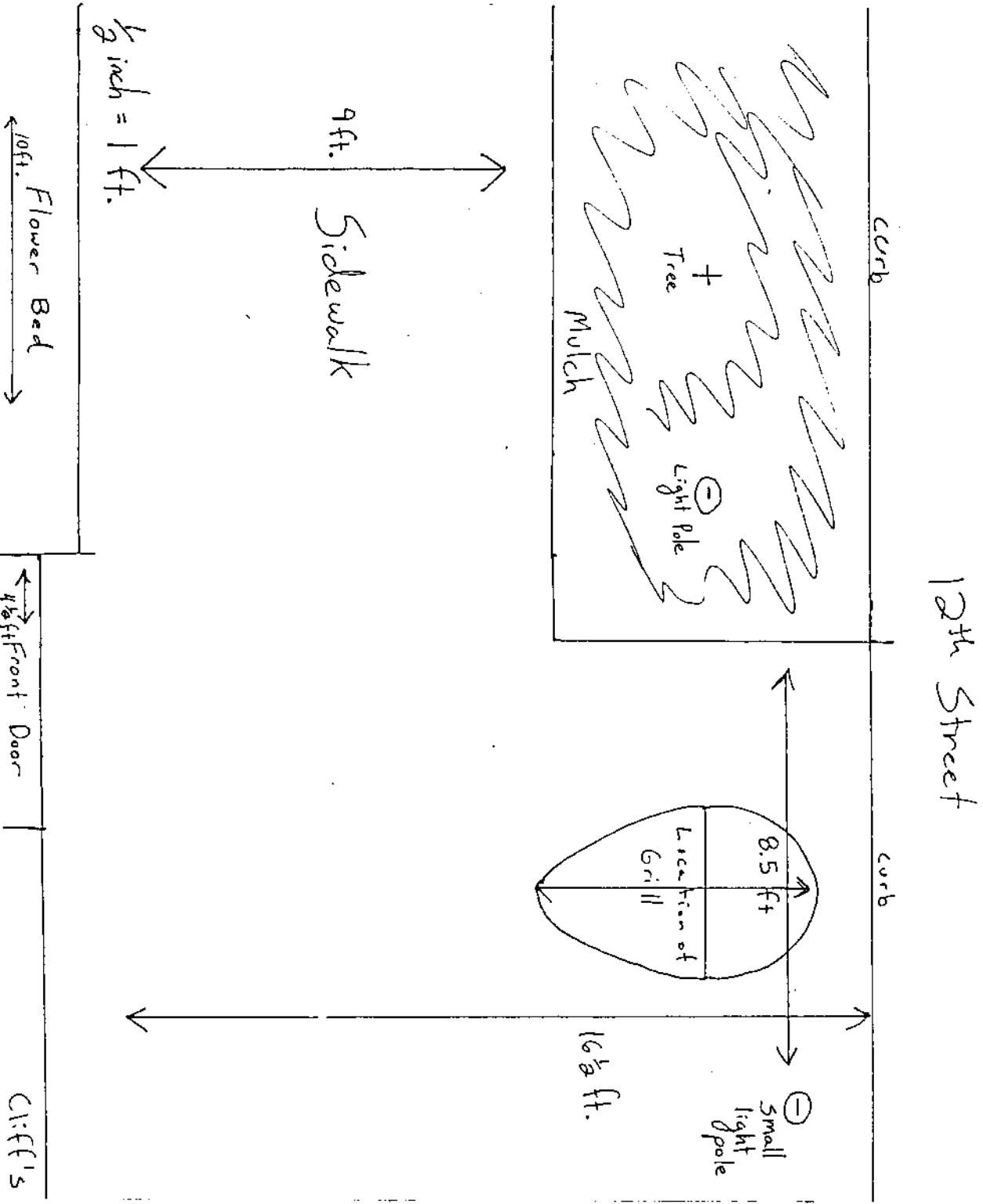
EXHIBIT "B"



JS

ACORD CERTIFICATE OF LIABILITY INSURANCE

DATE (MM/DD/YY)
01/09/02

PRODUCER
 INSPRO, Inc.
 1919 S 40th St, Suite #104
 P.O. Box 6847
 Lincoln, NE 68506

THIS CERTIFICATE IS ISSUED AS A MATTER OF INFORMATION ONLY AND CONFERS NO RIGHTS UPON THE CERTIFICATE HOLDER. THIS CERTIFICATE DOES NOT AMEND, EXTEND OR ALTER THE COVERAGE AFFORDED BY THE POLICIES BELOW.

INSURERS AFFORDING COVERAGE

INSURED
 Hansen Werner, Inc.
 DBA The Cookie Company
 138 N. 12th Street
 Lincoln, NE 68508

INSURER A: Nationwide Insurance
 INSURER B:
 INSURER C:
 INSURER D:
 INSURER E:

COVERAGES

THE POLICIES OF INSURANCE LISTED BELOW HAVE BEEN ISSUED TO THE INSURED NAMED ABOVE FOR THE POLICY PERIOD INDICATED. NOTWITHSTANDING ANY REQUIREMENT, TERM OR CONDITION OF ANY CONTRACT OR OTHER DOCUMENT WITH RESPECT TO WHICH THIS CERTIFICATE MAY BE ISSUED OR MAY PERTAIN, THE INSURANCE AFFORDED BY THE POLICIES DESCRIBED HEREIN IS SUBJECT TO ALL THE TERMS, EXCLUSIONS AND CONDITIONS OF SUCH POLICIES. AGGREGATE LIMITS SHOWN MAY HAVE BEEN REDUCED BY PAID CLAIMS.

INSR LTR	TYPE OF INSURANCE	POLICY NUMBER	POLICY EFFECTIVE DATE (MM/DD/YY)	POLICY EXPIRATION DATE (MM/DD/YY)	LIMITS
A	GENERAL LIABILITY <input checked="" type="checkbox"/> COMMERCIAL GENERAL LIABILITY CLAIMS MADE <input checked="" type="checkbox"/> OCCUR GENL AGGREGATE LIMIT APPLIES PER: POLICY <input type="checkbox"/> PRO-JECT <input type="checkbox"/> LOC	ACP7230129173	09/20/01	09/20/02	EACH OCCURRENCE \$1,000,000 FIRE DAMAGE (Any one fire) \$300,000 MED EXP (Any one person) \$5,000 PERSONAL & ADV INJURY \$1,000,000 GENERAL AGGREGATE \$2,000,000 PRODUCTS-COMP/OP AGG \$2,000,000
A	AUTOMOBILE LIABILITY <input checked="" type="checkbox"/> ANY AUTO <input type="checkbox"/> ALL OWNED AUTOS <input type="checkbox"/> SCHEDULED AUTOS <input checked="" type="checkbox"/> HIRED AUTOS <input checked="" type="checkbox"/> NON-OWNED AUTOS GARAGE LIABILITY <input type="checkbox"/> ANY AUTO	ACP7230129173	09/20/01	09/20/02	COMBINED SINGLE LIMIT (Ea accident) \$1,000,000 BODILY INJURY (Per person) \$ BODILY INJURY (Per accident) \$ PROPERTY DAMAGE (Per accident) \$ AUTO ONLY - EA ACCIDENT \$ OTHER THAN AUTO ONLY: EA ACC \$ AGG \$
A	EXCESS LIABILITY <input checked="" type="checkbox"/> OCCUR <input type="checkbox"/> CLAIMS MADE DEDUCTIBLE RETENTION \$	ACP7230129173	09/20/01	09/20/02	EACH OCCURRENCE \$1,000,000 AGGREGATE \$1,000,000 \$ \$
A	WORKERS COMPENSATION AND EMPLOYERS' LIABILITY	ACP7230129173	09/20/01	09/20/02	WC STATU- TOBY LIMITS: IOTH- ER E.L. EACH ACCIDENT \$100,000 E.L. DISEASE-EA EMPLOYEE \$100,000 E.L. DISEASE-POLICY LIMIT \$500,000
	OTHER				

DESCRIPTION OF OPERATIONS/LOCATIONS/VEHICLES/EXCLUSIONS ADDED BY ENDORSEMENT/SPECIAL PROVISIONS
 City of Lincoln is listed as Additional Insured.

CERTIFICATE HOLDER City of Lincoln Lincoln, NE 68505	ADDITIONAL INSURED: INSURER LETTER	CANCELLATION SHOULD ANY OF THE ABOVE DESCRIBED POLICIES BE CANCELLED BEFORE THE EXPIRATION DATE THEREOF, THE ISSUING INSURER WILL ENDEAVOR TO MAIL 30 DAYS WRITTEN NOTICE TO THE CERTIFICATE HOLDER NAMED TO THE LEFT, BUT FAILURE TO DO SO SHALL IMPOSE NO OBLIGATION OR LIABILITY OF ANY KIND UPON THE INSURER, ITS AGENTS OR REPRESENTATIVES. AUTHORIZED REPRESENTATIVE <i>Steve Morrow</i>
---	---	---





